

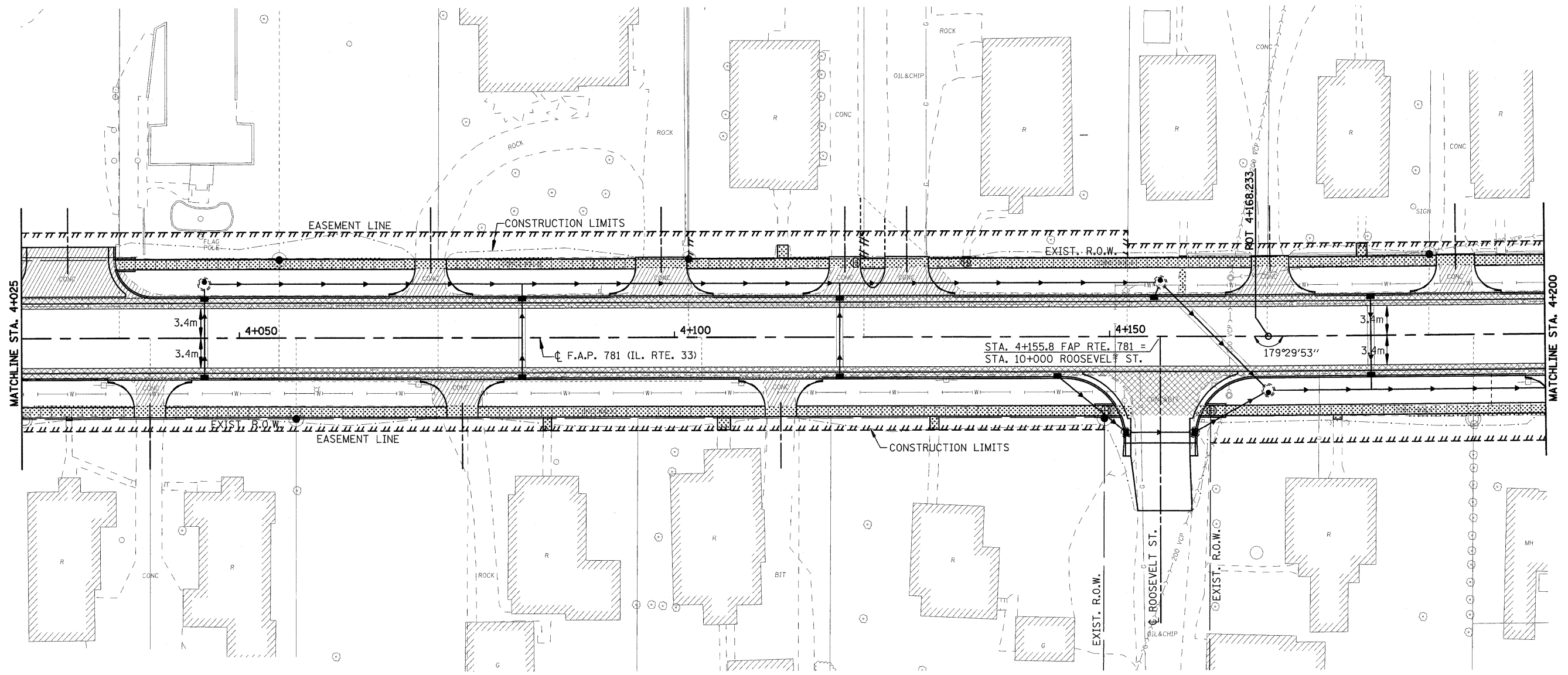



F.A.P. RTE.	SECTION	COUNTY	TOTAL SHEETS	SHEET NO.
781	2ZRS-1	CRAWFORD	191	51
STA. 4+025		TO STA. 4+200		
FED. ROAD DIST. NO.		ILLINOIS	FED. AID PROJECT	



**LEGEND**

-  DRIVEWAY PAVEMENT REMOVAL (INCLUDES ALL MATERIAL ENCOUNTERED)
-  PAVEMENT REMOVAL (INCLUDES ALL MATERIAL ENCOUNTERED)
-  SIDEWALK REMOVAL (INCLUDES STEPS)

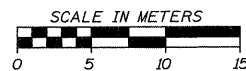

REVISIONS	
NAME	DATE

ILLINOIS DEPARTMENT OF TRANSPORTATION	
<b>REMOVAL ITEMS</b>	
SCALE	DRAWN BY EDW
DATE FEBRUARY 6, 2009	CHECKED BY LWJ

PLOT DATE = 2/5/2009  
 FILE NAME = H:\4420\Contract 74349\SHI\_051.REM250.dgn

H. M. & G. NO. 4420