

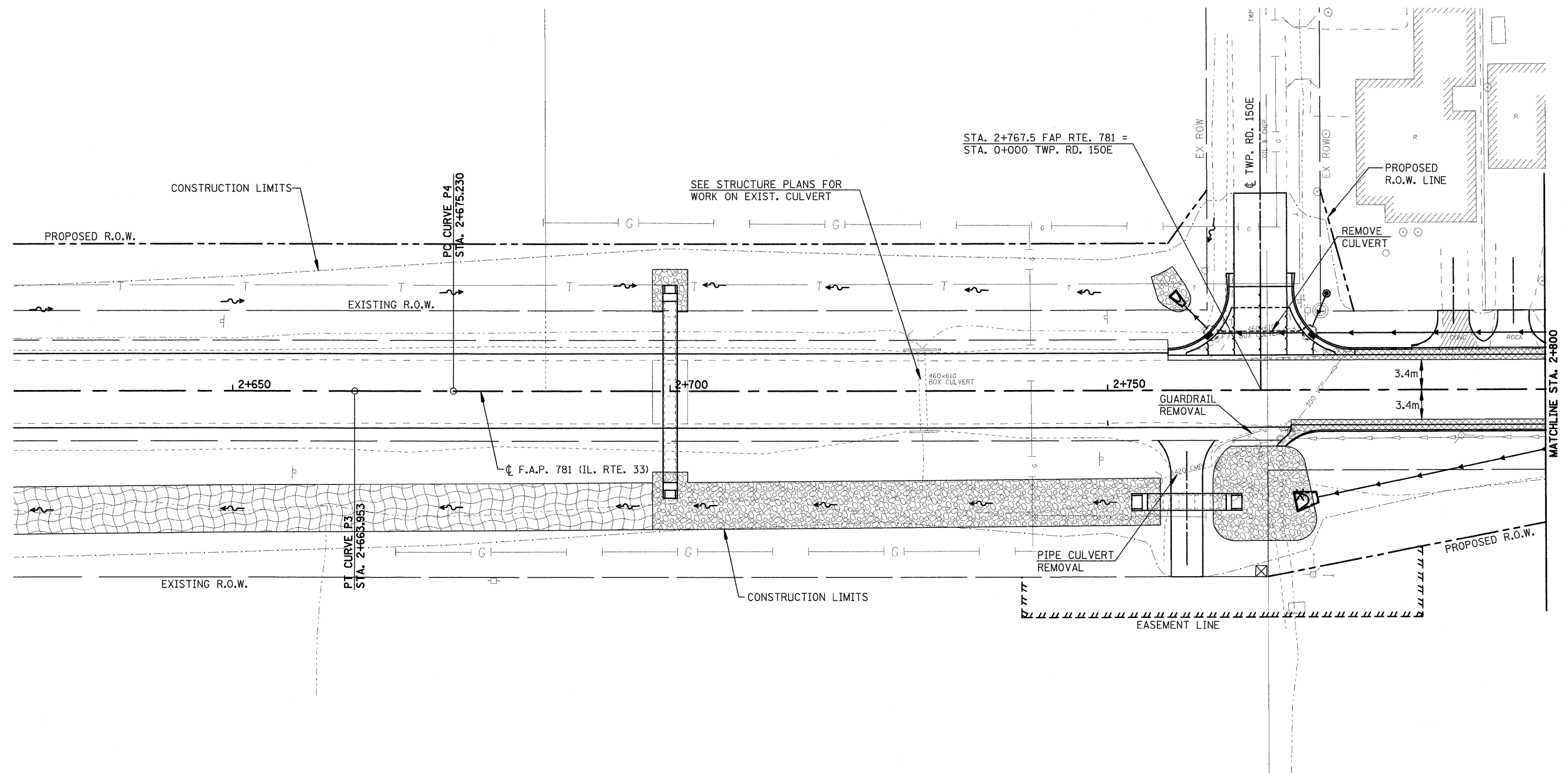



F.A.P. RTE.	SECTION	COUNTY	TOTAL SHEETS	SHEET NO.
781	2ZRS-1	CRAWFORD	191	43
STA. 2+625		TO STA. 2+800		
FED. ROAD DIST. NO.		ILLINOIS	FED. AID PROJECT	



LEGEND

-  DRIVEWAY PAVEMENT REMOVAL (INCLUDES ALL MATERIAL ENCOUNTERED)
-  PAVEMENT REMOVAL (INCLUDES ALL MATERIAL ENCOUNTERED)
-  SIDEWALK REMOVAL (INCLUDES STEPS)
-  HANDICAP RAMP

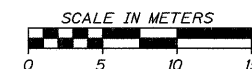

REVISIONS		ILLINOIS DEPARTMENT OF TRANSPORTATION
NAME	DATE	
		REMOVAL ITEMS SCALE _____ DRAWN BY EDW DATE FEBRUARY 6, 2009 CHECKED BY LWJ

PLOT DATE = 2/5/2009
 FILE NAME = H:\4420\Contract 74349\SHIT_043.REM250.D1.dgn

H. M. & G. NO. 4420