

F.A. RTE.	SECTION	COUNTY	TOTAL SHEETS	SHEET NO.
753	I28RS-3,139RS-3	MORGAN	137	49
STA. 7+00.00 TO STA. 11+00.00				
FED. ROAD DIST. NO. ILLINOIS FED. AID PROJECT				

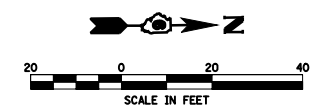

RR-00 PR SS 18" X 121.3' (WMR) USFL = 668.20 DSFL = 665.65 RR STA 7+56.02, 31.9' LT PR PRC FL END SEC 18" (STD 542301)

QQ-X PR SS 18" X 66.5' (WMR) USFL = 665.55 DSFL = 664.90 QQ STA 8+80.00 33.8' LT PR MH, T-A, 4' DIA. W/ FST & T-8 C (STD 602401, 602601, 602701, 604036) TOG = 668.56

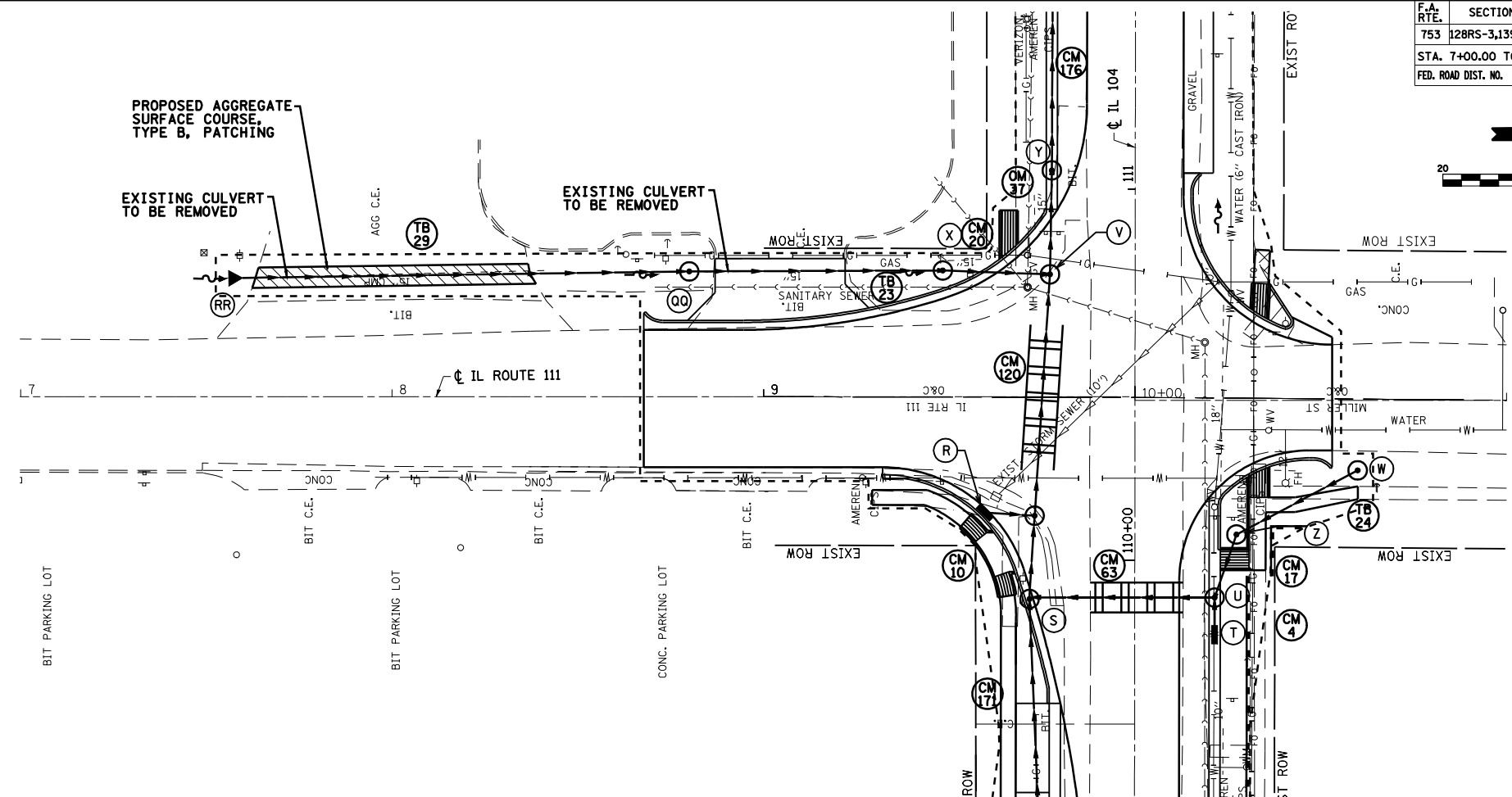

- NOTE:
- ON ALL STRUCTURES WITH TYPE 8 GRATES AND FLAT SLAB TOPS, A MINIMUM 6" TALL 24" DIAMETER RISER SHALL BE INSTALLED ABOVE THE FLAT SLAB TOP. THIS WORK SHALL BE INCLUDED IN THE CONTRACT UNIT PRICE PER EACH FOR THE STRUCTURE SPECIFIED.
  - CONTRACTOR SHALL HAVE OPTION OF PLACING STANDARD MANHOLES IN LIEU OF FLAT SLAB TOPS WHERE CONDITIONS PERMIT.
  - TOP OF GRATE ELEVATIONS & OFFSETS FOR DRAINAGE STRUCTURES WITHIN PAVEMENT AREAS ARE CALLED OUT TO THE INSIDE EDGE OF CURB. ALL OTHER DRAINAGE STRUCTURES ARE CALLED OUT TO THE CENTER OF STRUCTURE.

PLAN	SURVEYED	BY	DATE
NO.	NO.		

PROFILE	SURVEYED	BY	DATE
NO.	NO.		

PLOT DATE = Jan-16-2009 09:45:09 AM  
 FILE NAME = S:\CAD\072923\07854784\Drawings\784\Consult\Drawings\784\784-01.dwg  
 PLOT SCALE = 42.3229 / 1 IN.  
 USER NAME = joughlinr1

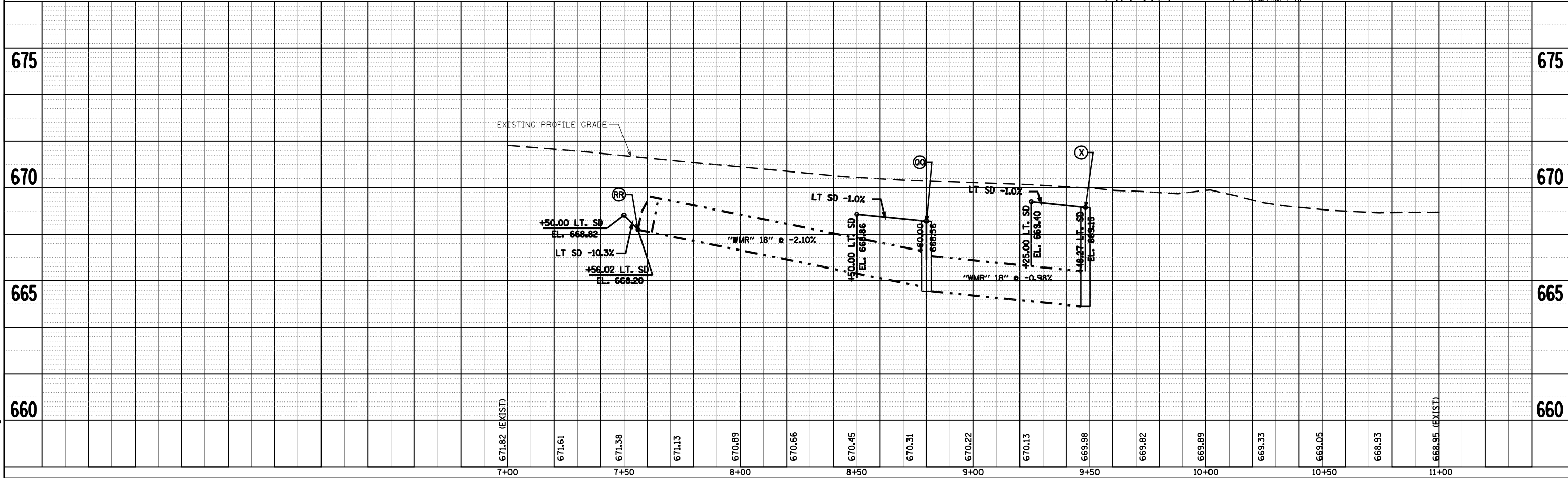

IL ROUTE 111 DRAINAGE PLAN & PROFILE, STA 5+00.00 TO STA 11+00.00