

F.A. RTE.	SECTION	COUNTY	TOTAL SHEETS	SHEET NO.
753	128RS-3,139RS-3	MORGAN	137	44
STA. 94+00.00		TO STA. 100+00.00		
FED. ROAD DIST. NO.	ILLINOIS	FED. AID PROJECT		

PLAN	DATE
BY	
DATE	
BY	
DATE	
BY	
DATE	

PROFILE	DATE
BY	
DATE	
BY	
DATE	
BY	
DATE	

PLOT DATE = Jan-16-2009 09:48:43AM
 FILE NAME = S:\CAD\07\2923 07854784\Drawings\784\Consult\Drawings\784\784.dwg
 PLOT SCALE = 42.3829 / IN.
 USER NAME = jangh11r-1

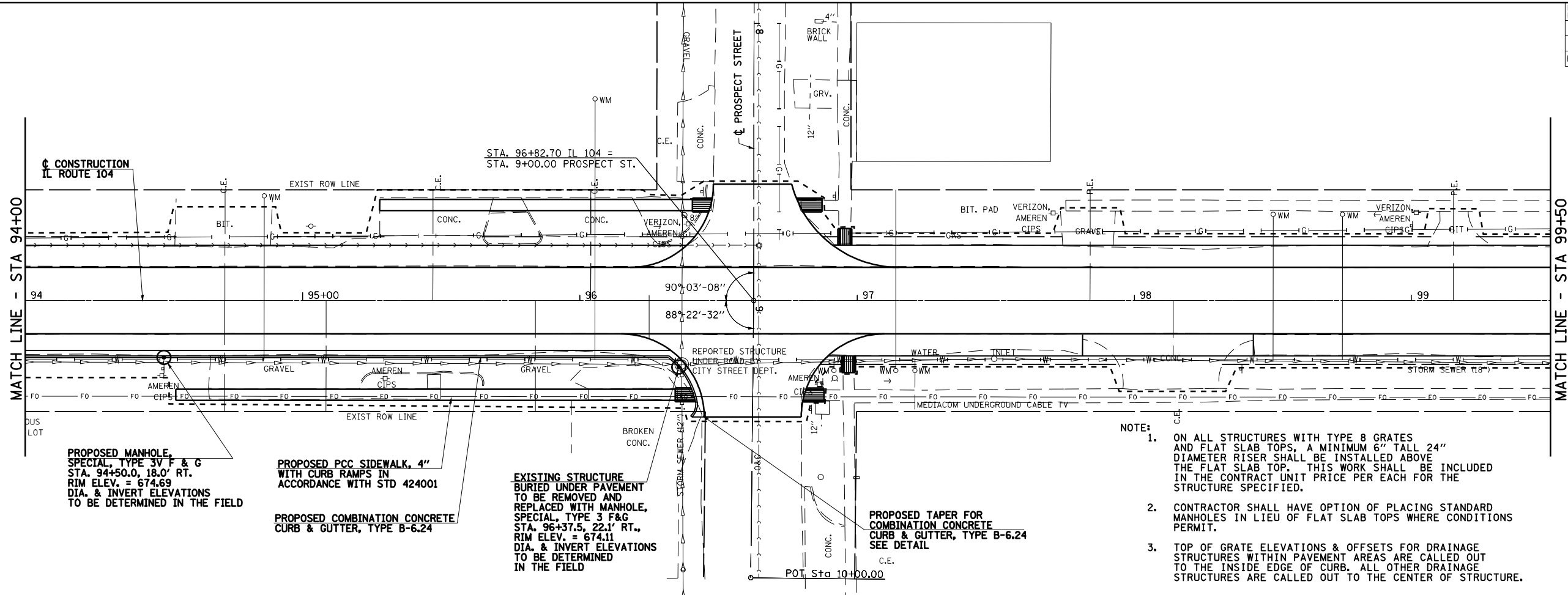

PROPOSED MANHOLE, SPECIAL, TYPE 3V F & G
 STA. 94+50.0, 18.0' RT.
 RIM ELEV. = 674.69
 DIA. & INVERT ELEVATIONS TO BE DETERMINED IN THE FIELD

PROPOSED PCC SIDEWALK, 4" WITH CURB RAMPS IN ACCORDANCE WITH STD 424001
PROPOSED COMBINATION CONCRETE CURB & GUTTER, TYPE B-6.24

EXISTING STRUCTURE BURIED UNDER PAVEMENT TO BE REMOVED AND REPLACED WITH MANHOLE, SPECIAL, TYPE 3 F&G
 STA. 96+37.5, 22.1' RT., RIM ELEV. = 674.11
 DIA. & INVERT ELEVATIONS TO BE DETERMINED IN THE FIELD

PROPOSED TAPER FOR COMBINATION CONCRETE CURB & GUTTER, TYPE B-6.24
 SEE DETAIL

- NOTE:**
- ON ALL STRUCTURES WITH TYPE 8 GRATES AND FLAT SLAB TOPS, A MINIMUM 6" TALL 24" DIAMETER RISER SHALL BE INSTALLED ABOVE THE FLAT SLAB TOP. THIS WORK SHALL BE INCLUDED IN THE CONTRACT UNIT PRICE PER EACH FOR THE STRUCTURE SPECIFIED.
 - CONTRACTOR SHALL HAVE OPTION OF PLACING STANDARD MANHOLES IN LIEU OF FLAT SLAB TOPS WHERE CONDITIONS PERMIT.
 - TOP OF GRATE ELEVATIONS & OFFSETS FOR DRAINAGE STRUCTURES WITHIN PAVEMENT AREAS ARE CALLED OUT TO THE INSIDE EDGE OF CURB. ALL OTHER DRAINAGE STRUCTURES ARE CALLED OUT TO THE CENTER OF STRUCTURE.

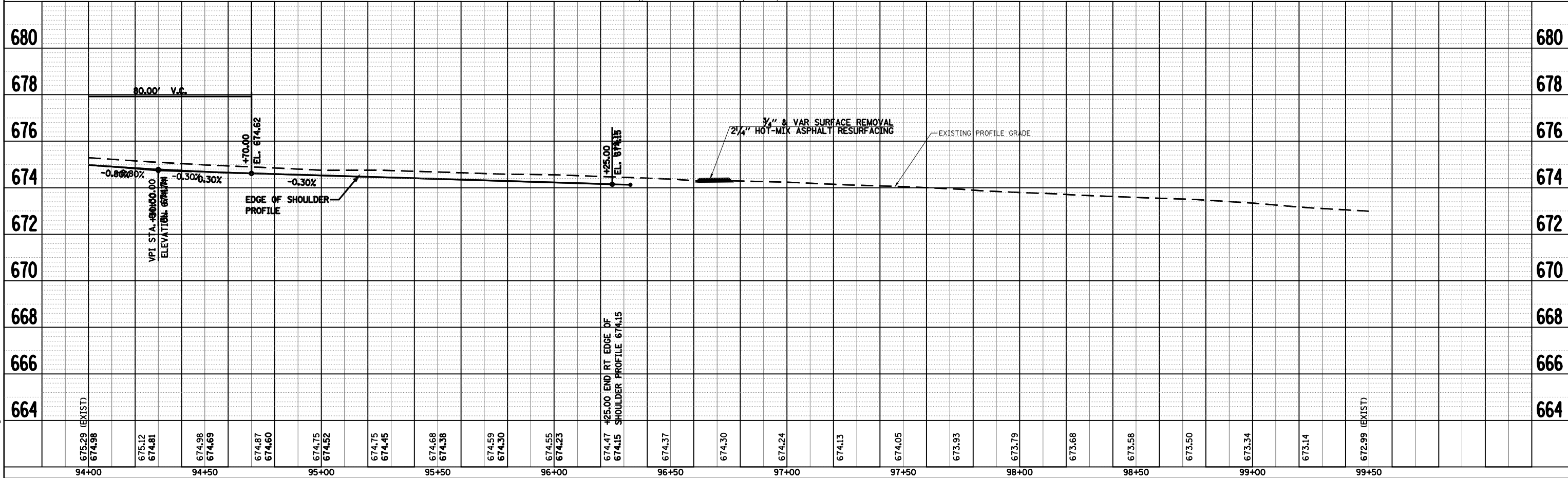
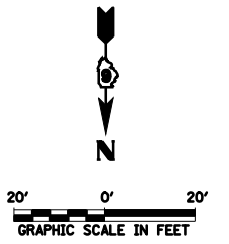

IL ROUTE 104 DRAINAGE PLAN & PROFILE, STA 94+00 TO STA 99+50