

F.A.P. RTE.	SECTION	COUNTY	TOTAL SHEETS	SHEET NO.
310	•	CASS	33	26
STA. 480+00	TO STA. 508+00			
FED. ROAD DIST. NO.	ILLINOIS	FED. AID PROJECT		
• 114(RS-3); 115(RS-3)			72830	

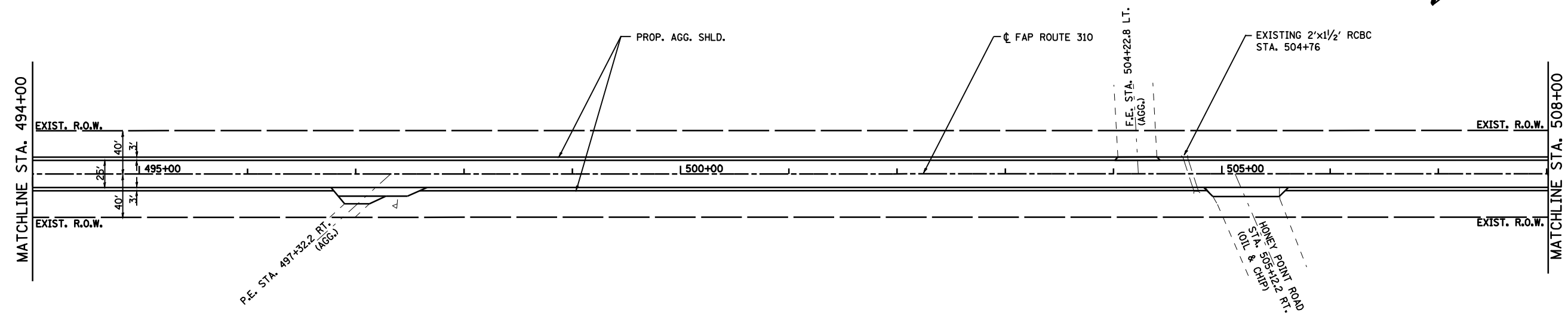
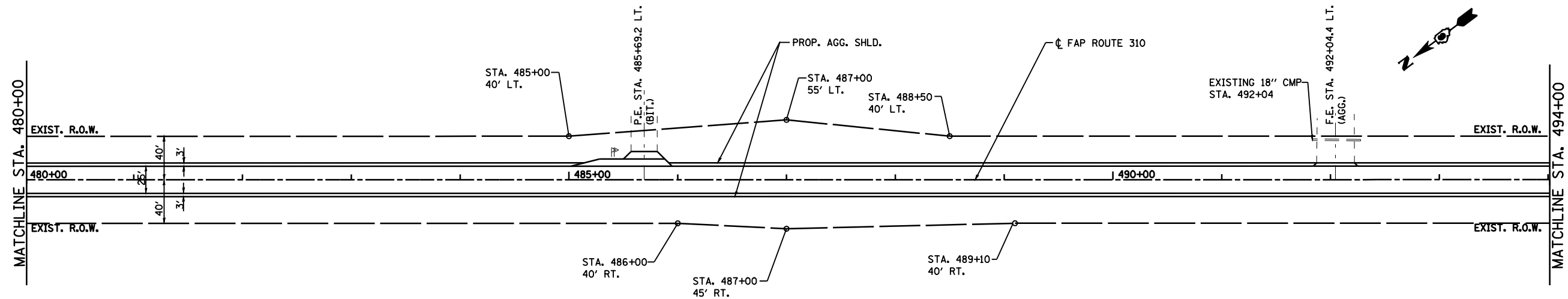

25' 0 25' 50'  
SCALE: 1" = 50'

REVISIONS	
NAME	DATE

ILLINOIS DEPARTMENT OF TRANSPORTATION  
**PLAN**  
FAP ROUTE 310 (US 67)  
SECTION 114 (RS-3); 115 (RS-3)  
CASS COUNTY  
SCALE: 1"=50'  
DATE: 11/2003  
DRAWN BY: FCX  
CHECKED BY: FML