

F.A.P. RTE.	SECTION	COUNTY	TOTAL SHEETS	SHEET NO.
310	•	CASS	33	19
STA. 283+00		TO STA. 311+00		
FED. ROAD DIST. NO.		ILLINOIS	FED. AID PROJECT	
• 114(RS-3); 115(RS-3)				72830

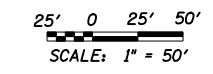
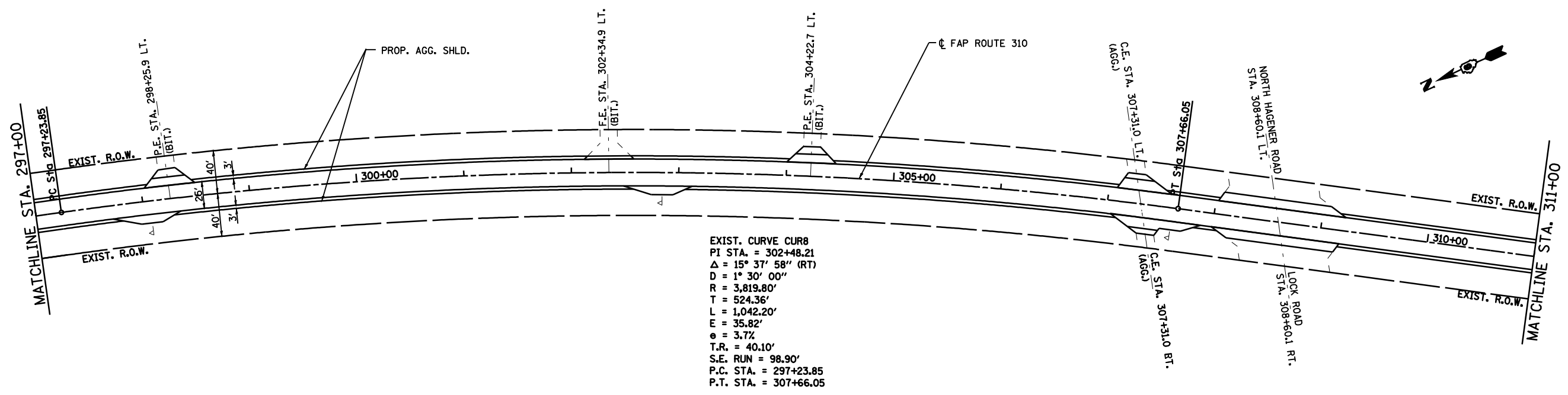
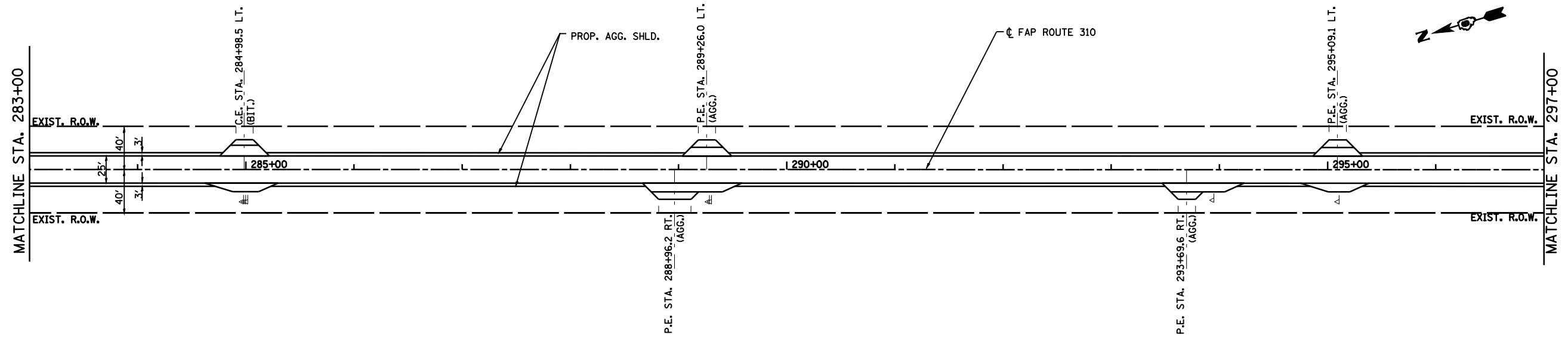

REVISIONS	
NAME	DATE

ILLINOIS DEPARTMENT OF TRANSPORTATION

PLAN

FAP ROUTE 310 (US 67)
SECTION 114 (RS-3); 115 (RS-3)
CASS COUNTY

SCALE: 1" = 50'
DATE: 11/2003

DRAWN BY: FCX
CHECKED BY: FML