

F.A.P. RTE.	SECTION	COUNTY	TOTAL SHEETS	SHEET NO.
325	*	MONTGOMERY	28	16
STA. 257+00.00 TO STA. 268+00.00				
FED. ROAD DIST. NO. ILLINOIS FED. AID PROJECT				
* 18(RS-4); 19(RS-7); 20Z(RS-5)				
CONTRACT NO. 72795				

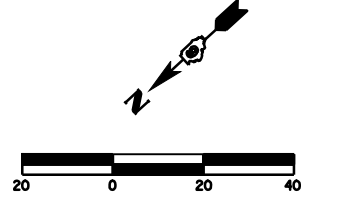

PLAN	SURVEYED	DATE
	PLOTTED	
	NOTE BOOK	
	NO. OF CHECKS	
	BY	
	DATE	

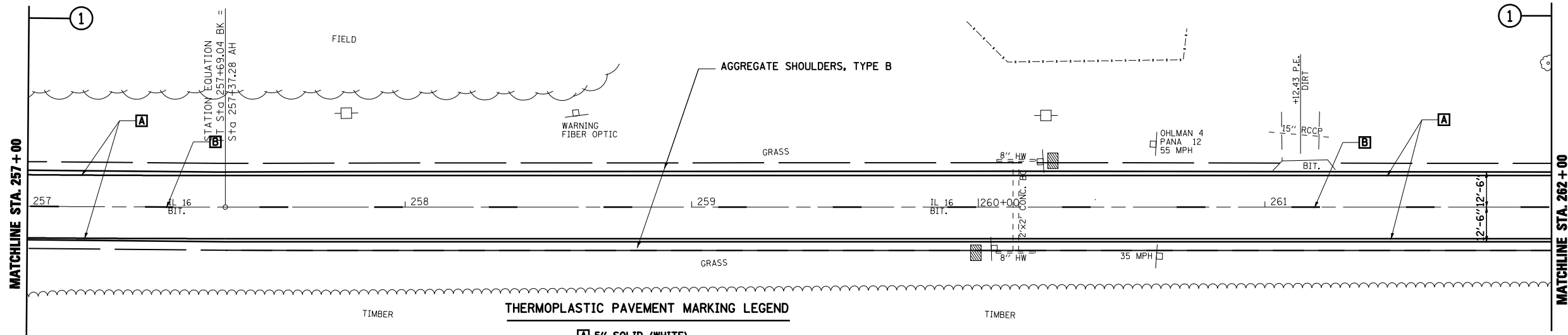

**THERMOPLASTIC PAVEMENT MARKING LEGEND**

- A** 5" SOLID (WHITE)
- B** 5" SKIP-DASH (YELLOW)
- C** 5" SOLID (YELLOW)
- D** 5" DOUBLE YELLOW (WIDE)



**PREFORMED PLASTIC PAVEMENT MARKING, TYP. B LEGEND**

- 1** 6" SOLID (WHITE)
- 2** 24" STOP BAR (WHITE)
- 3** 6" CROSSWALKS (WHITE)
- 4** LETTERS & SYMBOLS
- 5** 12" DIAGONAL (WHITE)
- 6** 12" DIAGONAL (YELLOW)

PROFILE	SURVEYED	DATE
	PLOTTED	
	NOTE BOOK	
	NO. OF CHECKS	
	BY	
	DATE	

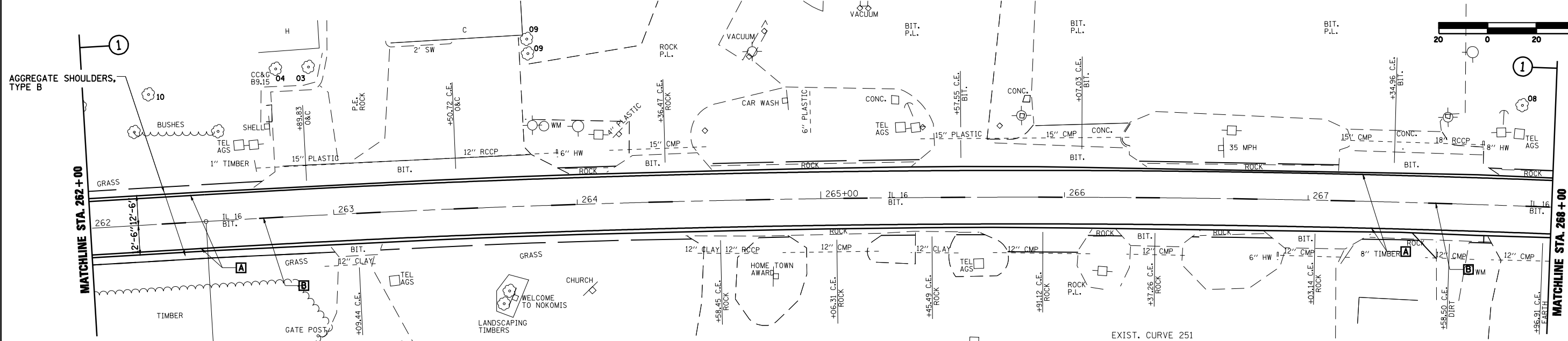

EXIST. CURVE 251  
 PI STA. = 265+84.30  
 $\Delta = 6^\circ 48' 25''$  (RT)  
 D = 1° 00' 42"  
 R = 5,663.51'  
 T = 336.83'  
 L = 672.86'  
 E = 10.01'  
 P.C. STA. = 262+47.47  
 P.T. STA. = 269+20.33  
 SE = N.C.

REVISIONS	
NAME	DATE

ILLINOIS DEPARTMENT OF TRANSPORTATION  
**F.A.P. ROUTE 325**  
**PLAN SHEET 2 OF 7**  
**(PART "A")**

DATE 3/2004  
 DRAWN BY MLO  
 CHECKED BY SJK