

F.A.S. RTE.	SECTION	COUNTY	TOTAL SHEETS	SHEET NO.
294	*	MCLEAN	22	1

\*(14R2 & 15R1)RS-1

D-95-032-06

STATE OF ILLINOIS  
DEPARTMENT OF TRANSPORTATION  
DIVISION OF HIGHWAYS

**PROPOSED  
HIGHWAY PLANS**

F.A.S. ROUTE 294 (OLD U.S. ROUTE 66)  
SECTION (14R2 & 15R1)RS-1  
MCLEAN COUNTY

RESURFACING (3P) FROM NORTH OF LEXINGTON TO SOUTH OF TOWANDA

C-95-033-06

PROJECT ESP-0294(108)

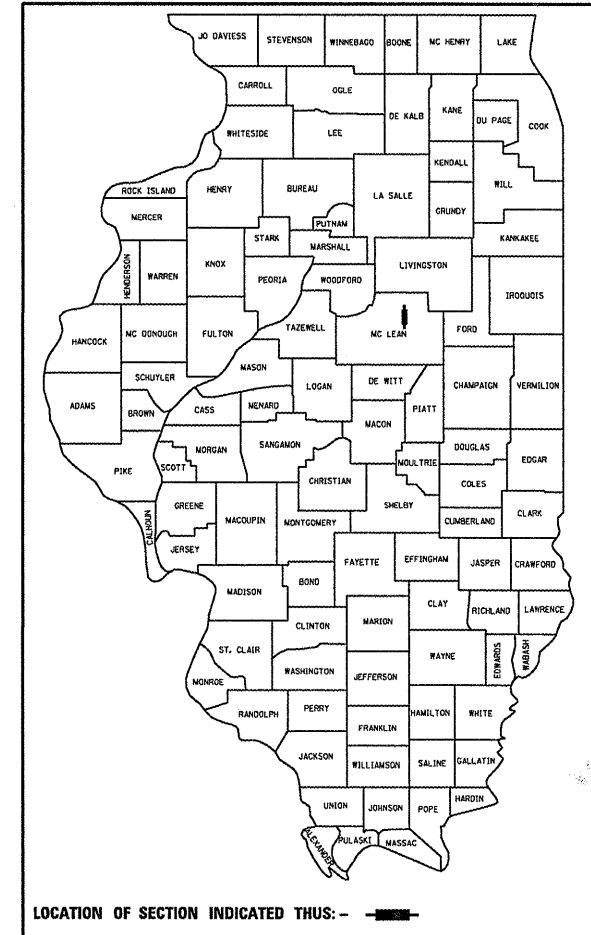

LOCATION OF SECTION INDICATED THIS: - [Black Box] -

PROJECT ENGINEER: KEVIN TRAPP

PROJECT ENGINEER: KEVIN TRAPP

PROJECT ENGINEER: KEVIN TRAPP

PROJECT ENGINEER: KEVIN TRAPP

PROJECT ENGINEER: KEVIN TRAPP

FOR INDEX OF SHEETS, SEE SHEET NO. 2  
FOR SUMMARY OF QUANTITIES, SEE SHEET NO. 4 - 5

**CURRENT ADT:**  
F.A.S. 294 (OLD ROUTE 66) = 3050 (2004)

**DESIGN DESIGNATION**  
MINOR ARTERIAL (URBAN)  
MAJOR COLLECTOR (RURAL)

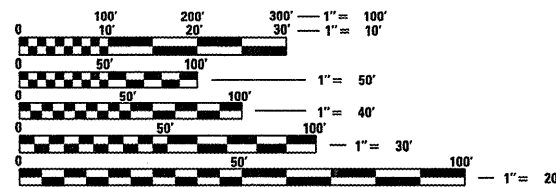

FULL SIZE PLANS HAVE BEEN PREPARED USING STANDARD ENGINEERING SCALES. REDUCED SIZED PLANS WILL NOT CONFORM TO STANDARD SCALES. IN MAKING MEASUREMENTS ON REDUCED PLANS, THE ABOVE SCALES MAY BE USED.

J.U.L.I.E.  
JOINT UTILITY LOCATION INFORMATION FOR EXCAVATION  
1-800-892-0123

TOWANDA, MONEY CREEK, LEXINGTON  
LEXINGTON, NORMAL AND CHENOA TOWNSHIPS

CONTRACT NO. 70512

STATION EQUATION  
STATION 2489+32.83 (BK) =  
STATION 2487+74.18 (AH)

S.N. 057-0033  
HMA RESURFACING  
STATION 2628+44.00

BRIDGE OMISSION  
S.N. 057-0239  
STATION 2811+28.00 TO  
STATION 2813+12.00

SECTION (14R2 & 15R1)RS-1  
ENDS @ STATION 2987+70

SECTION (14R2 & 15R1)RS-1  
BEGINS @ STATION 2300+12

BRIDGE OMISSION  
S.N. 057-0039  
STATION 2347+68.00 TO  
STATION 2350+52.00

BRIDGE OMISSION  
S.N. 057-0037  
STATION 2369+42.00 TO  
STATION 2369+68.00

STATION EQUATION  
STATION 2420+56.66 (BK) =  
STATION 2420+64.46 (AH)

BRIDGE OMISSION  
S.N. 057-0035  
STATION 2489+20.00 TO  
STATION 2491+98.00

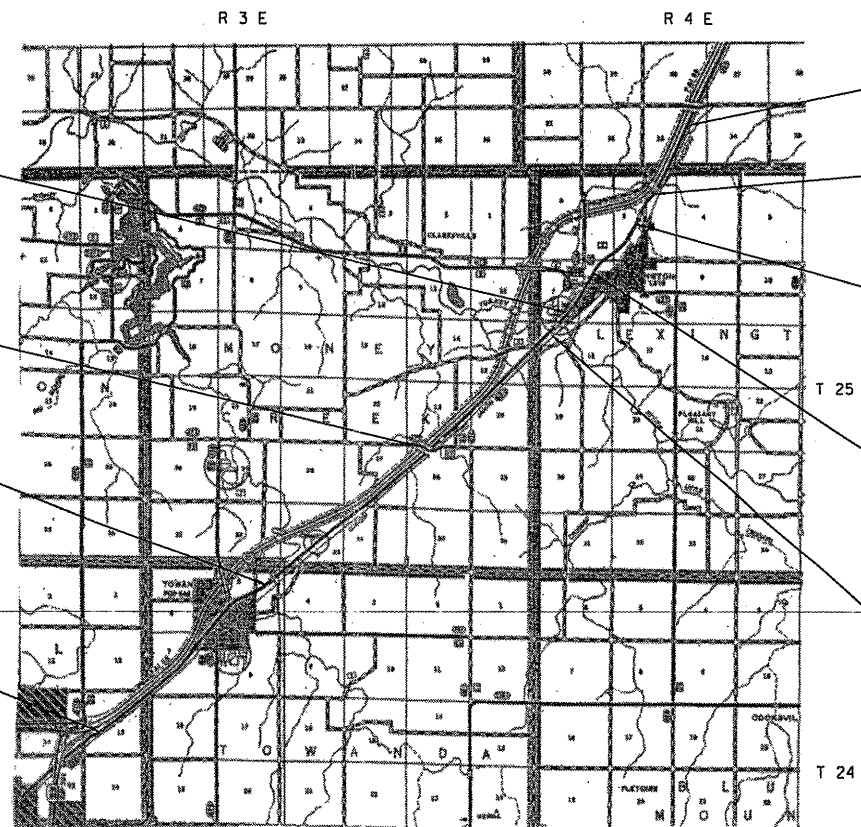

TOTAL LENGTH OF SECTION & PROJECT = 68,908.85 FEET = 13.051 MILES  
NET LENGTH OF SECTION & PROJECT = 68,136.85 FEET = 12.905 MILES



STATE OF ILLINOIS  
DEPARTMENT OF TRANSPORTATION  
DIVISION OF HIGHWAYS

SUBMITTED *Jan 29, 2009*

*March 13, 2009*  
DEPUTY DIRECTOR OF HIGHWAYS, REGION ENGINEER

*Charles J. Ingersoll*  
ENGINEER OF DESIGN AND ENVIRONMENT

*March 13, 2009*  
*Christine M. Reed*  
DIRECTOR OF HIGHWAYS/CHIEF ENGINEER

PRINTED BY THE AUTHORITY  
OF THE STATE OF ILLINOIS

F.A.S. RTE.	SECTION	COUNTY	TOTAL SHEETS	SHEET NO.
294	*	MCLEAN	22	2
STA.		TO STA.		
FED. ROAD DIST. NO.		ILLINOIS FED. AID PROJECT		

\*(14R2 & 15R1)RS-1

**INDEX OF SHEETS**

SHEET NO.	ITEM
1	COVER SHEET
2	INDEX OF SHEETS
2	LIST OF STANDARDS
3	GENERAL NOTES
4-5	SUMMARY OF QUANTITIES
6	EXISTING TYPICAL CROSS SECTIONS
7-8	PROPOSED TYPICAL CROSS SECTIONS
9-10	SCHEDULE OF QUANTITIES
11	MAINLINE HOT-MIX ASPHALT SURFACE REMOVAL DETAILS
11-13	STRUCTURE HOT-MIX ASPHALT SURFACE REMOVAL DETAILS
14	TYPICAL DETAIL OF RURAL PRIVATE AND COMMERCIAL ENTRANCES
14	DETAIL OF SIDEROAD RETURNS
15	TYPICAL DETAIL OF RURAL MAILBOX TURNOUTS
16	DETAIL OF MAIN ST. INTERSECTION IN LEXINGTON
17	DETAIL OF CONCRETE MEDIAN, TYPE SM-6 (SM-15) (DOWELED)
18	MISCELLANEOUS DETAILS
19-22	TYPICAL APPLICATIONS OF PAVEMENT MARKINGS

**LIST OF STANDARDS**

STANDARD NUMBER	NAME OF STANDARD
000001-05	STANDARD SYMBOLS, ABBREVIATIONS AND PATTERNS
001001-02	AREAS OF REINFORCEMENT BARS
001006	DECIMAL OF AN INCH AND OF A FOOT
406201-01	MAILBOX TURNOUT
442201-03	CLASS C AND D PATCHES
482011-03	HMA SHOULDER STRIPS/SHOULDERS WITH RESURFACING OR WIDENING AND RESURFACING PROJECTS
606301-04	PC CONCRETE ISLANDS AND MEDIANS
701006-03	OFF ROAD OPERATIONS 2L, 2W, 4.5M (15') TO 600MM (24") FROM PAVEMENT EDGE
701201-03	LANE CLOSURE, 2L, 2W, DAY ONLY, FOR SPEEDS >= 45 MPH
701301-03	LANE CLOSURE, 2L, 2W, SHORT TIME OPERATIONS
701306-02	LANE CLOSURE, 2L, 2W, SLOW MOVING OPERATIONS - DAY ONLY, FOR SPEEDS >= 45 MPH
701311-03	LANE CLOSURE, 2L, 2W, MOVING OPERATIONS - DAY ONLY
701326-03	LANE CLOSURE, 2L, 2W, PAVEMENT WIDENING, FOR SPEEDS >= 45 MPH
701501-05	URBAN LAND CLOSURE, 2L 2W, UNDIVIDED
701901-01	TRAFFIC CONTROL DEVICES
780001-02	TYPICAL PAVEMENT MARKINGS
781001-03	TYPICAL APPLICATIONS RAISED REFLECTIVE PAVEMENT MARKERS

PLOT DATE : 1/14/2009  
 FILE NAME : c:\pwworkspace\pwworkspace\PIERSONBR\012345\dlisths.dgn  
 PLOT SCALE : 42.3529 / IN.  
 USER NAME : dier-sombr

ILLINOIS DEPARTMENT OF TRANSPORTATION  
**INDEX OF SHEETS  
 & LIST OF STANDARDS**  
 F.A.S. ROUTE 294 (OLD U.S. ROUTE 66)  
 SECTION (14R2 & 15R1)RS-1  
 MCLEAN COUNTY

SCALE: NOT TO SCALE  
 DATE: 08/02/06

DRAWN BY: B.B.P.  
 CHECKED BY: M.L.B.

F.A.S. RTE.	SECTION	COUNTY	TOTAL SHEETS	SHEET NO.
294	*	MCLEAN	22	3
STA.		TO STA.		
FED. ROAD DIST. NO.		ILLINOIS FED. AID PROJECT		

\*(14R2 & 15R1)RS-1

### GENERAL NOTES

G. N. - 100

ENGLISH UNITS OF MEASUREMENT SHALL GOVERN OVER AND SUPERSEDE ANY METRIC UNITS SHOWN IN THIS CONTRACT. WHERE INCLUDED, METRIC UNITS ARE FOR INFORMATION ONLY.

G. N. - 406

THE QUANTITIES INCLUDED IN THE PLANS FOR HOT-MIX ASPHALT RESURFACING ARE INTENDED TO GIVE THE COVERAGE SHOWN ON THE TYPICAL CROSS SECTIONS. IT IS NOT INTENDED TO INCREASE THE THICKNESS OF THE HOT-MIX ASPHALT MIXTURE IN ORDER TO USE ALL OF THE QUANTITIES INCLUDED IN THE CONTRACT.

G. N. -406.05B

ALL LEVELING BINDER OR BINDER SHALL BE GIVEN A FOG COAT OF PRIME BEFORE THE SURFACE COURSE IS PLACED WHEN DIRECTED BY THE ENGINEER.

THE FOG COAT WILL BE PAID FOR AT THE CONTRACT UNIT PRICE PER GALLON FOR BITUMINOUS MATERIAL (PRIME COAT) AND NO ADDITIONAL COMPENSATION WILL BE ALLOWED.

G. N. - 406H

MIXTURE REQUIREMENTS

THE FOLLOWING MIXTURE REQUIREMENTS ARE APPLICABLE FOR THIS PROJECT:

MIXTURE USES	AC/PG	RAP % (MAX)	DESIGN AIR VOIDS	MIXTURE COMPOSITION	FRICTION AGGREGATE
LEVELING BINDER (HAND METHOD), N50	PG 64-22	25%	4.0% @ Ndes = 50	IL 9.5	MIX C
LEVELING BINDER (MACHINE METHOD), N50	PG 64-22	25%	4.0% @ Ndes = 50	IL 9.5	MIX C
HOT-MIX ASPHALT SURFACE COURSE, MIX "C", N50	PG 64-22	15%	4.0% @ Ndes = 50	IL 9.5	MIX C
HOT-MIX ASPHALT BASE COURSE WIDENING, 9"	PG 64-22	25%	4.0% @ Ndes = 50	IL 19.0	N. A.
INCIDENTAL HOT-MIX ASPHALT SURFACING	PG 64-22	15%	4.0% @ Ndes = 50	IL 9.5	MIX C
CLASS D PATCH	PG 64-22	25%	4.0% @ Ndes = 50	IL 19.0	N. A.
HOT-MIX ASPHALT MIXTURE FOR PATCHING	PG 64-22	25%	4.0% @ Ndes = 50	IL 9.5	MIX C

G. N. -703A

SHORT TERM PAVEMENT MARKING SHALL BE APPLIED TO THE PAVEMENT AFTER ANY OF THE FOLLOWING: COLD MILLING AND/OR PLACING BITUMINOUS MATERIALS (PRIME COAT), LEVELING BINDER (MACHINE METHOD), BINDER AND SURFACE COURSES. SHORT TERM PAVEMENT MARKING PLACED ON THE SURFACE, SHALL COINCIDE WITH THE FINAL PAVEMENT STRIPING. SHORT TERM PAVEMENT MARKING PLACED PRIOR TO THE SURFACE SHALL COINCIDE WITH THE EXISTING PAVEMENT MARKINGS. USE 4 FEET PER 40 FEET (OR 10% PER STATION).

G. N. -781

RAISED REFLECTIVE PAVEMENT MARKERS SHALL BE PLACED IN ACCORDANCE WITH STANDARD 781001, AND THE DETAILS SHOWN IN THE PLANS. IF THERE IS ANY DISCREPANCY BETWEEN THE STANDARD AND THE DETAILS IN THE PLANS, THE DETAILS IN THE PLANS SHALL GOVERN. THE FINAL PAVEMENT MARKINGS SHALL BE IN PLACE PRIOR TO PLACING THE RAISED REFLECTIVE PAVEMENT MARKERS AND THE RAISED REFLECTIVE PAVEMENT MARKERS SHALL BE PLACED MIDWAY IN THE 30 FOOT (9 m) SPACE BETWEEN THE DASHED CENTERLINE STRIPES (WHEN APPLICABLE).

G. N. -1004.01

COARSE AGGREGATE GRADATION CA-10 MAY BE USED WHENEVER COARSE AGGREGATE CA-6 IS SPECIFIED IN THE STANDARD SPECIFICATIONS.

PLOT DATE = 1/14/2009  
 FILE NAME = C:\pwworkspace\PROJECTS\2008\142329\1\IN  
 PLOT SCALE = 42,329 / IN  
 USER NAME = pier-somb

ILLINOIS DEPARTMENT OF TRANSPORTATION

#### GENERAL NOTES

F.A.S. ROUTE 294 (OLD U.S. ROUTE 66)  
 SECTION (14R2 & 15R1)RS-1  
 MCLEAN COUNTY

SCALE: NOT TO SCALE  
 DATE: 08/02/06

DRAWN BY: M.L.B.  
 CHECKED BY: M.L.B.

# SUMMARY OF QUANTITIES

SHEET 1 OF 2

CONTRACT NO. 70512				
F.A.S. RTE.	SECTION	COUNTY	TOTAL SHEETS	SHEET NO.
294	*	MCLEAN	22	4
STA.		TO STA.		
FED. ROAD DIST. NO.		ILLINOIS FED. AID PROJECT		
*(14R2 & 15R1)RS-1				

LOCATION OF WORK:

FAS 294	FAS 294
OLD U.S. ROUTE 66	OLD U.S. ROUTE 66
RURAL	URBAN
STA. 2300+12	STA. 2796+56
TO	TO
STA. 2796+56	STA. 2987+70

FUNDING BREAKOUT:

100% FED	100% FED
----------	----------

CONSTRUCTION TYPE CODE:

1000	1000
------	------

CODE NO	ITEM	UNIT	TOTAL QUANTITY	QUANTITY	QUANTITY
20200500	EARTH EXCAVATION (WIDENING)	CU YD	1,937.0	1,095.0	842.0
20800150	TRENCH BACKFILL	CU YD	1.0	1.0	0.0
31101200	SUB-BASE GRANULAR MATERIAL, TYPE B 4"	SO YD	37.0	37.0	0.0
35300500	PORTLAND CEMENT CONCRETE BASE COURSE, 10"	SO YD	37.0	37.0	0.0
35600712	HOT-MIX ASPHALT BASE COURSE WIDENING, 9"	SO YD	5,757.0	3,282.0	2,475.0
40600100	BITUMINOUS MATERIALS (PRIME COAT)	GAL	18,984.0	13,606.0	5,378.0
40600300	AGGREGATE (PRIME COAT)	TON	382.0	274.0	108.0
40600525	LEVELING BINDER (HAND METHOD), N50	TON	8.0	8.0	0.0
40600625	LEVELING BINDER (MACHINE METHOD), N50	TON	8,413.0	5,963.0	2,450.0
40600895	CONSTRUCTING TEST STRIP	EACH	1.0	0.7	0.3
40600990	TEMPORARY RAMP	SO YD	161.0	121.0	40.0
40603310	HOT-MIX ASPHALT SURFACE COURSE, MIX "C", N50	TON	15,910.0	11,389.0	4,518.0
40800010	BITUMINOUS MATERIAL (PRIME COAT)	GAL	728.0	442.0	286.0
40800030	AGGREGATE (PRIME COAT)	TON	15.0	9.0	6.0
40800050	INCIDENTAL HOT-MIX ASPHALT SURFACING	TON	618.0	378.0	240.0
44000155	HOT-MIX ASPHALT SURFACE REMOVAL, 1 1/2"	SO YD	183,213.0	132,312.0	50,901.0
44000196	HOT-MIX ASPHALT SURFACE REMOVAL, SPECIAL	SO YD	7694.0	4836.0	2,858.0
44002805	ISLAND REMOVAL	SO FT	335.0	335.0	0.0
44201798	CLASS D PATCHES, TYPE I, 13 INCH	SO YD	50.0	36.0	14.0

PLOT DATE : 1/15/2009  
 FILE NAME : G:\dwg\work\KPMW001\PIERSONBR\012345\alists.dgn  
 PLOT SCALE : 42.3529' / IN.  
 USER NAME : dlfrsahr

ILLINOIS DEPARTMENT OF TRANSPORTATION  
**SUMMARY OF QUANTITIES**  
 F.A.S. ROUTE 294 (OLD U.S. ROUTE 66)  
 SECTION (14R2 & 15R1)RS-1  
 MCLEAN COUNTY  
*Sheet 1 of 2*  
 SCALE: NOT TO SCALE      DRAWN BY: B.B.P.  
 DATE: 08/02/06              CHECKED BY: M.L.B.

F.A.S. RTE.	SECTION	COUNTY	TOTAL SHEETS	SHEET NO.
294	*	MCLEAN	22	5
STA.		TO STA.		
FED. ROAD DIST. NO.		ILLINOIS FED. AID PROJECT		

\*14R2 & 15R1RS-1

## SUMMARY OF QUANTITIES

SHEET 2 OF 2

LOCATION OF WORK:

FAS 294 OLD U.S. ROUTE 66 RURAL STA. 2300+12 TO STA. 2796+56	FAS 294 OLD U.S. ROUTE 66 URBAN STA. 2796+56 TO STA. 2987+70
---	---

FUNDING BREAKOUT:

100% FED	100% FED
----------	----------

CONSTRUCTION TYPE CODE:

1000	1000
------	------

CODE NO	ITEM	UNIT	TOTAL QUANTITY	QUANTITY	QUANTITY
44201803	CLASS D PATCHES, TYPE II, 13 INCH	SQ YD	3,037.0	2,194.0	843.0
44201807	CLASS D PATCHES, TYPE III, 13 INCH	SQ YD	283.0	204.0	79.0
44201809	CLASS D PATCHES, TYPE IV, 13 INCH	SQ YD	294.0	212.0	82.0
48101200	AGGREGATE SHOULDERS, TYPE B	TON	3,125.0	2,257.0	868.0
60622354	CONCRETE MEDIAN, TYPE SM-6 (DOWELLED)	SQ FT	140.0	140.0	0.0
67000400	ENGINEER'S FIELD OFFICE, TYPE A	CAL MO	4.0	3.0	1.0
67100100	MOBILIZATION	L SUM	1.0	0.7	0.3
70100450	TRAFFIC CONTROL AND PROTECTION, STANDARD 701201	L SUM	1.0	0.7	0.3
70100460	TRAFFIC CONTROL AND PROTECTION, STANDARD 701306	L SUM	1.0	0.7	0.3
70100500	TRAFFIC CONTROL AND PROTECTION, STANDARD 701326	L SUM	1.0	0.7	0.3
70102620	TRAFFIC CONTROL AND PROTECTION, STANDARD 701501	L SUM	1.0	0.7	0.3
70103815	TRAFFIC CONTROL SURVEILLANCE	CAL DAY	2.0	2.0	0.0
70300100	SHORT TERM PAVEMENT MARKING	FOOT	13,627.0	9,841.0	3,786.0
70300220	TEMPORARY PAVEMENT MARKING - LINE 4"	FOOT	155,764.0	112,571.0	43,193.0
70301000	WORK ZONE PAVEMENT MARKING REMOVAL	SQ FT	2,271.0	1,640.0	631.0
• 78000200	THERMOPLASTIC PAVEMENT MARKING - LINE 4"	FOOT	129.0	129.0	0.0
• 78000600	THERMOPLASTIC PAVEMENT MARKING - LINE 12"	FOOT	70.0	70.0	0.0
• 78000650	THERMOPLASTIC PAVEMENT MARKING - LINE 24"	FOOT	138.0	90.0	48.0
• 78001110	PAINT PAVEMENT MARKING - LINE 4"	FOOT	155,764.0	112,571.0	43,193.0
• 78100100	RAISED REFLECTIVE PAVEMENT MARKER	EACH	852.0	615.0	237.0
89502380	REMOVE EXISTING HANDHOLE	EACH	2.0	2.0	0.0
•	SPECIALTY ITEM				

PLOT DATE : 1/14/2009  
 FILE NAME : c:\pwworking\pwworking\PROJECTS\14R2 & 15R1RS-1.dgn  
 PLOT SCALE : 42.3529 / IN.  
 USER NAME : p1er.somb

ILLINOIS DEPARTMENT OF TRANSPORTATION

**SUMMARY OF QUANTITIES**

F.A.S. ROUTE 294 (OLD U.S. ROUTE 66)  
SECTION 14R2 & 15R1RS-1  
MCLEAN COUNTY  
*Sheet 2 of 2*

SCALE: NOT TO SCALE      DRAWN BY: B.B.P.  
DATE: 08/02/06      CHECKED BY: M.L.B.

F.A.S. RTE.	SECTION	COUNTY	TOTAL SHEETS	SHEET NO.
294	*	MCLEAN	22	6
STA.		TO STA.		
FED. ROAD DIST. NO.	ILLINOIS	FED. AID PROJECT		

BRIDGE OMISSION  
 STA. 2347+68.00 TO STA. 2350+52.00  
 STA. 2369+42.00 TO STA. 2369+68.00  
 STA. 2489+20.00 TO STA. 2491+98.00  
 STA. 2811+28.00 TO STA. 2813+12.00

**EXISTING TYPICAL CROSS SECTION ①**

STATION TO STATION  
 2300+12.00 2628+31.00 ② STATION EQUATION: 2420+56.66 (BACK) = 2420+64.46 (AHEAD)  
 ② 2628+57.00 2987+70.00 STATION EQUATION: 2489+32.83 (BACK) = 2487+74.18 (AHEAD)

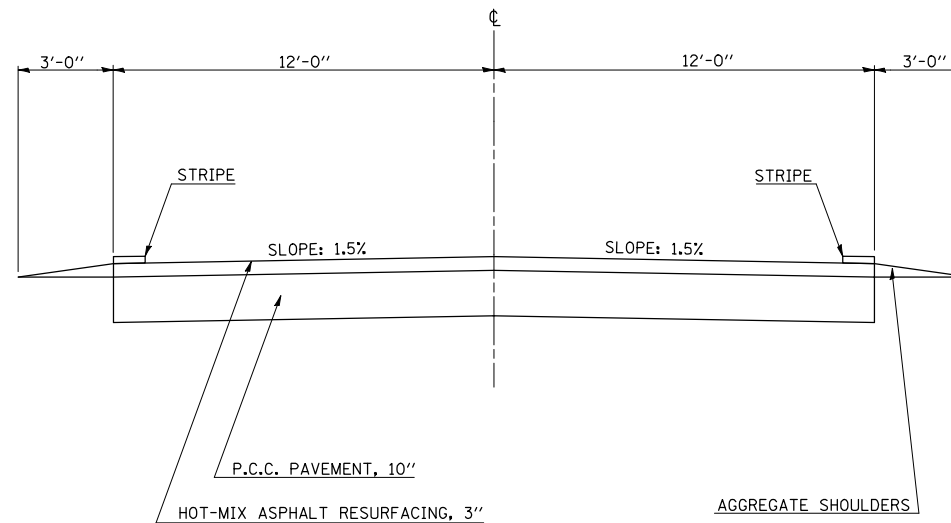

**EXISTING TYPICAL CROSS SECTION ②**

EXISTING STRUCTURE NO. 057-0033

STATION TO STATION  
 ① 2628+31.00 2628+57.00 ①

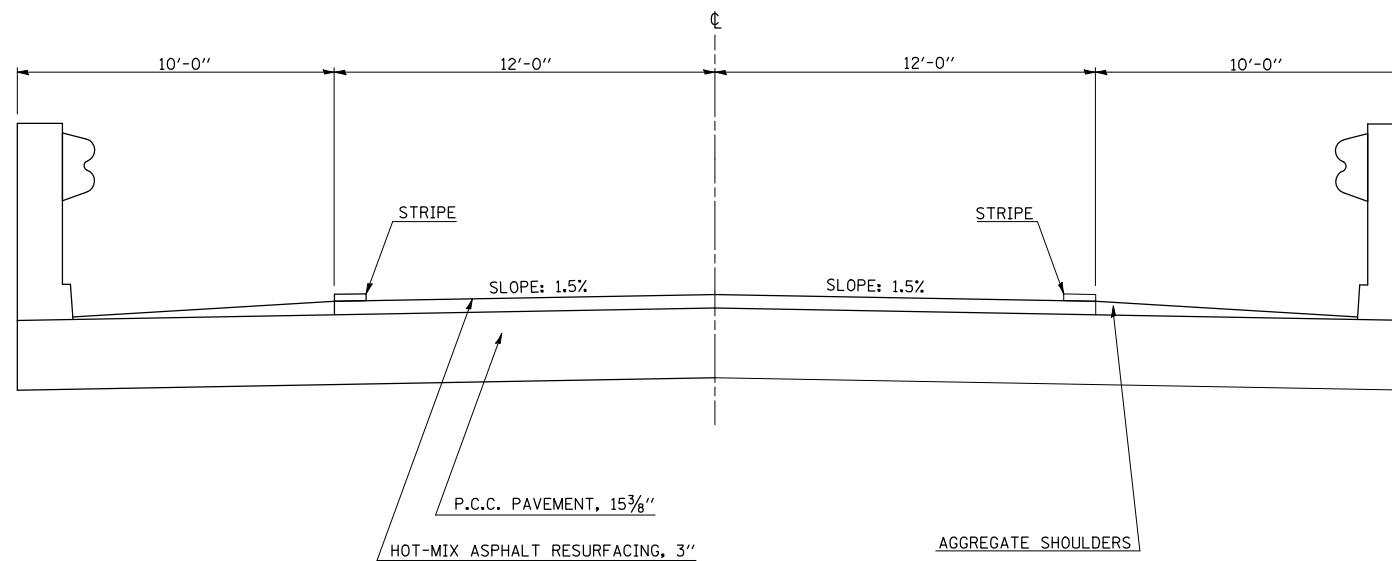

PLOT DATE = 1/14/2009  
 FILE NAME = G:\dwg\work\PIERSONBR\012345\dlisth1.s.dgn  
 USER NAME = piersonbr

ILLINOIS DEPARTMENT OF TRANSPORTATION  
**EXISTING TYPICAL CROSS SECTIONS**  
 F.A.S. ROUTE 294 (OLD U.S. ROUTE 66)  
 SECTION (14R2 & 15R1)RS-1  
 MCLEAN COUNTY  
 SCALE: NOT TO SCALE  
 DATE: 08/03/06  
 DRAWN BY: M.L.B./B.B.P.  
 CHECKED BY: M.L.B.

F.A.S. RTE.	SECTION	COUNTY	TOTAL SHEETS	SHEET NO.
294	*	MCLEAN	22	7
STA.		TO STA.		
FED. ROAD DIST. NO.	ILLINOIS	FED. AID PROJECT		

\*(14R2 & 15R1)RS-1

BRIDGE OMISSION  
 STA. 2347+68.00 TO STA. 2350+52.00  
 STA. 2369+42.00 TO STA. 2369+68.00  
 STA. 2489+20.00 TO STA. 2491+98.00  
 STA. 2811+28.00 TO STA. 2813+12.00

**PROPOSED TYPICAL CROSS SECTION (A)**

STATION	TO	STATION	
2300+12.00		2393+19.82	(B)
(B) 2420+56.66		2421+98.83	(C) STATION EQUATION: 2420+56.66 (BACK) = 2420+64.46 (AHEAD)
(C) 2456+01.74		2460+58.83	(B)
(B) 2485+12.78		2628+31.00	(D) STATION EQUATION: 2489+32.83 (BACK) = 2487+74.18 (AHEAD)
(D) 2628+57.00		2764+55.31	(B)
(B) 2775+13.64		2823+02.50	(B)
(B) 2841+59.05		2843+90.97	(C)
(C) 2880+88.34		2882+77.47	(B)
(B) 2901+47.21		2987+70.00	

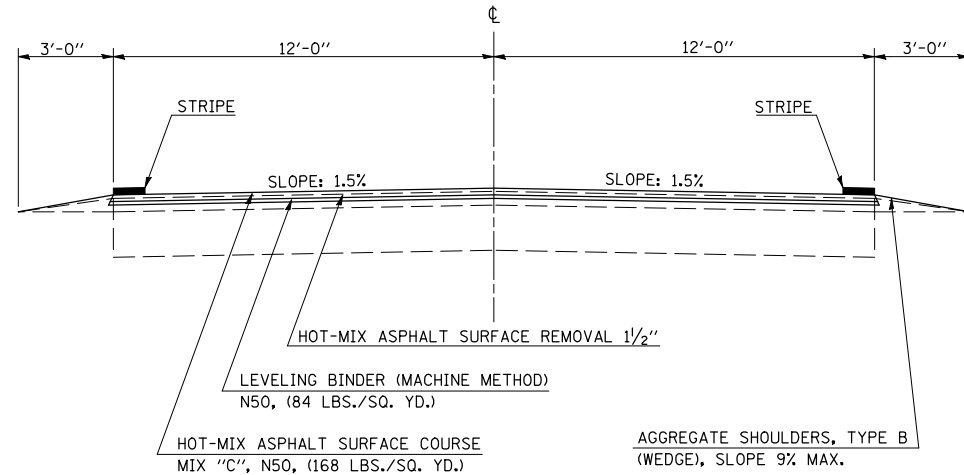

**PROPOSED TYPICAL CROSS SECTION (B)**

STATION	TO	STATION	
(A) 2393+19.82		2420+56.66	(A)
(A) 2460+58.83		2485+12.78	(A)
(A) 2764+55.31		2775+13.64	(A)
(A) 2823+02.50		2841+59.05	(A)
(A) 2882+77.47		2901+47.21	(A)

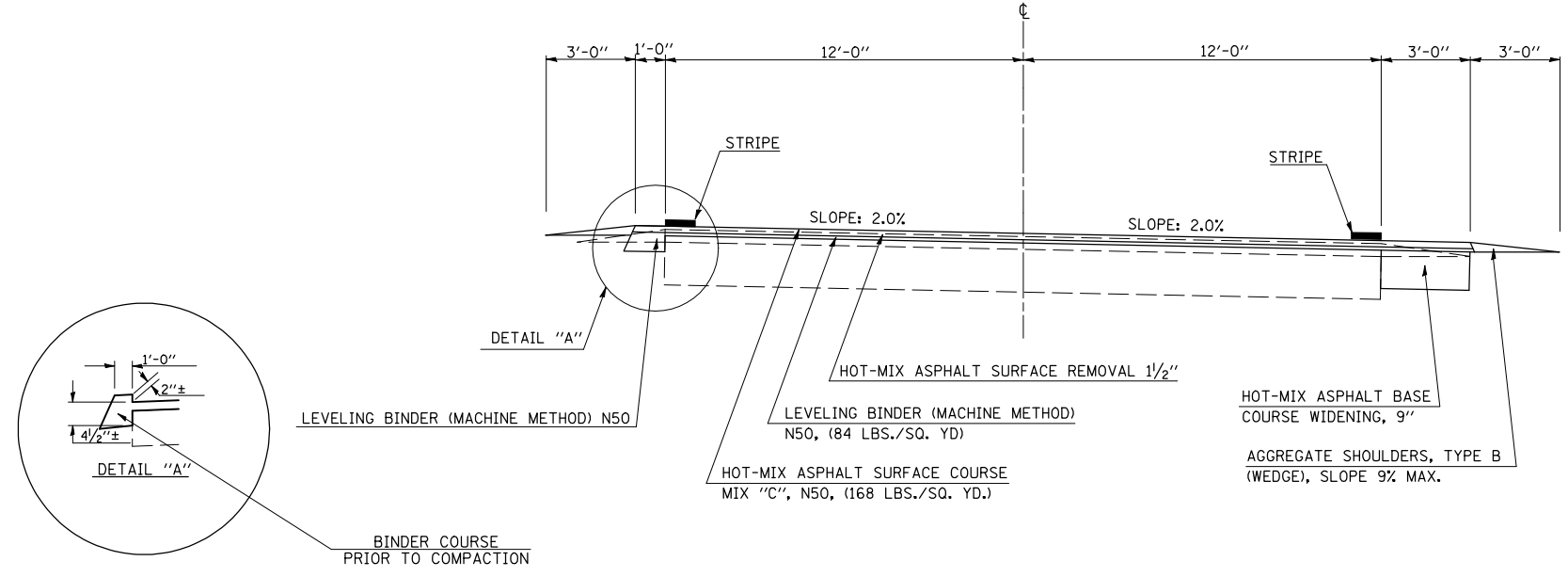

ILLINOIS DEPARTMENT OF TRANSPORTATION  
**PROPOSED TYPICAL CROSS SECTIONS**  
 F.A.S. ROUTE 294 (OLD U.S. ROUTE 66)  
 SECTION (14R2 & 15R1)RS-1  
 MCLEAN COUNTY  
 SCALE: NOT TO SCALE  
 DATE: 08/03/06  
 DRAWN BY: M.L.B./B.B.P.  
 CHECKED BY: M.L.B.

PLOT DATE = 1/14/2009  
 FILE NAME = G:\DW\work\PI\PIWIDOT\PERSONNEL\DO12345\dlisth.tsc.dgn  
 USER NAME = pfersonbr

F.A.S. RTE.	SECTION	COUNTY	TOTAL SHEETS	SHEET NO.
294	*	MCLEAN	22	8
STA.		TO STA.		
FED. ROAD DIST. NO.	ILLINOIS	FED. AID PROJECT		

\*(14R2 & 15R1)RS-1

### PROPOSED TYPICAL CROSS SECTION (C)

STATION TO STATION  
 (A) 2421+98.83 TO 2456+01.74 (A)  
 (A) 2843+90.97 TO 2880+88.34 (A)

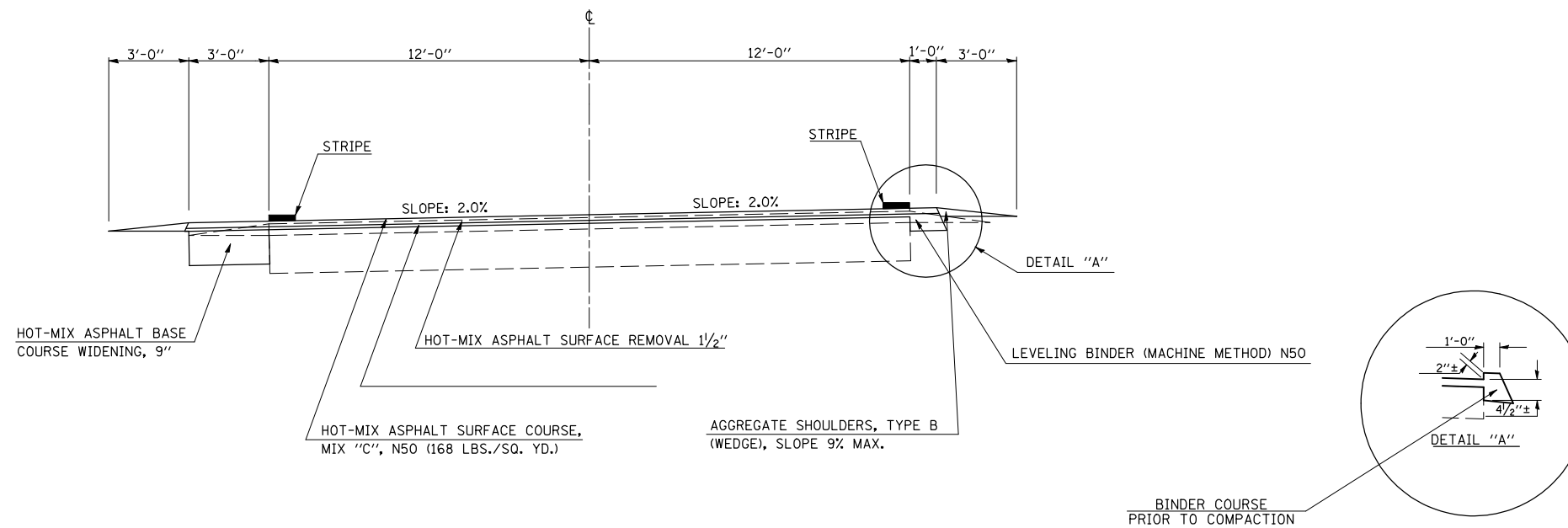

### PROPOSED TYPICAL CROSS SECTION (D)

EXISTING STRUCTURE NO. 057-0033

STATION TO STATION  
 (A) 2628+31.00 TO 2628+57.00 (A)

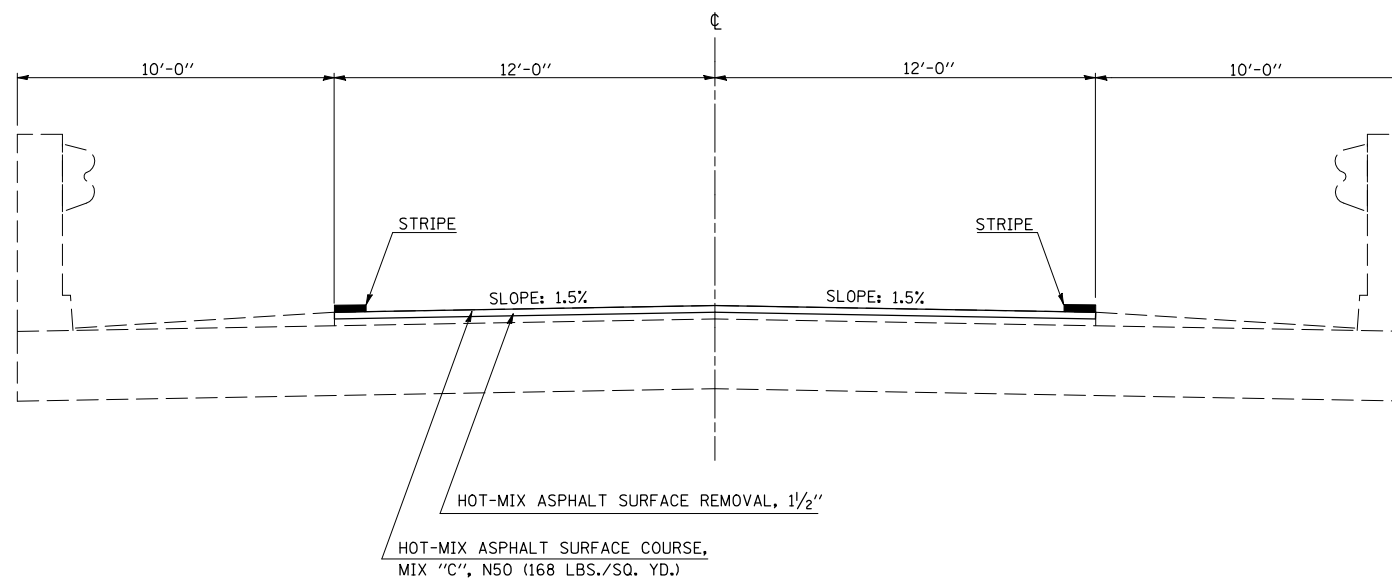

PLOT DATE = 1/14/2009  
 FILE NAME = G:\w\work\PIERSONBR\012345\dlisth.tsdgn  
 USER NAME = piersonbr

ILLINOIS DEPARTMENT OF TRANSPORTATION  
**PROPOSED TYPICAL CROSS SECTIONS**  
 F.A.S. ROUTE 294 (OLD U.S. ROUTE 66)  
 SECTION (14R2 & 15R1)RS-1  
 MCLEAN COUNTY  
 SCALE: NOT TO SCALE  
 DATE: 08/03/06  
 DRAWN BY: M.L.B./B.B.P.  
 CHECKED BY: M.L.B.



F.A.S. RTE.	SECTION	COUNTY	TOTAL SHEETS	SHEET NO.
294	*	MCLEAN	22	9
STA.		TO STA.		
FED. ROAD DIST. NO.	ILLINOIS	FED. AID PROJECT		

# SCHEDULE OF QUANTITIES

## SHEET 1 OF 2

\*(14R2 & 15R1)RS-1

### HOT-MIX ASPHALT SURFACE REMOVAL, 1 1/2" (44000155)

	STATION	TO	STATION	LENGTH (FT)	WIDTH (FT)	AREA (SQ YD)
RURAL	2300+12.00	TO	2347+68.00	4,756.00	24.2	12,788.36
	2350+52.00	TO	2369+42.00	1,890.00	24.2	5,082.00
	2369+68.00	TO	2420+56.66 (BK.)	5,088.66	24.2	13,682.84
	2420+64.46 (AH.)	TO	2489+32.83 (BK.)	6,868.37	24.2	18,468.28
	2487+74.18 (AH.)	TO	2489+20.00	145.82	24.2	392.09
	2491+98.00	TO	2796+56.00	30,458.00	24.2	81,898.18
URBAN	2796+56.00	TO	2811+28.00	1,472.00	24.2	3,958.04
	2813+12.00	TO	2987+70.00	17,458.00	24.2	46,942.62
TOTAL =						183,212.41
USE =						183,213.00

### TABULATION OF CLASS D PATCHING - 13"

TYPE I (SQ YD)	TYPE II (SQ YD)	TYPE III (SQ YD)	TYPE IV (SQ YD)	
44201798	44201803	44201807	44201809	
36.0	2194.0	204.0	212.0	RURAL
14.0	843.0	79.0	82.0	URBAN
50.0	3037.0	283.0	294.0	TOTAL

THE PATCHING QUANTITIES REPRESENT AN ESTIMATE OF CLASS D PATCHING BASED ON 2% OF THE TOTAL SQUARE YARDAGE OF THE PROJECT.

THE FOLLOWING CALCULATIONS REPRESENT THE PATCHING ESTIMATE:

$(68136.9 \text{ FT} \times 24.2 \text{ FT}) / 9 \text{ SQ YD/SQ FT} = 183213 \text{ SQ YD}$

$183213 \times .02 = 3664 \text{ SQ YD}$

BASES ON A PARTIAL PATCHING SURVEY THAT WAS DONE THE FOLLOWING PERCENTAGES ARE WHAT WAS USED FOR THE ESTIMATE OF EACH TYPE OF PATCH.

- 1.37% = TYPE I
- 82.9% = TYPE II
- 7.71% = TYPE III
- 8.02% = TYPE IV

- 44201798 CLASS D PATCH TYPE I, 10" = 3664 SQ YD X 0.0137 = 50 SQ YD
- 44201803 CLASS D PATCH TYPE II, 10" = 3664 SQ YD X 0.829 = 3037 SQ YD
- 44201807 CLADD D PATCH TYPE III, 10" = 3664 SQ YD X 0.0771 = 283 SQ YD
- 44201809 CLASS D PATCH TYPE IV, 10" = 3664 SQ YD X 0.0802 = 294 SQ YD

### SHORT TERM PAVEMENT MARKING (70300100)

YELLOW:		
RURAL	9,841.00 LIN. FT.	LINE 4 INCH
URBAN	3,786.00 LIN. FT.	LINE 4 INCH
TOTAL =		13,627.00 LIN. FT. LINE 4 INCH

### WORK ZONE PAVEMENT MARKING REMOVAL (70301000)

LOCATION		
RURAL	CENTERLINE	1,640.00 SQ FT
URBAN	CENTERLINE	631.00 SQ FT
TOTAL =		2,271.00 SQ FT

### TEMPORARY PAVEMENT MARKING - LINE 4" (70300220)

YELLOW:		
RURAL	13,636.00 LIN. FT.	LINE 4 INCH
URBAN	5,333.00 LIN. FT.	LINE 4 INCH
WHITE:		
RURAL	98,935.00 LIN. FT.	LINE 4 INCH
URBAN	37,860.00 LIN. FT.	LINE 4 INCH
TOTAL =		155,764.00 LIN. FT. LINE 4 INCH

### PAINT PAVEMENT MARKING - LINE 4" (78001110)

YELLOW:		
RURAL	13,636.00 LIN. FT.	LINE 4 INCH
URBAN	5,333.00 LIN. FT.	LINE 4 INCH
WHITE:		
RURAL	98,935.00 LIN. FT.	LINE 4 INCH
URBAN	37,860.00 LIN. FT.	LINE 4 INCH
TOTAL =		155,764.00 LIN. FT. LINE 4 INCH

### THERMOPLASTIC PAVEMENT MARKING

WHITE:		
RURAL	129.00	LIN. FT LINE 4 INCH (78000200)
	70.00	LIN. FT LINE 12 INCH (78000600)
	138.00	LIN. FT LINE 24 INCH (78000650)

### RAISED REFLECTIVE PAVEMENT MARKERS (78100100)

QUANTITY			
	LOCATION	EACH	TYPE
RURAL	CENTERLINE	615.0	AMBER (BIDIRECTIONAL)
URBAN	CENTERLINE	237.0	AMBER (BIDIRECTIONAL)
TOTAL =		852.0	EACH

ILLINOIS DEPARTMENT OF TRANSPORTATION  
**SCHEDULE OF QUANTITIES**  
 F.A.S. ROUTE 294 (OLD U.S. ROUTE 66)  
 SECTION (14R2 & 15R1)RS-1  
 MCLEAN COUNTY  
 Sheet 1 of 2

SCALE: NOT TO SCALE  
 DATE: 08/02/06  
 DRAWN BY: B.B.P.  
 CHECKED BY: M.L.B.

PLOT DATE = 1/14/2009  
 FILE NAME = G:\DW\work\PIPWIDOT\PERSONNEL\DO12345\dlisht.s.dgn  
 USER NAME = pfersonbr

F.A.S. RTE.	SECTION	COUNTY	TOTAL SHEETS	SHEET NO.
294	*	MCLEAN	22	10
STA.		TO STA.		
FED. ROAD DIST. NO.	ILLINOIS	FED. AID PROJECT		

# SCHEDULE OF QUANTITIES

## SHEET 2 OF 2

### INCIDENTAL HOT-MIX ASPHALT SURFACING FAS ROUTE 294 (OLD U. S. ROUTE 66)

\*(14R2 & 15R1)RS-1

STATION	DESCRIPTION	INCIDENTAL AREA (SQ YD)	AVERAGE THICKNESS (INCH)	INCIDENTAL HOT-MIX ASPHALT SURFACING (TON) (40800050)	BIT MAT'L PRIME COAT (GALLONS) (40800010)	AGGREGATE PRIME COAT (TON) (40800040)	HOT-MIX ASPHALT SURFACE REMOVAL (SPECIAL) (SQ YD) (44000196)	NOTE:	
<b>RURAL</b>									
RT. (NORTH OF 2368 + 40)	P. E.	55.3	1.5				55.3	Removing Drive, not placing back.	
LT. 2368+40 (2550E)	S. R.	317.20	1.5	26.64	31.72	0.63	317.2	Remove 30.0' back from e.o.p.	
RT. 2370+70	P. E. / M. B. T.	165.50	1.5	13.90	16.55	0.33	165.5	Remove 41.0' back from e.o.p.	
RT. 2389+16	P. E.	216.70	1.5	18.20	21.67	0.43	216.7	Remove 52.0 back from e.o.p.	
RT. 2400+78	BIKE PATH	11.80	1.5	0.99	1.18	0.02	11.8	Remove 10.0' back from e.o.p.	
LT. 2400+78 (PARK)	C. E.	115.30	1.5	9.69	11.53	0.23	115.3	Remove 30.0' back from e.o.p.	
RT. 2431+06	C. E.	221.40	1.5	18.60	22.14	0.44	221.4	Remove 49.0' back from e.o.p.	
LT. 2451+06	MAIN STREET	546.30	1.5	45.89	54.63	1.09	546.3	Remove 34.0' back from e.o.p.	
RT. 2451+23	MAIN STREET	115.80	1.5	33.78	40.22	0.80	402.2	Remove 58.0' back from e.o.p.	
LT. 2473+83	S. R.	310.10	1.5	26.05	31.01	0.62	310.1	Remove 30.0' back and 10.0 back on bike path from e.o.p.	
RT. 2474+03	S. R.	252.90	1.5	21.02	25.02	0.50	250.2	Remove 54.0' back and 10.0 back on bike path from e.o.p.	
RT/LT 2486+00 TO 2489+20	SHOULDER	213.50	1.0	11.94	10.66	0.21	213.5	Shoulder at S.N. 057-0035	
RT/LT 2491+98 TO 2495+18	SHOULDER	213.50	1.0	11.95	10.67	0.20	213.5	Shoulder at S.N. 057-0035	
RT. 2510+86	P. E.	213.50	1.5	17.93	21.35	0.43	213.5	Remove 54.0' back from e.o.p.	
LT. 2517+61 (2360N)	S. R.	187.60	1.5	15.76	18.76	0.38	187.6	Remove 30.0' back from e.o.p.	
RT. 2518+01 (2360N)	S. R.	206.30	1.5	17.33	20.63	0.41	206.3	Remove 30.0 back from e.o.p.	
LT. 2641+11 (CR 65)	S. R.	154.90	1.5	13.01	15.49	0.31	154.9	Remove 30.0' back from e.o.p.	
LT. 2700+83 (2150E)	S. R.	157.10	1.5	13.20	15.71	0.31	157.1	Remove 30.0' back from e.o.p.	
RT. 2756+50 (2050N)	S. R.	321.60	1.5	27.01	32.16	0.64	321.6	Remove 35.0' back from e.o.p.	
RT. 2770+26 (2050E)	S. R.	149.90	1.5	12.94	15.41	0.31	154.1	Remove 30.0' back from e.o.p.	
RT. 2786+87	P. E.	259.80	1.5	21.82	25.98	0.52	259.8	Remove 70.0' back from e.o.p.	
<b>URBAN</b>									
RT. 2804+20	P. E.	244.20	1.5	20.51	24.42	0.49	244.2	Remove 70.0' back from e.o.p.	
LT. 2833+76 (1960 E)	S. R.	199.40	1.5	16.75	19.94	0.40	199.4	Remove 30.0' back from e.o.p.	
RT. 2833+76 (1960 E)	S. R.	205.80	1.5	17.29	20.58	0.41	205.8	Remove 40.0' back from e.o.p.	
LT. 2858+22	JEFFERSON ST	263.00	1.5	23.44	27.91	0.56	279.1	Remove 30.0' back from e.o.p.	
RT. 2858+22	JEFFERSON ST	440.60	1.5	37.01	44.06	0.88	440.6	Remove 75.0' back from e.o.p.	
LT. 2871+39	MONROE ST	251.10	1.5	20.58	24.50	0.49	245.0	Remove 55.0' back from e.o.p.	
RT. 2871+39	MONROE ST	279.30	1.5	23.46	27.93	0.56	279.3	Remove 30.0' back from e.o.p.	
RT. 2897+81	C. E.	187.60	1.5	15.76	18.76	0.38	187.6	Remove 40.0' back from e.o.p.	
LT. 2897+81	C. E.	204.30	1.5	17.16	20.43	0.41	204.3	Remove 30.0' back from e.o.p.	
RT. 2906+40	C. E.	280.80	1.5	22.64	26.95	0.54	269.5	Remove 34.0' back from e.o.p.	
LT. 2959+68	AIRPORT RD	303.3	1.5	25.48	30.33	0.61	303.3	Remove 30.0' back from e.o.p.	
				TOTAL =	617.73 TONS	728.30 GAL	14.57 TONS	7,552.0 SQ YD	
				USE =	618.0 TONS	728.0 GAL	15.0 TONS	7,552.0 SQ YD	

P. E. = PRIVATE ENTRANCE  
S. R. = SIDE ROAD  
M. B. T. = MAIL BOX TURN-OUT  
C. E. = COMMERCIAL ENTRANCE

### EARTHWORK

	LOCATION			EARTH EXCAVATION (WIDENING) (20200500)	EARTH EXCAVATION EMBANKMENT ADJUSTED FOR SHRINKAGE (25%)	EMBANKMENT	EARTHWORK BALANCE WASTE (+) OR SHORTAGE (-)
	STATION	TO	STATION	CU YD	CU YD	CU YD	CU YD
RURAL	O. R. 66	2393+19.82	2420+56.66	310.4	232.8	0.00	+232.8
	O. R. 66	2421+98.83	2456+01.74	386.0	289.5	0.00	+289.5
	O. R. 66	2460+58.83	2485+12.78	278.3	208.7	0.00	+208.7
URBAN	O. R. 66	2764+55.31	2775+13.64	120.0	90.0	0.00	+90.0
	O. R. 66	2823+02.50	2841+59.05	210.6	158.0	0.00	+158.0
	O. R. 66	2843+90.97	2880+88.34	419.4	314.6	0.00	+314.6
	O. R. 66	2882+77.47	2901+47.21	212.1	159.1	0.00	+159.1
TOTALS				1,936.80	1,452.70	0.00	+1452.7

ILLINOIS DEPARTMENT OF TRANSPORTATION  
**SCHEDULE OF QUANTITIES**  
F.A.S. ROUTE 294 (OLD U.S. ROUTE 66)  
SECTION (14R2 & 15R1)RS-1  
MCLEAN COUNTY  
Sheet 2 of 2

SCALE: NOT TO SCALE  
DATE: 08/02/06  
DRAWN BY: B.B.P.  
CHECKED BY: M.L.B.

F.A.S. RTE.	SECTION	COUNTY	TOTAL SHEETS	SHEET NO.
294	*	MCLEAN	22	11
STA. 294		TO STA.		
FED. ROAD DIST. NO.	ILLINOIS	FED. AID PROJECT		

\*(14R2 & 15R1)RS-1

### HOT-MIX ASPHALT SURFACE REMOVAL DETAIL AT BEGINNING OF PROJECT STATION 2300+12.00

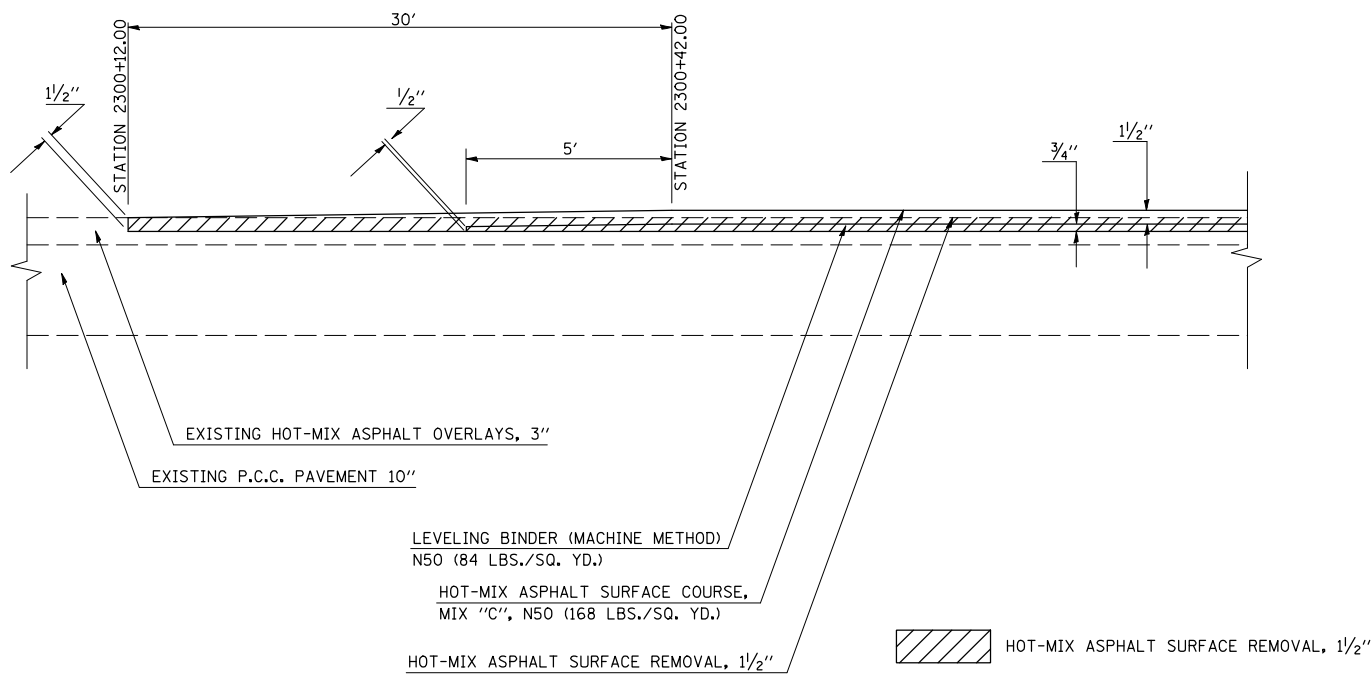

### HOT-MIX ASPHALT SURFACE REMOVAL DETAIL AT END OF PROJECT STATION 2987+70.00

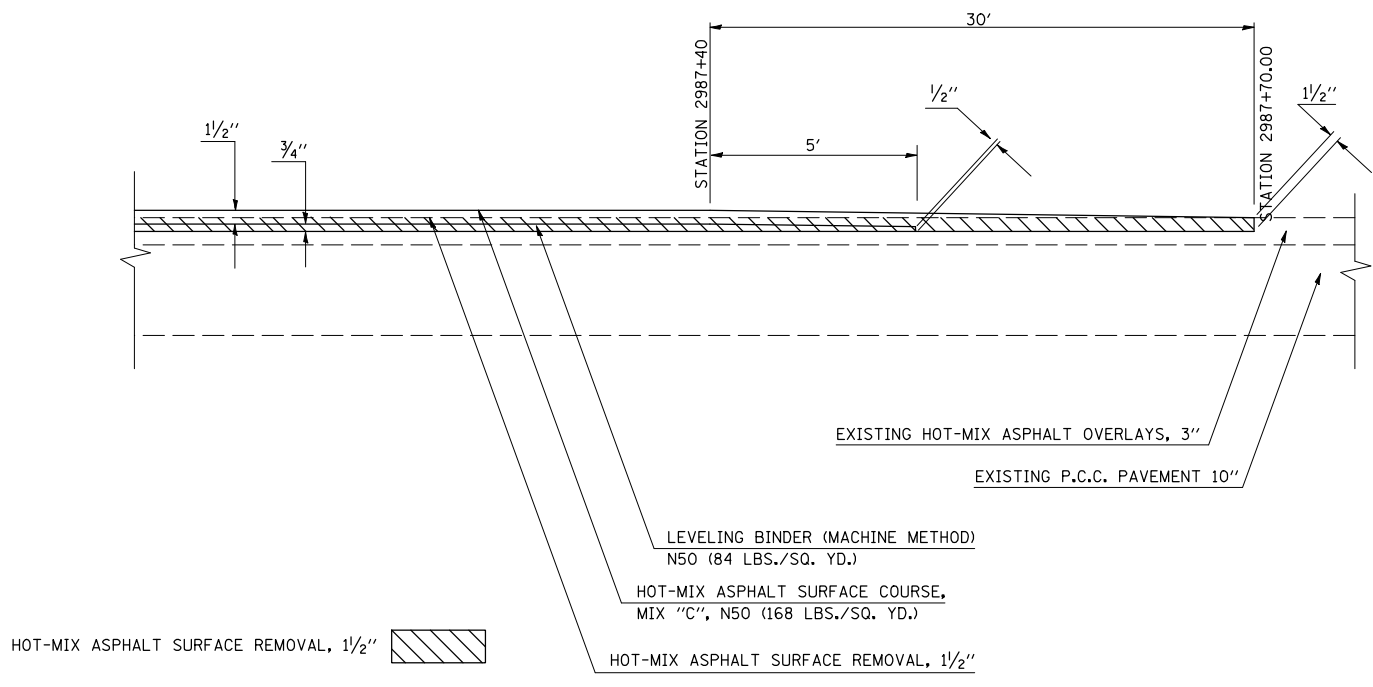

### HOT-MIX ASPHALT SURFACE REMOVAL DETAIL AT STRUCTURE NO. 057-0039 STATION 2349+10.00

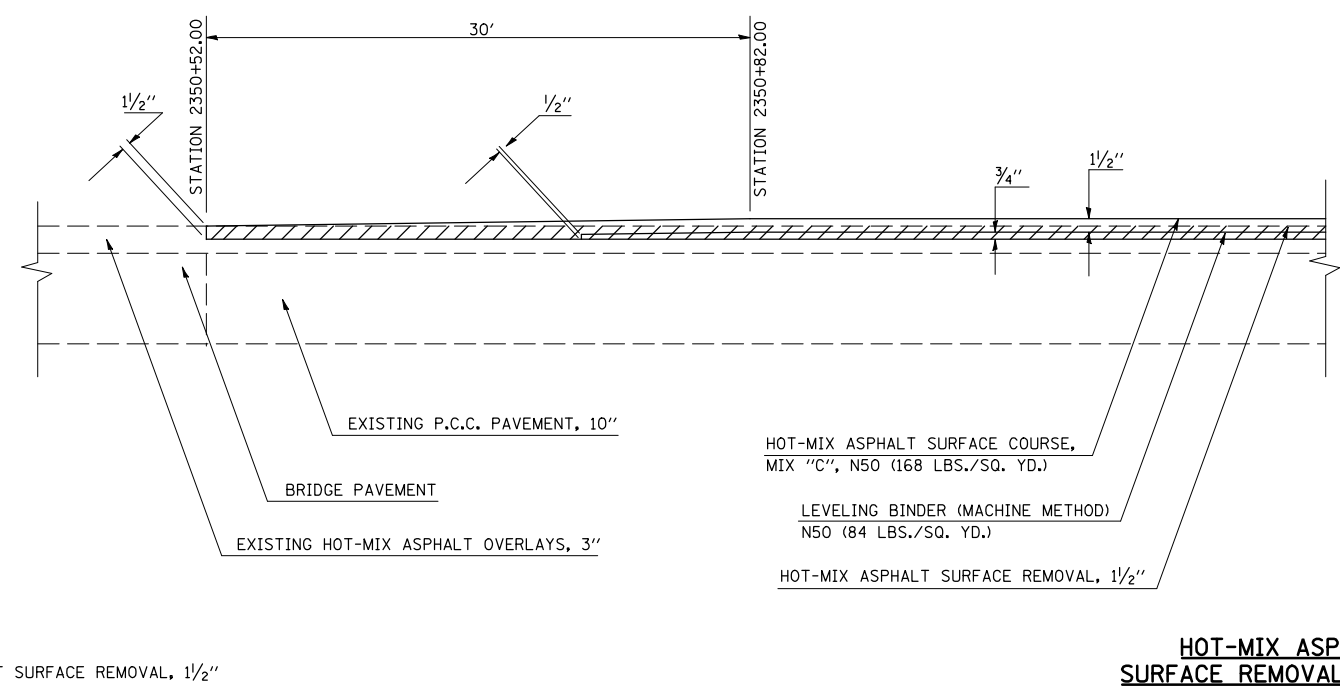
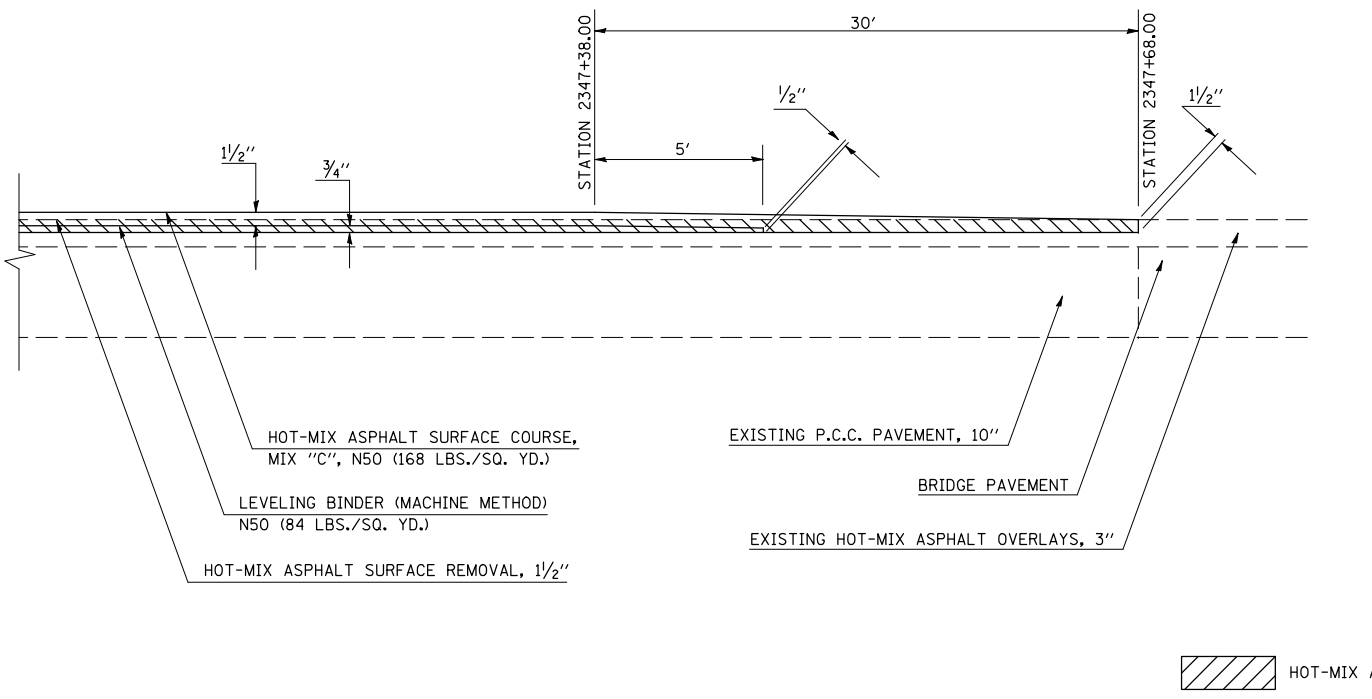

HOT-MIX ASPHALT SURFACE REMOVAL, 1 1/2"

HOT-MIX ASPHALT SURFACE REMOVAL DETAILS

PLOT DATE = 1/14/2009  
FILE NAME = G:\work\K\PIWIDOT\PIERSONBR\012345\alish1.s.dgn  
USER NAME = piersonbr

F.A.S. RTE.	SECTION	COUNTY	TOTAL SHEETS	SHEET NO.
294	*	MCLEAN	22	12
STA.		TO STA.		
FED. ROAD DIST. NO.	ILLINOIS	FED. AID PROJECT		

\*(14R2 & 15R1)RS-1

## HOT-MIX ASPHALT SURFACE REMOVAL DETAIL AT STRUCTURE NO. 057-0037 STATION 2369 + 55.00

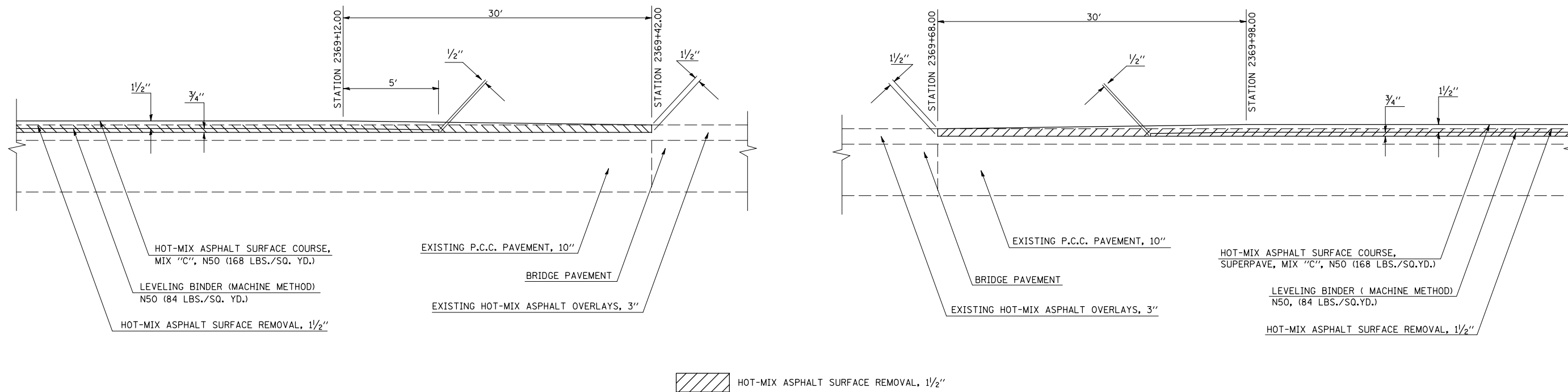

## HOT-MIX ASPHALT SURFACE REMOVAL DETAIL AT STRUCTURE NO. 057-0035 STATION 2490 + 58.70

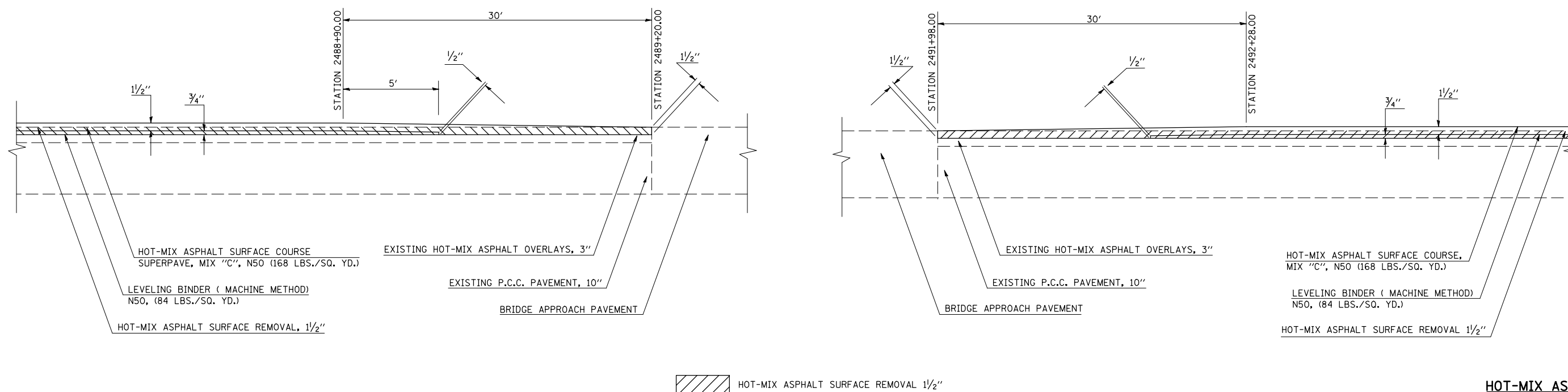

**HOT-MIX ASPHALT  
SURFACE REMOVAL DETAILS**

PLOT DATE = 1/14/2009  
 FILE NAME = G:\w\work\PI\PIWIDOT\PIERSONBR\012345\dlisth1.s.dgn  
 USER NAME = piersonbr

F.A.S. RTE.	SECTION	COUNTY	TOTAL SHEETS	SHEET NO.
294	*	MCLEAN	22	13
STA.		TO STA.		
FED. ROAD DIST. NO.	ILLINOIS	FED. AID PROJECT		

\*(14R2 & 15R1)RS-1

## HOT-MIX ASPHALT SURFACE REMOVAL DETAIL AT STRUCTURE NO. 057-0033 STATION 2628 + 44.00

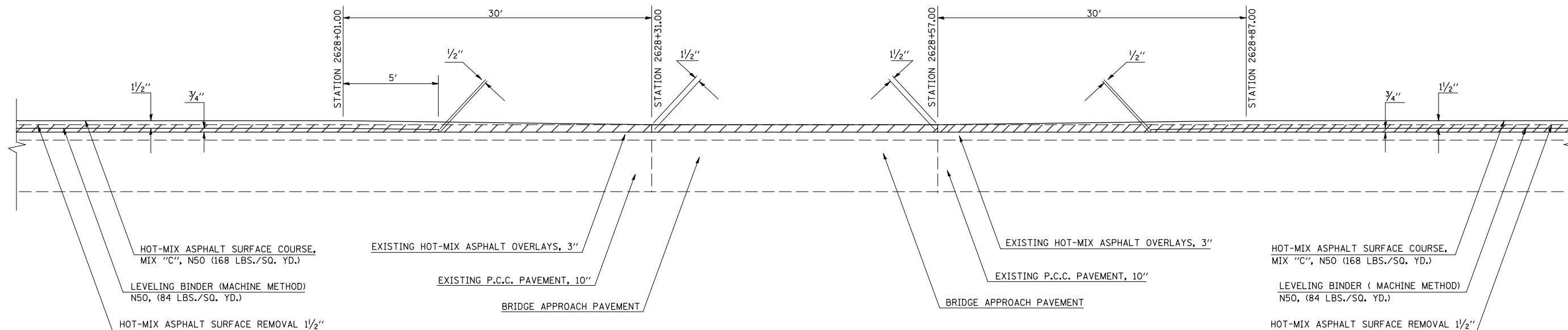

HOT-MIX ASPHALT SURFACE COURSE, MIX "C", N50 (168 LBS./SQ. YD.)  
LEVELING BINDER (MACHINE METHOD) N50, (84 LBS./SQ. YD.)  
HOT-MIX ASPHALT SURFACE REMOVAL 1/2"

EXISTING HOT-MIX ASPHALT OVERLAYS, 3"  
EXISTING P.C.C. PAVEMENT, 10"  
BRIDGE APPROACH PAVEMENT

EXISTING HOT-MIX ASPHALT OVERLAYS, 3"  
EXISTING P.C.C. PAVEMENT, 10"  
BRIDGE APPROACH PAVEMENT

HOT-MIX ASPHALT SURFACE COURSE, MIX "C", N50 (168 LBS./SQ. YD.)  
LEVELING BINDER (MACHINE METHOD) N50, (84 LBS./SQ. YD.)  
HOT-MIX ASPHALT SURFACE REMOVAL 1/2"

HOT-MIX ASPHALT SURFACE REMOVAL 1/2"

BILL OF MATERIALS FOR: SN 057-0033  
HMA SURFACE REMOVAL = 70 SQ YD  
HMA SURFACE COURSE, MIX "C" = 6.0 TON

## HOT-MIX ASPHALT SURFACE REMOVAL DETAIL AT STRUCTURE NO. 057-0239 STATION 2812 + 20.00

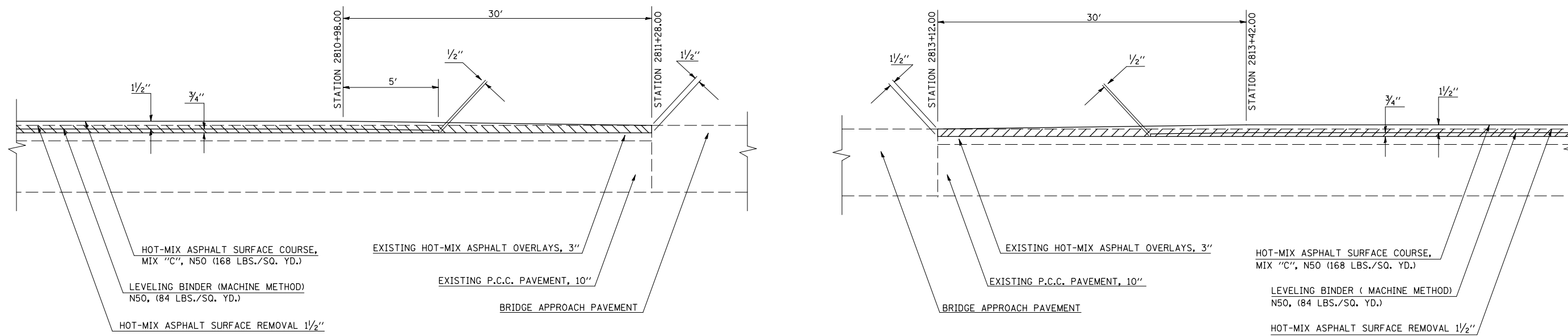

HOT-MIX ASPHALT SURFACE COURSE, MIX "C", N50 (168 LBS./SQ. YD.)  
LEVELING BINDER (MACHINE METHOD) N50, (84 LBS./SQ. YD.)  
HOT-MIX ASPHALT SURFACE REMOVAL 1/2"

EXISTING HOT-MIX ASPHALT OVERLAYS, 3"  
EXISTING P.C.C. PAVEMENT, 10"  
BRIDGE APPROACH PAVEMENT

EXISTING HOT-MIX ASPHALT OVERLAYS, 3"  
EXISTING P.C.C. PAVEMENT, 10"  
BRIDGE APPROACH PAVEMENT

HOT-MIX ASPHALT SURFACE COURSE, MIX "C", N50 (168 LBS./SQ. YD.)  
LEVELING BINDER (MACHINE METHOD) N50, (84 LBS./SQ. YD.)  
HOT-MIX ASPHALT SURFACE REMOVAL 1/2"

HOT-MIX ASPHALT SURFACE REMOVAL 1/2"

**HOT-MIX ASPHALT  
SURFACE REMOVAL DETAILS**

PLOT DATE = 1/14/2009  
 FILE NAME = G:\work\K\P\WIDOT\PIERSONBR\012345\dlisth.s.dgn  
 USER NAME = piersonbr

F.A.S. RTE.	SECTION	COUNTY	TOTAL SHEETS	SHEET NO.
294	*	MCLEAN	22	14
STA.		TO STA.		
FED. ROAD DIST. NO.	ILLINOIS	FED. AID PROJECT		

\*(14R2 & 15R1)RS-1

### TYPICAL DETAIL OF RURAL PRIVATE AND COMMERCIAL ENTRANCES

(HOT-MIX ASPHALT OR OIL & CHIP)

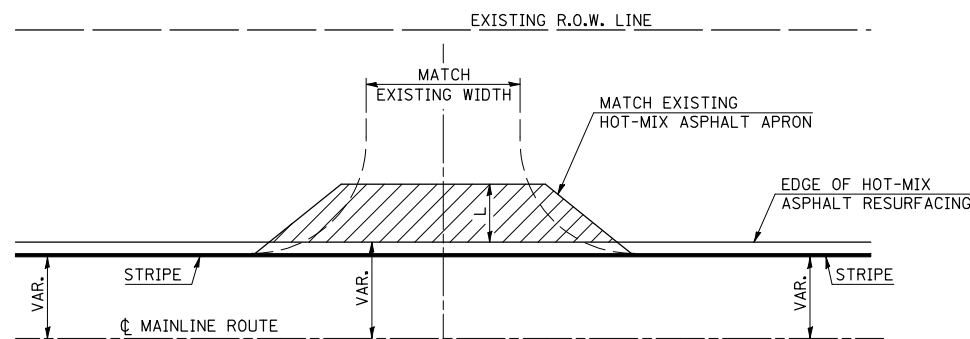

PLAN

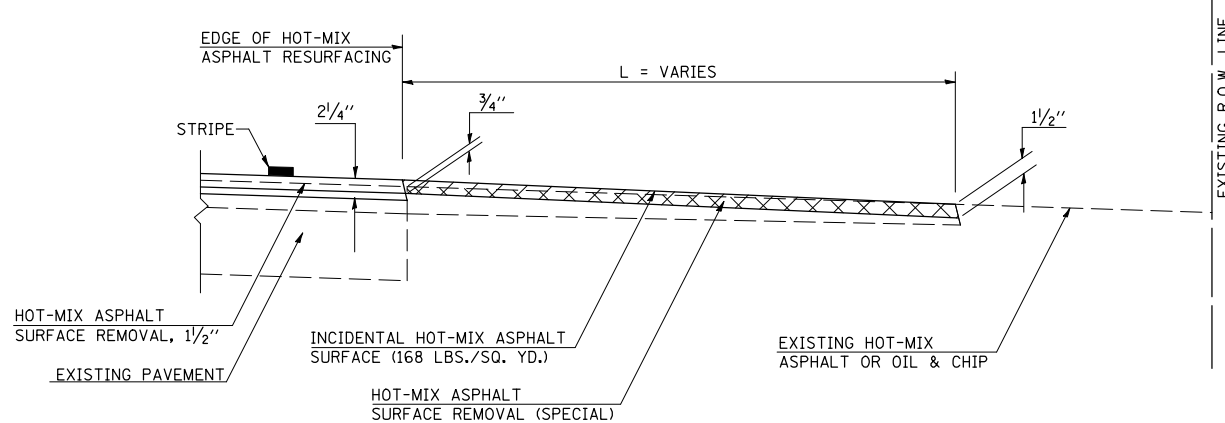

PROFILE

#### GENERAL NOTES

1. THE EXISTING SURFACE SHALL BE PREPARED IN ACCORDANCE WITH SECTION 408 OF THE STANDARD SPECIFICATIONS.
2. THE INCIDENTAL HOT-MIX ASPHALT SURFACING IS INTENDED TO RESURFACE THE EXISTING ENTRANCES IN THEIR ENTIRETY.
3. ANY NECESSARY WORK BEHIND THE INCIDENTAL HOT-MIX ASPHALT SURFACING SHALL BE AS SHOWN IN THE PLANS AND/OR AS DIRECTED BY THE ENGINEER.

### DETAIL OF SIDEROAD RETURNS

(RURAL SECTION WITH HOT-MIX ASPHALT OR OIL & CHIP)

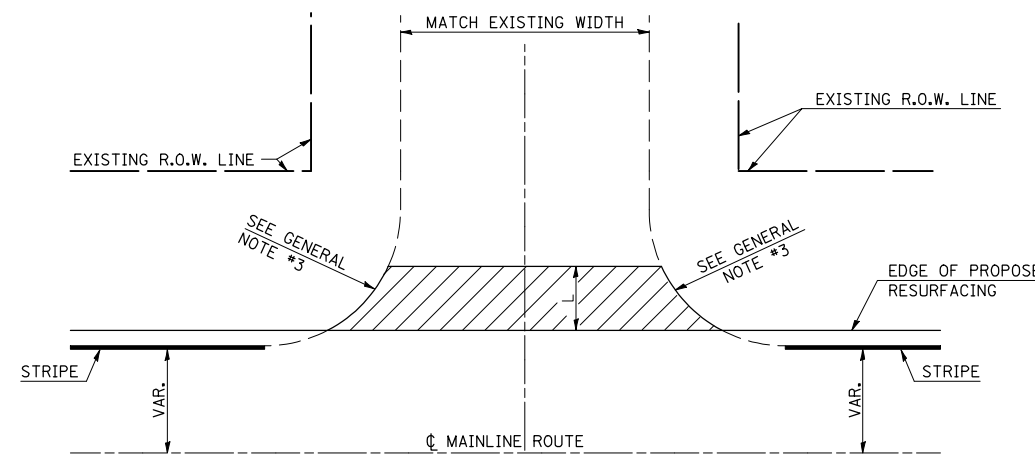

PLAN

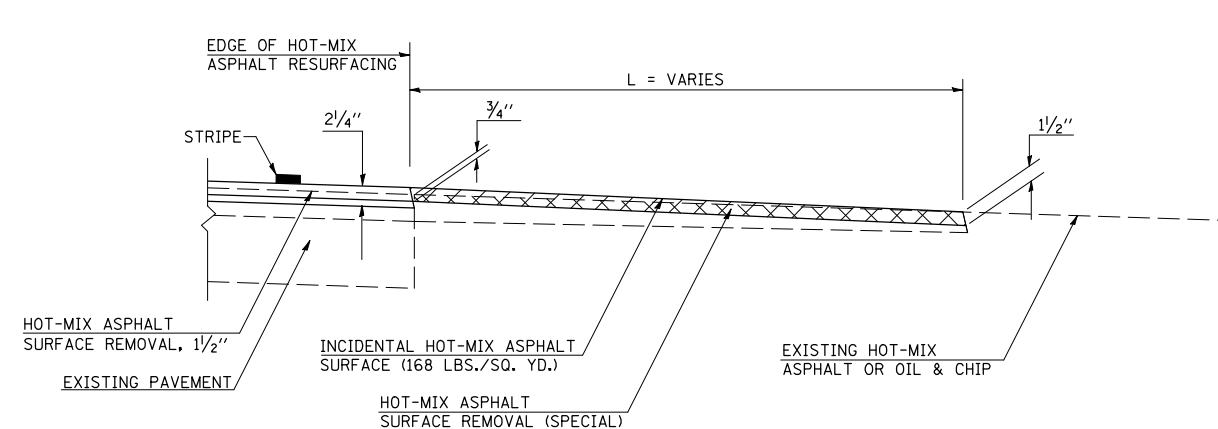

PROFILE

#### GENERAL NOTES

1. THE EXISTING SURFACE SHALL BE PREPARED IN ACCORDANCE WITH SECTION 408 OF THE STANDARD SPECIFICATIONS.
2. THE INCIDENTAL HOT-MIX ASPHALT SURFACING IS INTENDED TO RESURFACE THE EXISTING SIDEROAD TO VARIOUS LENGTHS FROM THE EDGE OF PROPOSED RESURFACING.
3. THE INCIDENTAL HOT-MIX ASPHALT SURFACING SHALL MATCH THE EXISTING RADIUS.

ILLINOIS DEPARTMENT OF TRANSPORTATION  
**RURAL PRIVATE & COMMERCIAL**  
**ENTRANCES/SIDEROAD RETURN DETAILS**  
 F.A.S. ROUTE 294 (OLD U.S. ROUTE 66)  
 SECTION (14R2 & 15R1)RS-1  
 MCLEAN COUNTY  
 SCALE: NOT TO SCALE DRAWN BY: M.L.B.  
 DATE: 08/03/06 CHECKED BY: M.L.B.

PLOT DATE = 1/14/2009  
 FILE NAME = G:\p\_w\work\PIERSONBR\DOT\PIERSONBR\012345\dlisth1.s.dgn  
 USER NAME = piersonbr

F.A.S. RTE.	SECTION	COUNTY	TOTAL SHEETS	SHEET NO.
294	.	MCLEAN	22	15

**PROJECTS WITHOUT RECONSTRUCTION**

**S.M.A.R.T. IMPROVEMENTS**  
(POLICY RESURFACING; BDE 53-4.03; 1 1/2")

**"3P" OR "3R" IMPROVEMENTS**  
(POLICY RESURFACING; BDE 53-4.02; 2 1/4" OR 2 1/2" ON BARE CONCRETE)

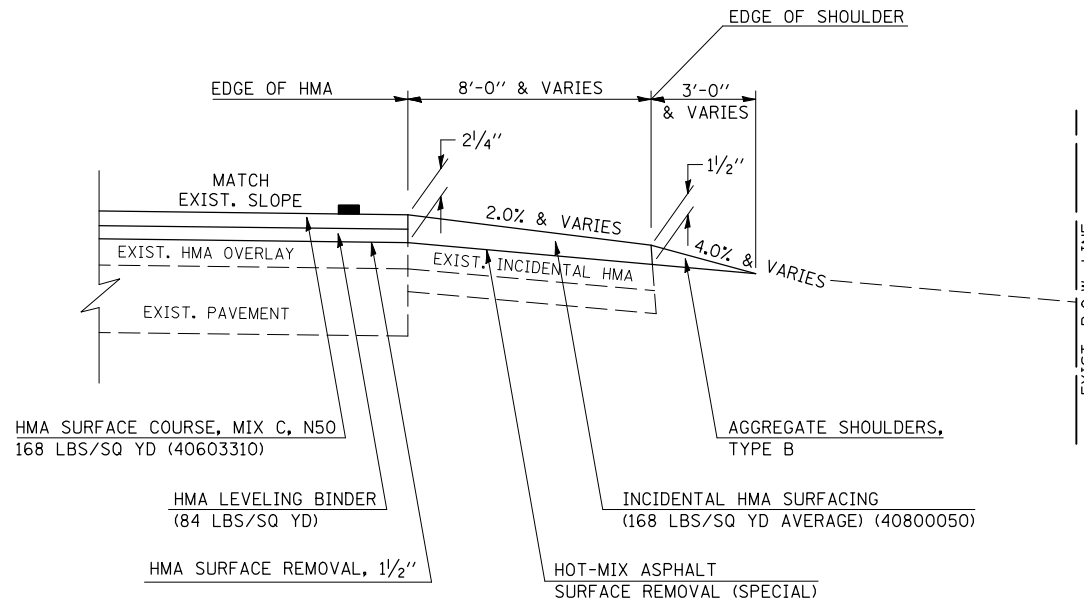
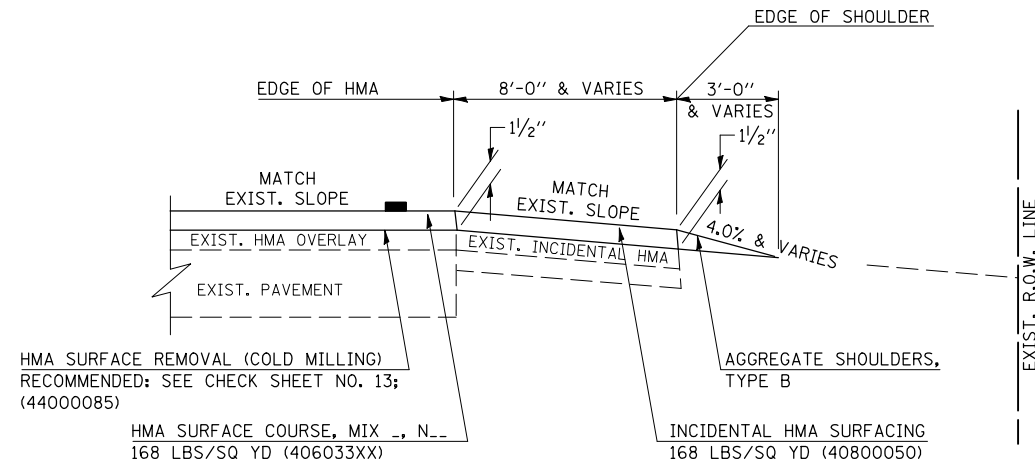

**GENERAL NOTES**

1. THE EXISTING SURFACE SHALL BE PREPARED IN ACCORDANCE WITH SECTION 408 OF THE STANDARD SPECIFICATIONS.
2. AGGREGATE BASE COURSE, TYPE B, 6" (150) MIN. SHALL BE USED WHERE IN THE OPINION OF THE ENGINEER THERE IS NOT SUFFICIENT BASE MATERIAL FOR THE PROPOSED MAILBOX TURNOUTS. THIS MATERIAL SHALL GENERALLY BE USED TO WIDEN ALL EXISTING MAILBOX TURNOUTS OR TO CONSTRUCT NEW MAILBOX TURNOUTS WHERE NONE NOW EXISTS.
3. ANY NECESSARY WORK BEHIND THE INCIDENTAL HMA SURFACING SHALL BE AS SHOWN IN THE PLANS AND/OR AS DIRECTED BY THE ENGINEER.
4. THE TEMPORARY RELOCATION OF EXISTING MAILBOXES SHALL BE IN ACCORDANCE WITH ARTICLE 107.20 OF THE STANDARD SPECIFICATIONS.
5. WHEN MORE THAN ONE RELOCATED MAILBOX IS INCLUDED IN A PARTICULAR LOCATION THE TWO 10' (3 m) DIMENSIONS AS SHOWN ABOVE SHALL BE FROM THE END MAILBOX.
6. CROSS SLOPE SHALL BE AS SHOWN ON THE STATION CROSS SECTIONS AND/OR AS DIRECTED BY THE ENGINEER. MINIMUM 4% (1/2"/') DESIRABLE; MAXIMUM 8% (1"/')
7. WHEN MAILBOX TURNOUTS ARE CONSTRUCTED ADJACENT TO FIELD ENTRANCES, THE WIDTH OF THE INCIDENTAL HMA SURFACING CONSTRUCTED FOR THE FIELD ENTRANCE SHALL MATCH THE WIDTH OF THE PROPOSED MAILBOX TURNOUT SURFACING.
8. THE TOTAL SHOULDER WIDTH, 2.4 m (8') MINIMUM, SHALL BE PAVED BETWEEN SIDEROADS ENTRANCES AND/OR MAILBOX TURNOUTS AT LOCATIONS WHERE THE DISTANCE BETWEEN RADIUS OR TAPER CONTROL POINTS IS LESS THAN 15.0 m (50').
9. MAILBOXES SHALL BE MOUNTED SUCH THAT THE FACE OF THE MAILBOX IS 6" (150 mm) TO 12" (300 mm) AND THE POST A MINIMUM OF 24" (600 mm) FROM THE EDGE OF THE TURNOUT SURFACING.

**PROJECTS WITH RECONSTRUCTION**

( "3R" IMPROVEMENTS )

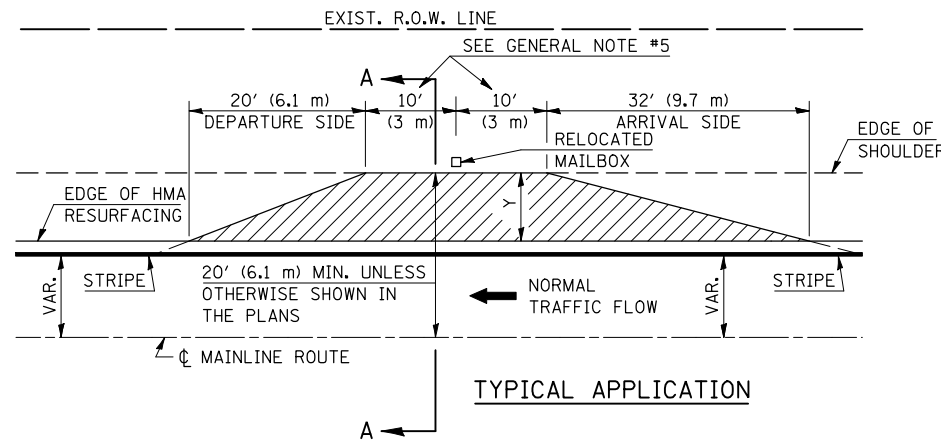

WIDTH OF SHOULDER	4'-0" - 8'-0" (1.2 m - 2.4 m)	10'-0" (3.0 m)
WIDTH OF TURNOUT "Y"	8'-0" (2.4 m)	8'-0" - 10'-0" (2.4 m - 3.0 m)

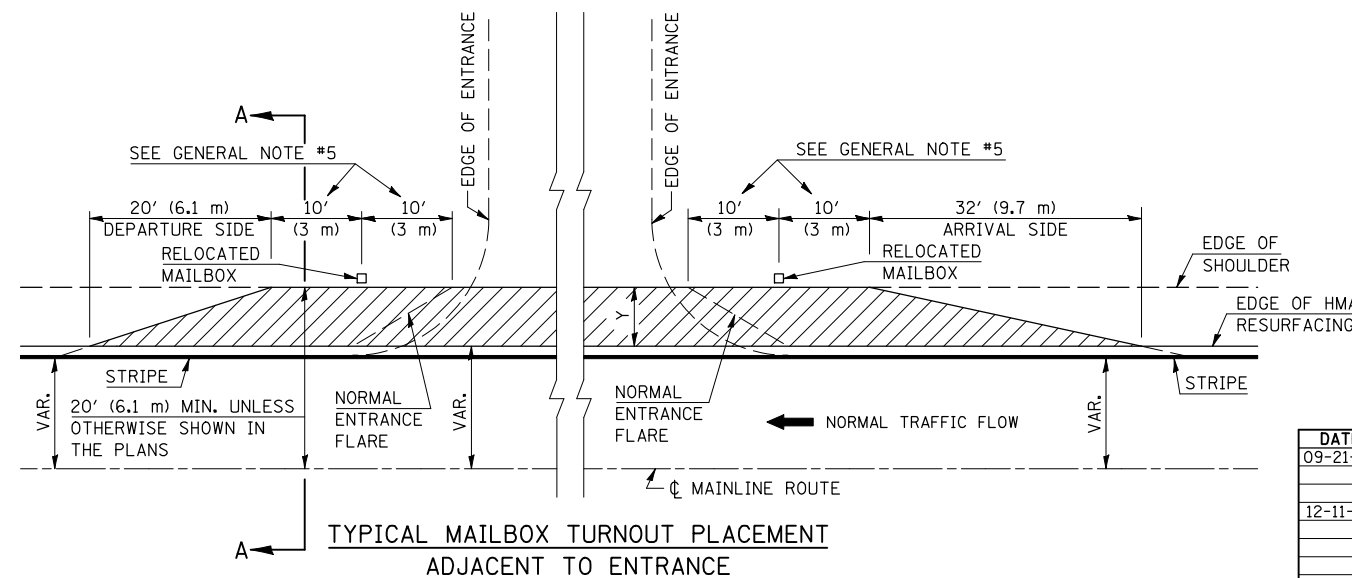
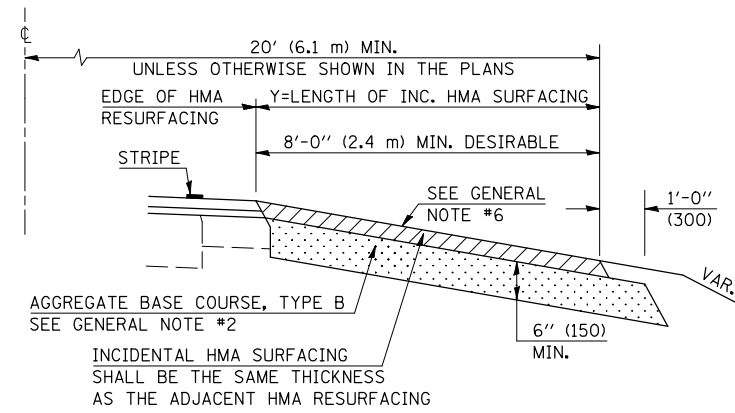

Note: All dimensions are in INCHES (millimeters) unless otherwise shown.

DATE	REVISIONS	NAME	ILLINOIS DEPARTMENT OF TRANSPORTATION
09-21-07	WIDTH CHANGE ARRIVAL SIDE AND VAR. CORRECTIONS	K.A.G.	<b>MAILBOX TURNOUT (RURAL)</b>
12-11-06	RENUMBERED/COMBINED C-1.25 WITH ADDITIONS OF S.M.A.R.T & 3P & 3R IMPROVEMENTS	T.J.B.	

F.A.S. RTE.	SECTION	COUNTY	TOTAL SHEETS	SHEET NO.
294	*	MCLEAN	22	16

STA.	TO STA.
FED. ROAD DIST. NO.	ILLINOIS FED. AID PROJECT

\*(14R2 & 15R1)RS-1

# OLD U.S. ROUTE 66 & MAIN ST. INTERSECTION IN LEXINGTON

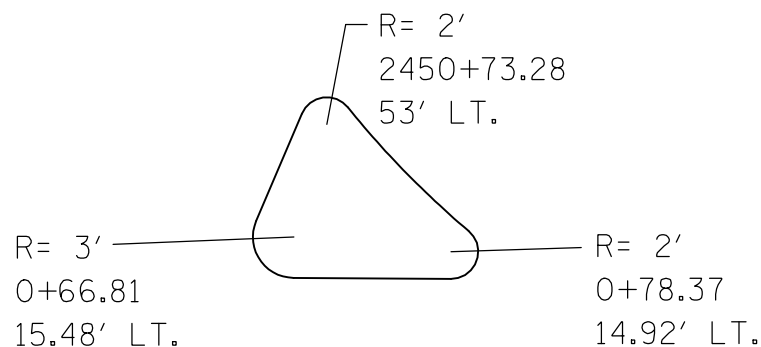

DETAIL OF CONCRETE  
MEDIAN TYPE SM-6 DOWELLED

F.A.S. 294 STA. 2451+25.54 =  
MAIN ST. (LT.) STA. 0+00.00

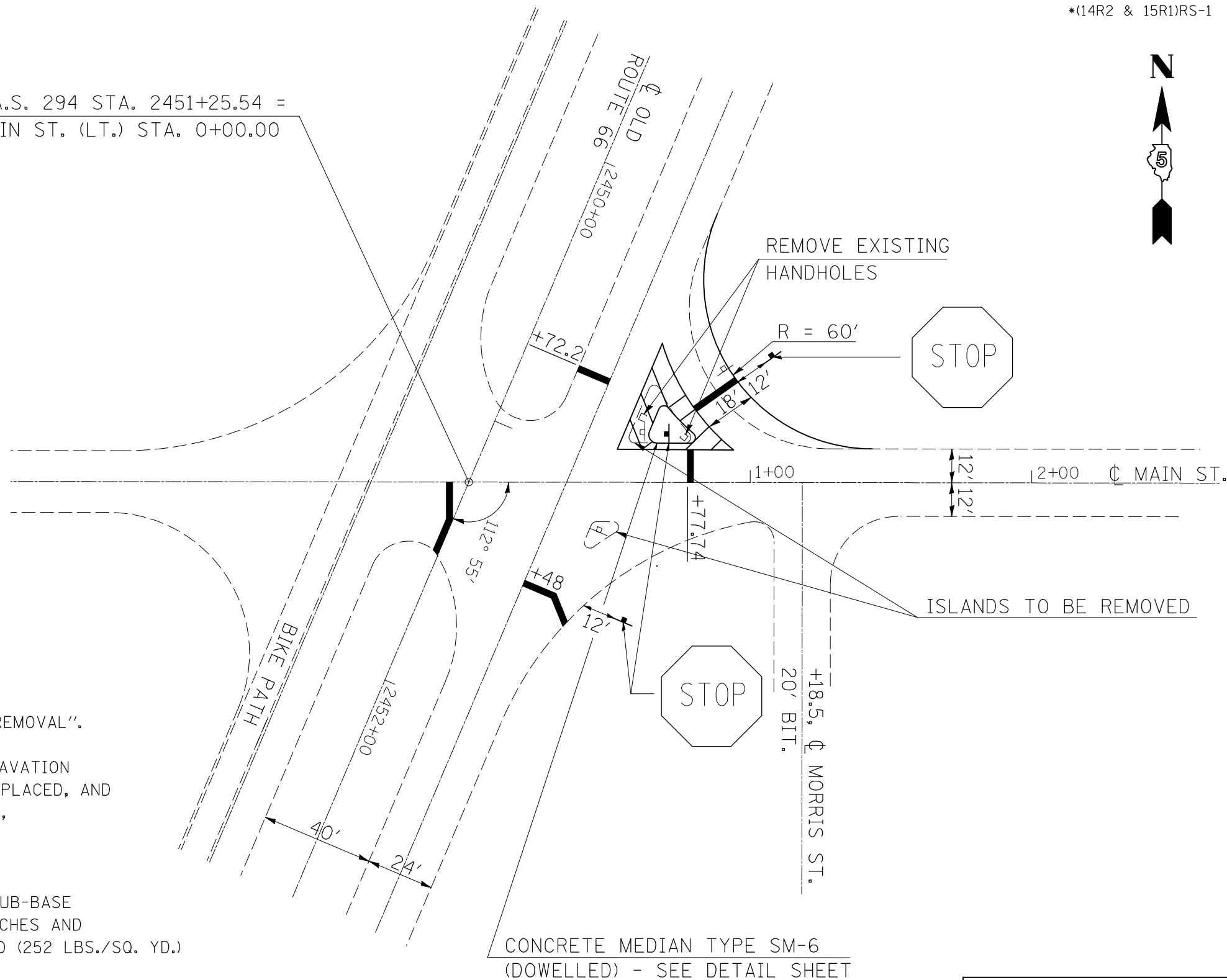

GENERAL NOTES

1. REMOVAL OF EXISTING ISLANDS WILL BE PAID FOR AS "ISLAND REMOVAL".
2. THE WIDENING OF THE RADIUS WILL BE PAID FOR AS EARTH EXCAVATION (WIDENING), WITH HMA BASE COURSE WIDENING, 9 INCHES BEING PLACED, AND ON TOP OF THAT WILL BE LEVELING BINDER (HAND METHOD), N50 (84 LBS./SQ. YD.) & HOT-MIX ASPHALT SURFACE COURSE, MIX "C", N50 (168 LBS./SQ. YD.).
3. THE EXISTING ISLANDS WILL BE REMOVED AND REPLACED WITH SUB-BASE GRANULAR MATERIAL, TYPE B 4", WITH PCC BASE COURSE 10 INCHES AND ON TOP OF THAT WILL BE LEVELING BINDER (HAND METHOD), N50 (252 LBS./SQ. YD.) & HOT-MIX ASPHALT SURFACE COURSE, SUPERPAVE, MIX "C", N50 (168 LBS./SQ. YD.).
4. THE REMOVAL & REPLACEMENT OF THE EXISTING STOP SIGNS AND POSTS WILL BE INCIDENTAL TO THE CONCRETE MEDIAN, TYPE SM-6 DOWELLED.

CONCRETE MEDIAN TYPE SM-6  
(DOWELLED) - SEE DETAIL SHEET

PLOT DATE = 1/14/2009  
FILE NAME = G:\DW\work\PIERSONBR\PIERSONBR.d012345\dlist1.s.dgn  
USER NAME = pier\_sonbr

ILLINOIS DEPARTMENT OF TRANSPORTATION  
**DETAIL: OLD ROUTE 66 & MAIN ST.  
INTERSECTION IN LEXINGTON**  
F.A.S. ROUTE 294 (OLD U.S. ROUTE 66)  
SECTION (14R2 & 15R1)RS-1  
MCLEAN COUNTY

SCALE: NOT TO SCALE  
DATE: 08/08/06

DRAWN BY: M.L.B.  
CHECKED BY: M.L.B.



F.A.S. RTE.	SECTION	COUNTY	TOTAL SHEETS	SHEET NO.
294	.	MCLEAN	22	17

\*(14R2 & 15R1)RS-1

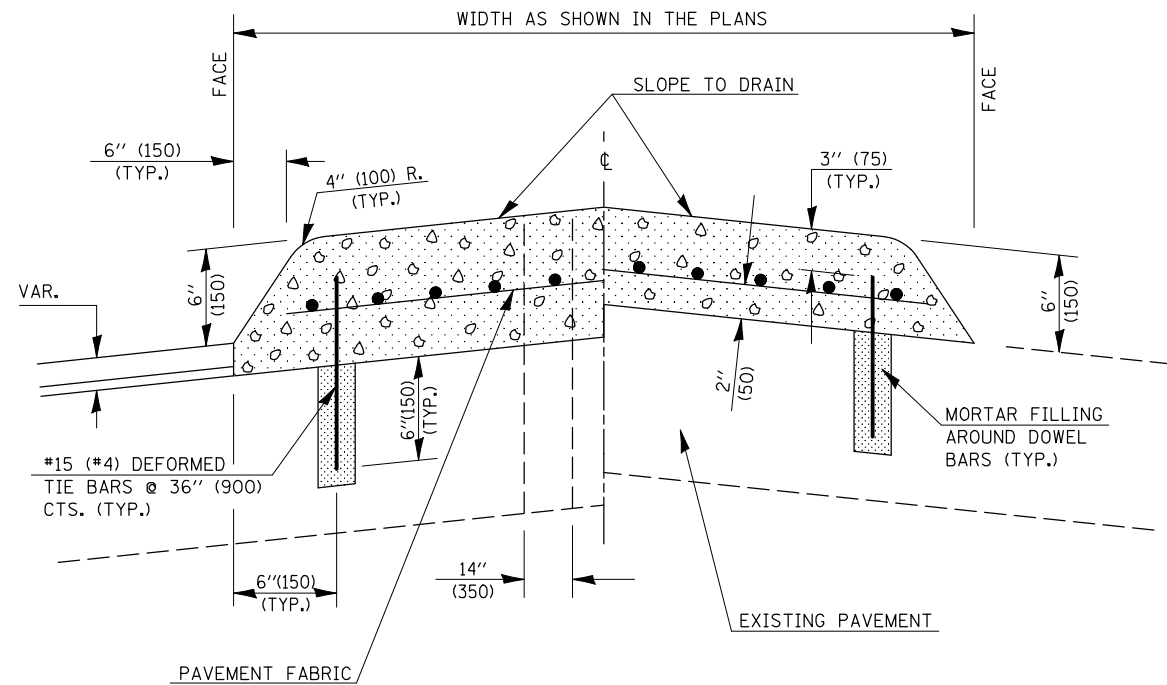

SECTION A-A

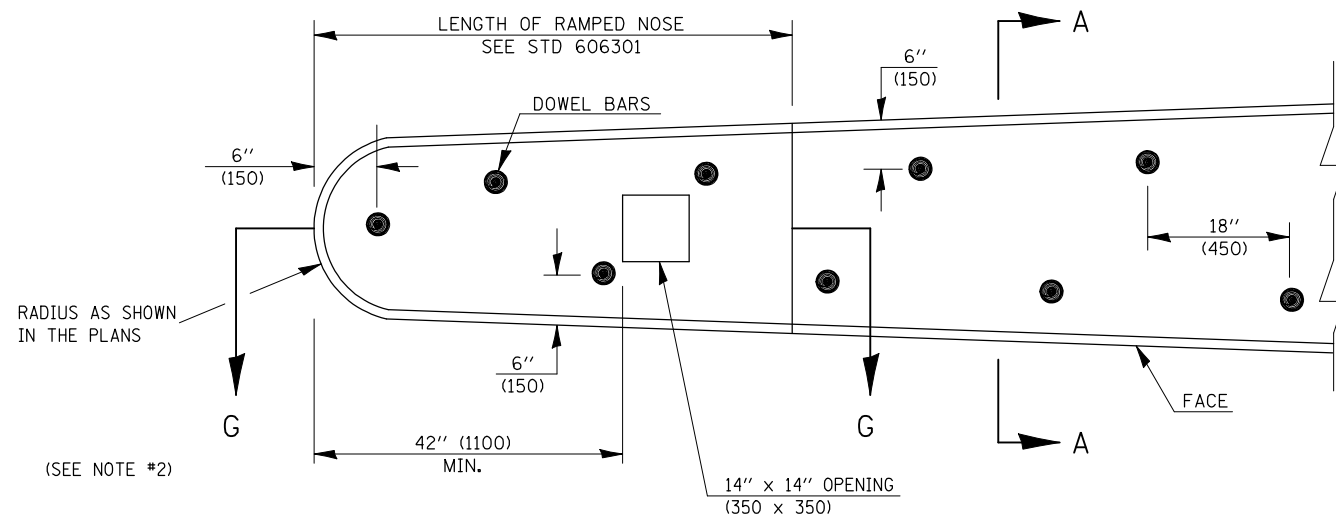

PLAN OF MEDIAN

GENERAL NOTES

1. THE GENERAL NOTES FOR STANDARD 606301 SHALL APPLY.
2. DOWEL BARS @ 36" (900) CTS. OR AS DIRECTED BY THE ENGINEER.
3. THIS WORK WILL BE PAID FOR AT THE CONTRACT UNIT PRICE PER SQ FOOT (m ) FOR CONCRETE MEDIAN, TYPE SM-6 (SM-15) (DOWELED), INCLUDING THE COST OF FURNISHING AND INSTALLING THE DOWEL BARS, MORTAR FILLING, PAVEMENT FABRIC AND THE REMOVAL AND DISPOSAL OF THE EXISTING PAVEMENT FOR THE 14" x 14" (350 x 350) OPENING, IF REQUIRED, AND NO ADDITIONAL COMPENSATION WILL BE ALLOWED.

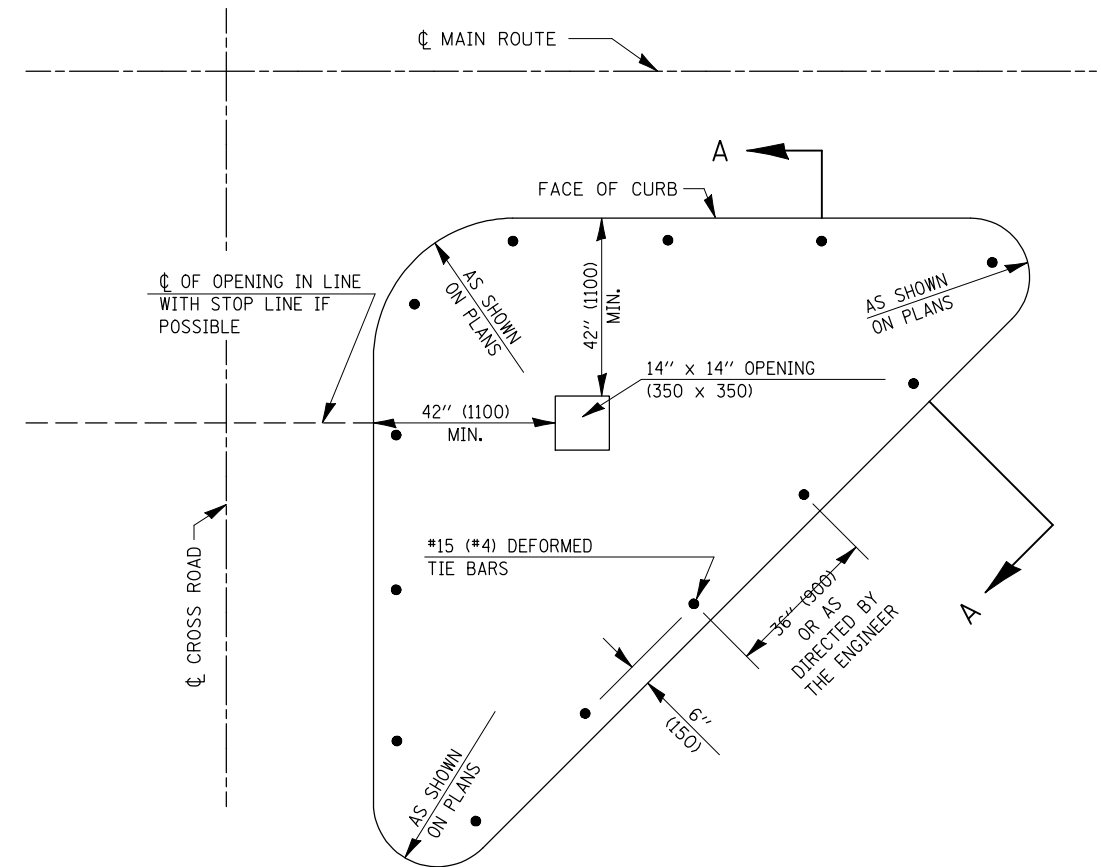

PLAN OF CORNER ISLAND

Note: All dimensions are in INCHES (millimeters) unless otherwise shown.

DATE	REVISIONS	NAME
11/06	REPLACED DETAIL A-5.07	TJB

ILLINOIS DEPARTMENT OF TRANSPORTATION

CONCRETE MEDIAN,  
TYPE SM-6 (SM-15)  
(DOWELED)

DISTRICT 5 DETAIL NO. 60622354

DESIGNER NOTE:

PLOT DATE = 1/20/2009  
FILE NAME = c:\p\m\c\p\11001\CEARLOCKJD\0112345\111111.dgn  
PLOT SCALE = 42,352 x 1/16 IN.  
USER NAME = cearlockjd

F.A.S. RTE.	SECTION	COUNTY	TOTAL SHEETS	SHEET NO.
294	*	MCLEAN	22	18
STA.		TO STA.		
FED. ROAD DIST. NO.		ILLINOIS FED. AID PROJECT		
*(14R2 & 15R1)RS-1				

### CORNER ISLAND STRIPING DETAIL OLD ROUTE 66 & MAIN STREET

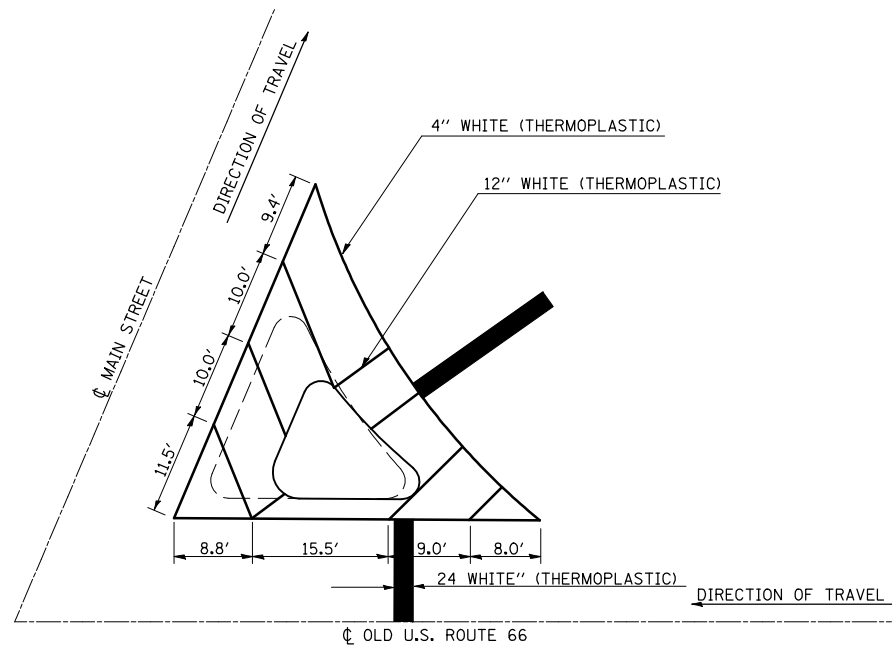

### HOT-MIX ASPHALT SHOULDER DETAIL STRUCTURE NO. 057-0035

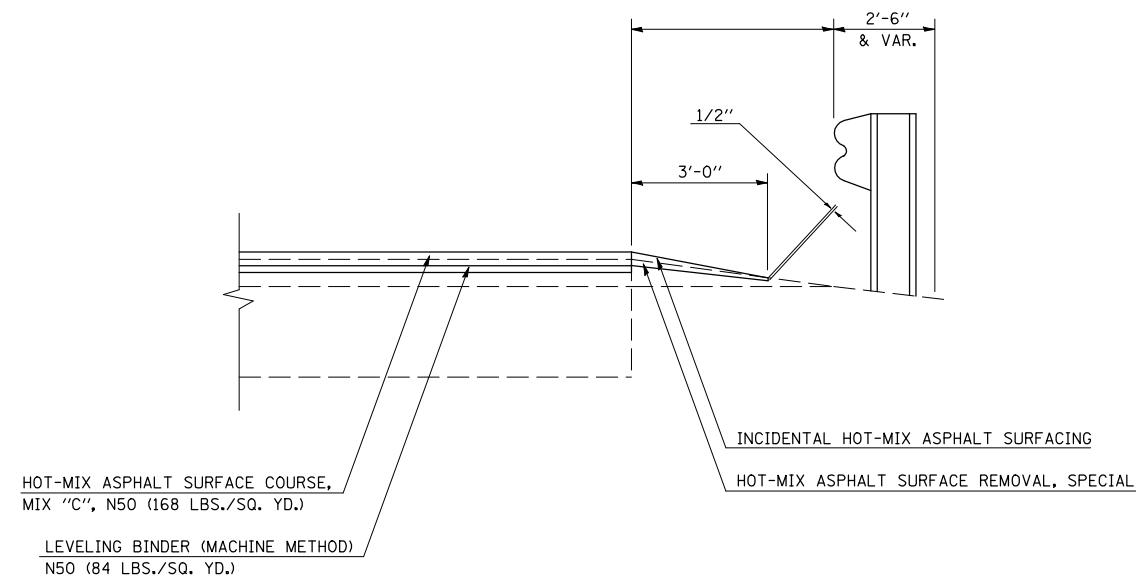

STATION 2486+00.00 TO STATION 2489+20.00  
STATION 2491+98.00 TO STATION 2495+18.00

### TYPICAL DETAIL FOR BIKE PATH STRIPING

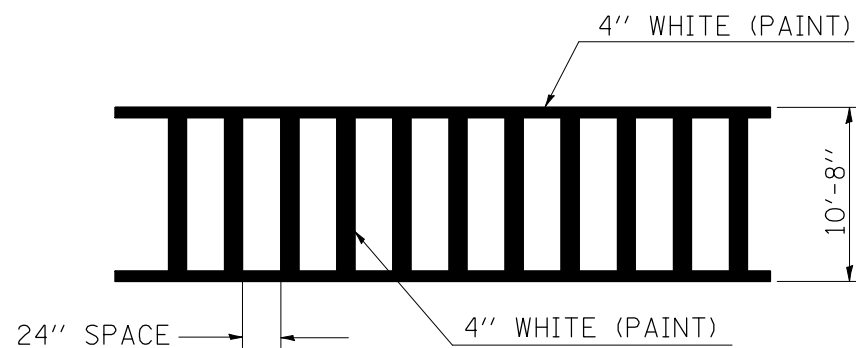

STATION 2400+78.00 (OLD RTE 4)  
STATION 2473+83.00 (GROVE ST.)

ILLINOIS DEPARTMENT OF TRANSPORTATION

#### MISCELLANEOUS DETAILS

F.A.S. ROUTE 294 (OLD U.S. ROUTE 66)  
SECTION (14R2 & 15R1)RS-1  
MCLEAN COUNTY

SCALE: NOT TO SCALE  
DATE: 08/10/06

DRAWN BY: M.L.B./B.B.P.  
CHECKED BY: M.L.B.

F.A.S. RTE.	SECTION	COUNTY	TOTAL SHEETS	SHEET NO.
294	*	MCLEAN	22	19
STA.		TO STA.		
FED. ROAD DIST. NO.	ILLINOIS	FED. AID PROJECT		

\*(14R2 & 15R1)RS-1

# TYPICAL APPLICATIONS OF PAVEMENT MARKINGS AND MARKERS

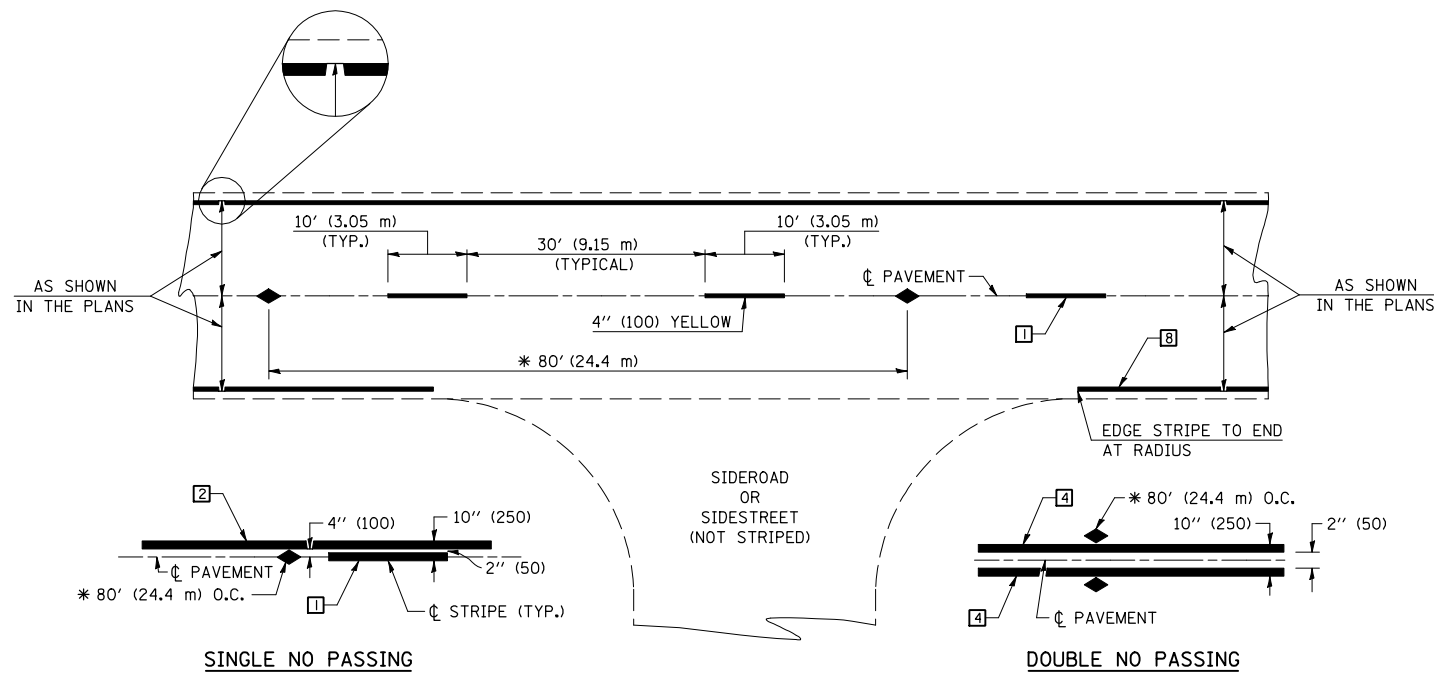

## TYPICAL PAVEMENT MARKING LEGEND

- 1 4" (100) SKIP-DASH (YELLOW)
- 2 4" (100) SOLID (YELLOW)
- 3 12" (300) DIAGONAL (YELLOW)
- 4 4" (100) DOUBLE YELLOW (NARROW)
- 5 RESERVED
- 6 RESERVED
- 7 4" (100) SKIP-DASH (WHITE)
- 8 4" (100) SOLID (WHITE)
- 9 12" (300) DIAGONAL (WHITE)
- 10 6" (150) CROSS WALK (WHITE)
- 11 24" (600) STOP BAR (WHITE)
- 12 8" (200) SOLID (WHITE)
- 13 4" (100) LANE LINE EXTENSIONS (WHITE)
- 14 4" (100) PARKING WHITE

## TYPICAL PAVEMENT MARKERS LEGEND

- ◆ TWO-WAY AMBER MARKER
- ▶ ONE-WAY AMBER MARKER
- ▷ ONE-WAY CRYSTAL MARKER

## DETAIL OF RURAL LEFT TURN LANE

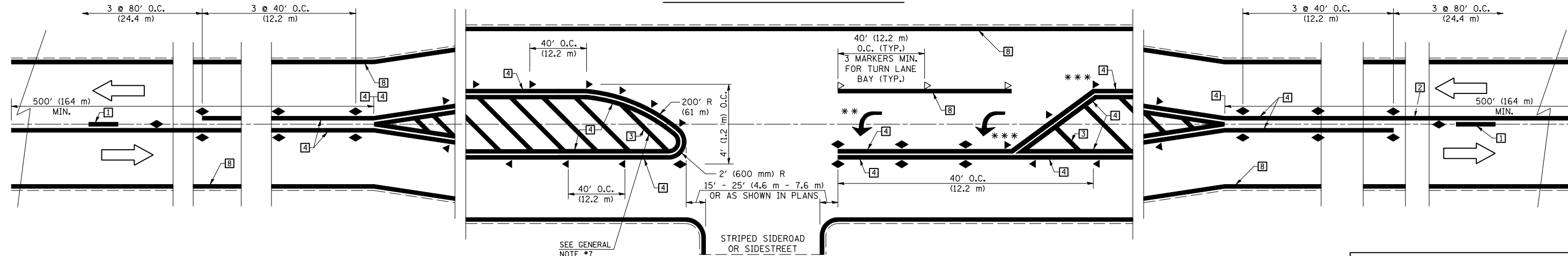

PLOT DATE = 1/14/2009  
 FILE NAME = G:\work\K\PWIDOT\PERSONNEL\DO12345\dlist1.s.dgn  
 USER NAME = pier\_sonbr

### SHEET 1 OF 4

DESIGNED	NAME	DATE	REVISIONS	DATE
J.M.H.		5/85	NAME	
FMS		6/88	GEOMETRICS/K.A.G.	07/02
CTD		6/88	K.A.G.	09/05
CADD NO.	F-5.25			

ALL DIMENSIONS ARE IN INCHES (MILLIMETERS) UNLESS OTHERWISE SHOWN.

ILLINOIS DEPARTMENT OF TRANSPORTATION  
**TYPICAL APPLICATIONS OF PAVEMENT MARKINGS AND MARKERS DETAIL**  
 F.A.S. ROUTE 294 (OLD U.S. ROUTE 66)  
 SECTION (14R2 & 15R1)RS-1  
 MCLEAN COUNTY  
*Sheet 1 of 4*  
 SCALE: NOT TO SCALE DATE: 08/02/06

F.A.S. RTE.	SECTION	COUNTY	TOTAL SHEETS	SHEET NO.
294	*	MCLEAN	22	20
STA.		TO STA.		
FED. ROAD DIST. NO.	ILLINOIS	FED. AID PROJECT		

\*(14R2 & 15R1)RS-1

### TYPICAL APPLICATIONS OF PAVEMENT MARKINGS AND MARKERS

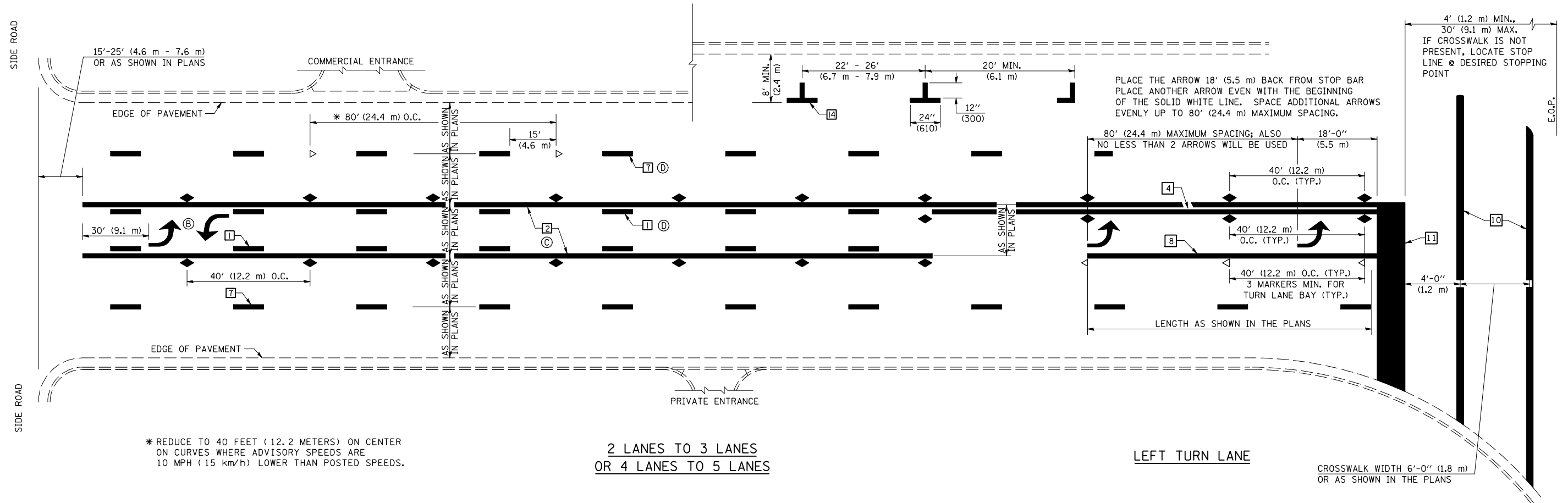

\* REDUCE TO 40 FEET (12.2 METERS) ON CENTER ON CURVES WHERE ADVISORY SPEEDS ARE 10 MPH (15 km/h) LOWER THAN POSTED SPEEDS.

2 LANES TO 3 LANES  
OR 4 LANES TO 5 LANES

LEFT TURN LANE

CROSSWALK WIDTH 6'-0" (1.8 m)  
OR AS SHOWN IN THE PLANS

PLOT DATE = 1/14/2009  
FILE NAME = c:\pwworkspace\PIERSONBR\d012345\dlistht.s.dgn  
USER NAME = pier\_sonbr

SHEET 2 OF 4

	NAME	DATE	REVISIONS	
DESIGNED	J.M.H.	5/85	NAME	DATE
CHECKED	FMS	6/85	GEOMETRICS/K.A.G.	07/02
CADD NO.	F-5.25	6/88	K.A.G.	09/05

ALL DIMENSIONS ARE IN INCHES (MILLIMETERS) UNLESS OTHERWISE SHOWN.

ILLINOIS DEPARTMENT OF TRANSPORTATION  
**TYPICAL APPLICATIONS OF PAVEMENT MARKINGS AND MARKERS DETAIL**  
 F.A.S. ROUTE 294 (OLD U.S. ROUTE 66)  
 SECTION (14R2 & 15R1)RS-1  
 MCLEAN COUNTY  
 Sheet 2 of 4  
 SCALE: NOT TO SCALE DATE: 08/02/06

F.A.S. RTE.	SECTION	COUNTY	TOTAL SHEETS	SHEET NO.
294	*	MCLEAN	22	21
STA.		TO STA.		
FED. ROAD DIST. NO.	ILLINOIS	FED. AID PROJECT		

\*(14R2 & 15R1)RS-1

## TYPICAL APPLICATIONS OF PAVEMENT MARKINGS AND MARKERS

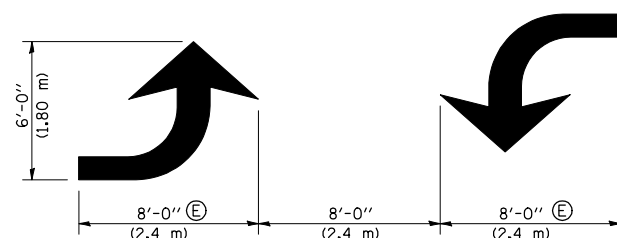

TYPICAL DOUBLE TURN ARROWS (WHITE)

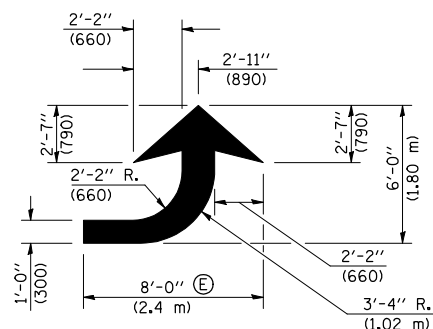

LEFT ARROW

REVERSE FOR RIGHT ARROW  
AREA = 15.6 SQ. FT. (1.47 m<sup>2</sup>)  
(WHITE)

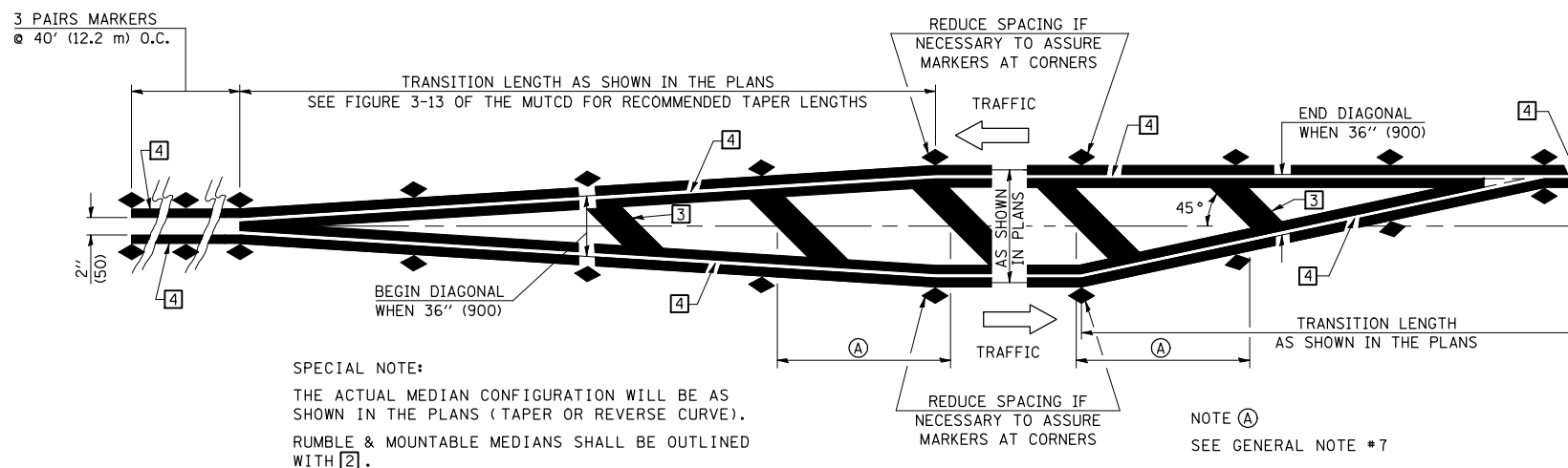

TYPICAL MEDIAN TRANSITIONS

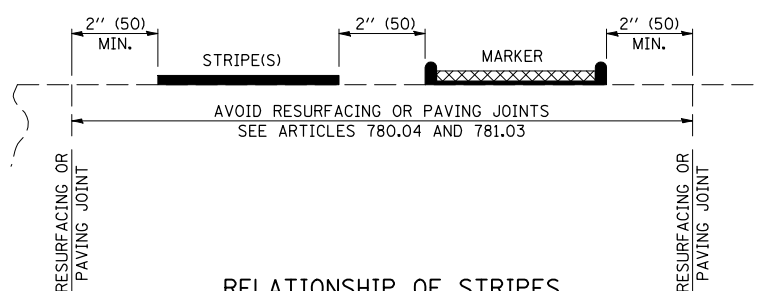

RELATIONSHIP OF STRIPES, MARKERS AND JOINTS

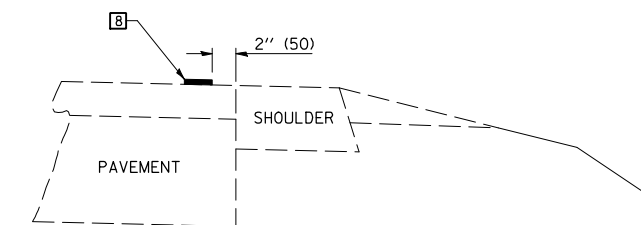

RELATIONSHIP OF EDGE STRIPE TO SAFETY SHOULDER OR PAVED SURFACE

SPECIAL NOTES:

- (B) TURN ARROW PAIRS SHALL BE PLACED AT 250' (75 m) INTERVALS AND SHALL BE EVENLY SPACED BETWEEN BOTH ENDS OF THE BIDIRECTIONAL LEFT TURN LANE.
- (C) THE SOLID YELLOW PAVEMENT MARKINGS [2] SHOULD GENERALLY START OR END NEAR THE RADIUS POINT OF EACH STREET RETURN EXCEPT WHERE ONE OR BOTH ENDS WOULD INCLUDE STOP BARS.
- (D) THE SKIP-DASH PAVEMENT MARKINGS [1] OR [7] SHOULD BE CENTERED BETWEEN BOTH ENDS OF EACH CITY BLOCK AND SHALL BE PLACED SO THEY LINE UP ACROSS FROM EACH OTHER. SEE EXAMPLE ON SHEET 2 OF 3.
- (E) TURN ARROW SIZE DEPENDS ON THE LOCATION.  
RURAL LOCATION - LARGE ARROW SIZE  
URBAN LOCATION - SMALL ARROW SIZE

GENERAL NOTES

1. WHEN MEDIANS ARE PRESENT, PAVEMENT MARKINGS ARE TO BE PLACED ADJACENT TO MEDIANS.
2. SCALE: NONE
3. SOME OF THE INFORMATION INCLUDED WITH THIS DETAIL MAY NOT BE APPLICABLE TO THIS IMPROVEMENT.
4. PAVEMENT MARKINGS ARE TO BE EXTENDED THROUGH OMISSIONS WHEN APPLICABLE.
5. A STRIPING KEY IS AVAILABLE ELSEWHERE AND SHALL BE SHOWN WHERE THE QUANTITIES ARE LISTED.
6. FINAL PAVEMENT MARKINGS SHALL BE IN PLACE PRIOR TO PLACING ANY RAISED REFLECTIVE PAVEMENT MARKERS.
7. THE FOLLOWING CRITERIA SHALL BE USED FOR SELECTING THE DIAGONAL PAVEMENT MARKING SPACING,  
<30 MPH USE 15' (<50 km/h USE 4.5 m)  
30-45 MPH USE 20' (50-75 km/h USE 6.0 m)  
>45 MPH USE 30' (>75 km/h USE 9.0 m)

PLOT DATE = 1/14/2009  
FILE NAME = G:\DW\work\PIERSONBR\012345\allsh1.s.dgn  
USER NAME = piersonbr

SHEET 3 OF 4

	NAME	DATE	REVISIONS	
DESIGNED	J.M.H.	5/85	NAME	DATE
CHECKED	FMS	6/85	GEOMETRICS/K.A.G.	07/02
CADD NO.	F-5.25	6/88	K.A.G.	09/05

ALL DIMENSIONS ARE IN INCHES (MILLIMETERS) UNLESS OTHERWISE SHOWN.

ILLINOIS DEPARTMENT OF TRANSPORTATION  
**TYPICAL APPLICATIONS OF PAVEMENT MARKINGS AND MARKERS DETAIL**  
F.A.S. ROUTE 294 (OLD U.S. ROUTE 66)  
SECTION (14R2 & 15R1)RS-1  
MCLEAN COUNTY  
Sheet 3 of 4  
SCALE: NOT TO SCALE DATE: 08/02/06

F.A.S. RTE.	SECTION	COUNTY	TOTAL SHEETS	SHEET NO.
294	*	MCLEAN	22	22
STA.		TO STA.		
FED. ROAD DIST. NO.	ILLINOIS	FED. AID PROJECT		

\*(14R2 & 15R1)RS-1

### TYPICAL APPLICATIONS OF PAVEMENT MARKINGS AND MARKERS

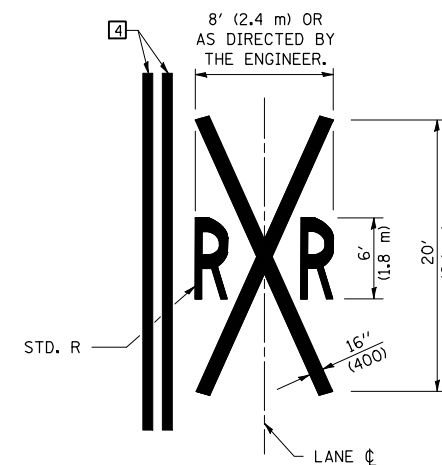
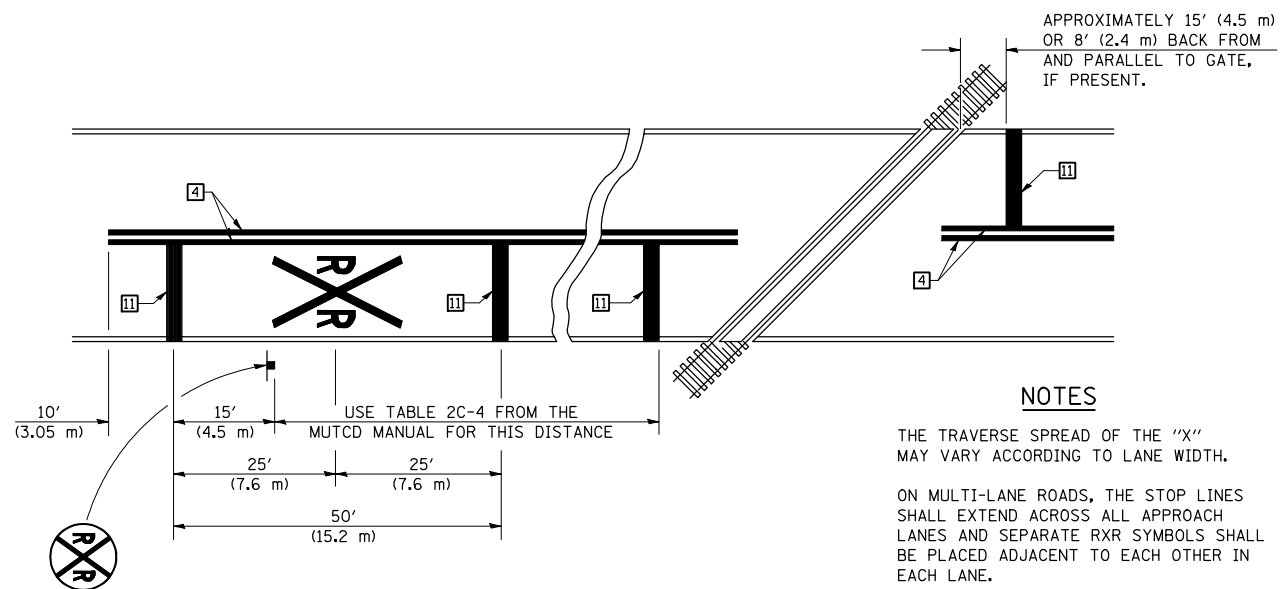

**NOTES**

THE TRAVERSE SPREAD OF THE "X" MAY VARY ACCORDING TO LANE WIDTH.

ON MULTI-LANE ROADS, THE STOP LINES SHALL EXTEND ACROSS ALL APPROACH LANES AND SEPARATE RXR SYMBOLS SHALL BE PLACED ADJACENT TO EACH OTHER IN EACH LANE.

WHEN THE PAVEMENT MARKING SYMBOL IS USED, A PORTION OF THE SYMBOL SHOULD BE LOCATED DIRECTLY ADJACENT TO THE ADVANCE WARNING SIGN (W10-1) AS PLACED BY TABLE II-1, CONDITION B OF THE MUTCD.

**PAVEMENT MARKINGS AT RAILROAD-HIGHWAY GRADE CROSSING**

PLOT DATE = 1/14/2009  
 FILE NAME = G:\b\_wor\k\PIRIDOT\PERSONBR\012345\dlisth.s.dgn  
 USER NAME = pier\_sonbr

**SHEET 4 OF 4**

	NAME	DATE	REVISIONS
DESIGNED	J.M.H.	5/85	NAME
CHECKED	FMS	6/85	DATE
CADD NO.	CTD	6/88	GEOMETRICS/K.A.G.
	F-5.25		K.A.G.

ALL DIMENSIONS ARE IN INCHES (MILLIMETERS) UNLESS OTHERWISE SHOWN.

ILLINOIS DEPARTMENT OF TRANSPORTATION  
**TYPICAL APPLICATIONS OF PAVEMENT MARKINGS AND MARKERS DETAIL**  
 F.A.S. ROUTE 294 (OLD U.S. ROUTE 66)  
 SECTION (14R2 & 15R1)RS-1  
 MCLEAN COUNTY  
*Sheet 4 of 4*  
 SCALE: NOT TO SCALE      DATE: 08/02/06