

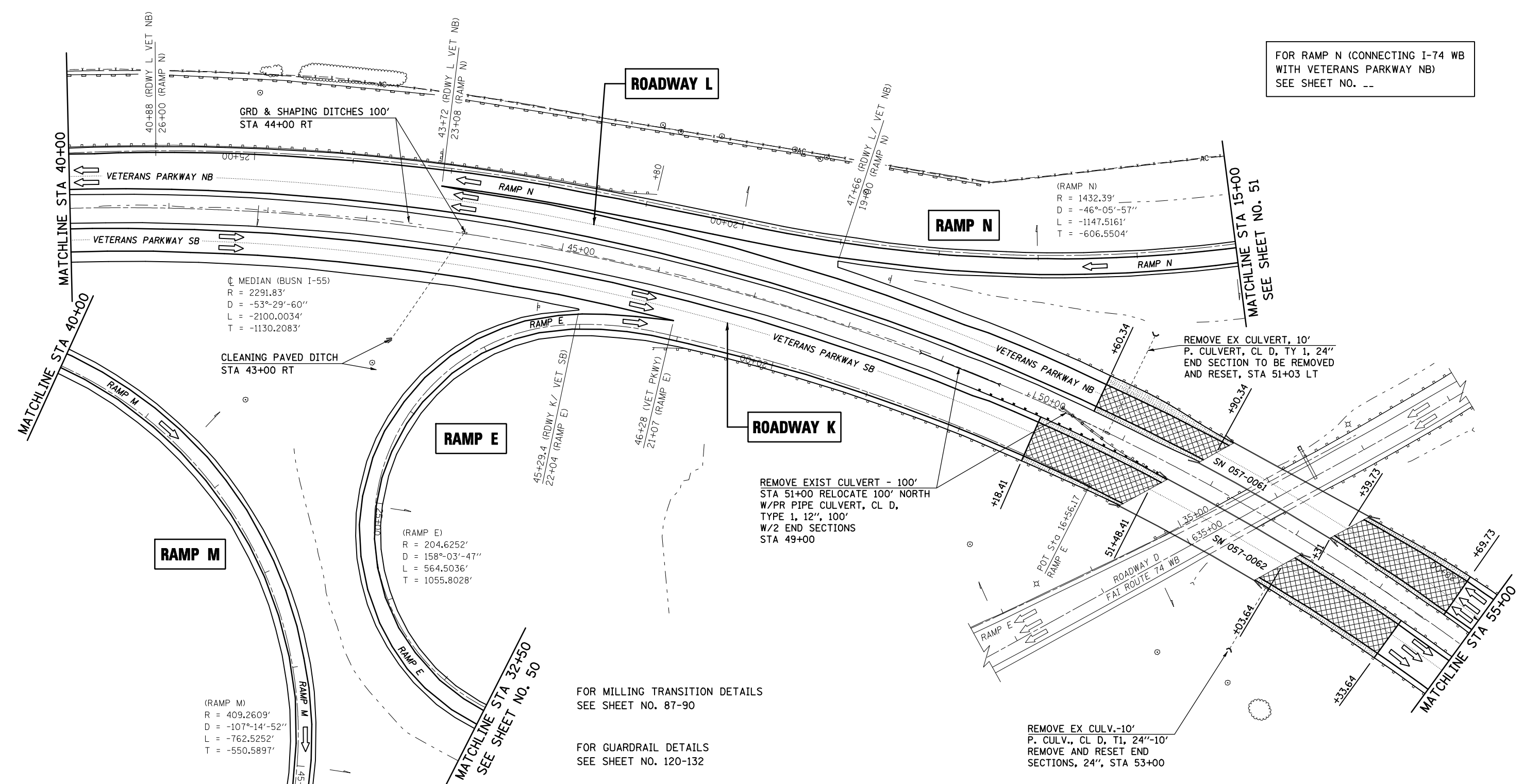

FOR RAMP N (CONNECTING I-74 WB WITH VETERANS PARKWAY NB)  
SEE SHEET NO. --



CL MEDIAN (BUSN I-55)  
R = 2291.83'  
D = -53°-29'-60"  
L = -2100.0034'  
T = -1130.2083'

(RAMP M)  
R = 409.2609'  
D = -107°-14'-52"  
L = -762.5252'  
T = -550.5897'

(RAMP E)  
R = 204.6252'  
D = 158°-03'-47"  
L = 564.5036'  
T = 1055.8028'

(RAMP N)  
R = 1432.39'  
D = -46°-05'-57"  
L = -1147.5161'  
T = -606.5504'

FOR MILLING TRANSITION DETAILS  
SEE SHEET NO. 87-90

FOR GUARDRAIL DETAILS  
SEE SHEET NO. 120-132

- MILLING TRANSITION FOR STRUCTURES
- HMA SURFACE REMOVAL-BUTT JOINT

SHEET 2 OF 4

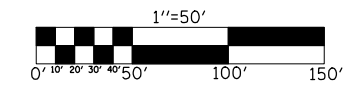

FILE NAME =	USER NAME = shererjm	DESIGNED - JMS	REVISED -	<b>STATE OF ILLINOIS DEPARTMENT OF TRANSPORTATION</b>	<b>VETERANS PARKWAY NORTHBOUND &amp; SOUTHBOUND</b>	F.A.I. RTE. = 74	SECTION = 57-20(1) & (57-4,5,6)RS-3	COUNTY = MCLEAN	TOTAL SHEETS = 160	SHEET NO. = 64	
ct:\pw\work\PWIDOT\SHERRERJM\dms83233\70505SHEETS.DGN	PLOT SCALE = 100.0000' / IN.	DRAWN - JRP	REVISED -			SCALE: 1" = 50'    PLAN VIEW SHEET 18 OF 21    STA 40+00 TO STA 55+00 (NB & SB)					
	PLOT DATE = 1/30/2009	CHECKED -	REVISED -			CONTRACT NO. 70505					
		DATE = 05-20-08	REVISED -			FED. ROAD DIST. NO.    ILLINOIS FED. AID PROJECT					