

SEC. 90-15HB-2 F.A.I. 74
 TR 234 (TENNESSEE AVE.)
 S.N. 090-0084
 STA. 686+89.76 F.A.I. 74 =
 STA. 15+00.07 TR 234
 LENGTH = 223.66'
 WIDTH = 30'
 SKEW = 88° 07' 00"

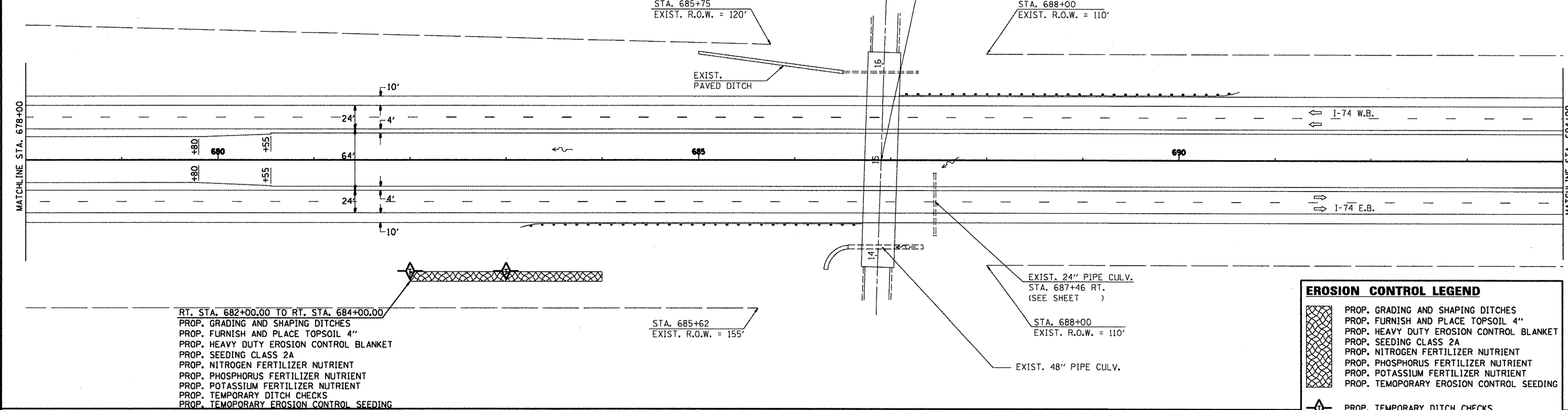

MATCHLINE STA. 678+00

MATCHLINE STA. 694+00



RT. STA. 682+00.00 TO RT. STA. 684+00.00
 PROP. GRADING AND SHAPING DITCHES
 PROP. FURNISH AND PLACE TOPSOIL 4"
 PROP. HEAVY DUTY EROSION CONTROL BLANKET
 PROP. SEEDING CLASS 2A
 PROP. NITROGEN FERTILIZER NUTRIENT
 PROP. PHOSPHORUS FERTILIZER NUTRIENT
 PROP. POTASSIUM FERTILIZER NUTRIENT
 PROP. TEMPORARY DITCH CHECKS
 PROP. TEMPORARY EROSION CONTROL SEEDING

EROSION CONTROL LEGEND

- PROP. GRADING AND SHAPING DITCHES
- PROP. FURNISH AND PLACE TOPSOIL 4"
- PROP. HEAVY DUTY EROSION CONTROL BLANKET
- PROP. SEEDING CLASS 2A
- PROP. NITROGEN FERTILIZER NUTRIENT
- PROP. PHOSPHORUS FERTILIZER NUTRIENT
- PROP. POTASSIUM FERTILIZER NUTRIENT
- PROP. TEMPORARY EROSION CONTROL SEEDING
- PROP. TEMPORARY DITCH CHECKS
- PROP. PERIMETER EROSION BARRIER
- PROP. STONE DUMPED RIPRAP

MATCHLINE STA. 694+00

MATCHLINE STA. 710+00

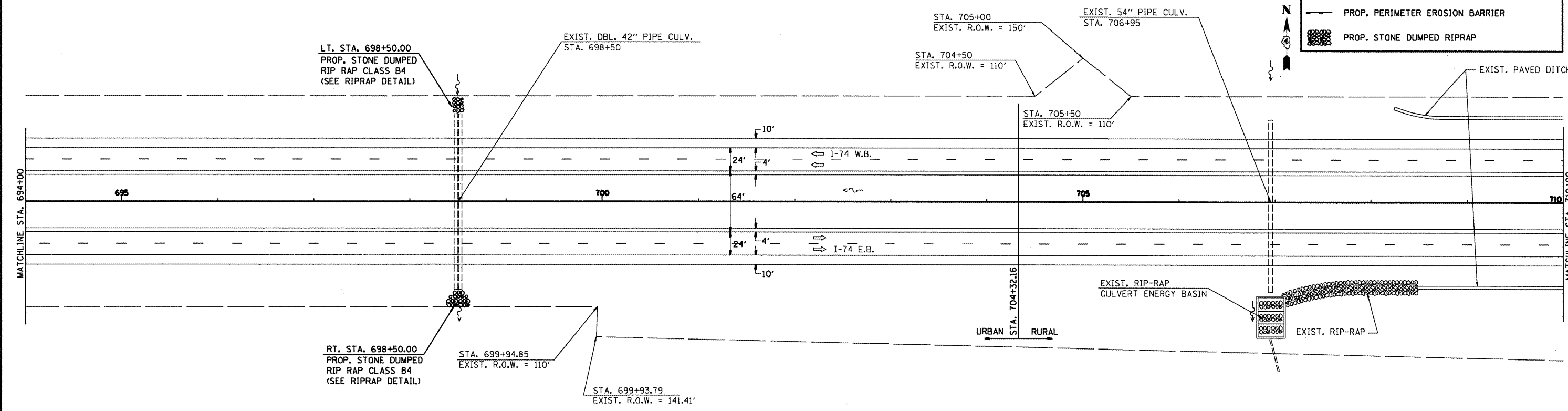

LT. STA. 698+50.00
 PROP. STONE DUMPED
 RIP RAP CLASS B4
 (SEE RIPRAP DETAIL)

RT. STA. 698+50.00
 PROP. STONE DUMPED
 RIP RAP CLASS B4
 (SEE RIPRAP DETAIL)

STA. 699+94.85
 EXIST. R.O.W. = 110'

STA. 699+93.79
 EXIST. R.O.W. = 141.41'

STA. 705+00
 EXIST. R.O.W. = 150'

STA. 704+50
 EXIST. R.O.W. = 110'

STA. 705+50
 EXIST. R.O.W. = 110'

URBAN
 STA. 704+32.16
 RURAL

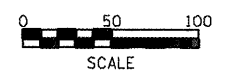

FILE NAME =
 I-74 Morton General File.dgn

USER NAME = k1mankk	DESIGNED -	REVISED -
PLOT SCALE = 100.0000' / IN.	DRAWN -	REVISED -
PLOT DATE = 2/11/2009	CHECKED -	REVISED -
	DATE -	REVISED -

**STATE OF ILLINOIS
 DEPARTMENT OF TRANSPORTATION**

EROSION CONTROL PLAN SHEETS

SCALE: PROVIDED ABOVE SHEET NO. 3 OF 12 SHEETS STA. 678+00 TO STA. 710+00

F.A.I. RTE.	SECTION	COUNTY	TOTAL SHEETS	SHEET NO.
74	(90-15)RS-3	TAZEWELL	60	32
CONTRACT NO. 68508				
ILLINOIS FEDERAL AID PROJECT				