

F.A.U. RTE.	SECTION	COUNTY	TOTAL SHEETS	SHEET NO.
6120	(50-2HB-5)RS-2	LASALLE	17	1
		ILLINOIS	CONTRACT NO. 66953	

### INDEX OF SHEETS

1. COVER SHEET
2. GENERAL NOTES
3. SUMMARY OF QUANTITIES
4. TYPICAL SECTIONS.
- 5 - 6. SCHEDULES
- 7 - 11. PLAN VIEW SHEETS
- 12 - 16. PAVEMENT MARKING SHEETS
17. TYPICAL PAVEMENT MARKINGS

### STANDARDS

- |           |  |
|-----------|--|
| 000001-05 | STANDARD SYMBOLS, ABBREVIATIONS AND PATTERNS                                       |
| 001006    | DECIMAL OF AN INCH AND OF A FOOT   |
| 701001-02 | OFF-ROAD OPERATIONS 2L, 2W, MORE THAN 15' (4.5 m) AWAY                             |
| 701006-03 | OFF-ROAD OPERATIONS 2L, 2W, 15' (4.5 m) TO 24" (600 mm) FROM PAVEMENT EDGE         |
| 701011-02 | OFF-ROAD MOVING OPERATIONS 2L, 2W, DAY ONLY  |
| 701101-02 | OFF-ROAD OPERATIONS MULTILANE, 15' (4.5 m) TO 24" (600 mm) FROM PAVEMENT EDGE      |
| 701106-02 | OFF-ROAD OPERATIONS, MULTILANE, MORE THAN 15' (4.5 m) AWAY                         |
| 701301-03 | LANE CLOSURE, 2L, 2W, SHORT TIME OPERATIONS  |
| 701306-02 | LANE CLOSURE, 2L, 2W, SLOW MOVING OPERATIONS DAY ONLY, FOR SPEEDS $\geq$ 55 MPH    |
| 701311-03 | LANE CLOSURE, 2L, 2W, MOVING OPERATIONS - DAY ONLY                                 |
| 701426-03 | LANE CLOSURE, MULTILANE INTERMITTENT OR MOVING OPERATIONS FOR SPEEDS $\geq$ 55 MPH |
| 701601-03 | URBAN LANE CLOSURE, MULTILANE, 1W OR 2W WITH NONTRAVERSABLE MEDIAN                 |
| 701901-01 | TRAFFIC CONTROL DEVICES  |

# STATE OF ILLINOIS DEPARTMENT OF TRANSPORTATION DIVISION OF HIGHWAYS PROPOSED HIGHWAY PLANS

**FAU ROUTE 6120 (IL 178)  
SECTION (50-2HB-5)RS-2  
PROJECT E-SP-6120(001)  
MILLING AND RESURFACING  
LASALLE COUNTY  
C-93-088-09**

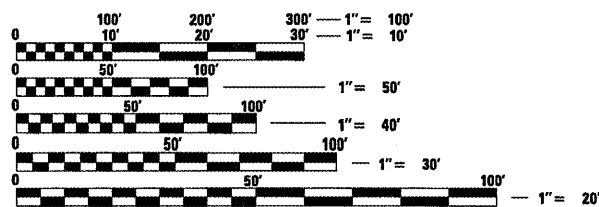
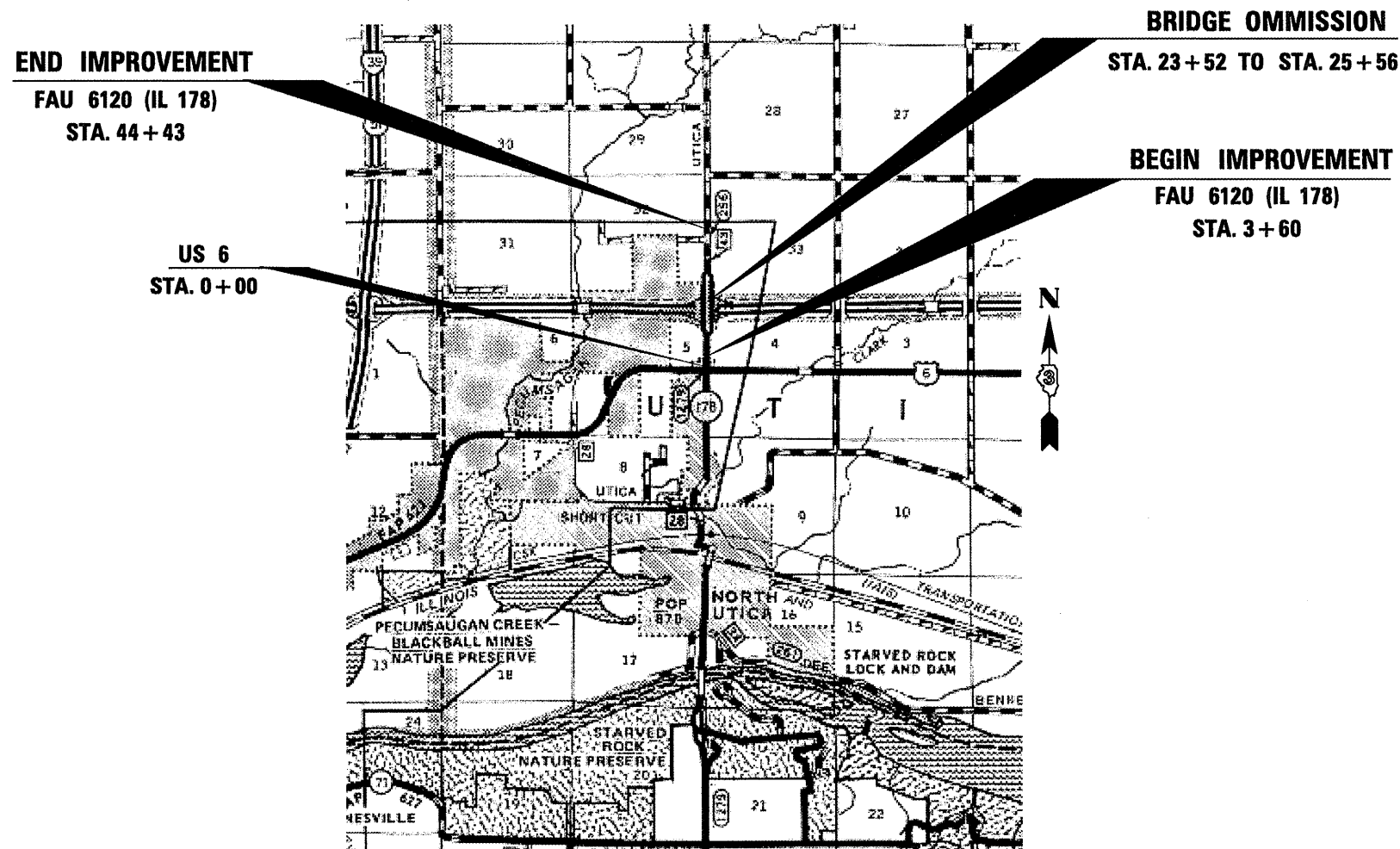
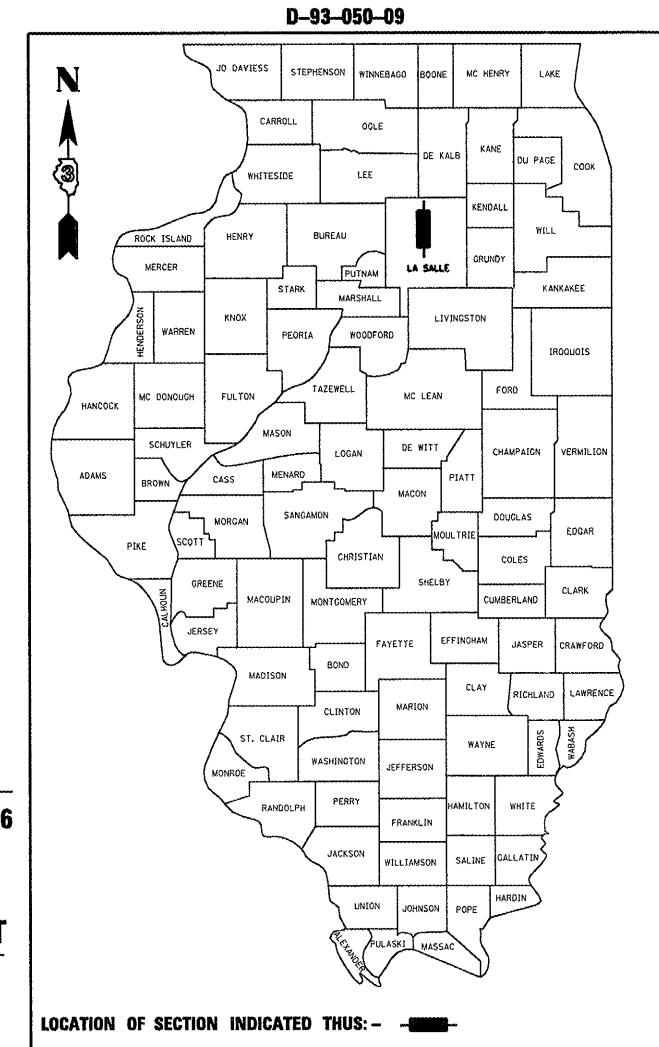

FULL SIZE PLANS HAVE BEEN PREPARED USING STANDARD ENGINEERING SCALES. REDUCED SIZED PLANS WILL NOT CONFORM TO STANDARD SCALES. IN MAKING MEASUREMENTS ON REDUCED PLANS, THE ABOVE SCALES MAY BE USED.

J.U.L.I.E.  
JOINT UTILITY LOCATION INFORMATION FOR EXCAVATION  
1-800-892-0123  
OR 811

**PROJECT ENGINEER: JOE KANNEL  
UNIT CHIEF: RON WOODSHANK  
TOWNSHIP: UTICA  
CONTRACT NO. 66953**

GROSS LENGTH = 4500 FT. = 0.85 MILE  
NET LENGTH = 4083 FT. = 0.77 MILE

FUNCTIONAL CLASSIFICATION  
URBAN - MINOR ARTERIAL  
F.A.U. ROUTE 6120 (IL 178)  
2007 ADT = 3300  
P.V. = 84.8% M.U. = 8.4% S.U. = 6.8 %

STATE OF ILLINOIS  
DEPARTMENT OF TRANSPORTATION  
DIVISION OF HIGHWAYS

SUBMITTED 213 20 09

*Charles J. Ingersoll*  
DEPUTY DIRECTOR OF HIGHWAYS, REGION ENGINEER

March 13, 2009  
*Charles J. Ingersoll*  
ENGINEER OF DESIGN AND ENVIRONMENT

March 13, 2009  
*Christine M. Reed*  
DIRECTOR OF HIGHWAYS, CHIEF ENGINEER

**PRINTED BY THE AUTHORITY  
OF THE STATE OF ILLINOIS**