

**HMA TAPER AT BUTT JOINTS**

- \* STA. 3+77.3
- \* STA. 331+55
- \* STA 364+30
- \* STA. 377+09

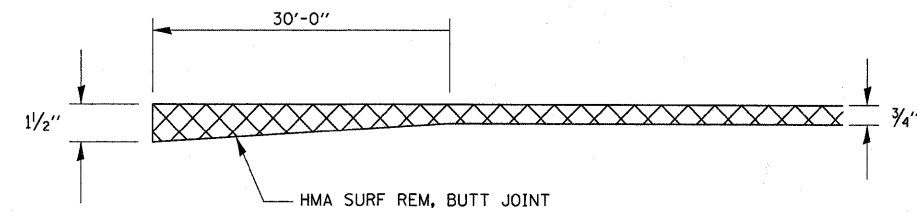

**HMA SURFACE REMOVAL - BUTT JOINT**

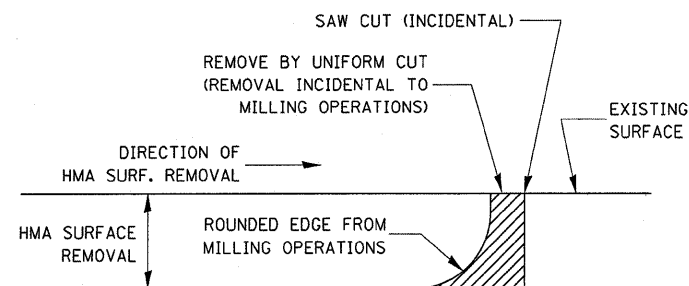

NOTE:  
 WHEN MILLING OPERATIONS PRODUCE A ROUNDED EDGE,  
 THEN A SAW CUT SHALL BE USED TO MANUFACTURE  
 A PERPENDICULAR EDGE AS SHOWN IN THE DETAIL.  
 THE ENGINEER SHALL BE THE SOLE JUDGE  
 CONCERNING THE USE OF THIS DETAIL

**HMA DETAIL AT BUTT JOINTS**

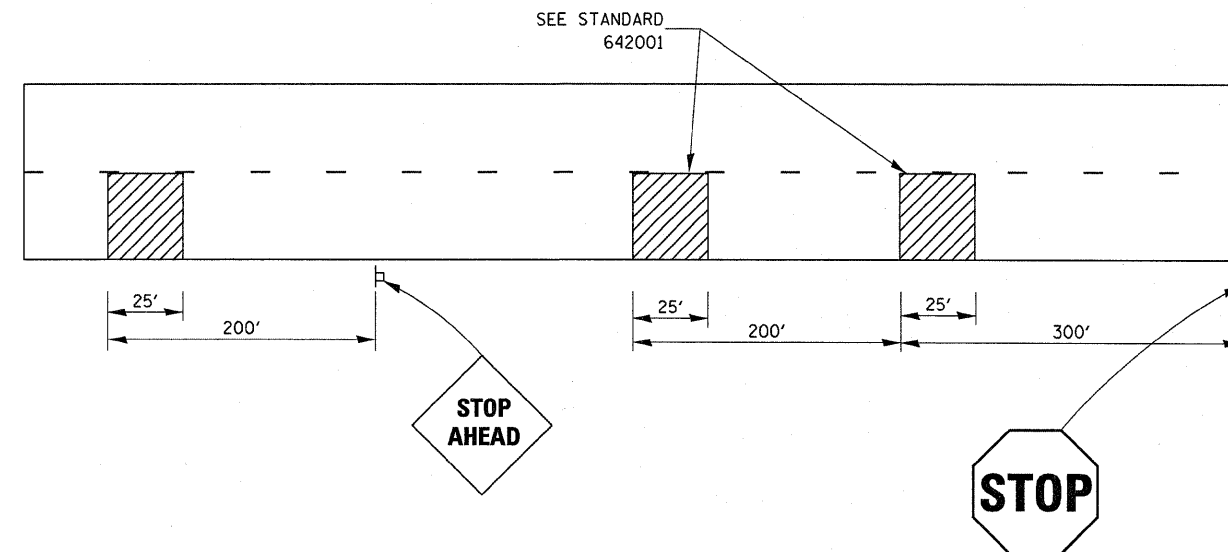

**TYPICAL GROOVED RUMBLE STRIP  
 APPLICATION IN ADVANCE OF AN INTERSECTION**

TO BE INSTALLED FOR WESTBOUND TRAFFIC AT IL 89

|   |                         |            |           |   |                |           |    |        |   |         |        |              |                |    |    |
|---|-------------------------|------------|-----------|---|----------------|-----------|----|--------|---|---------|--------|--------------|----------------|----|----|
| FILE NAME =   | USER NAME = carpenterdj | DESIGNED - | REVISED - | <b>STATE OF ILLINOIS<br/>DEPARTMENT OF TRANSPORTATION</b> | <b>DETAILS</b> |           |    |        | F.A.P. RTE.                                   | SECTION | COUNTY | TOTAL SHEETS | SHEET NO.      |    |    |
| c:\pwork\PW1DOT\CARPENTERDJ\d0116115\366925-shr-details.DGN |                         | DRAWN -    | REVISED - |   | SCALE:         | SHEET NO. | OF | SHEETS | STA.  | TO STA. | 653    | (1,105)RS-3  | PUTNAM/LASALLE | 12 | 11 |
|   |                         | CHECKED -  | REVISED - |   |                |           |    |        | CONTRACT NO. 66925                            |         |        |              |                |    |    |
|   |                         | DATE -     | REVISED - |   |                |           |    |        | FED. ROAD DIST. NO. ILLINOIS FED. AID PROJECT |         |        |              |                |    |    |