

F.A.I. RTE.	SECTION	COUNTY	TOTAL SHEETS	SHEET NO.
80	32-2RS-4	GRUNDY	8	1
		ILLINOIS	CONTRACT NO. 66906	

INDEX OF SHEETS

- 1 COVER SHEET
- 2 GENERAL NOTES AND DETAILS
- 3 SUMMARY OF QUANTITIES
- 4-5 SCHEDULES
- 6 TYPICAL SECTIONS
- 7 PROJECT LAYOUT PLAN VIEW
- 8 PATCHING DETAIL

STANDARDS

- 000001-05 STANDARD SYMBOLS, ABBREVIATIONS AND PATTERNS
- 442001-04 CLASS A PATCHES
- 701101-02 OFF-ROAD OPERATIONS MULTILANE, 15' (4.5 m) TO 24" (600 mm) FROM PAVEMENT EDGE
- 701400-03 APPROACH TO LANE CLOSURE, FREEWAY/EXPRESSWAY
- 701401-05 LANE CLOSURE, FREEWAY/EXPRESSWAY
- 701411-05 LANE CLOSURE, MULTILANE, AT ENTRANCE OR EXIT RAMP FOR SPEEDS ≥ 45 MPH
- 701426-03 LANE CLOSURE, MULTILANE INTERMITTENT OR MOVING OPERATION, FOR SPEEDS ≥ 45 MPH
- 701901-01 TRAFFIC CONTROL DEVICES

STATE OF ILLINOIS
DEPARTMENT OF TRANSPORTATION
DIVISION OF HIGHWAYS

**PROPOSED
HIGHWAY PLANS**

**FAI ROUTE 80 (I-80)
SECTION (32-2)RS-4
PROJECT ESP-080-3(131)105
ULTRA-THIN BONDED WEARING COURSE (NOVA CHIP)
GRUNDY COUNTY**

C-93-048-09

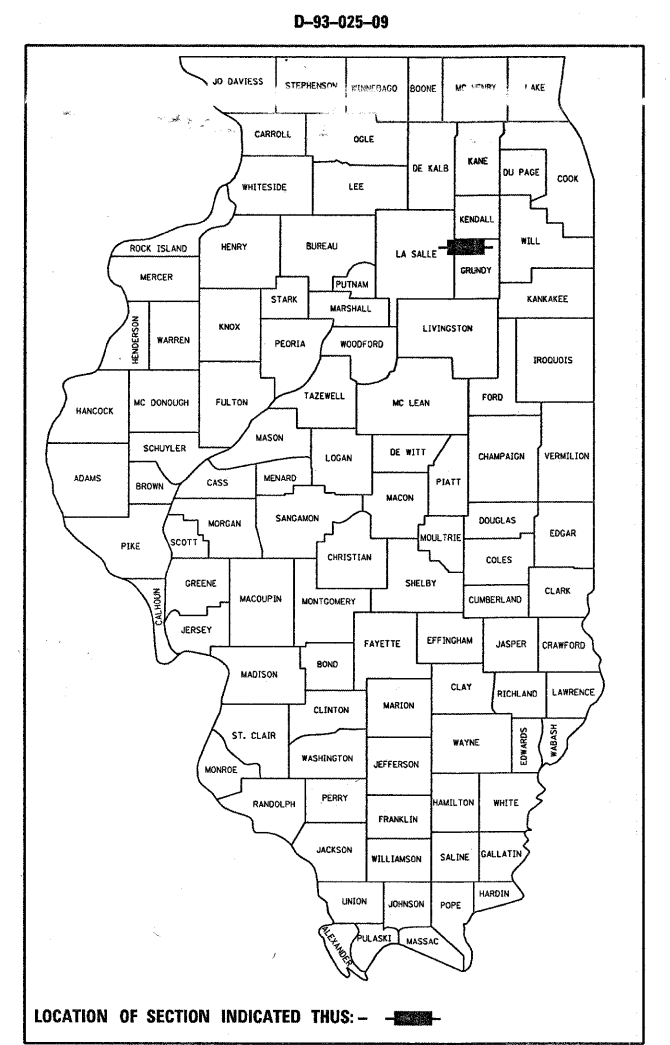

FUNCTIONAL CLASSIFICATION
INTERSTATE
2008 ADT = 30300
P.V. = 58.8% S.U. = 6.5% M.U. = 34.7%

STATE OF ILLINOIS
DEPARTMENT OF TRANSPORTATION
DIVISION OF HIGHWAYS

SUBMITTED 2/13 2009

Marg. F. Ryan
DEPUTY DIRECTOR OF HIGHWAYS, REGION ENGINEER

March 13, 2009
Charles J. Ingersoll
ENGINEER OF DESIGN AND ENVIRONMENT

March 13, 2009
Christine M. Reed
DIRECTOR OF HIGHWAYS, CHIEF ENGINEER

**PRINTED BY THE AUTHORITY
OF THE STATE OF ILLINOIS**

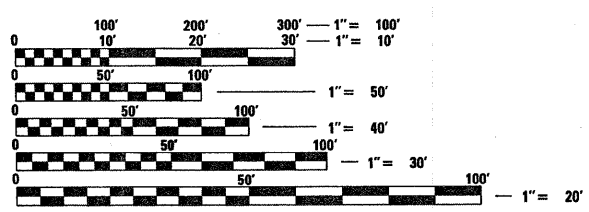

FULL SIZE PLANS HAVE BEEN PREPARED USING STANDARD ENGINEERING SCALES. REDUCED SIZED PLANS WILL NOT CONFORM TO STANDARD SCALES. IN MAKING MEASUREMENTS ON REDUCED PLANS, THE ABOVE SCALES MAY BE USED.

J.U.L.I.E.
JOINT UTILITY LOCATION INFORMATION FOR EXCAVATION
1-800-892-0123
OR 811

**PROJECT ENGINEER: C. REED
UNIT CHIEF: B. DUNCAN
DISTRICT 3 NO. (815) 434-6131
CONTRACT NO. 66906**

**BEGIN PROJECT
STA 846+70**

**SN 032-0010
STA 1068+30**

**SN 032-0012
STA 1131+99**

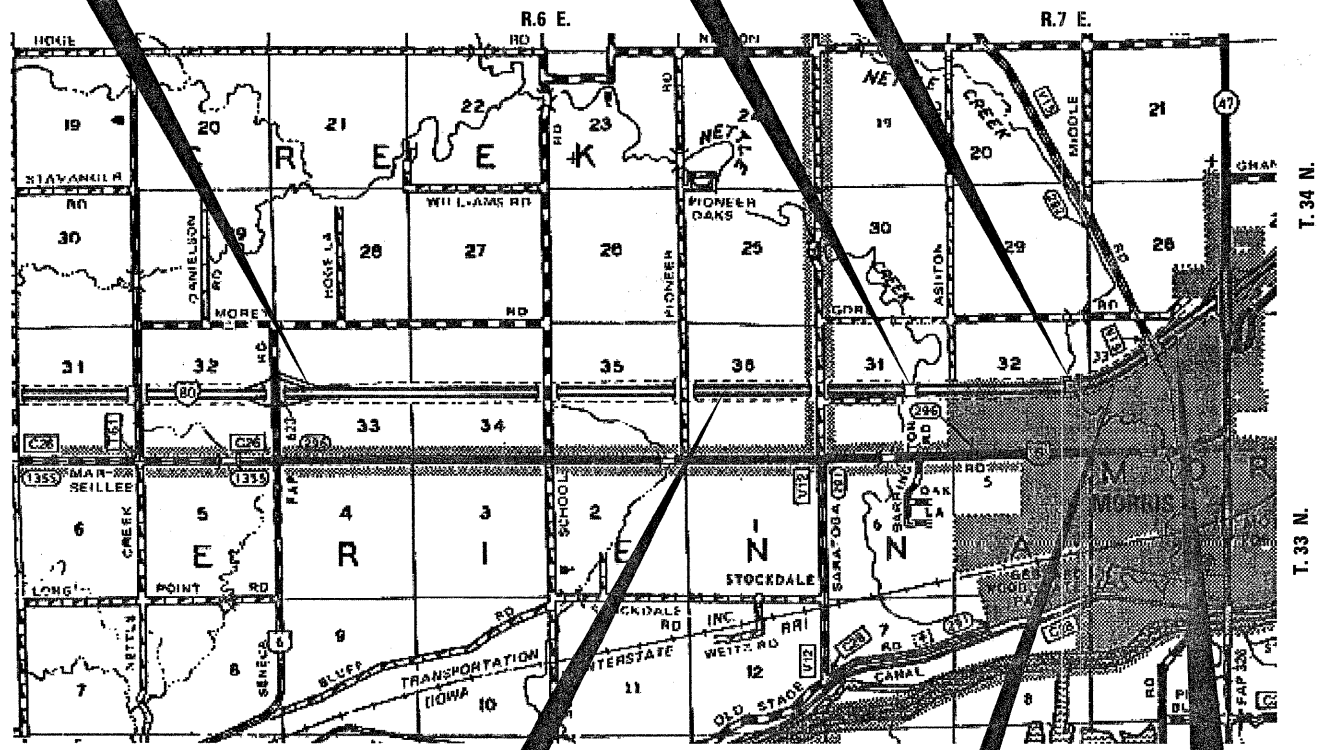

**SN 032-2524
STA 996+60**

**STATION EQUATION:
STA 1157+55.62 BK =
STA 1157+72.37 AH**

**END PROJECT
STA 1179+70**

GROSS AND NET LENGTH = 33283.25 FT. = 6.30 MILES