

F.A.P. RTE.	SECTION	COUNTY	TOTAL SHEETS	SHEET NO.
681	0151RS-1	LIVINGSTON	279	238
STA. 187+73.00		TO STA. 187+75.00		
FED. ROAD DIST. NO. ILLINOIS		FED. AID PROJECT		
70		CONTRACT NO. 66375		

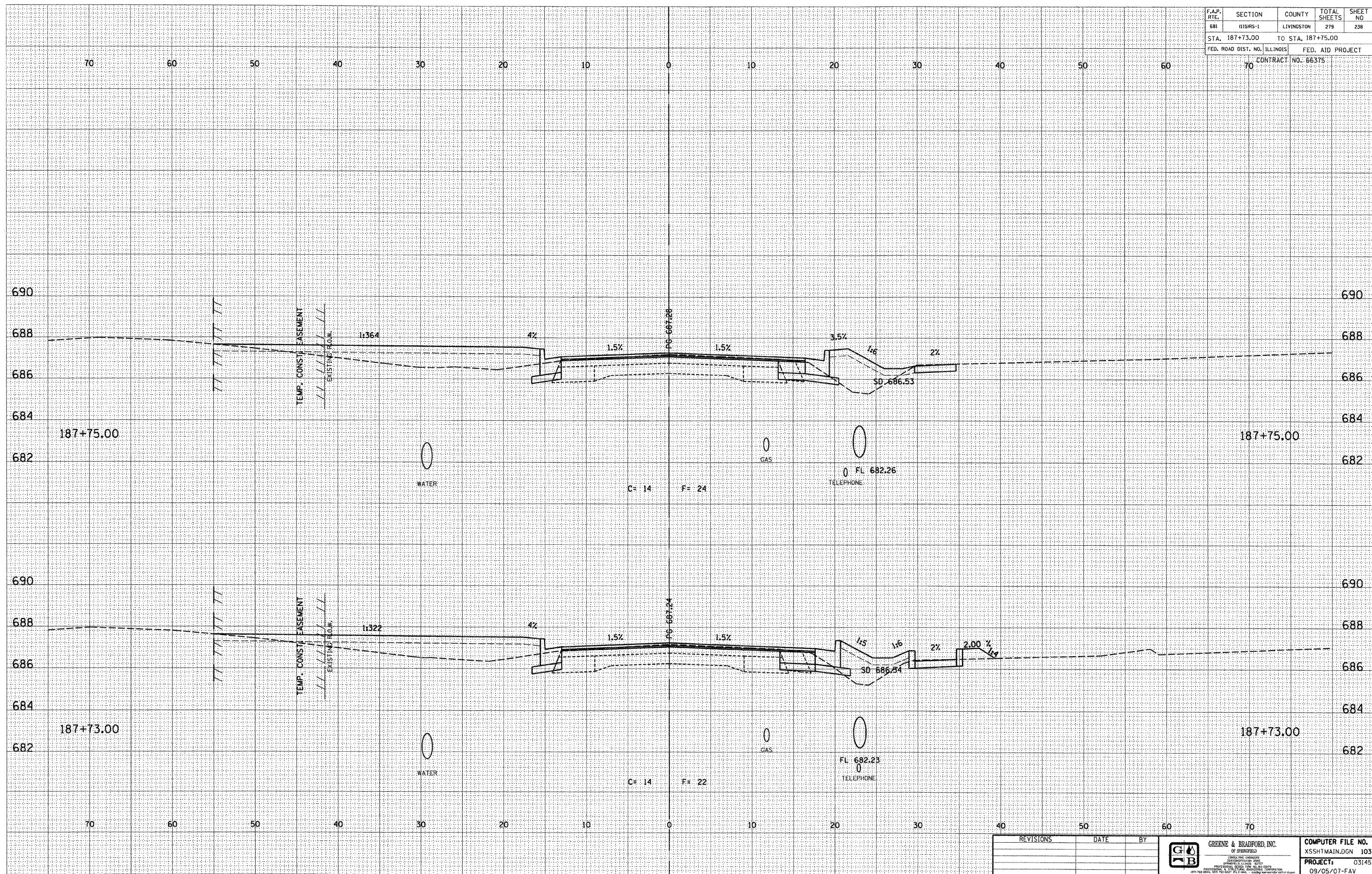

DESIGN		
INT.	DATE	REASON

BY	DATE

PLOTS & CHECKS			
INT.	DATE	NO.	REASON

BY	DATE

CHECKS		
INT.	DATE	REASON

REVISIONS	DATE	BY

GREENE & BRADFORD, INC.
OF SPRINGFIELD
CONSULTING ENGINEERS
PROFESSIONAL ENGINEERS
REGISTERED IN ILLINOIS
1075 1/2 BRADLEY BLVD. SPRINGFIELD, ILLINOIS 62761
(618) 752-8844 FAX (618) 752-8857

COMPUTER FILE NO.
XS5HTMAIN.DGN 103
PROJECT: 03145
09/05/07-FAV

E-XSEC 2:1 06/09/03

CROSS SECTIONS - FAP 681 (IL RTE. 116) LIVINGSTON COUNTY
STA. 187+73.00 TO STA. 187+75.00