

F.A.P. RTE.	SECTION	COUNTY	TOTAL SHEETS	SHEET NO.
681	115RS-1	LIVINGSTON	279	225
STA. 184+00.00		TO STA. 184+25.00		
FED. ROAD DIST. NO. ILLINOIS			FED. AID PROJECT	
			CONTRACT NO. 66375	

DESIGN		
INT.	DATE	REASON

BY	DATE

PLOTS & CHECKS			
INT.	DATE	NO.	REASON

BY	DATE

CHECKS		
INT.	DATE	REASON

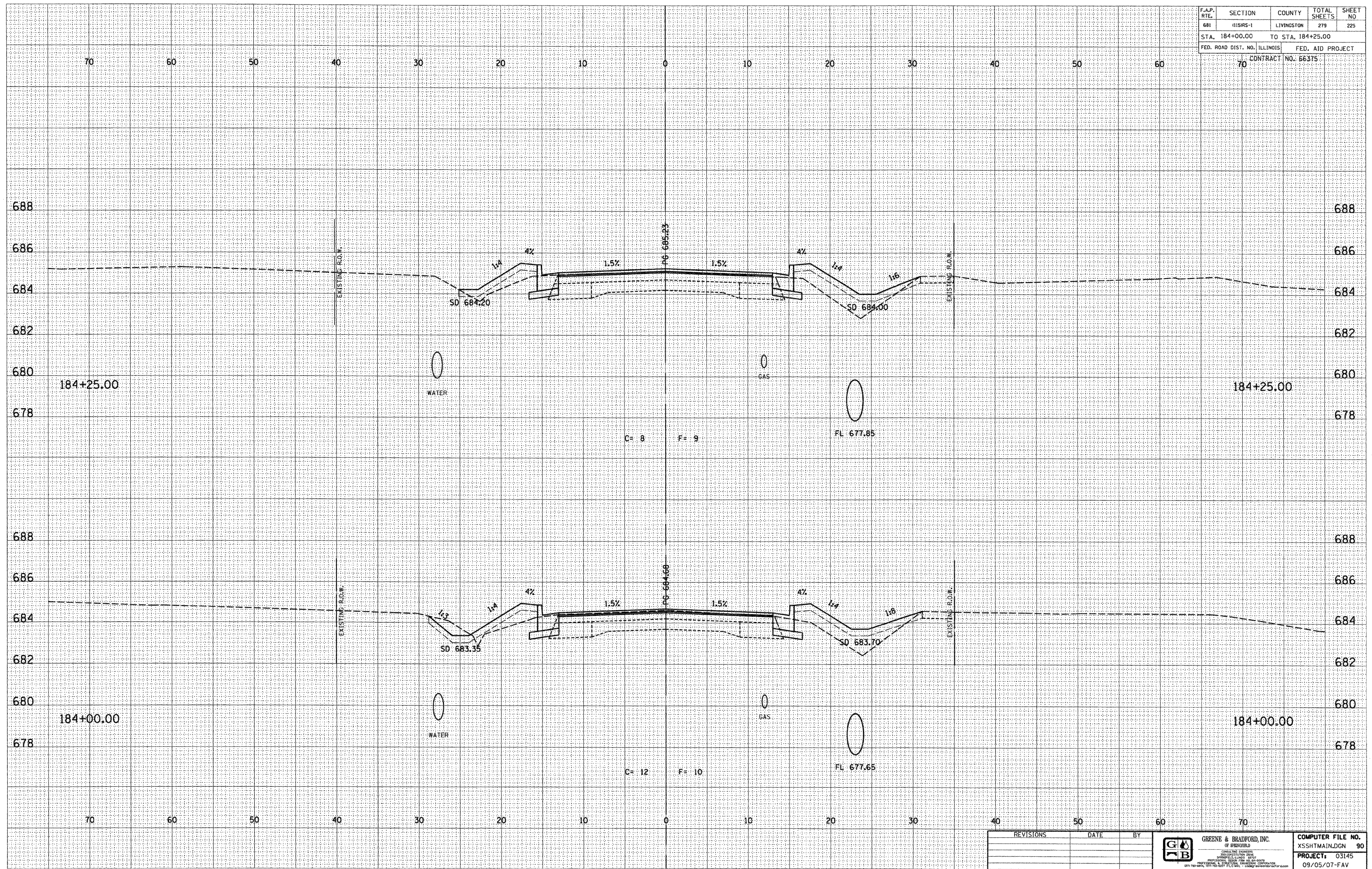

REVISIONS	DATE	BY

GREENE & BRADFORD, INC.
 OF ENGINEERS
 CONSULTING ENGINEERS
 1100 WEST 10TH STREET, SUITE 100
 ST. LOUIS, MISSOURI 63102
 (314) 782-2200 FAX (314) 782-2201
 WWW.GREENE-AND-BRADFORD.COM

COMPUTER FILE NO.
XSSHTMAIN.DGN 90

PROJECT: 03145

09/05/07-FAV

E-XSEC 2:1 06/09/03

CROSS SECTIONS - FAP 681 (IL RTE. 116) LIVINGSTON COUNTY
 STA. 184+00.00 TO STA. 184+25.00