

F.A.P. RTE.	SECTION	COUNTY	TOTAL SHEETS	SHEET NO
681	01SR5-1	LIVINGSTON	279	223
STA. 183+39.00		TO STA. 183+50.00		
FED. ROAD DIST. NO. ILLINOIS		FED. AID PROJECT		
70		CONTRACT NO. 66375		

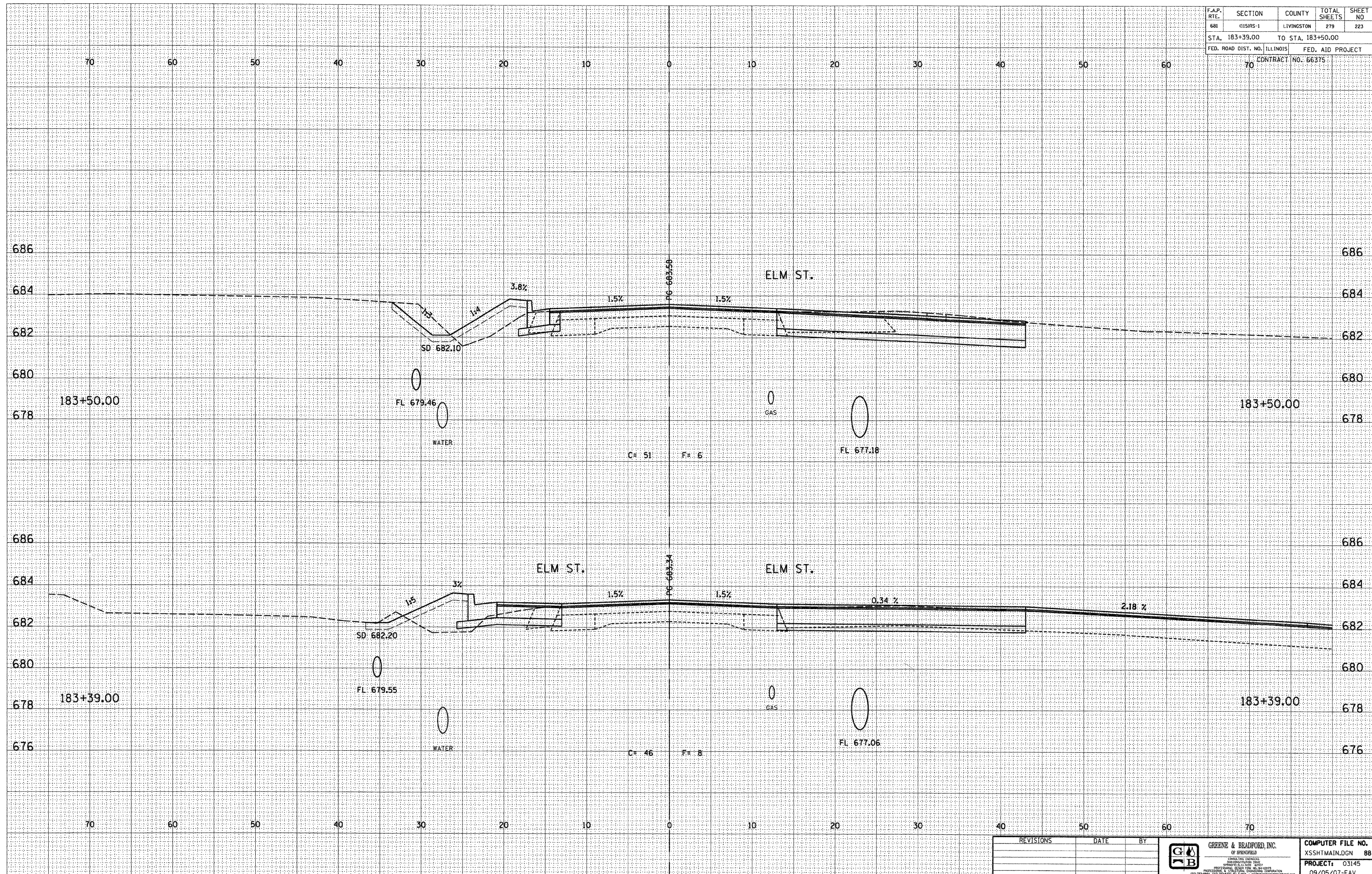

DESIGN		
INT.	DATE	REASON

BY	DATE

PLOTS & CHECKS			
INT.	DATE	NO.	REASON

BY	DATE

CHECKS		
INT.	DATE	REASON

REVISIONS	DATE	BY

GREENE & BRADFORD, INC.
 OF SPRINGFIELD
 REGISTERED PROFESSIONAL ENGINEERS
 LICENSE NO. 15121
 PROFESSIONAL SEAL NO. 15121
 1001 E. BRADLEY BLVD., SPRINGFIELD, ILL. 62781
 (417) 762-8844 FAX (417) 762-8227 P.L.L.C. #00287-000000000000000000

COMPUTER FILE NO.	88
XSSHTMAIN.DGN	
PROJECT: 03145	
09/05/07-FAV	

E-XSEC 2:1 06/09/03

CROSS SECTIONS - FAP 681 (IL RTE. 116) LIVINGSTON COUNTY
 STA. 183+39.00 TO STA. 183+50.00