

F.A.P. RTE.	SECTION	COUNTY	TOTAL SHEETS	SHEET NO
681	0151RS-1	LIVINGSTON	279	203
STA. 177+35.00		TO STA. 177+50.00		
FED. ROAD DIST. NO. ILLINOIS		FED. AID PROJECT		
		CONTRACT NO. 66375		

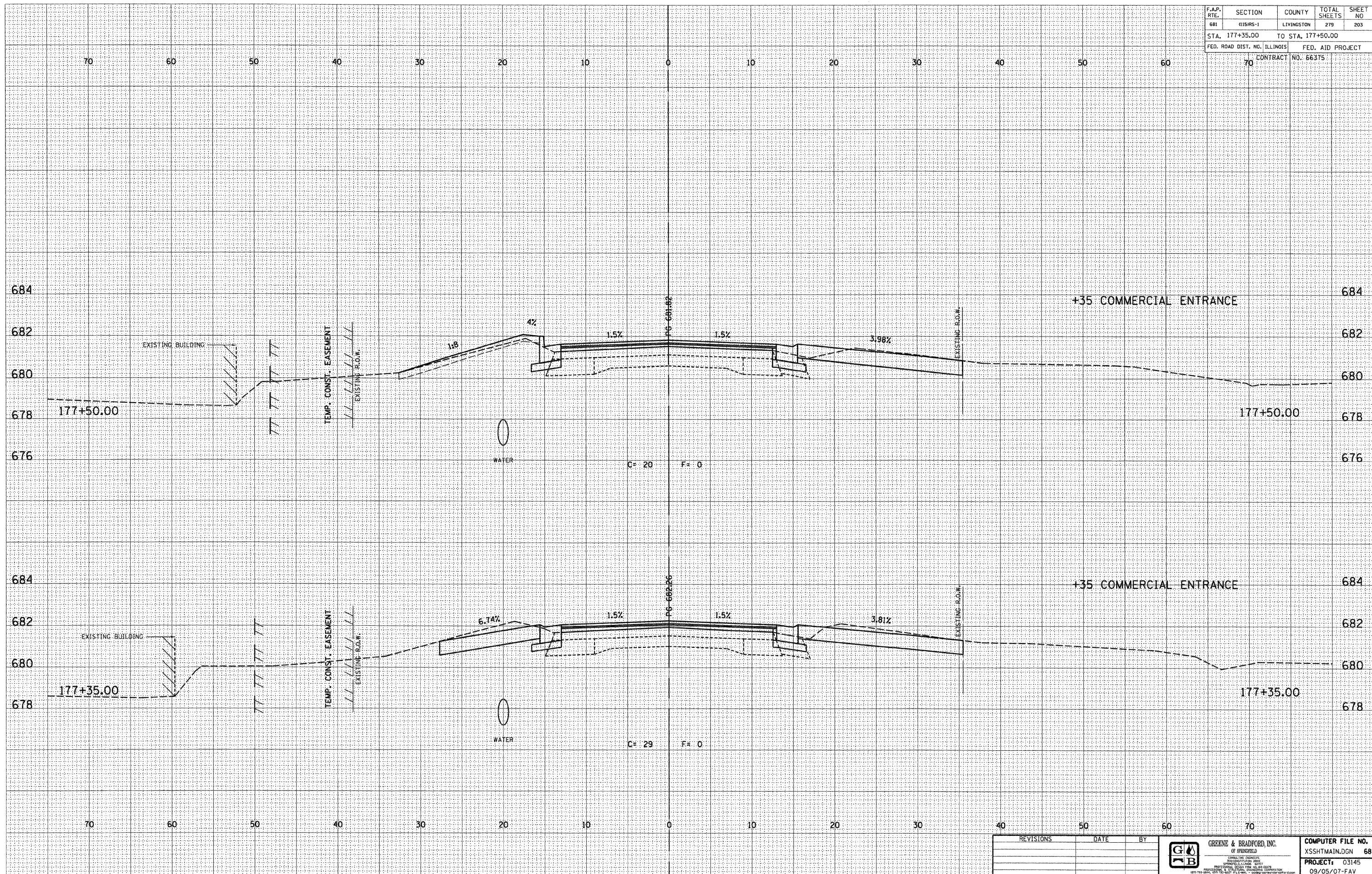

DESIGN		
INT.	DATE	REASON

BY		DATE

PLOTS & CHECKS			
INT.	DATE	NO.	REASON

BY		DATE

CHECKS		
INT.	DATE	REASON

REVISIONS	DATE	BY		GREENE & BRADFORD, INC. OF SPRINGFIELD CONSULTING ENGINEERS PROFESSIONAL SERVICE CORPORATION 1071 7th Street, Springfield, IL 62761 (417) 781-8800	COMPUTER FILE NO. XSSHTMAIN.DGN 68 PROJECT: 03145 09/05/07-FAV

E-XSEC 2:1 06/09/03

CROSS SECTIONS - FAP 681 (IL RTE. 116) LIVINGSTON COUNTY
 STA. 177+35.00 TO STA. 177+50.00