

F.A.P. RTE.	SECTION	COUNTY	TOTAL SHEETS	SHEET NO.
681	116RS-1	LIVINGSTON	279	183
STA. 170+50.00		TO STA. 170+57.00		
FED. ROAD DIST. NO. ILLINOIS		FED. AID PROJECT		
		CONTRACT NO. 66375		

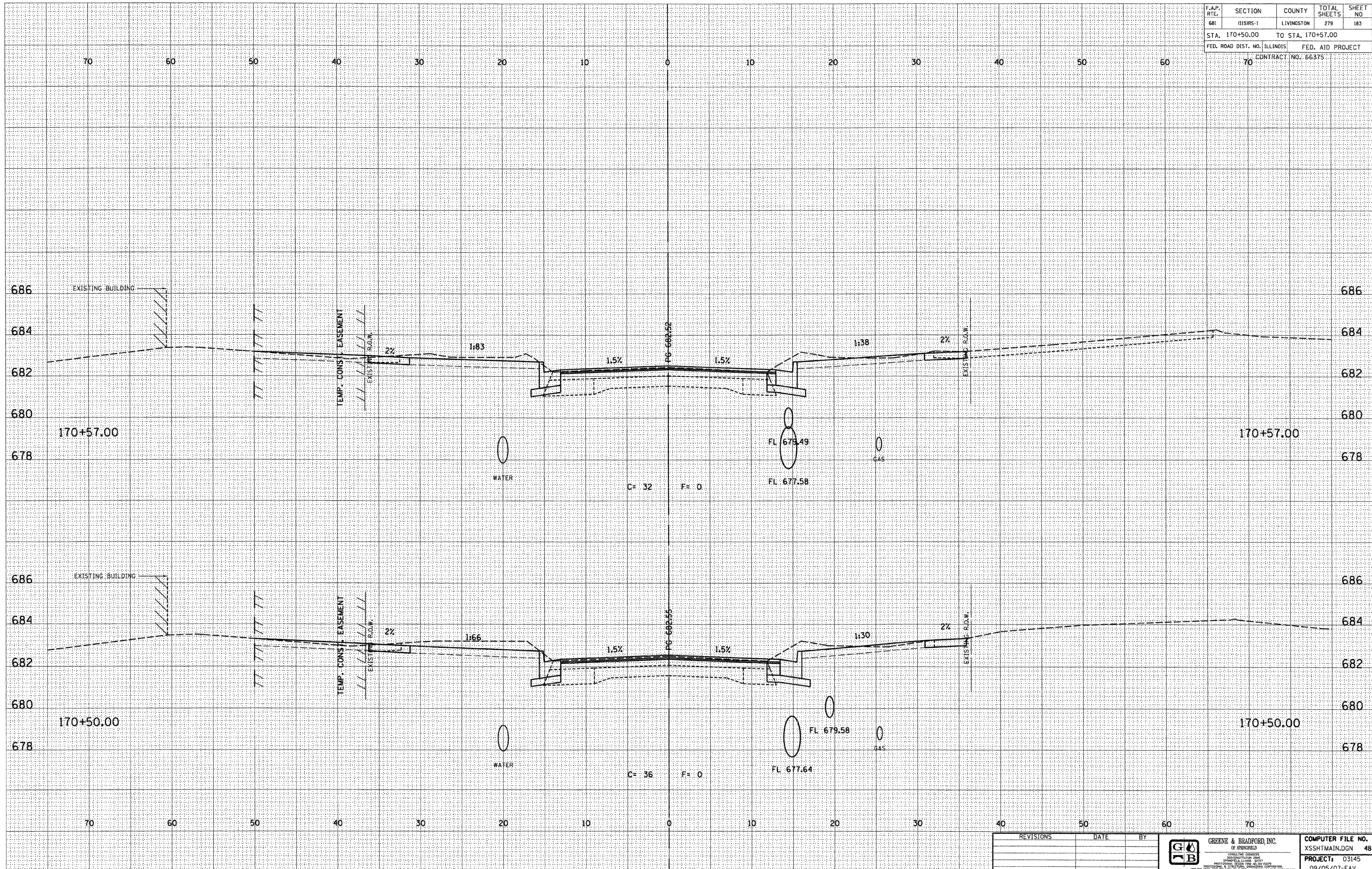

DESIGN		
INT.	DATE	REASON

BY	DATE

PLOTS & CHECKS			
INT.	DATE	NO.	REASON

BY	DATE

CHECKS		
INT.	DATE	REASON

REVISIONS	DATE	BY

GREENE & BRADFORD, INC.
 OF SPRINGFIELD
 CIVIL ENGINEERS
 1000 CONSTITUTION DRIVE
 SPRINGFIELD, ILLINOIS 62761
 PHONE: 217-223-8227 FAX: 217-223-8228
 WWW: WWW.GREENE-AND-BRADFORD.COM

COMPUTER FILE NO.	48
XSSHTMAIN.DGN	
PROJECT:	03145
	09/05/07-FAV

E-XSEC 2:1 06/09/03

CROSS SECTIONS - FAP 681 (IL RTE. 116) LIVINGSTON COUNTY
 STA. 170+50.00 TO STA. 170+57.00