

F.A.P. RTE.	SECTION	COUNTY	TOTAL SHEETS	SHEET NO.
681	(115)RS-1	LIVINGSTON	279	59
STA. 161+00		TO STA. 167+00		
FED. ROAD DIST. NO.	ILLINOIS FED. AID PROJECT		CONTRACT NO. 66375	

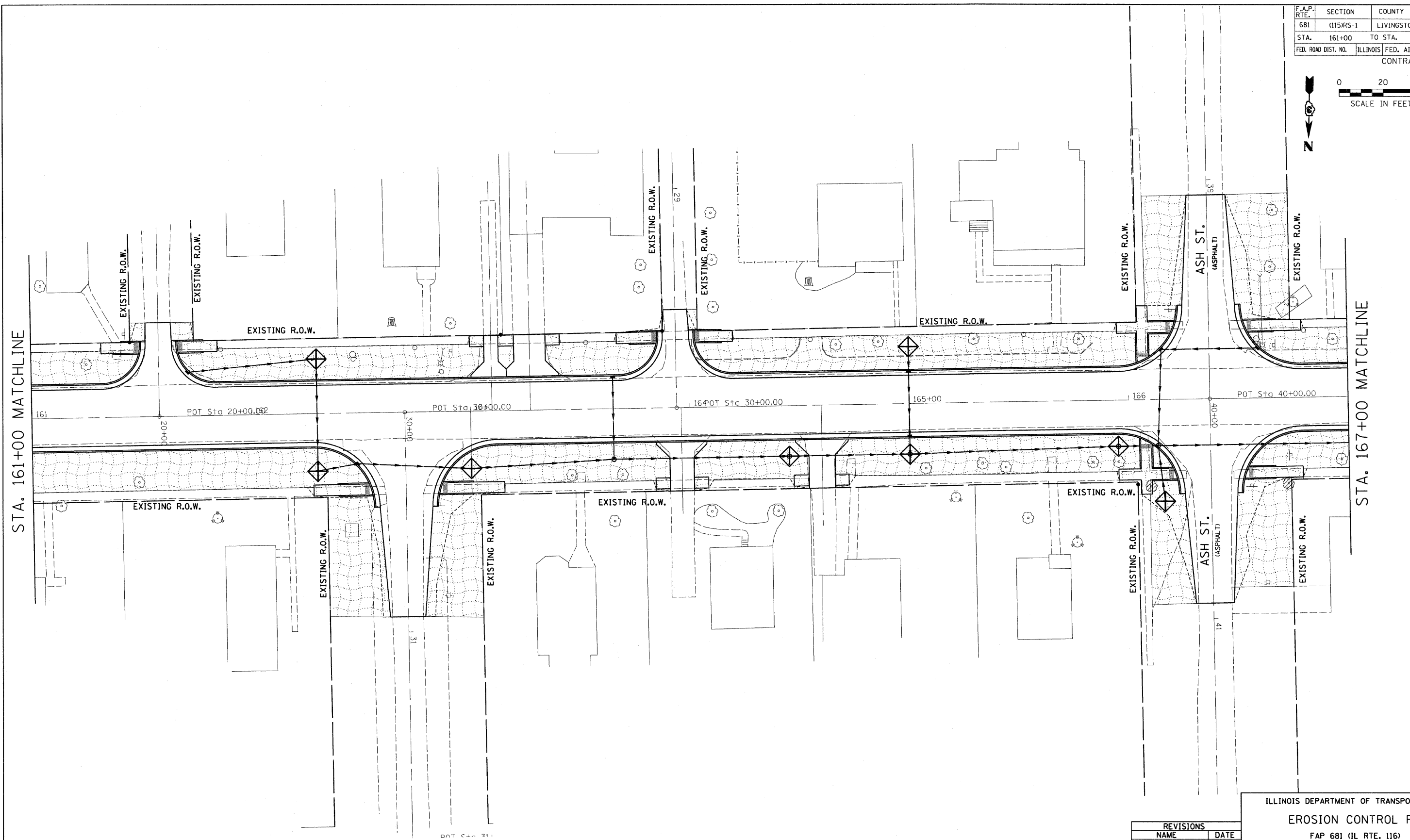
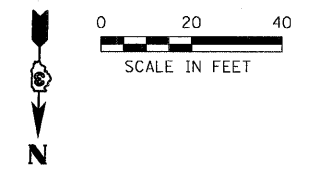

REVISIONS	
NAME	DATE

ILLINOIS DEPARTMENT OF TRANSPORTATION
EROSION CONTROL PLAN
 FAP 681 (IL RTE. 116)
 SECTION (115)RS-1
 LIVINGSTON COUNTY
 VILLAGE OF CULLOM

SCALE: AS SHOWN
 DATE: _____
 DRAWN BY: EJR
 CHECKED BY: TMM

McDonough-Whitlow, P.C.
 Consulting Engineers & Land Surveyors

138 East Wood Street
 Hillboro, IL 62049
 Phone: 217.532.9233
 Fax: 217.532.4300
 MW PROJ. * 03-060

7/8/2009 9:24:30 AM J:\03\15\DRAWINGS\EROSION\2.dwg