

STATE OF ILLINOIS
DEPARTMENT OF TRANSPORTATION

ROUTE NO.	SECTION	COUNTY	TOTAL SHEETS	SHEET NO.	SHEET NO. 2
FAI 74	*	ROCK ISLAND	246	189	11 SHEETS
FED. ROAD DIST. NO. 7	ILLINOIS	FED. AID PROJECT-			

* 81 (1-2, 1, 2-2) RS-1 & M

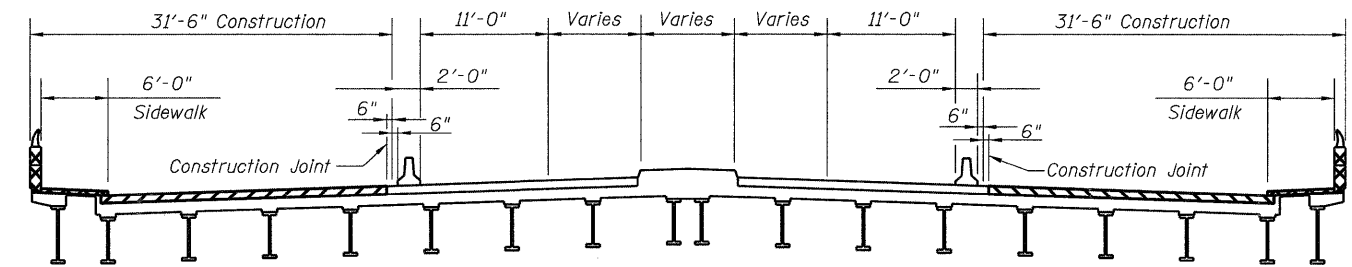
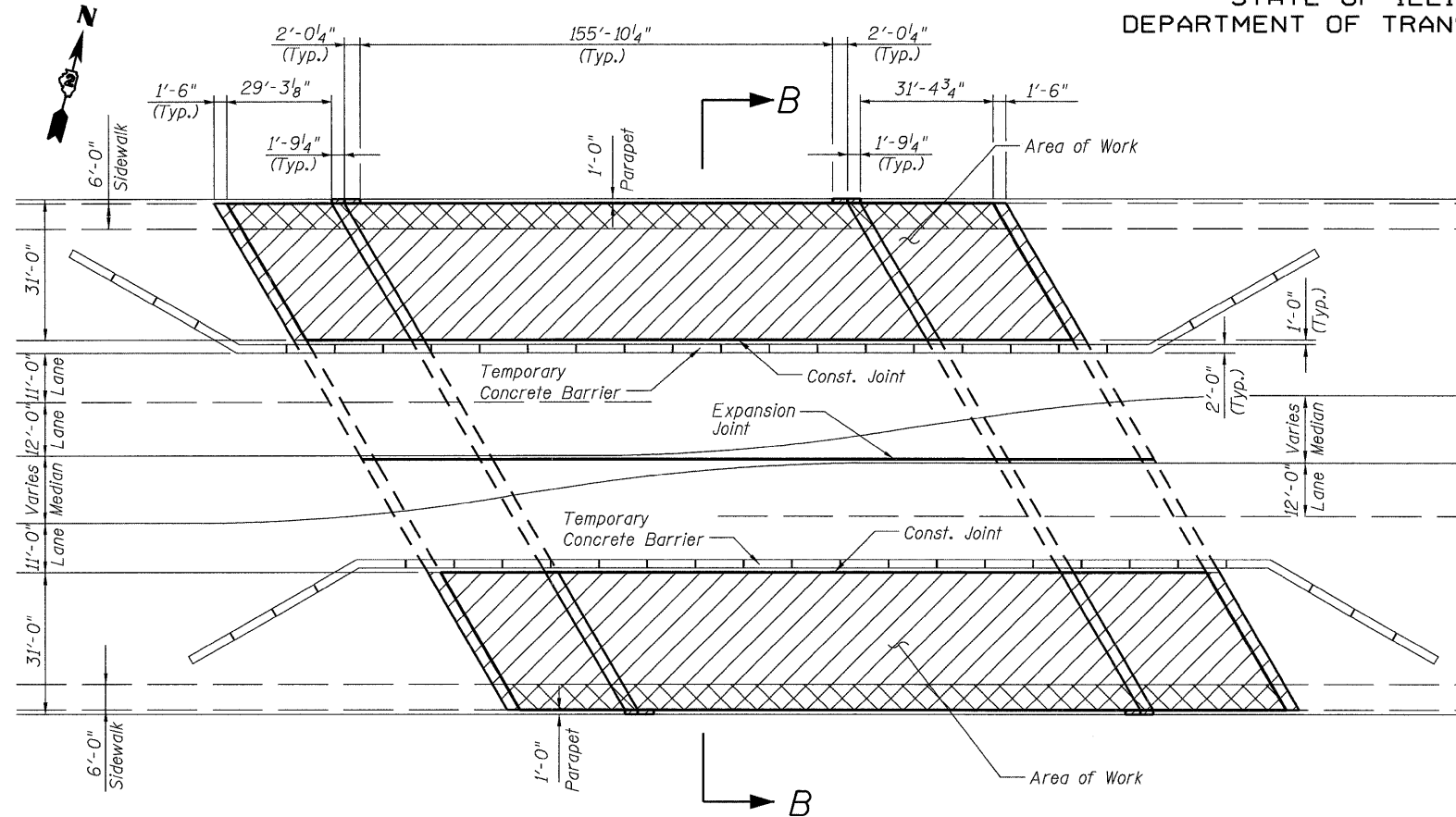

SECTION B-B

STAGE I CONSTRUCTION

Install temporary concrete barrier as shown. *

Move traffic to Stage I traffic lanes.

Sawcut concrete wearing surface and remove.

Replace bridge joints and repair sidewalks.

Install new wearing surface & waterproofing membrane.

Note: North and South Sidewalks shall not be closed

at the same time during construction. One sidewalk to

remain open at all times.

- Deck overlay Replacement
- Sidewalk Repair (paid for as Deck Slab Repair)

* For temporary concrete barrier details, see sheet 10 of 11.

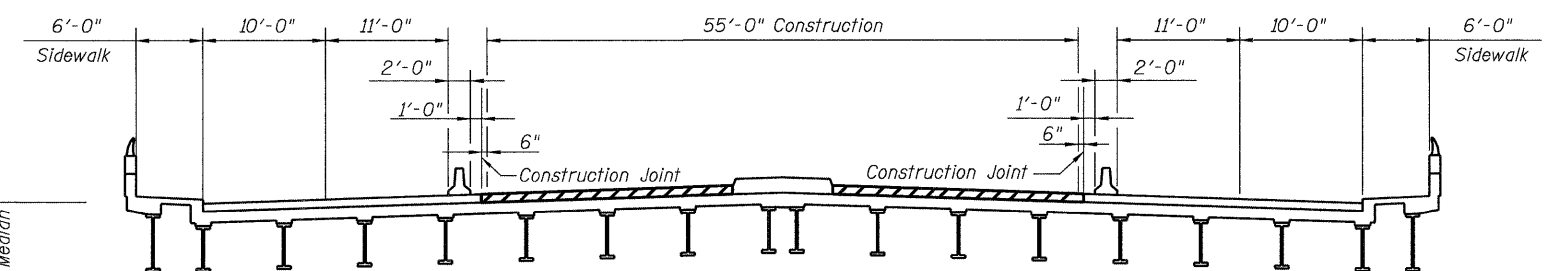
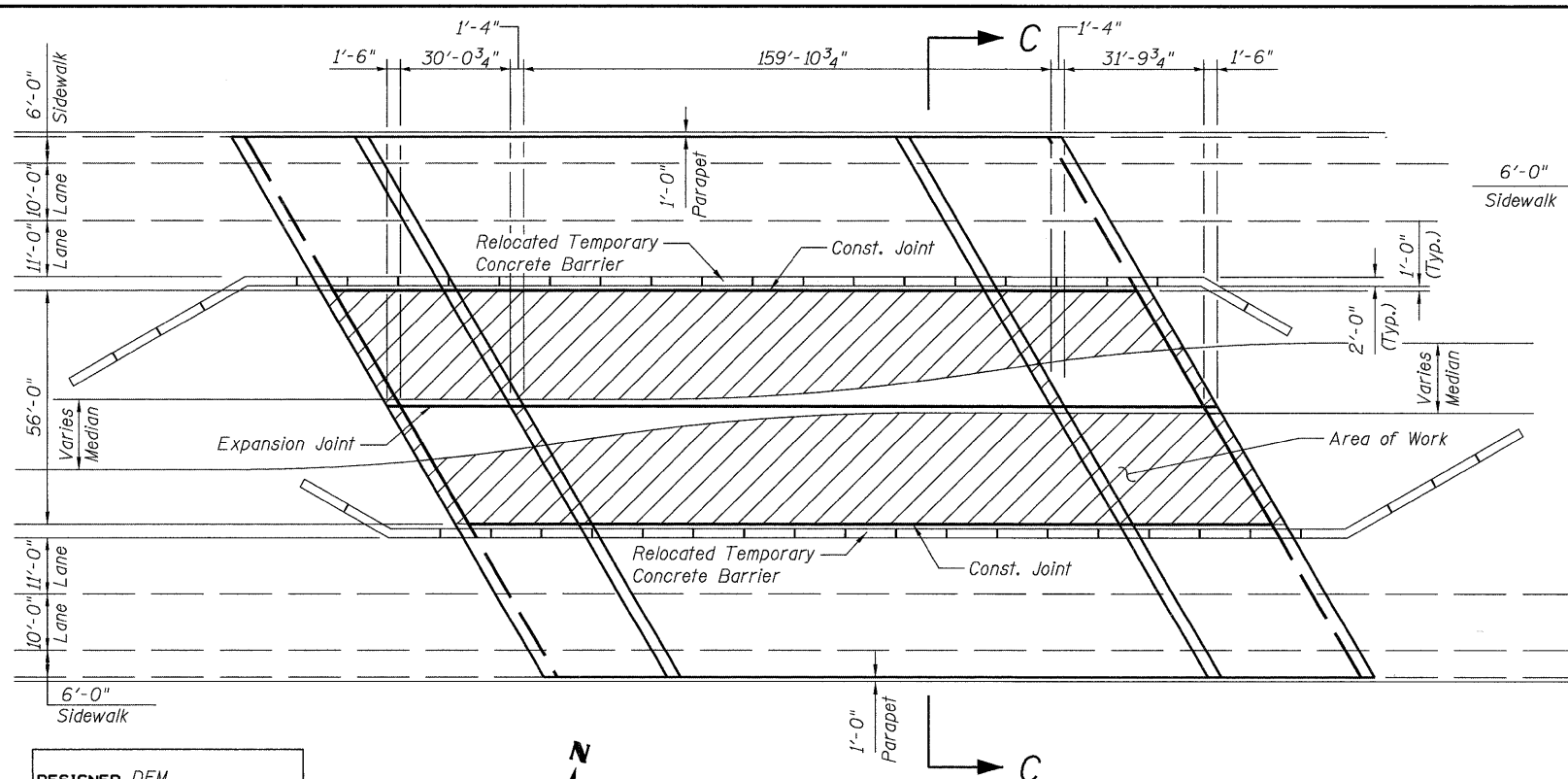

SECTION C-C

STAGE II CONSTRUCTION

Relocate temporary concrete barrier as shown. *

Move traffic to Stage II traffic lanes.

Remove concrete wearing surface.

Replace bridge joints.

Install new wearing surface & waterproofing membrane.

Remove temporary concrete barrier.

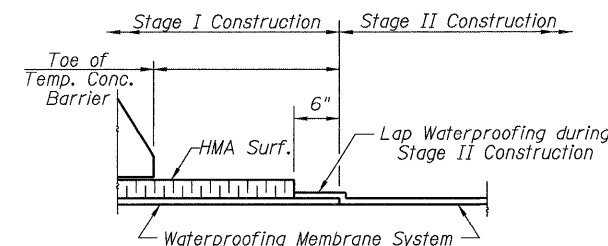

WATERPROOFING TREATMENT
AT STAGE CONSTRUCTION

STAGING PLAN
23RD AVE. OVER F.A.I. 74
ROCK ISLAND COUNTY
STRUCTURE NO. 081-0105

DESIGNED	DFM
CHECKED	DFM
DRAWN	EBS
CHECKED	DFM