

# DETOUR FOR I-74 WB (NB) TO IL 5 EB (RAMP D)

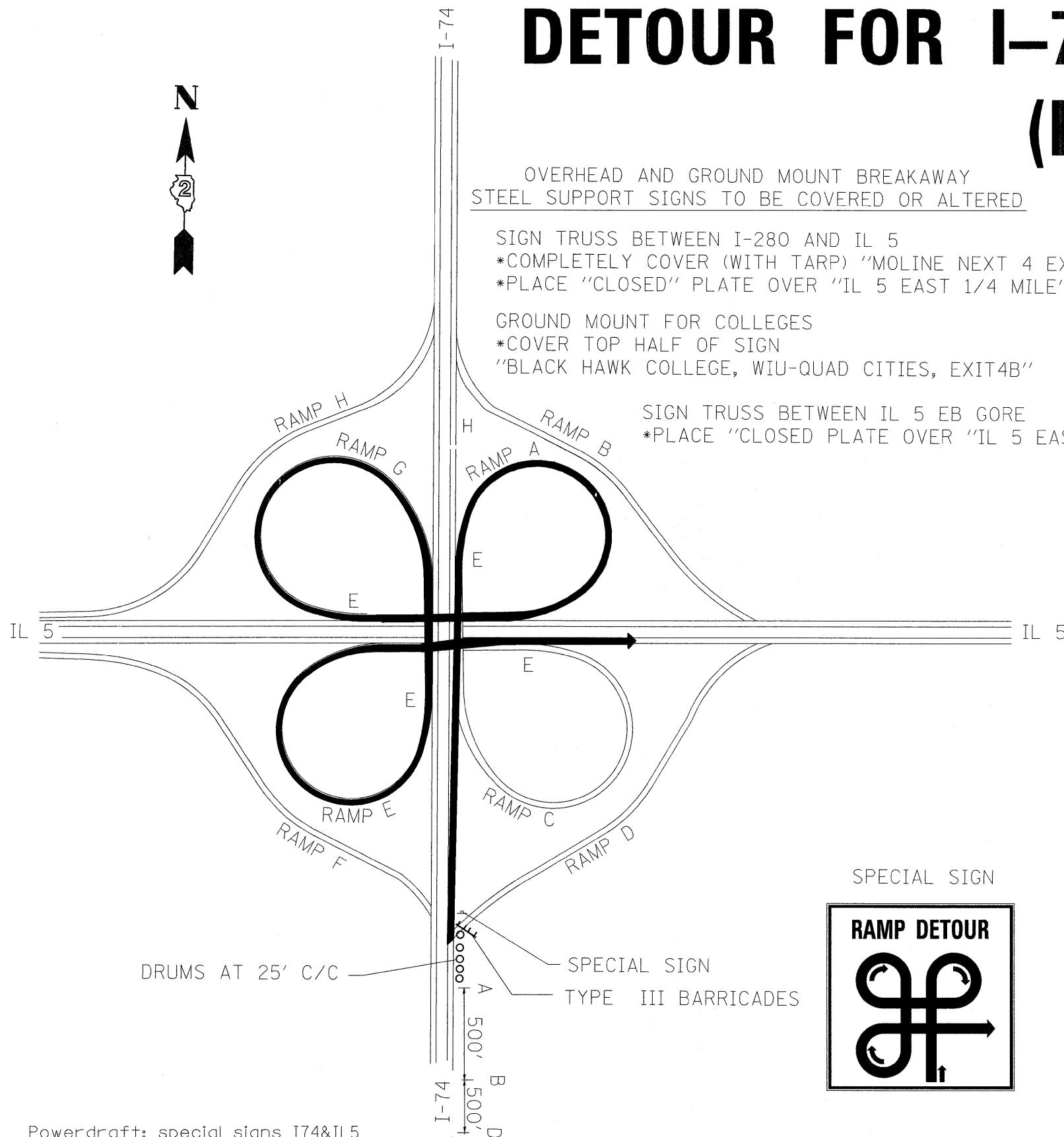

OVERHEAD AND GROUND MOUNT BREAKAWAY  
STEEL SUPPORT SIGNS TO BE COVERED OR ALTERED

SIGN TRUSS BETWEEN I-280 AND IL 5  
\*COMPLETELY COVER (WITH TARP) "MOLINE NEXT 4 EXITS"  
\*PLACE "CLOSED" PLATE OVER "IL 5 EAST 1/4 MILE"

GROUND MOUNT FOR COLLEGES  
\*COVER TOP HALF OF SIGN  
"BLACK HAWK COLLEGE, WIU-QUAD CITIES, EXIT4B"

SIGN TRUSS BETWEEN IL 5 EB GORE  
\*PLACE "CLOSED" PLATE OVER "IL 5 EAST" →

DRUMS AT 25' C/C

SPECIAL SIGN

TYPE III BARRICADES

SPECIAL SIGN

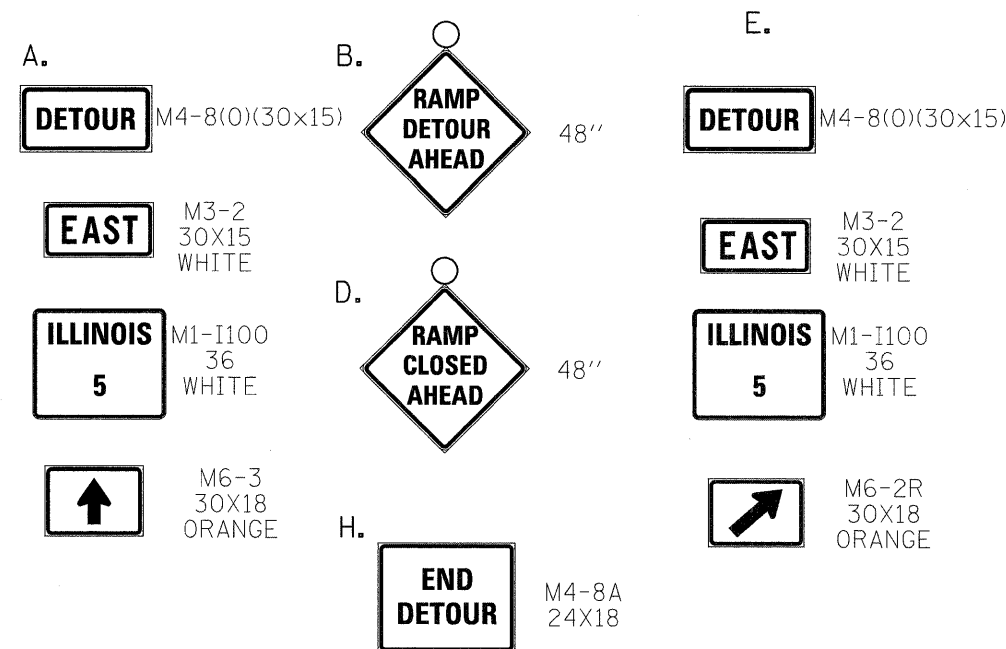
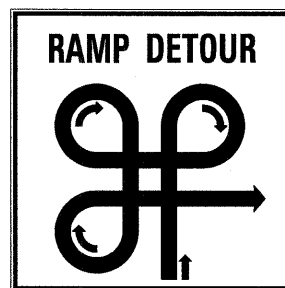

NOTE: THE TYPE III BARRICADE SHALL HAVE  
A RAMP CLOSED SIGN. REVISE SIGN  
R11-2 (Road Closed) to "RAMP CLOSED"



THE CONTRACTOR SHALL BE RESPONSIBLE  
FOR PROVIDING ALL SIGNS REQUIRED FOR  
THE RAMP CLOSURES AND DETOURS.

SEE SPECIAL SIGN DETAILS SHEET  
THE RAMPS SHALL NOT BE CLOSED AT THE  
SAME TIME.

Powerdraft: special signs I74&IL5

FILE NAME =	USER NAME = duncanfa	DESIGNED -	REVISED -	<b>STATE OF ILLINOIS DEPARTMENT OF TRANSPORTATION</b>	<b>DETOUR FOR I-74 WB TO IL 5 EB</b>				F.A.I. RTE.	SECTION	COUNTY	TOTAL SHEETS	SHEET NO.
es\pwwork\PWIDOT\DUNCANFA\dms33952\d08005-shr-ts.dgn		DRAWN -	REVISED -		505	*	ROCK ISLAND	246	105				
PLOT SCALE = 50.0000' / IN.		CHECKED -	REVISED -		SCALE: SHEET NO. OF SHEETS STA. TO STA.				ILLINOIS FED. AID PROJECT				
PLOT DATE = Fri Feb 06 10:54:46 2009		DATE -	REVISED -		CONTRACT NO. 64A97				* 81-(1-2,1,2-2)RS-1&M				