

F.A.I. RTE.	SECTION	COUNTY	TOTAL SHEETS	SHEET NO.
57	1920.1B-R	COOK	101	025
STA.		TO STA.		
FED. ROAD DIST. NO. 1		ILLINOIS FED. AID PROJECT		
CONTRACT NO. 62533				

**NOTES:**

- FOR CURB RAMP AND SIDEWALK DETAILS AND GENERAL NOTES SEE SHEETS 061 TO 064
- ALL SLOPES SHOWN ARE ROUNDED NUMBERS
- THE WIDTHS OF PAVEMENT MARKINGS FOR CROSSWALKS ARE SHOWN ON PAVEMENT MARKING PLANS
- FOR DETAILS OF CURB RAMP AND CURB GUTTER SEE SHEET 060
- KEYSTONE/TOP LANDINGS AREA, RAMPS AND SIDE FLARES WILL BE PAID FOR AS PCC SIDEWALK 8"

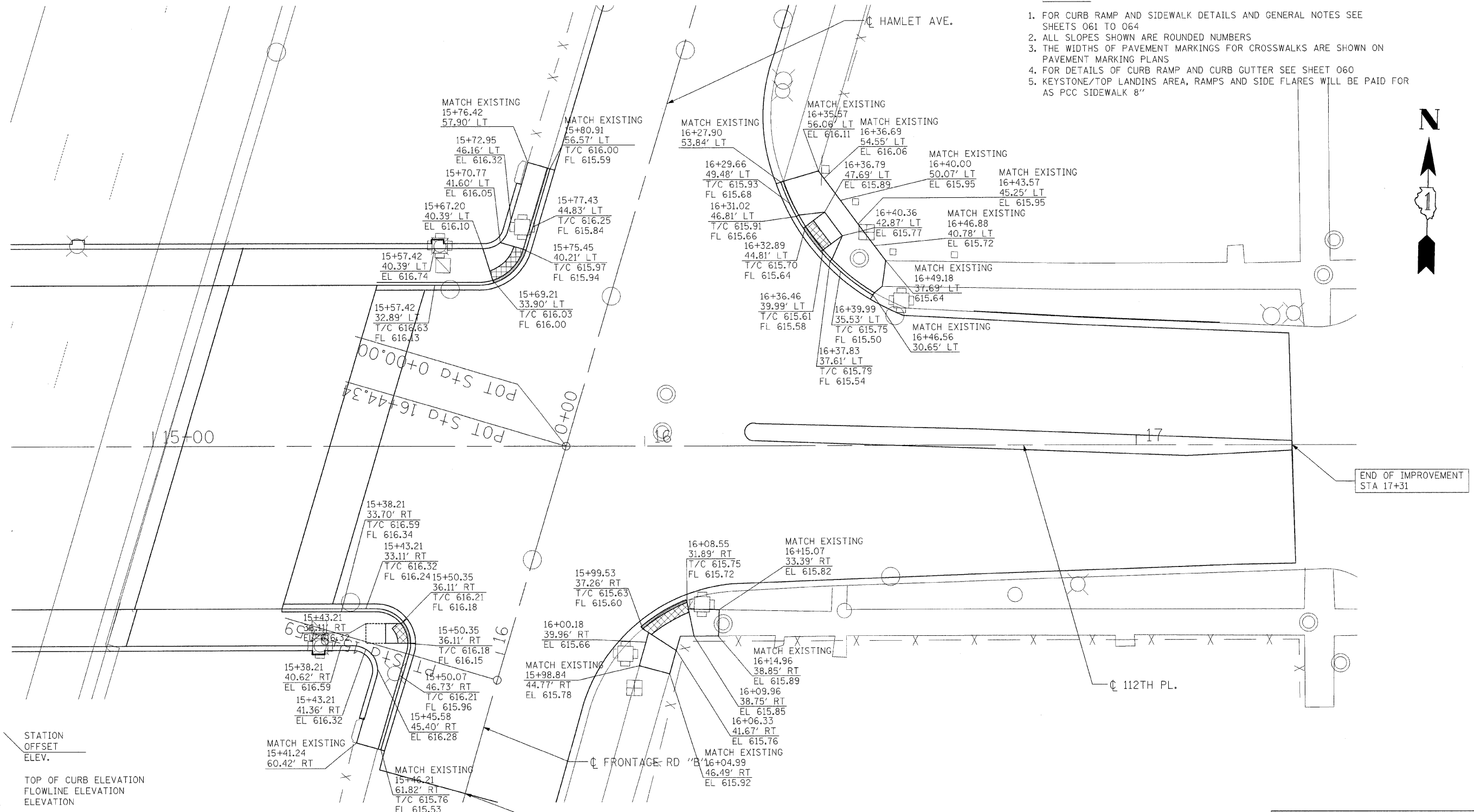

END OF IMPROVEMENT STA 17+31

LIMIT OF CONSTRUCTION STA 15+70

**PROPOSED ADA RAMP GRADING PLAN FOR 112TH PLACE AND HAMLET AVE.**

NOTE: ALL STATIONING BASED OFF 112TH PLACE UNLESS OTHERWISE NOTED.

**LEGEND**

XXX+XX.XX XX.XX' XXX.XX	STATION OFFSET ELEV.
T/C FL EL	TOP OF CURB ELEVATION FLOWLINE ELEVATION ELEVATION
	DETECTABLE WARNING TILES
	DEPRESSED CURB
0.5%	SLOPE DIRECTION SLOPE IN PERCENT
1:64	SLOPE DIRECTION SLOPE IN RISE:RUN

REVISIONS	
NAME	DATE

ILLINOIS DEPARTMENT OF TRANSPORTATION  
112TH PLACE OVER  
F.A.I. ROUTE 57 (INTERSTATE 57)

**112TH PLACE AND HAMLET AVE  
ADA SIDEWALK DETAILS**

SCALE: 1"=10'  
DATE: 01/16/09

DRAWN BY: BRH  
CHECKED BY: ACL

**TENG**  
TENG & ASSOCIATES, INC.  
ENGINEERS/ARCHITECTS/PLANNERS  
205 N. MICHIGAN AVE., CHICAGO, IL 60601  
TELEPHONE: 312/616-9000

\\ALTON888.DGN, \\TPO009.DGN, \\TTB000.DGN, \\VW000.DGN, \\SUIR000.DGN, \\LIT000.DGN, \\VAG-SCRA-CH-VT.DGN, HECHTBR  
 I:\DOCUMENT\930860\AC\AD\RD\RD008\A.DGN  
 1 2 3 4 5 6 7 8 9 10 11 12 13 14 15 16 17 18 19 20 21 22 23 24 25 26 27 28 29 30 31 32 33 34 35 36 37 38 39 40 41 42 43 44 45 46 47 48 49 50 51 52 53 54 55 56 57 58 59 60 61 62