

F.A.I. RTE.	SECTION	COUNTY	TOTAL SHEETS	SHEET NO.
57	1920.1B-R	COOK	101	022
STA.		TO STA.		
FED. ROAD DIST. NO. 1		ILLINOIS	FED. AID PROJECT	
CONTRACT NO. 62533				

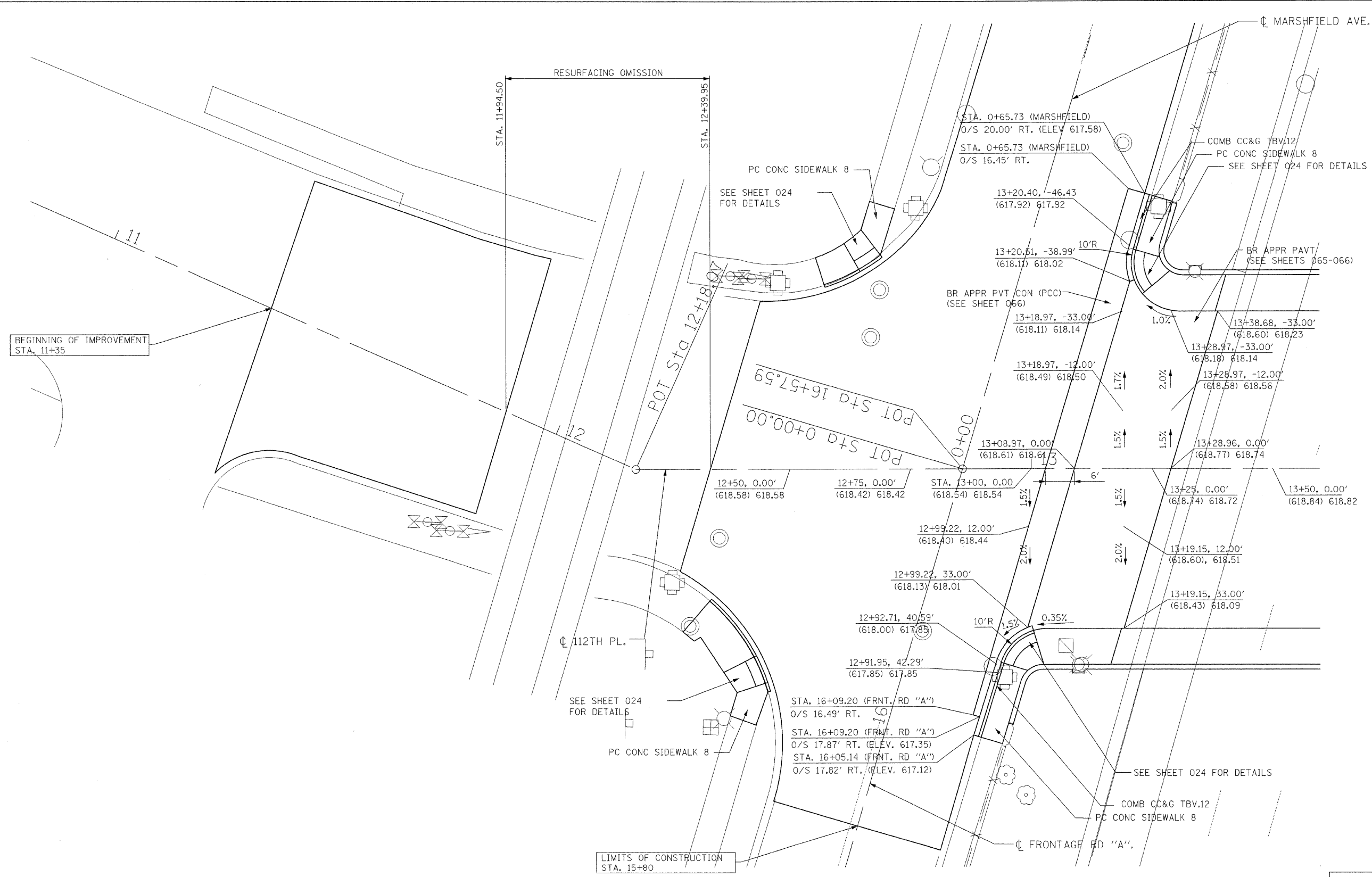
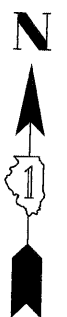

LEGEND
 STA. XX+XX, OFFSET
 (ELEV. XXX.XX) ELEV. XXX.X

**PROPOSED INTERSECTION GRADING PLAN
 FOR 112TH PLACE AND MARSHFIELD AVE.**
 NOTE: ALL STATIONING BASED OFF 112TH PLACE UNLESS OTHERWISE NOTED.

REVISIONS	
NAME	DATE

ILLINOIS DEPARTMENT OF TRANSPORTATION
 112TH PLACE OVER
 F.A.I ROUTE 57 (INTERSTATE 57)
**112TH PLACE AND
 MARSHFIELD AVE
 INTERSECTION GRADING PLAN**
 SCALE: 1"=10'
 DATE: 01/16/09
 DRAWN BY: BRH
 CHECKED BY: ACL
TENG
TEW & ASSOCIATES, INC.
 ENGINEERS/ARCHITECTS/PLANNERS
 205 N. MICHIGAN AVE., CHICAGO, IL 60601
 TELEPHONE: 312/456-9000

..\ALTOON88.DGN, ..\TPO009M.DGN, ..\TBO00M.DGN, ..\REWOODSVC.DGN, ..\SUIRO05V.DGN, ..\RDWOODTK.DGN, ..\LIT000IC.DGN, ..\LIT000IC5.DGN
 H-16-2009, 13:46:38
 T:\DOCUMENT\65208601\CIVIL\DWG\RDWOODSVC.DGN
 1 2 3 4 5 6 7 8 9 10 11 12 13 14 15 16 17 18 19 20 21 22 23 24 25 26 27 28 29 30 31 32 33 34 35 36 37 38 39 40 41 42 43 44 45 46 47 48 49 50 51 52 53 54 55 56 57 58 59 60 61 62