

Notes:
Work this sheet with Sheets S-004 and S-005.

SCREED PLAN

DEFLECTIONS

Girder	A	B	C	D
1 and 14	3/4"	1 1/8"	1/4"	1/4"
2-6 and 9-13	3/4"	1"	3/8"	1/2"
7 and 8	1/2"	3/4"	1/4"	3/8"

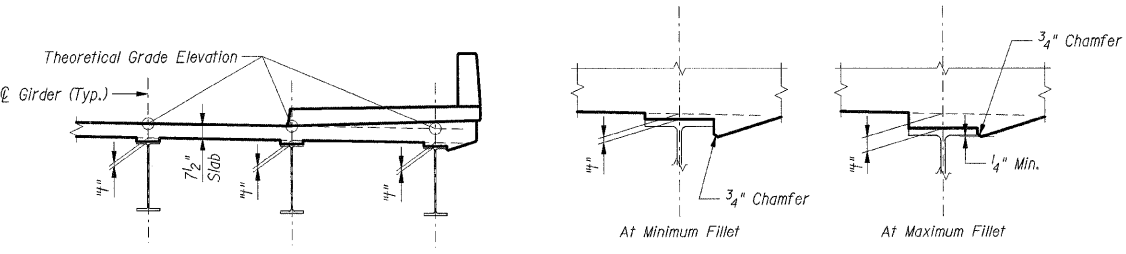

To determine "f": After all structural steel has been erected, elevations of the top flanges of the girders shall be taken at intervals shown above. These elevations subtracted from the "Theoretical Grade Elevations Adjusted for Dead Load Deflections" shown on Sheets S-004 and S-005, minus the slab thickness, equal the fillet heights "f" above the top flanges of the girders.

FILLET HEIGHTS

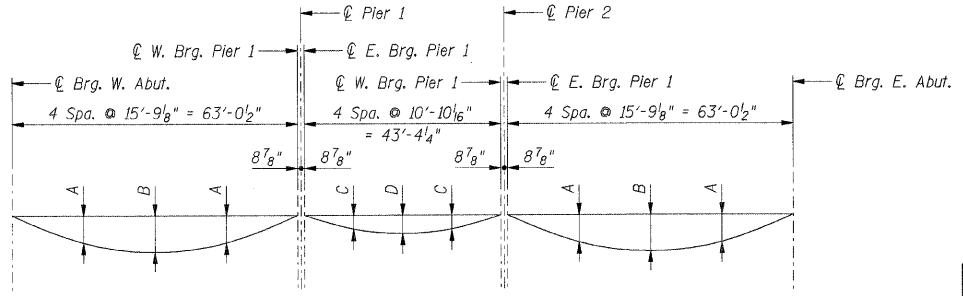

DEAD LOAD DEFLECTION DIAGRAM

(Includes weight of concrete only)

Notes:
The above deflections are not to be used in the field if the Engineer is working from the theoretical grade elevations adjusted for dead load deflections shown on Sheets S-004 and S-005.

SHT. S-003

REVISIONS	
NAME	DATE

ILLINOIS DEPARTMENT OF TRANSPORTATION
 F.A.I. ROUTE 57 (INTERSTATE 57)
 111TH STREET BRIDGE DECK REPLACEMENT
 111th STREET OVER I-57
 SN 016-0989 STA. 556+99.89
 COOK COUNTY

DECK ELEVATION PLAN

DATE: 01/16/09
 DRAWN BY: CCE
 CHECKED BY: JLR

TENG
 TENG & ASSOCIATES, INC.
 ENGINEERS/ARCHITECTS/PLANNERS
 205 N. MICHIGAN AVE., CHICAGO, IL 60601
 TELEPHONE: 312.616.0000

\AFRPOOLIC\DCN... \BIBORBER\DCN... \DKEONR\DCN... \DKEONR\DCN... \DKEONR\DCN... \DKEONR\DCN...
 1-16-2009 14:22:28
 pen: Tabbe: N/A