

F.A.I. RTE.	SECTION	COUNTY	TOTAL SHEETS	SHEET NO.
57	2021.1B-R	COOK	101	027
STA.		TO STA.		
FED. ROAD DIST. NO. 1 ILLINOIS FED. AID PROJECT				
CONTRACT NO. 62532				

REMOVAL NOTES

- A - REMOVE H.P.S.V. LUMINAIRE AND MAST ARM
- B - REMOVE POLE, CITY STEEL
- C - REMOVE FOUNDATION
- D - EXISTING POLE TO REMAIN
- E - EXISTING CABLE TO BE REMOVED
- F - EXISTING CONDUIT TO BE REMOVED
- G - EXISTING CONTROLLER AND FOUNDATION TO BE REMOVED

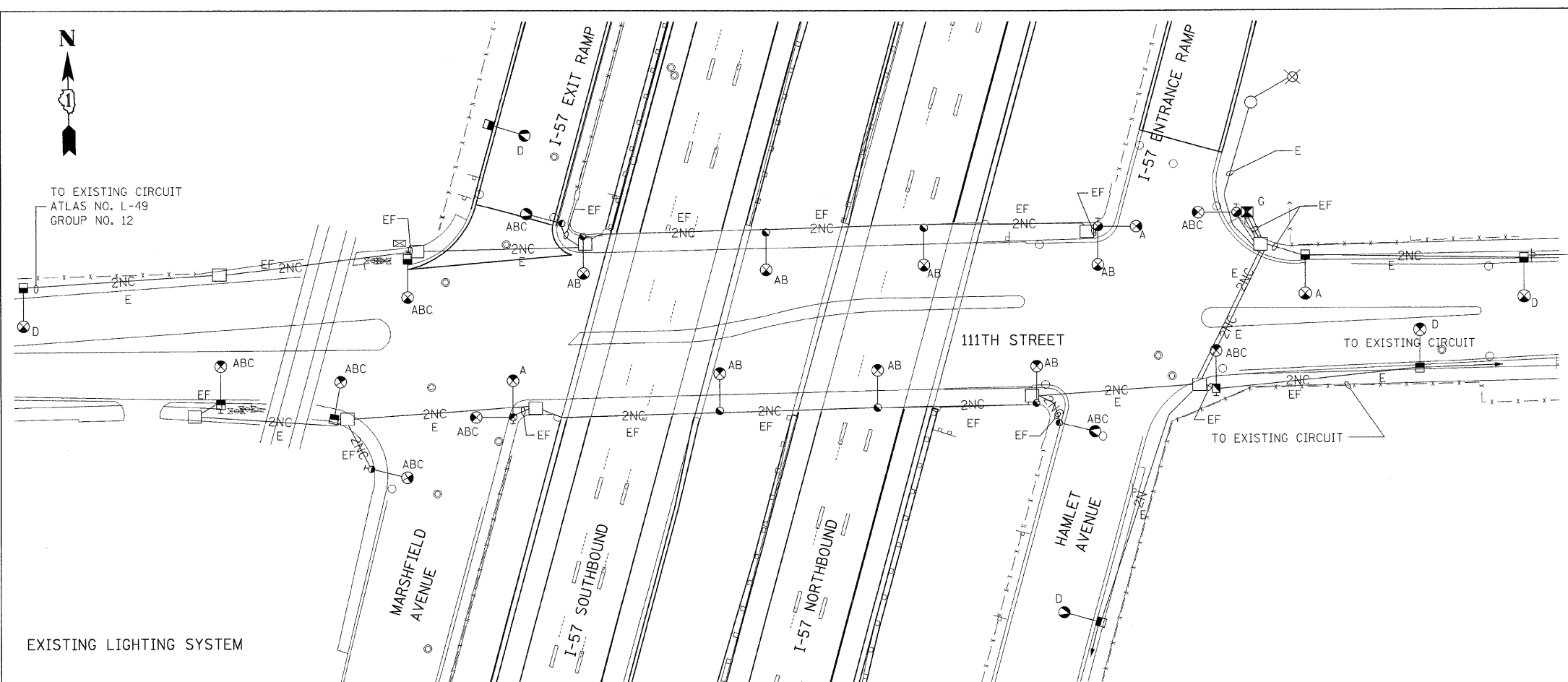

INSTALLATION NOTES

- H - INSTALL 400W H.P.S.V. LUMINAIRE AND 12' MAST ARM
- I - INSTALL POLE, CITY STEEL, ANCHOR BASE, SIZE AS INDICATED
- J - INSTALL NEW CONCRETE FOUNDATION
- K - CONDUIT ATTACHED TO STRUCTURE (NOTE 6)
- EM - CONDUIT EMBEDDED IN BARRIER WALL
- T - CONDUIT IN TRENCH
- L - INSTALL POLE CITY ALUMINUM, ANCHOR BASE, SIZE AS INDICATED
- M - INSTALL 400W HPSV LUMINAIRE & DAVIT ARM

NOTE:
FOR LEGEND AND NOTES REFER TO DRAWING NO. E-1.

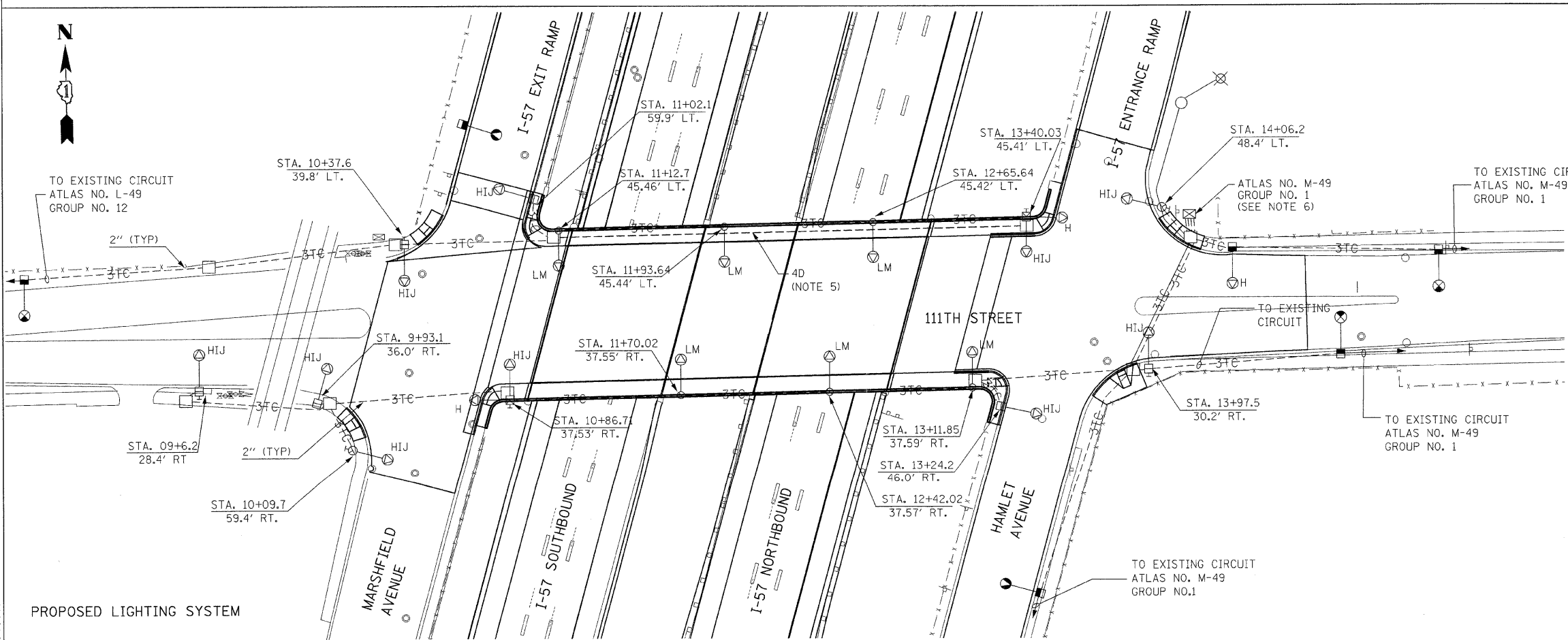

REVISIONS	
NAME	DATE

ILLINOIS DEPARTMENT OF TRANSPORTATION
111TH STREET OVER
F.A.I ROUTE 57 (INTERSTATE 57)

CITY OF CHICAGO
LIGHTING PLAN

SCALE: 1" = 30'
DATE: 01/16/09

DRAWN BY: ACL
CHECKED BY: PR

TENG
TENG & ASSOCIATES, INC.
ENGINEERS/ARCHITECTS/PLANNERS
205 N. MICHIGAN AVE. CHICAGO, IL 60601
TELEPHONE: 312/616-3000

\TPO0014E.DGN, \RDWOOD_6.DGN, \PMD005M.DGN, \SEH000PT.DGN, \111TH ST BORDEL.DGN, \VALTOONR.DGN, \TPO0074E.DGN, \RDWOOD3B.DGN, \RDWOOD3E.DGN, \RDWOOD3L.DGN, \RDWOOD3R.DGN, \RDWOOD3S.DGN, \RDWOOD3T.DGN, \RDWOOD3U.DGN, \RDWOOD3V.DGN, \RDWOOD3W.DGN, \RDWOOD3X.DGN, \RDWOOD3Y.DGN, \RDWOOD3Z.DGN, \RDWOOD4A.DGN, \RDWOOD4B.DGN, \RDWOOD4C.DGN, \RDWOOD4D.DGN, \RDWOOD4E.DGN, \RDWOOD4F.DGN, \RDWOOD4G.DGN, \RDWOOD4H.DGN, \RDWOOD4I.DGN, \RDWOOD4J.DGN, \RDWOOD4K.DGN, \RDWOOD4L.DGN, \RDWOOD4M.DGN, \RDWOOD4N.DGN, \RDWOOD4O.DGN, \RDWOOD4P.DGN, \RDWOOD4Q.DGN, \RDWOOD4R.DGN, \RDWOOD4S.DGN, \RDWOOD4T.DGN, \RDWOOD4U.DGN, \RDWOOD4V.DGN, \RDWOOD4W.DGN, \RDWOOD4X.DGN, \RDWOOD4Y.DGN, \RDWOOD4Z.DGN, \RDWOOD5A.DGN, \RDWOOD5B.DGN, \RDWOOD5C.DGN, \RDWOOD5D.DGN, \RDWOOD5E.DGN, \RDWOOD5F.DGN, \RDWOOD5G.DGN, \RDWOOD5H.DGN, \RDWOOD5I.DGN, \RDWOOD5J.DGN, \RDWOOD5K.DGN, \RDWOOD5L.DGN, \RDWOOD5M.DGN, \RDWOOD5N.DGN, \RDWOOD5O.DGN, \RDWOOD5P.DGN, \RDWOOD5Q.DGN, \RDWOOD5R.DGN, \RDWOOD5S.DGN, \RDWOOD5T.DGN, \RDWOOD5U.DGN, \RDWOOD5V.DGN, \RDWOOD5W.DGN, \RDWOOD5X.DGN, \RDWOOD5Y.DGN, \RDWOOD5Z.DGN, \RDWOOD6A.DGN, \RDWOOD6B.DGN, \RDWOOD6C.DGN, \RDWOOD6D.DGN, \RDWOOD6E.DGN, \RDWOOD6F.DGN, \RDWOOD6G.DGN, \RDWOOD6H.DGN, \RDWOOD6I.DGN, \RDWOOD6J.DGN, \RDWOOD6K.DGN, \RDWOOD6L.DGN, \RDWOOD6M.DGN, \RDWOOD6N.DGN, \RDWOOD6O.DGN, \RDWOOD6P.DGN, \RDWOOD6Q.DGN, \RDWOOD6R.DGN, \RDWOOD6S.DGN, \RDWOOD6T.DGN, \RDWOOD6U.DGN, \RDWOOD6V.DGN, \RDWOOD6W.DGN, \RDWOOD6X.DGN, \RDWOOD6Y.DGN, \RDWOOD6Z.DGN, \RDWOOD7A.DGN, \RDWOOD7B.DGN, \RDWOOD7C.DGN, \RDWOOD7D.DGN, \RDWOOD7E.DGN, \RDWOOD7F.DGN, \RDWOOD7G.DGN, \RDWOOD7H.DGN, \RDWOOD7I.DGN, \RDWOOD7J.DGN, \RDWOOD7K.DGN, \RDWOOD7L.DGN, \RDWOOD7M.DGN, \RDWOOD7N.DGN, \RDWOOD7O.DGN, \RDWOOD7P.DGN, \RDWOOD7Q.DGN, \RDWOOD7R.DGN, \RDWOOD7S.DGN, \RDWOOD7T.DGN, \RDWOOD7U.DGN, \RDWOOD7V.DGN, \RDWOOD7W.DGN, \RDWOOD7X.DGN, \RDWOOD7Y.DGN, \RDWOOD7Z.DGN, \RDWOOD8A.DGN, \RDWOOD8B.DGN, \RDWOOD8C.DGN, \RDWOOD8D.DGN, \RDWOOD8E.DGN, \RDWOOD8F.DGN, \RDWOOD8G.DGN, \RDWOOD8H.DGN, \RDWOOD8I.DGN, \RDWOOD8J.DGN, \RDWOOD8K.DGN, \RDWOOD8L.DGN, \RDWOOD8M.DGN, \RDWOOD8N.DGN, \RDWOOD8O.DGN, \RDWOOD8P.DGN, \RDWOOD8Q.DGN, \RDWOOD8R.DGN, \RDWOOD8S.DGN, \RDWOOD8T.DGN, \RDWOOD8U.DGN, \RDWOOD8V.DGN, \RDWOOD8W.DGN, \RDWOOD8X.DGN, \RDWOOD8Y.DGN, \RDWOOD8Z.DGN, \RDWOOD9A.DGN, \RDWOOD9B.DGN, \RDWOOD9C.DGN, \RDWOOD9D.DGN, \RDWOOD9E.DGN, \RDWOOD9F.DGN, \RDWOOD9G.DGN, \RDWOOD9H.DGN, \RDWOOD9I.DGN, \RDWOOD9J.DGN, \RDWOOD9K.DGN, \RDWOOD9L.DGN, \RDWOOD9M.DGN, \RDWOOD9N.DGN, \RDWOOD9O.DGN, \RDWOOD9P.DGN, \RDWOOD9Q.DGN, \RDWOOD9R.DGN, \RDWOOD9S.DGN, \RDWOOD9T.DGN, \RDWOOD9U.DGN, \RDWOOD9V.DGN, \RDWOOD9W.DGN, \RDWOOD9X.DGN, \RDWOOD9Y.DGN, \RDWOOD9Z.DGN, \RDWOOD0A.DGN, \RDWOOD0B.DGN, \RDWOOD0C.DGN, \RDWOOD0D.DGN, \RDWOOD0E.DGN, \RDWOOD0F.DGN, \RDWOOD0G.DGN, \RDWOOD0H.DGN, \RDWOOD0I.DGN, \RDWOOD0J.DGN, \RDWOOD0K.DGN, \RDWOOD0L.DGN, \RDWOOD0M.DGN, \RDWOOD0N.DGN, \RDWOOD0O.DGN, \RDWOOD0P.DGN, \RDWOOD0Q.DGN, \RDWOOD0R.DGN, \RDWOOD0S.DGN, \RDWOOD0T.DGN, \RDWOOD0U.DGN, \RDWOOD0V.DGN, \RDWOOD0W.DGN, \RDWOOD0X.DGN, \RDWOOD0Y.DGN, \RDWOOD0Z.DGN