

REMOVAL PLAN

- REMOVAL NOTES
- 1 - REMOVE EXISTING UNDERPASS LIGHTING AND RETURN TO IDOT. REMOVE ASSOCIATED CONDUITS AND JUNCTION BOXES UP TO RISER POINT AT GRADE. REMOVE ASSOCIATED WIRES UP TO PRIOR ROADWAY JUNCTION BOX AT FRANKLIN CONNECTOR.
 - 2- REMOVE ILLUMINATED ROADWAY SIGN, CLEAN AND STORE FOR RE-INSTALLATION.
 - 3- CONTRACTOR MUST ASCERTAIN THE TYPE OF CABLE AND ITS USE IN RACEWAY(S) BEFORE BRIDGE DEMOLITION AND WHERE NECESSARY, REMOVE, RELOCATE AND RE-INSTALL WITHOUT ANY INTERRUPTION OF SERVICE. CONTRACTOR SHALL COORDINATE WITH IDOT TO MAKE CORRECT MODIFICATIONS.

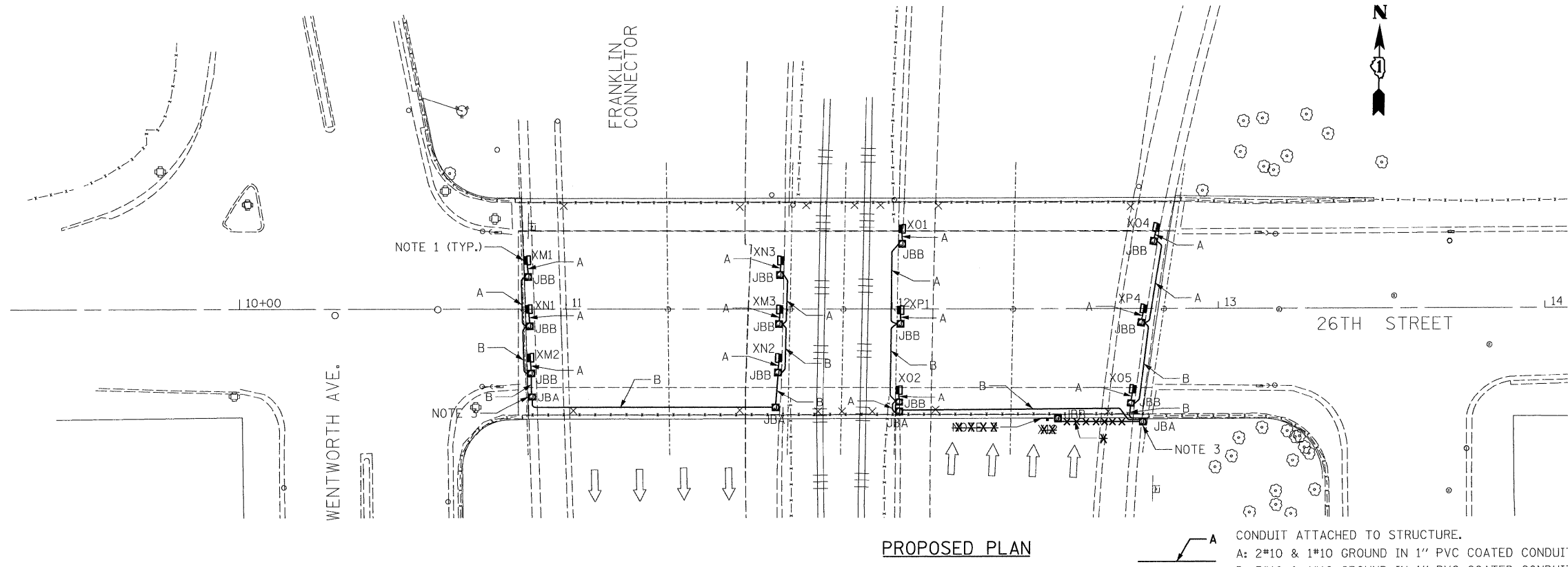

PROPOSED PLAN

- PROPOSED NOTES
- 1 - PROVIDE NEW 150W HPS UNDERPASS LIGHTING. PROVIDE CONDUITS AND WIRES AS SHOWN. RECONNECT PROPOSED UNDERPASS LUMINAIRES TO EXISTING CIRCUIT AT ROADWAY JUNCTION BOX ON FRANKLIN CONNECTOR.
 - ~~2- RE-INSTALL ILLUMINATED ROADWAY SIGN.~~
 - 3- PROVIDE NEW CONDUIT FROM CONDUIT RISER POINT AT GRADE TO JUNCTION BOX. SEE DETAILS FOR MORE INFORMATION.
 - 4- ALL PROPOSED CONDUIT AND CABLE SHALL BE AS PER LEGEND SHEET E1.

A CONDUIT ATTACHED TO STRUCTURE.
 A: 2*10 & 1*10 GROUND IN 1" PVC COATED CONDUIT.
 B: 3*10 & 1*10 GROUND IN 1" PVC COATED CONDUIT.