

NOTE:
THIS PLAN IS FOR THE PURPOSE OF REPLACING THE DETECTOR LOOPS ONLY. ALL OTHER INFORMATION SHOWN IS NOT RELATED AND WILL BE DISREGARDED.

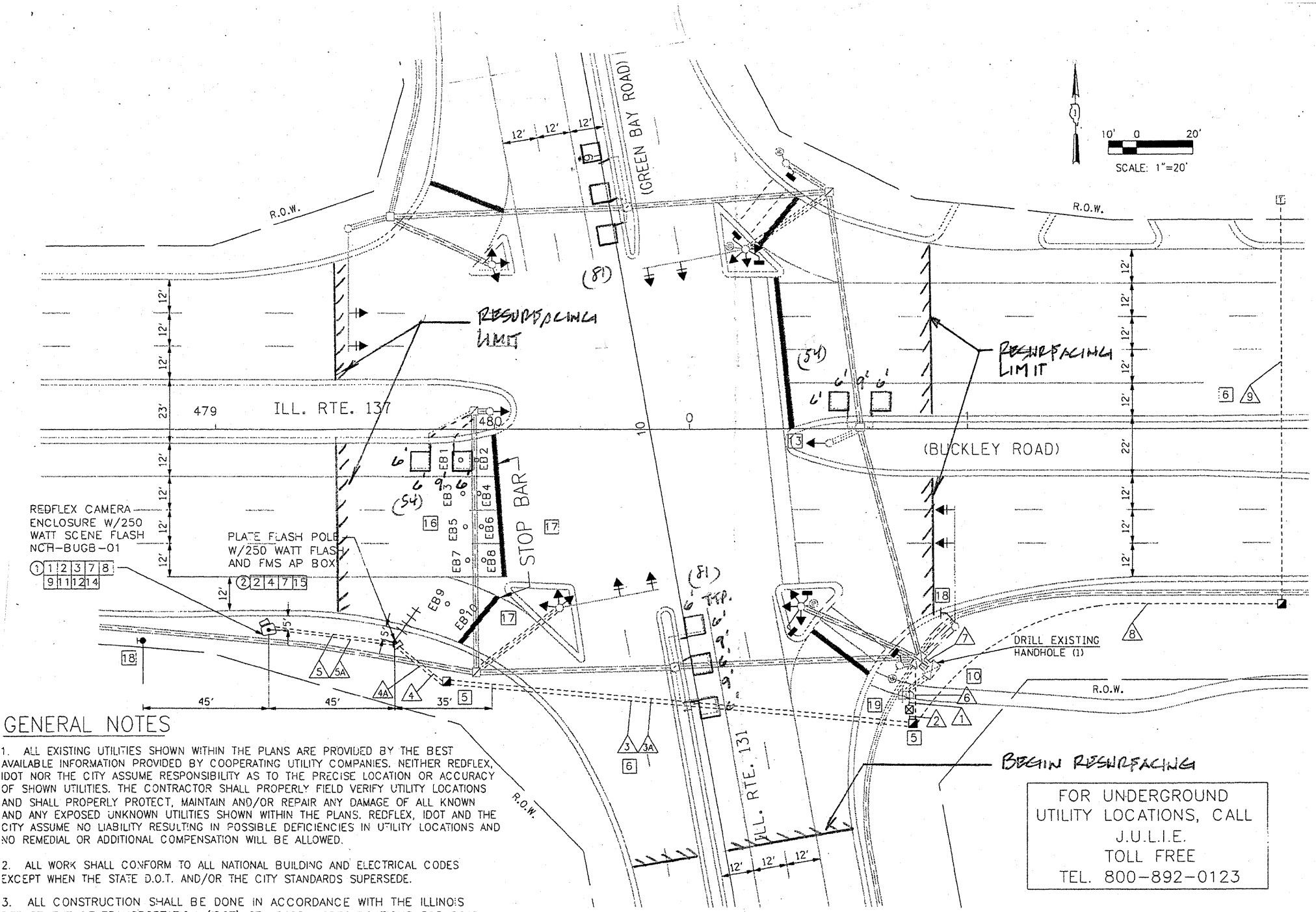

GENERAL NOTES

1. ALL EXISTING UTILITIES SHOWN WITHIN THE PLANS ARE PROVIDED BY THE BEST AVAILABLE INFORMATION PROVIDED BY COOPERATING UTILITY COMPANIES. NEITHER REDFLEX, IDOT NOR THE CITY ASSUME RESPONSIBILITY AS TO THE PRECISE LOCATION OR ACCURACY OF SHOWN UTILITIES. THE CONTRACTOR SHALL PROPERLY FIELD VERIFY UTILITY LOCATIONS AND SHALL PROPERLY PROTECT, MAINTAIN AND/OR REPAIR ANY DAMAGE OF ALL KNOWN AND ANY EXPOSED UNKNOWN UTILITIES SHOWN WITHIN THE PLANS. REDFLEX, IDOT AND THE CITY ASSUME NO LIABILITY RESULTING IN POSSIBLE DEFICIENCIES IN UTILITY LOCATIONS AND NO REMEDIAL OR ADDITIONAL COMPENSATION WILL BE ALLOWED.
2. ALL WORK SHALL CONFORM TO ALL NATIONAL BUILDING AND ELECTRICAL CODES EXCEPT WHEN THE STATE D.O.T. AND/OR THE CITY STANDARDS SUPERSEDE.
3. ALL CONSTRUCTION SHALL BE DONE IN ACCORDANCE WITH THE ILLINOIS DEPARTMENT OF TRANSPORTATION (IDOT) STANDARD SPECIFICATIONS FOR ROAD AND BRIDGE CONSTRUCTION (SSRBC) ADOPTED JANUARY 1, 2007 AND THE IDOT SUPPLEMENTAL SPECIFICATIONS AND RECURRING SPECIAL PROVISIONS ADOPTED JANUARY 1, 2007.
4. THE CONTRACTOR SHALL BE RESPONSIBLE FOR MAINTAINING THE TRAFFIC SIGNAL INSTALLATION IN PROPER OPERATING CONDITION. THE CONTRACTOR MUST FOLLOW THE PROCEDURES AS SPECIFIED IN THE ARTICLE 801.11 OF THE IDOT STANDARD SPECIFICATIONS. THE CONTRACTOR SHALL PERFORM THE MAINTENANCE PROCEDURES AS OUTLINED IN IDOT DISTRICT 1 "TRAFFIC SIGNAL SPECIAL PROVISIONS".
5. ALL SUBSTRUCTURES AND UNDERGROUND UTILITIES MUST BE LOCATED PRIOR TO CONSTRUCTION. THE CONTRACTOR SHALL AND MUST NOTIFY ALL UTILITY COMPANIES WITHIN A MINIMUM OF TWO WORKING DAYS PRIOR TO START OF WORK.
6. REDFLEX WILL MEET WITH THE CONTRACTOR, CITY AND IDOT (ILLINOIS DEPARTMENT OF TRANSPORTATION) OFFICIALS, AND POLICE TO MARK THE EXACT LOCATION OF THE POLES AND CABINET PRIOR TO CONSTRUCTION.
7. TRAFFIC FLOW SHALL BE MAINTAINED AT ALL TIMES. TEMPORARY SHUTDOWNS OR DISRUPTION MUST BE COORDINATED WITH THE CITY AND DOT.

FOR UNDERGROUND UTILITY LOCATIONS, CALL J.U.L.I.E. TOLL FREE TEL. 800-892-0123

TRAFFIC SIGNAL LEGEND

PROPOSED	EXISTING	PROPOSED	EXISTING
CONTROLLER	[Symbol]	EMERGENCY VEHICLE SYSTEM DETECTOR	[Symbol]
SERVICE INSTALLATION	[Symbol]	CONFIRMATION BEACON	[Symbol]
SIGNAL HEAD	[Symbol]	SIGNAL HEAD, OPTICALLY PROGRAMMED	[Symbol]
SIGNAL HEAD WITH BACKPLATE	[Symbol]	CONDUIT SPLICE	[Symbol]
SIGNAL HEAD, PEDESTRIAN	[Symbol]	FMS AP ANTENNA BOX (FMS) FLUSH MOUNTED SENSOR (# INDICATES SENSOR NUMBER)	[Symbol]
SIGNAL POST	[Symbol]		
MAST ARM ASSEMBLY AND POLE, STEEL	[Symbol]		
MAST ARM ASSEMBLY AND POLE, ALUMINUM	[Symbol]		
WOOD POLE	[Symbol]		
HANDHOLE	[Symbol]		
HEAVY DUTY HANDHOLE	[Symbol]		
DOUBLE HANDHOLE	[Symbol]		
CALVANIZED STEEL CONDUIT IN TRENCH OR PUSHED	[Symbol]		
PEDESTRIAN PUSHBUTTON DETECTOR	[Symbol]		
DETECTOR LOOP	[Symbol]		

REPLACE ALL DETECTOR LOOPS AS SHOWN

(WITHIN THE RESURFACING LIMITS)

CODE NO.	QUANTITY	UNIT	ITEM
8000600	270	Foot	Detector Loop Replacement

FILE NAME	USER NAME	DESIGNED	REVISED
cr:\projects\traffic\070022\1150\forestry.dgn	kanthaphixayb	-	-
PLOT SCALE	DATE	CHECKED	REVISED
1/8" = 1' IN.	08/15/2007	-	-
PLOT DATE		DATE	REVISED

STATE OF ILLINOIS
DEPARTMENT OF TRANSPORTATION

ILL. RTE. 131 (GREEN BAY RD.) @ ILL. RTE. 137 (BUCKLEY RD.)

F.A.U./F.A.P. RTE.	SECTION	COUNTY	TOTAL SHEETS	SHEET NO.
		LAKE	40	23
CONTRACT NO.				

SCALE: SHEET NO. OF SHEETS STA. TO STA.

FED. ROAD DIST. NO. ILLINOIS FED. AID PROJECT