

F.A.U. RTE.	SECTION	COUNTY	TOTAL SHEETS	SHEET NO.
1467	2008-024RS	COOK	21	1
FED. ROAD DIST. NO. 1		ILLINOIS	CONTRACT NO. 60E55	

STATE OF ILLINOIS
DEPARTMENT OF TRANSPORTATION
DIVISION OF HIGHWAYS

**PROPOSED
HIGHWAY PLANS**

F.A.U. ROUTE 1467 /31ST STREET /GOLFVIEW AVENUE
IL 171 TO DES PLAINES AVENUE
SECTION: 2008-024RS
RESURFACING (MAINTENANCE)
PROJECT: *ESP-1467(006)*
COOK COUNTY
C-91-469-08

FOR INDEX OF SHEETS, SEE SHEET NO. 2

PROJECT IS LOCATED IN THE
VILLAGES OF RIVERSIDE AND BROOKFIELD

D-91-469-08

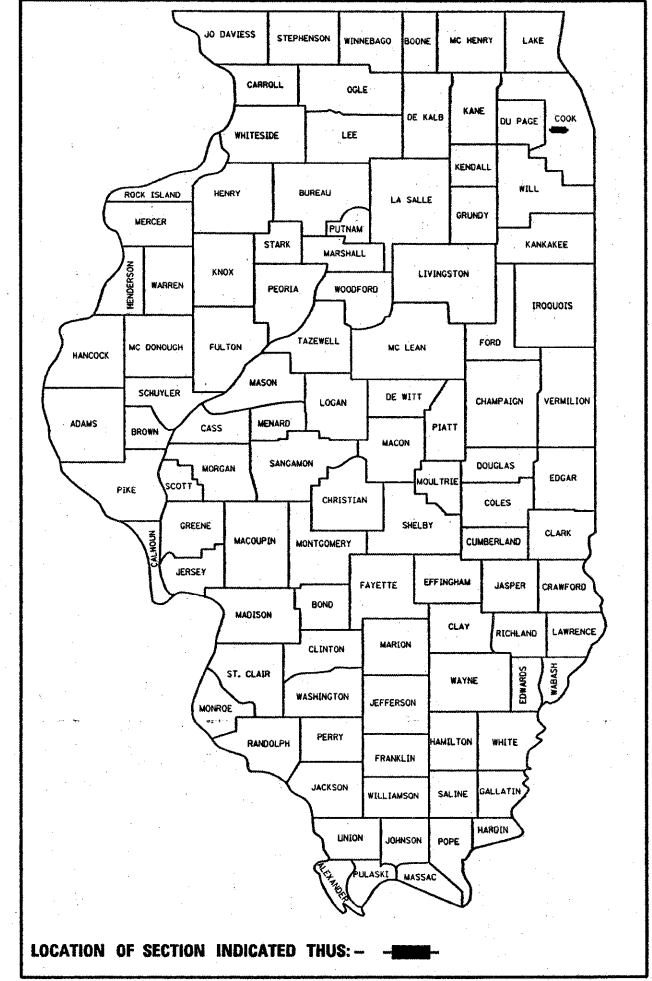

LOCATION OF SECTION INDICATED THUS: —

DISTRICT ONE DESIGN PLAN PREPARATION ENGINEER:
KEN ENG (847) 705-4247

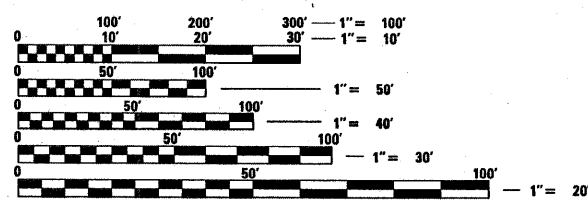

FULL SIZE PLANS HAVE BEEN PREPARED USING STANDARD
ENGINEERING SCALES. REDUCED SIZED PLANS WILL NOT
CONFORM TO STANDARD SCALES. IN MAKING MEASUREMENTS
ON REDUCED PLANS, THE ABOVE SCALES MAY BE USED.

J.U.L.I.E.
JOINT UTILITY LOCATION INFORMATION FOR EXCAVATION
1-800-892-0123
OR 811

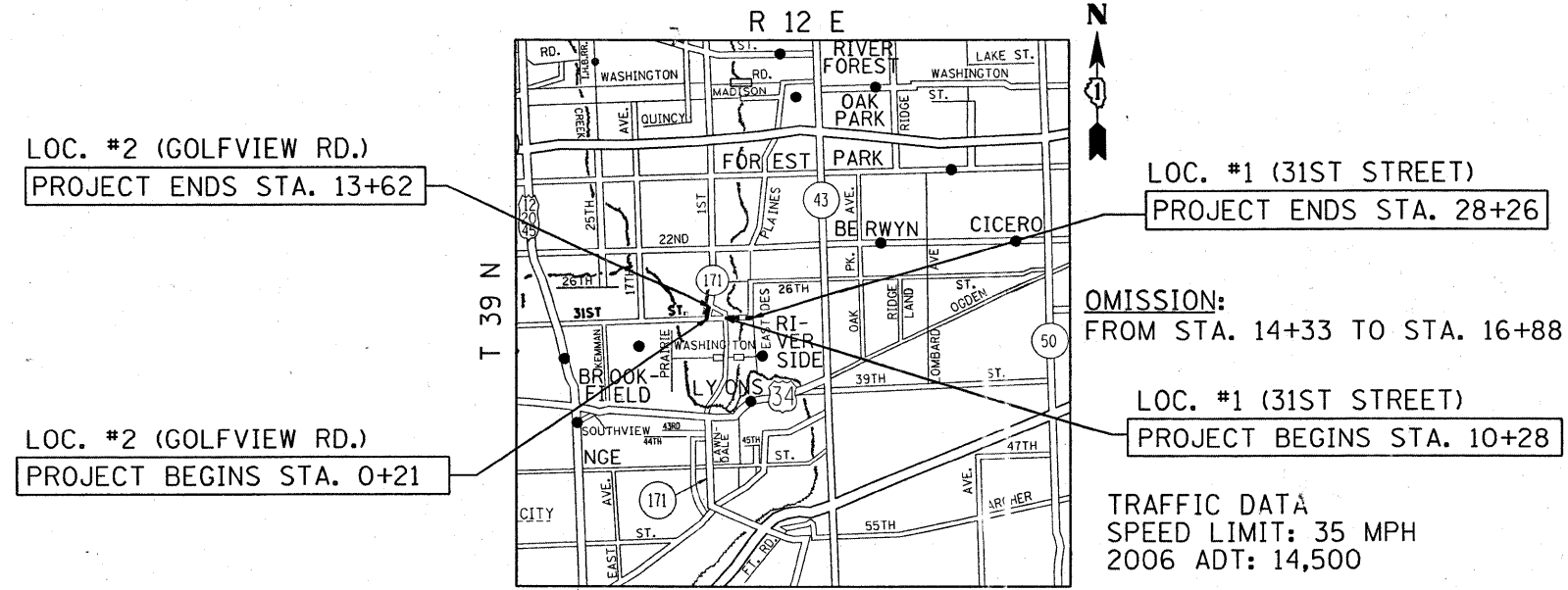

LOC. #2 (GOLFVIEW RD.)
PROJECT ENDS STA. 13+62

LOC. #1 (31ST STREET)
PROJECT ENDS STA. 28+26

LOC. #2 (GOLFVIEW RD.)
PROJECT BEGINS STA. 0+21

LOC. #1 (31ST STREET)
PROJECT BEGINS STA. 10+28

OMISSION:
FROM STA. 14+33 TO STA. 16+88

TRAFFIC DATA
SPEED LIMIT: 35 MPH
2006 ADT: 14,500

PROJECT ENGINEER: ANA ABREU
PROJECT MANAGER: KEN ENG

CONTRACT NO. 60E55

GROSS LENGTH OF PROJECT = 3,139 FEET (0.59 MILES)
NET LENGTH OF PROJECT = 2,884 FEET (0.55 MILES)

STATE OF ILLINOIS
DEPARTMENT OF TRANSPORTATION
DIVISION OF HIGHWAYS

SUBMITTED JANUARY 8, 20 09

Diana M. O'Keefe
DEPUTY DIRECTOR OF HIGHWAYS, REGION ENGINEER

March 13, 20 09
Charles J. Ingersoll
ENGINEER OF DESIGN AND ENVIRONMENT

March 13, 20 09
Christine M. Reed
DIRECTOR OF HIGHWAYS, CHIEF ENGINEER

**PRINTED BY THE AUTHORITY
OF THE STATE OF ILLINOIS**