

CONSTRUCTION SEQUENCE

| PRESTAGE  |  |
|---|--|
| CONSTRUCTION  | TRAFFIC CONTROL  |
| MEDIAN REMOVAL AND TEMPORARY PAVEMENT CONSTRUCTION                            | UTILIZE STANDARD 701421  |
| STAGE 1   |  |
| CONSTRUCTION  | TRAFFIC CONTROL  |
| EASTBOUND DECK SEALING AND BRIDGE JOINT RECONSTRUCTION                        | TWO-WAY TRAFFIC ON WESTBOUND LANES FROM STA. 276+61 TO STA. 294+31 UTILIZING STANDARD 701431 |
| STAGE 2   |  |
| CONSTRUCTION  | TRAFFIC CONTROL  |
| WESTBOUND DECK BEAM OVERLAY, BRIDGE JOINT RECONSTRUCTION AND APPROACH OVERLAY | TWO-WAY TRAFFIC ON EASTBOUND LANES FROM STA. 276+61 TO STA. 294+31 UTILIZING STANDARD 701431 |
| STAGE 3   |  |
| CONSTRUCTION  | TRAFFIC CONTROL  |
| TEMPORARY PAVEMENT REMOVAL AND CONCRETE MEDIAN CONSTRUCTION                   | UTILIZE STANDARD 701421  |

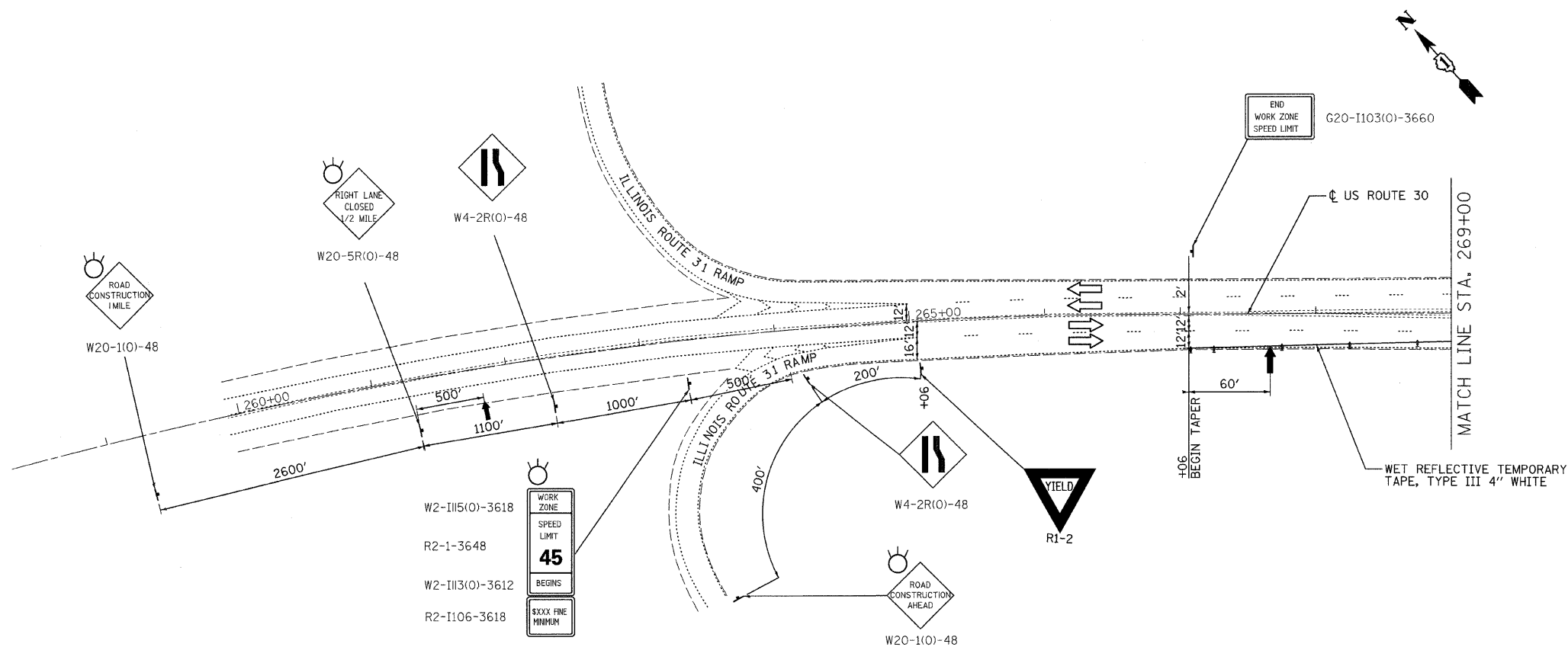

SYMBOLS

- ↑ Arrow board
- ▨ Work area
- ♠ Sign
- ⊙ Drum with steady burn monodirectional light (50' cts.)
- ⬆ Direction Indicator barricade with steady burn monodirectional light (50' cts.)
- Flexible delineator
- ⚡ Type III barricade with flashing monodirectional lights
- ⊕ Non-directional flashing beacon
- ◇ Crystal, bidirectional barrier wall / guardrail marker (25' cts.)
- ▨ Temporary Pavement: Hot-mix asphalt surface course, mix "D", N50 (IL-9.5mm), 1 1/2" Hot-mix asphalt binder course, IL-19.0, N50, 8 1/2" (in 4 lifts)
- ▨ Temporary impact attenuator
- ⊙ Temporary signal post
- ⬆ Temporary traffic signal installation
- ▨ Temporary concrete barrier wall
- Detector loops

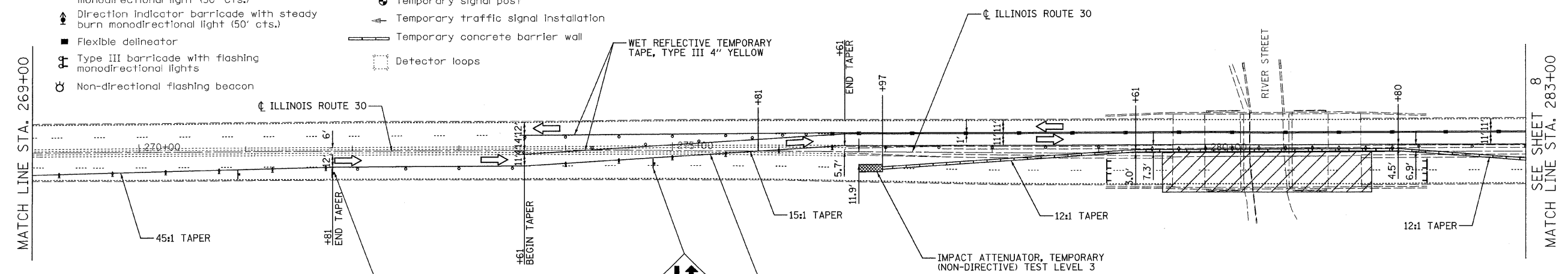

NOTE:  
WHEN EXISTING PAVEMENT MARKINGS AND RAISED PAVEMENT MARKERS ARE IN CONFLICT WITH THE TRAFFIC CONTROL AND PROTECTION PLAN, EXISTING PAVEMENT MARKINGS AND RAISED PAVEMENT MARKERS SHALL BE REMOVED AND PAID FOR AS PAVEMENT MARKING REMOVAL OR AS RAISED REFLECTIVE PAVEMENT MARKING REMOVAL.

FILE NAME: c:\projects\3329\3329\_28\design\unopened\plan\3329\_28\_09-TCF11.dgn

**Ciorba Group, Inc.**  
CONSULTING ENGINEERS  
5507 North Cumberland Avenue, Suite 402  
Chicago, Illinois 60656  
Tel: 773.775.4009 Fax: 773.775.4014

|                            |                 |           |
|----------------------------|-----------------|-----------|
| USER NAME = wlancaester    | DESIGNED - JCC  | REVISED - |
| PLOT SCALE = 51.8058' / 1" | DRAWN - JCC     | REVISED - |
| PLOT DATE = 1/13/2009      | CHECKED - MJL   | REVISED - |
|                            | DATE - 01/30/08 | REVISED - |

STATE OF ILLINOIS  
DEPARTMENT OF TRANSPORTATION

FAP 349 / US ROUTE 30  
OVER RIVER STREET  
TRAFFIC CONTROL AND PROTECTION - STAGE 1  
SCALE: 1"=50'  
SHEET NO.1 OF 2 SHEETS STA. TO STA.

|   |                 |                |                 |             |
|---|-----------------|----------------|-----------------|-------------|
| F.A.P. RTE. 349                                 | SECTION 11 HB-1 | COUNTY KENDALL | TOTAL SHEETS 26 | SHEET NO. 7 |
| CONTRACT NO. 60D83                              |                 |                |                 |             |
| FED. ROAD DIST. NO. - ILLINOIS FED. AID PROJECT |                 |                |                 |             |