

SECTION A-A

Cost of Polymer Concrete is included in the cost of Bridge Deck Latex Concrete Overlay, 2 1/4"

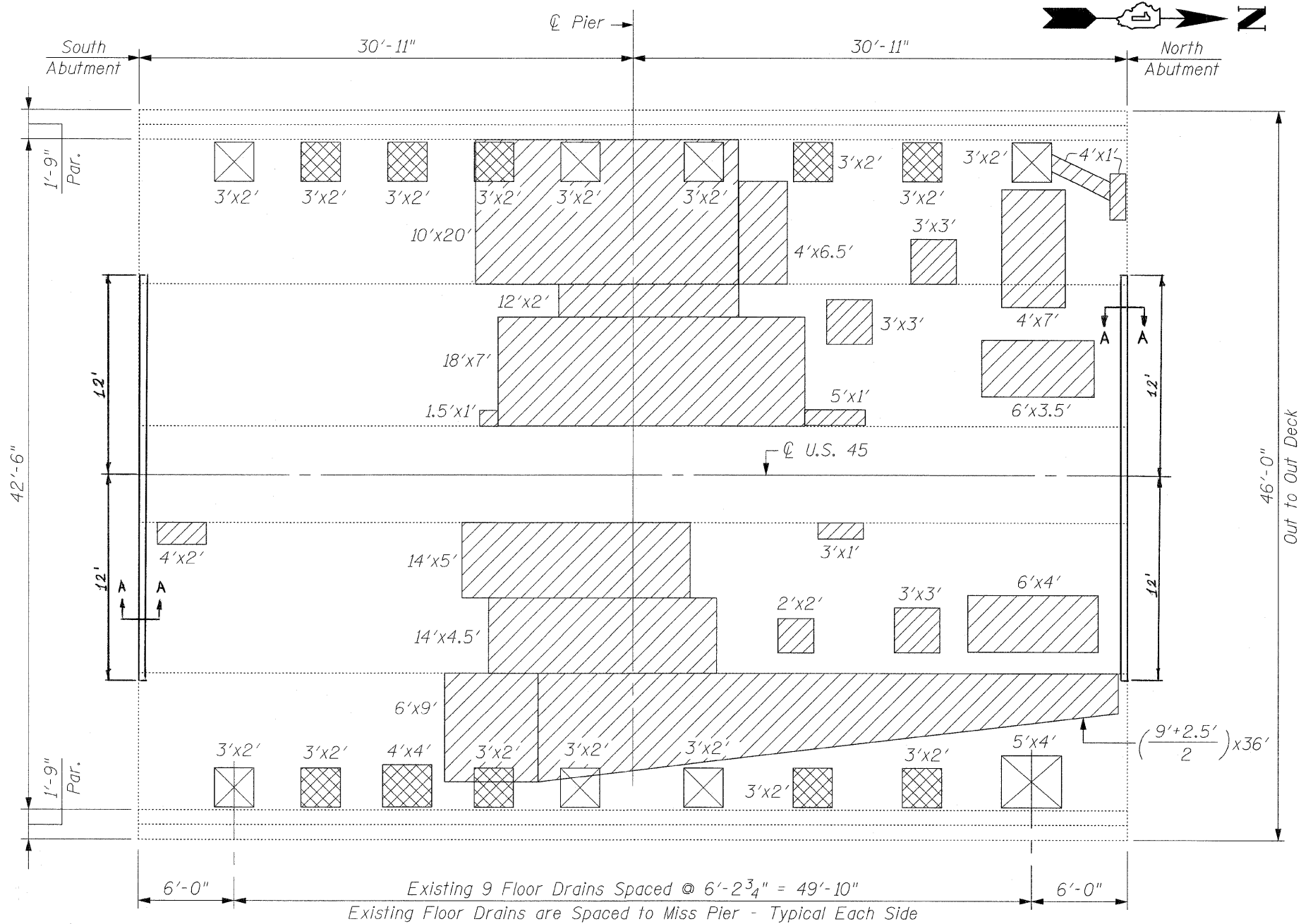

PLAN

BILL OF MATERIAL

ITEM	UNIT	QUANTITY
Deck Slab Repair (Full Depth, Type II)	Sq. Yd.	15

NOTE:
INSPECTION WAS CONDUCTED ON SEPTEMBER 28, 2007 BY I.D.O.T. FIELD MAINTENANCE ENGINEERS

NOTES:
Deck Slab Repair (Partial) is Shown for Information Only.
Locations & Areas of Repairs are Based on Inspections Performed by I.D.O.T.

LEGEND:

- Deck Slab Repair (Full Depth, Type II), Eliminate Floor Drains
- Deck Slab Repair (Full Depth, Type II), Floor Drains to Remain
- Deck Slab Repair (Partial) = 100 Sq. Yd.

FILE NAME = deck-repair.sht	USER NAME = IDOT	DESIGNED - B.N.S.	REVISED -
		DRAWN - D.L./R.E.S./F.M.	REVISED -
	PLOT SCALE = 50.0000' / IN.	CHECKED - B.N.S./S.J.P./J.C.N.	REVISED -
	PLOT DATE = 1/12/2009	DATE - JANUARY 12, 2009	REVISED -

STATE OF ILLINOIS
DEPARTMENT OF TRANSPORTATION

DECK CONCRETE PATCHING
U.S. 45 / 52 OVER SOUTH BRANCH FORKED CREEK
S.N. 099-0121

F.A.P. RTE. 330	SECTION 17 B-2-1-1	COUNTY WILL	TOTAL SHEETS 21	SHEET NO. 13
SCALE: SHEET NO. S3 OF S6 SHEETS STA. TO STA.			CONTRACT NO. 60D79	