

STAGE I TRAFFIC CONTROL
 (SIGNING & BARRICADING TO BE INSTALLED
 IN ACCORDANCE WITH STANDARD 701316)

TRAFFIC CONTROL AND STAGING LEGEND

-  WORK ZONE
-  DIRECTION OF TRAFFIC
-  TYPE III BARRICADES WITH FLASHING LIGHTS
-  TRAFFIC SIGNAL

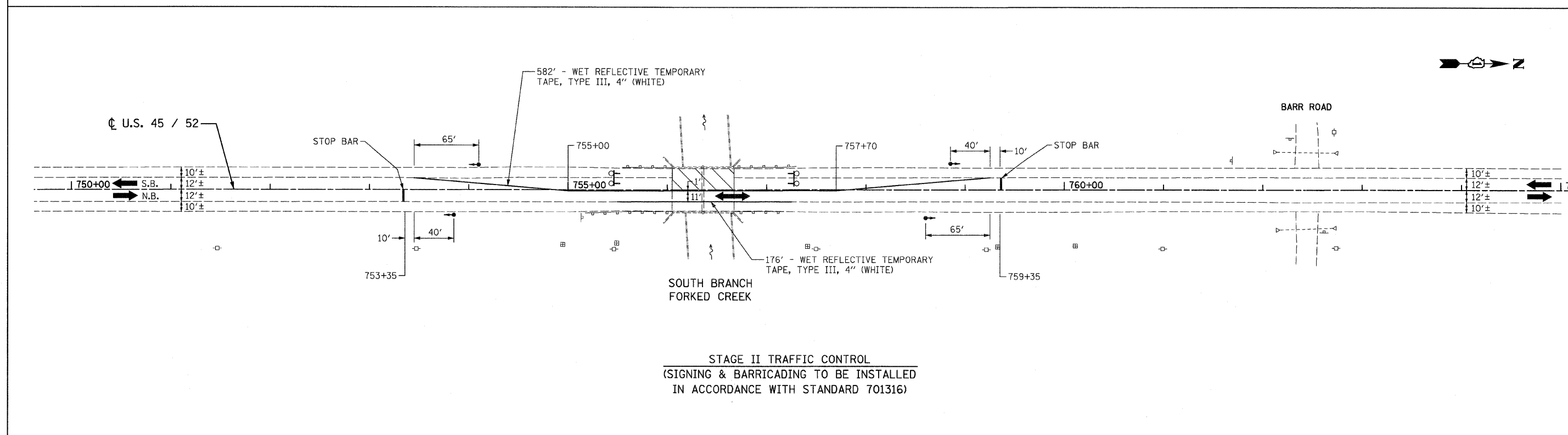

STAGE II TRAFFIC CONTROL
 (SIGNING & BARRICADING TO BE INSTALLED
 IN ACCORDANCE WITH STANDARD 701316)

FILE NAME = 60079 staging2.dgn
 PLOT DATE = 1/12/2009

CHRISTIAN-ROGE & ASSOCIATES, INC.
 ENGINEERS-PLANNERS-SURVEYORS
 211 WEST WACKER DRIVE
 CHICAGO, ILLINOIS 60606
 PHONE: (312)372-2023 FAX: (312)372-5274

DESIGNED - S.J.P.	REVISED -
DRAWN - A.C.S.	REVISED -
CHECKED - E.J.M.	REVISED -
DATE - JANUARY 12, 2009	REVISED -

STATE OF ILLINOIS
DEPARTMENT OF TRANSPORTATION

SUGGESTED TRAFFIC CONTROL AND STAGING PLAN
U.S. 45 / 52

SCALE: 1" = 50' SHEET NO. 2 OF 2 SHEETS STA. 750+00 TO STA. 764+00

F.A.P. RTE.	SECTION	COUNTY	TOTAL SHEETS	SHEET NO.
330	17 B-2-I-1	WILL	21	8
CONTRACT NO. 60079				
<small>FED. ROAD DIST. NO. 1 ILLINOIS FED. AID PROJECT</small>				