

PAVEMENT MARKING NOTES:

- ALL PAVEMENT MARKINGS ON BRIDGE DECK AND PAVEMENT SHALL BE POLYUREA, TYPE I.

CURVE DATA	
P.C. STA.	181+50.89
P.I. STA.	188+71.63
P.O.C. STA.	193+29.06
P.T. STA.	195+51.24
R	= 2,400.00'
L	= 1,400.35'
Δ	= 2° 23' 14" (RT)
E	= 105.89'
D	= 2° 23' 14"
T	= 720.74'

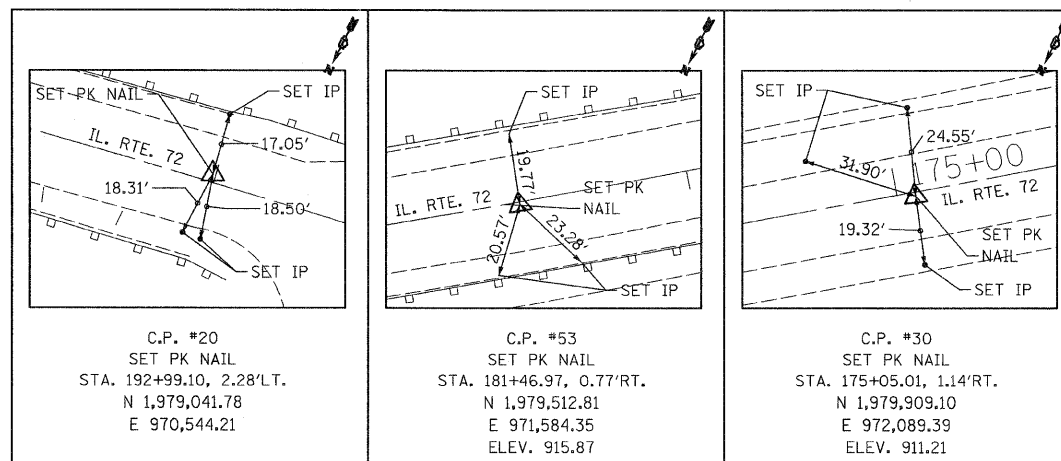

CENTERLINE ALIGNMENT				
PN	POINT	NORTHING	EASTING	STATION
5000	P. O. T.	1,979,979.67	972,181.75	173+88.78
5004	P. O. T.	1,979,745.34	971,881.27	177+69.84
5001	P. C.	1,979,511.01	971,580.78	181+50.89
5002	P. C. C.	1,979,285.11	971,232.23	185+66.79
5005	P. O. C.	1,979,038.73	970,514.30	193+29.06
5003	P. T.	1,979,011.00	970,293.93	195+51.24

FILE NAME = 60D72 align pmdgn
 PLOT DATE = 1/15/2009

CHRISTIAN-ROGE & ASSOCIATES, INC.
 ENGINEERS-PLANNERS-SURVEYORS
 211 WEST WACKER DRIVE
 CHICAGO, ILLINOIS 60606
 PHONE: (312)372-2023 FAX: (312)372-5274

DESIGNED - S.J.P.	REVISED -
DRAWN - A.Y.	REVISED -
CHECKED - E.J.M.	REVISED -
DATE - JANUARY 15, 2009	REVISED -

**STATE OF ILLINOIS
 DEPARTMENT OF TRANSPORTATION**

**ALIGNMENT, TIES, AND PAVEMENT MARKINGS
 IL 72**

SCALE: 1" = 50' SHEET NO. 1 OF 1 SHEETS STA. 179+00 TO STA. 194+00

F.A.P. RTE.	SECTION	COUNTY	TOTAL SHEETS	SHEET NO.
341	N-4-C-1	KANE	32	5
CONTRACT NO. 60D72				
FED. ROAD DIST. NO. 1 ILLINOIS FED. AID PROJECT				