

Contract #60D65

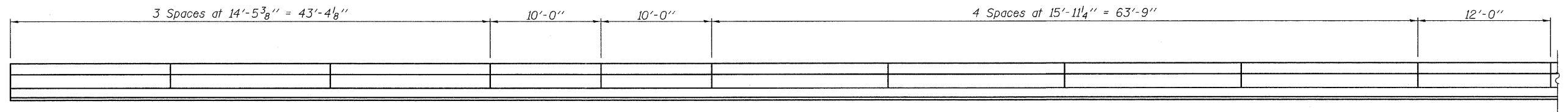

**NORTH PARAPET ELEVATION**

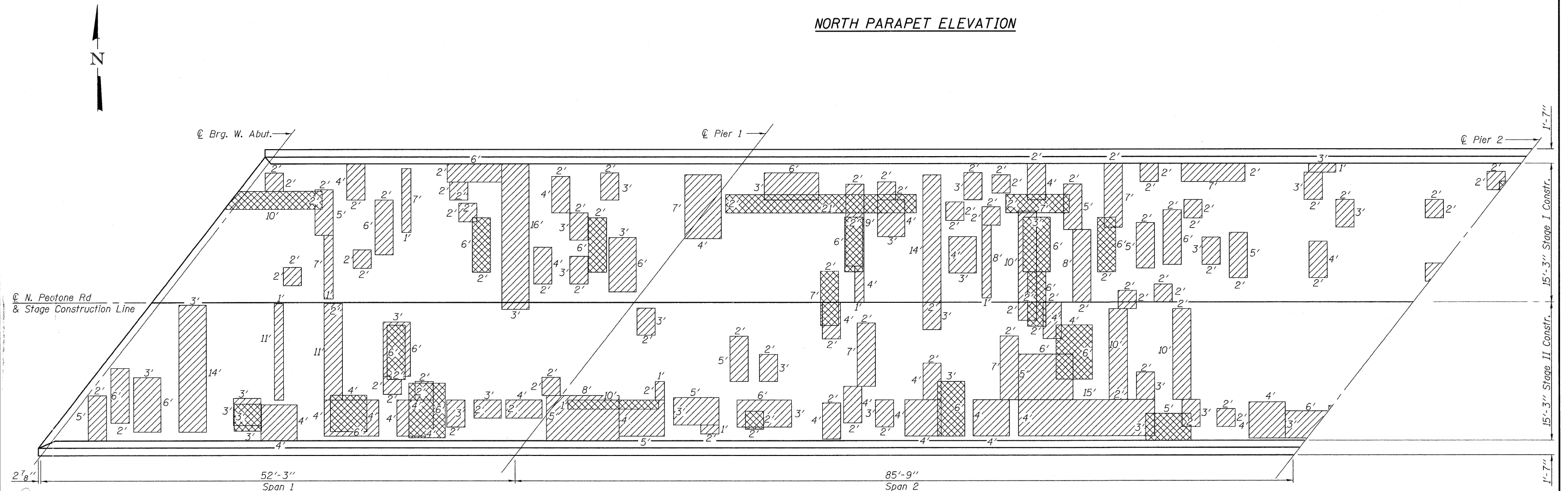

**PLAN**

**BILL OF MATERIAL**  
(Quantity for entire deck)

Item	Unit	Quantity
Deck Slab Repair (Full Depth, Type I)	Sq. Yd.	2
Deck Slab Repair (Full Depth, Type II)	Sq. Yd.	78
Bridge Deck Latex Concrete Overlay, 2 1/4"	Sq. Yd.	930
Bridge Deck Hydro-Scarification, 1/2"	Sq. Yd.	930
Bridge Deck Grooving	Sq. Yd.	884
Protective Shield	Sq. Yd.	564
Structural Repair of Concrete (Depth equal to or less than 5")	Sq. Ft.	14

Full-Depth Patching  
 \*Partial Depth Patching (231 Sq. Yd., for entire deck)  
 \*Partial Depth shown for information only.

**NOTES**

- Entire existing deck to be Hydro-Scarified 1/2" and overlaid with 2 1/4" Latex Concrete.
- Existing reinforcement bars & dowel rods extending into new concrete are to be cleaned and incorporated into new construction.
- Deck repair areas are estimated from IDOT in the Fall of 2007. Actual locations of repairs made shall be shown by the Engineer on As Built plans.
- See Sheet 1 of 12 for limits of protective shield.
- See Sheet 10 of 12 for location of structural repair of concrete.

**rjngroup**  
Excellence through Ownership  
200 West Front Street  
Wheaton, IL 60187

ILLINOIS DEPARTMENT OF TRANSPORTATION  
DECK AND PARAPET  
REPAIR PLAN - I  
NORTH PEOTONE ROAD OVER I-57  
FAI RTE 57 SECTION 99-2HB-1-I-2  
WILL COUNTY  
STATION 1035+6.40  
STRUCTURE NO. 099-0162  
DATE: 1-14-2009  
DRAWN BY JMT  
CHECKED BY WJV

1/14/2009 16:11:25 2501 Structures W Peotone over I-57 Repair.dgn