

STATE OF ILLINOIS
DEPARTMENT OF TRANSPORTATION

EAST CURB LINE

Location	Station	Offset	Theoretical Grade Elevations
End at N Abut	580+19.52	57.58	611.83
A	580+09.52	57.58	612.11
B	579+99.52	57.58	612.39
End of North appr pavement	579+89.52	57.58	612.66

EAST MEDIAN CURB LINE

Location	Station	Offset	Theoretical Grade Elevations
End at N Abut	580+01.30	1.50	612.69
A	579+91.30	1.50	612.96
B	579+81.30	1.50	613.23
End of North appr pavement	579+71.30	1.50	613.50

PG EASTBOUND LANES

Location	Station	Offset	Theoretical Grade Elevations
End at N Abut	579+93.99	-21.00	613.30
A	579+83.99	-21.00	613.57
B	579+73.99	-21.00	613.83
End of North appr pavement	579+63.99	-21.00	614.10

PG WESTBOUND LANES

Location	Station	Offset	Theoretical Grade Elevations
End at N Abut	580+07.63	21.00	612.92
A	579+97.63	21.00	613.20
B	579+87.63	21.00	613.47
End of North appr pavement	579+77.63	21.00	613.74

WEST MEDIAN CURB LINE

Location	Station	Offset	Theoretical Grade Elevations
End at N Abut	580+00.32	-1.50	612.72
A	579+90.32	-1.50	612.99
B	579+80.32	-1.50	613.26
End of North appr pavement	579+70.32	-1.50	613.53

WEST CURB LINE

Location	Station	Offset	Theoretical Grade Elevations
End at N Abut	579+82.10	-57.58	612.86
A	579+72.10	-57.58	613.12
B	579+62.10	-57.58	613.39
End of North appr pavement	579+52.10	-57.58	613.65

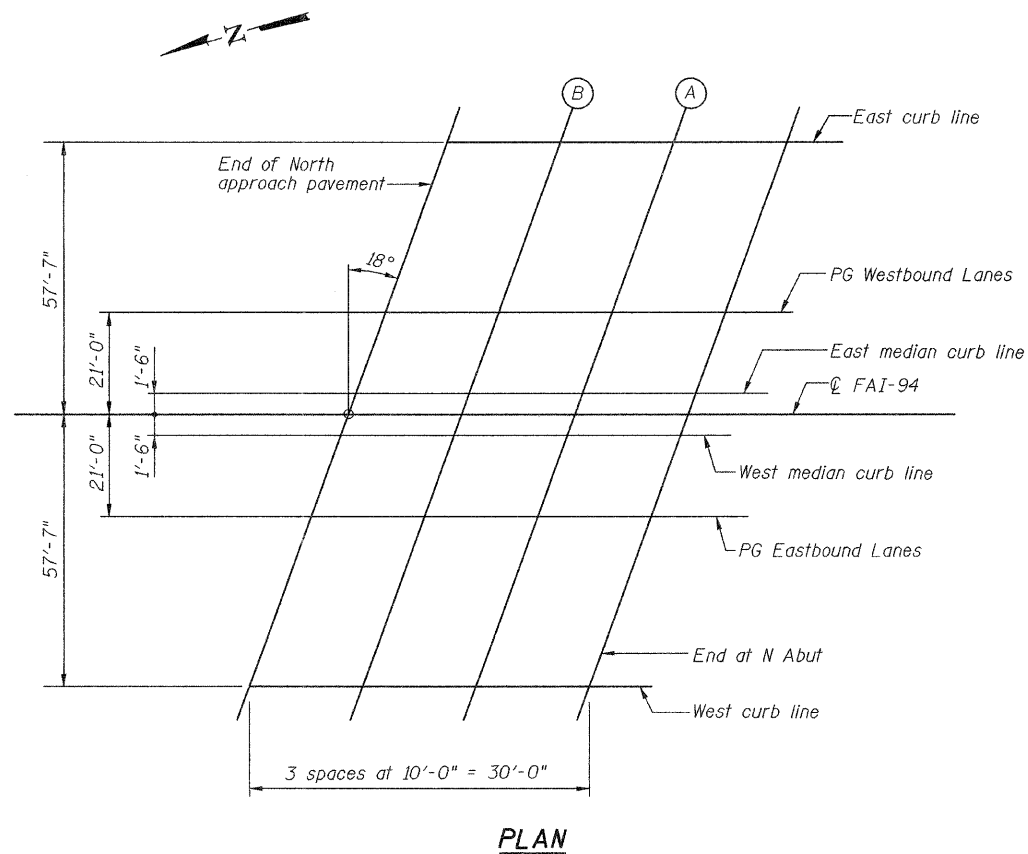

**TOP OF NORTH APPROACH
SLAB ELEVATIONS
BISHOP FORD EXPRESSWAY (I-94)
LITTLE CALUMET RIVER
COOK COUNTY
STATION
STRUCTURE NUMBER 016-0163**

DESIGNED -
CHECKED -
DRAWN -
CHECKED -

**HOMER L.
CHASTAIN
& ASSOCIATES, LLP**
CONSULTING ENGINEERS
DECATUR (217) 422-8544
CHICAGO (773) 714-0050
ROCKFORD (815) 489-0050
184-001397

SHEET NO. 14 OF 17 SHEETS	F.A.I. RTE.	SECTION	COUNTY	TOTAL SHEETS	SHEET NO.
	94	(0405,ETC,42-7&0707)RS-11	COOK	133	100
BISHOP FORD EXPRESSWAY (I-94)			CONTRACT NO. 60D21		
FED. ROAD DIST. NO. - ILLINOIS FED. AID PROJECT					