



STAGE III AND IV: YEAR 2010
 STAGE III (CONTINUED)

STAGE III NOTES

- SEQUENCE OF CONSTRUCTION: PAVEMENT PATCHING, HMA SURFACE REMOVAL AND PROPOSED HMA COURSES. WORK CAN OCCUR CONCURRENTLY, BUT SEQUENCE SHALL BE MAINTAINED AND NOT CONFLICT. RAMP WORK WILL BE COMPLETED USING DISTRICT DETAIL TC-8 - FREEWAY AND EXIT RAMP CLOSURE DETAILS.
- LANE AND RAMP CLOSURES ALLOWED AS STIPULATED IN THE SPECIAL PROVISIONS.
- LANE CLOSURES PER STANDARDS 701400, 701401 AND 701446.
- REDUCE LANE WIDTH USING 35:1 TAPER PER DISTRICT DETAIL TC-9 - TRAFFIC CONTROL DETAILS FOR FREEWAY SINGLE AND MULTI-LANE WEAVE. A W5-1 (48 x 48) ROAD NARROWS SIGN WILL BE ERRECTED 500' IN ADVANCE OF THE TAPER.
- THE CONTRACTOR SHALL ERRECT ROAD CONSTRUCTION AHEAD SIGNS (W20-I10310-48) WITH FLASHING BEACON ON ALL ARTERIAL ROADWAYS APPROACHING INTERCHANGE RAMP.
- GRADE DIFFERENTIAL BETWEEN LANES SHALL NOT EXCEED 2-1/2".
- PARTIAL MILLING OF PAVEMENT FOR AN OPERATION WILL NOT BE PAID FOR SEPARATELY, BUT WILL BE PAID FOR AT THE FINAL MILLING THICKNESS SHOWN ON THE TYPICAL SECTIONS.
- REMOVAL OF TEMPORARY PAVEMENT MARKING, WHEN REQUIRED, SHALL BE PAID FOR AS "WORK ZONE PAVEMENT MARKING REMOVAL".
- REMOVAL OF EXISTING PAVEMENT MARKING, WHEN REQUIRED, SHALL BE PAID FOR AS "PAVEMENT MARKING REMOVAL".
- EXISTING OR TEMPORARY PAVEMENT MARKINGS REMOVED DURING MILLING OPERATIONS WILL NOT BE PAID FOR SEPARATELY.
- CASTINGS EXPOSED IN TRAVEL LANES SHALL BE PROTECTED PER APPLICABLE PORTIONS OF ARTICLE 603.07 OF THE STANDARD SPECIFICATIONS. THIS WORK WILL NOT BE PAID FOR SEPARATELY, BUT SHALL BE INCLUDED IN THE VARIOUS HMA BINDER AND SURFACE COURSES PLACED.

LEGEND

- ① EXISTING PAVEMENT MARKING
 - ② WET REFLECTIVE TEMPORARY TAPE, TYPE III, 5" (WHITE 10' DASH - 30' SKIP)
 - ③ WET REFLECTIVE TEMPORARY TAPE, TYPE III, 4" (YELLOW LEFT & WHITE RIGHT) INSTALLED WITHIN 24 HOURS OF MILLING OR BINDER PLACEMENT.
 - ④ EPOXY PAVEMENT MARKING, LIMITED TO AREA IMPACTED BY STAGE I & II SEE PAVEMENT MARKING PLANS FOR COLOR AND WIDTH.
 - ⑤ VERTICAL BARRICADES WITH STEADY BURNING MONO DIRECTIONAL LIGHT AT 100' C-C SPACING. VERTICAL BARRICADES ALONG SHOULDERS WILL REMAIN IN PLACE BETWEEN OPERATIONS WHEN ALL LANES ARE OPEN TO TRAFFIC. DURING EACH OPERATION VERTICAL BARRICADES WILL THEN BE MOVED TO SEPARATE THE WORK ZONE AND OPERATING LANES.
 - ⑥ PROPOSED PAVEMENT MARKING. SEE PAVEMENT MARKING PLANS.
-  BITUMINOUS SURFACE REMOVAL
 HMA LEVELING BINDER AND BINDER COURSE

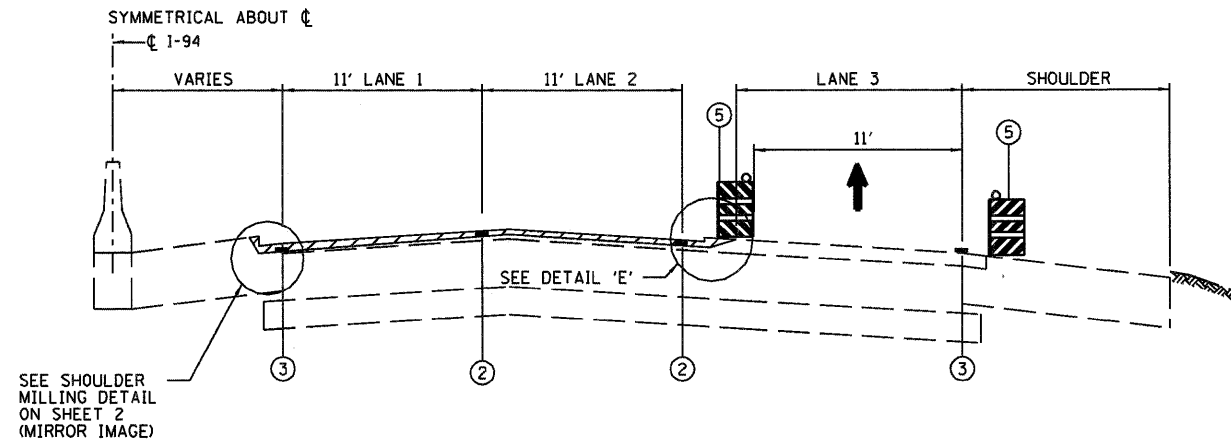

STAGE III - OPERATION SIX
 HMA SURFACE REMOVAL 2-1/4" - LANES 1 & 2

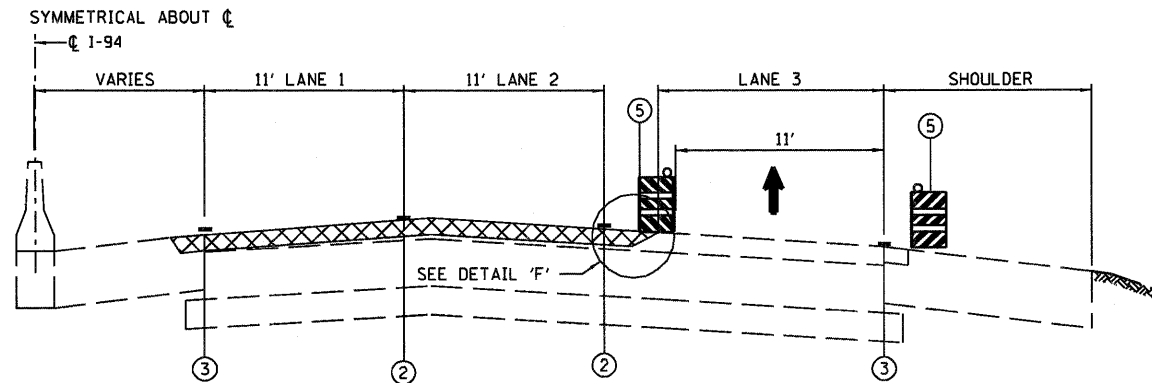

STAGE III - OPERATION SEVEN
 PLACE 3/4" LEVELING BINDER & 1-3/4" BINDER - LANES 1 & 2

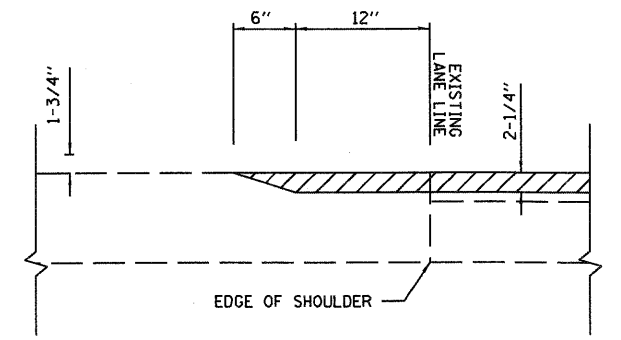

SHOULDER MILLING DETAIL

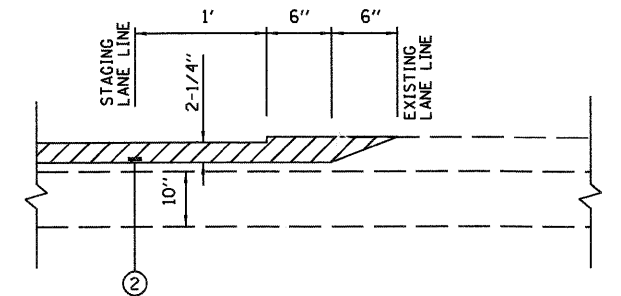

DETAIL 'E'

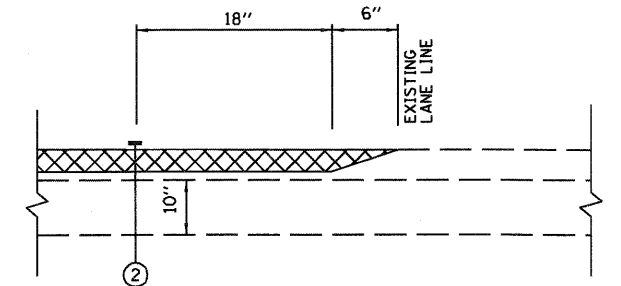

DETAIL 'F'

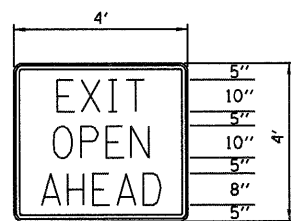

1" BORDER LINE
 GREEN REFLECTIVE BACKGROUND
 WITH WHITE LEGEND

THIS SIGN SHALL BE INSTALLED
 IN ADVANCE OF ALL OPEN/EXIT
 RAMP WHEN THE RIGHT
 LANES ARE CLOSED.



W8-11
 48" x 48"

NOTE:
 THIS SIGN SHALL BE INSTALLED
 ON BOTH SIDES OF THE ROADWAY
 500' IN ADVANCE OF AREAS WHERE
 THERE IS A GRADE DIFFERENTIAL
 BETWEEN LANES, AFTER EACH
 ENTRANCE RAMP AND MINIMUM
 OF EVERY MILE..

FILE NAME = D:\60021-032-STAGE.III.C.dgn	USER NAME = droznerski	DESIGNED - DRAWN - DMW	REVISED - REVISED -	STATE OF ILLINOIS DEPARTMENT OF TRANSPORTATION	BISHOP FORD EXPRESSWAY (I-94) SUGGESTED MAINTENANCE OF TRAFFIC	F.A.I. RTE. 94	SECTION 10405,ETC,42-7&0707R5-11	COUNTY COOK	TOTAL SHEETS 133	SHEET NO. 32			
PLOT SCALE = N/A	CHECKED -	REVISED -	SCALE: N/A			SHEET NO. 4 OF 24 SHEETS	STA. TO STA.	FED. ROAD DIST. NO.	ILLINOIS FED. AID PROJECT	CONTRACT NO. 60021			
PLOT DATE = 2/5/2009	DATE - 2/5/2009	REVISED -											