

STATE OF ILLINOIS
DEPARTMENT OF TRANSPORTATION

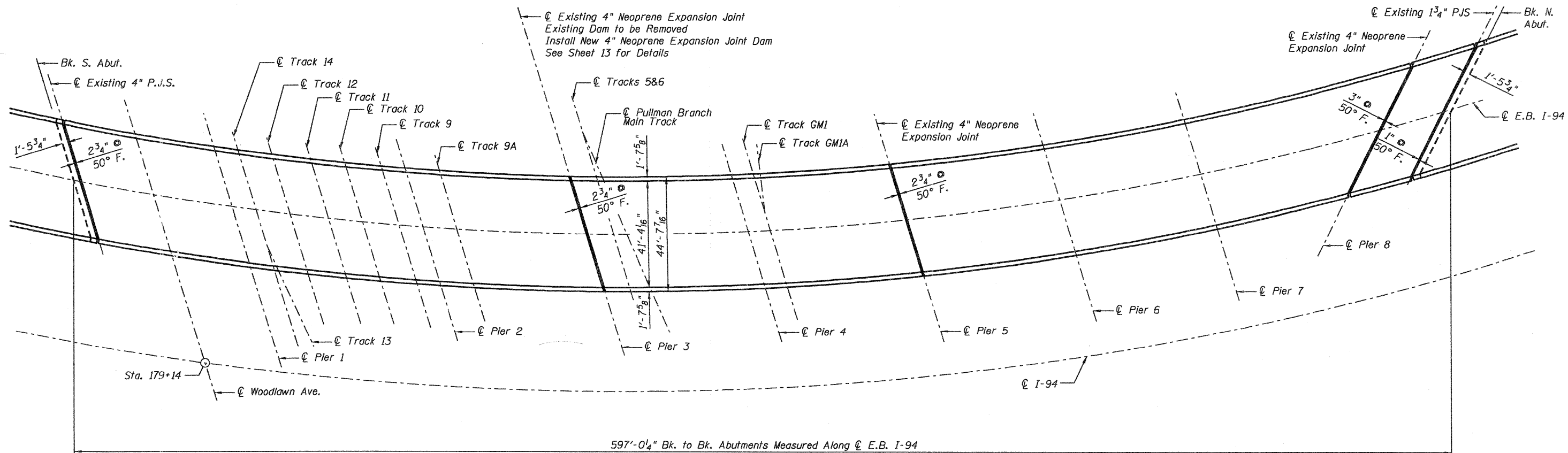

597'-0 1/4" Bk. to Bk. Abutments Measured Along @ E.B. I-94

PLAN

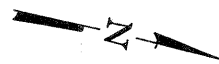

TOTAL BILL OF MATERIAL

Item	Unit	Total
Concrete Sealer	Sq. Ft.	28,540
Neoprene Expansion Joint (Dam)	Foot	47

Concrete Sealer to be placed on deck surface, top and front face of parapets.

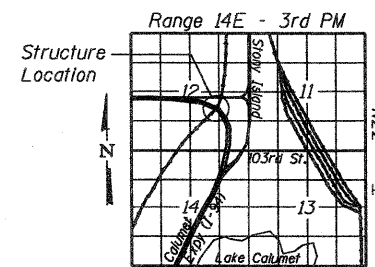

LOCATION SKETCH

GENERAL PLAN
BISHOP FORD EXPRESSWAY (I-94)
EASTBOUND I-94 OVER
NORFOLK SOUTHERN R.R. YARD
COOK COUNTY
STATION 179+14
STRUCTURE NO. 016-0150

DESIGNED	LAS
CHECKED	DAZ
DRAWN	SAW
CHECKED	LAS

Plan dimensions and details relative to existing plans are subject to nominal construction variations. The Contractor shall field verify existing dimensions and details affecting new construction and make necessary approved adjustments prior to construction or ordering of materials. Such variations shall not be cause for additional compensation for a change in the scope of work, however, the Contractor will be paid for the quantity actually furnished at the unit price bid for the work.

ZROKA
engineering
Zroka Engineering, P.C.
4216 North Hermitage
Chicago, IL 60613

SHEET NO. 2 OF 13 SHEETS	F.A.I. RTE.	SECTION	COUNTY	TOTAL SHEETS	SHEET NO.
	94	(0312-708W, ETC. & 1315)RS-4	COOK	167	110
S.N. 016-0150			CONTRACT NO. 60C08		
FED. ROAD DIST. NO. 7 ILLINOIS FED. AID PROJECT					