

STAGE I (CONTINUED)

STAGE I NOTES

1. STONY ISLAND
 - A. SEQUENCE OF CONSTRUCTION: GUARDRAIL REMOVAL AND REPLACEMENT, PAVEMENT PATCHING, HMA SURFACE REMOVAL AND PROPOSED HMA COURSES. WORK CAN OCCUR CONCURRENTLY, BUT SEQUENCE SHALL BE MAINTAINED AND NOT CONFLICT.
 - B. SHOULDER AND LANE CLOSURES AND PARTIAL RAMP CLOSURES PER STANDARDS 701101, 701400 AND 701401 AND DISTRICT DETAIL TC-17 FOR TRAFFIC CONTROL DURING ALLOWABLE CLOSURES IDENTIFIED IN THE SPECIAL PROVISIONS. THE CONTRACTOR SHALL SCHEDULE GUARDRAIL WORK SO A HAZARD OR MEDIAN IS PROTECTED DURING OPEN TIMES.
 - C. GRADE DIFFERENTIAL BETWEEN LANES SHALL NOT EXCEED 2".
2. MAINLINE
 - A. SEQUENCE OF CONSTRUCTION: CLASS A PATCHING, BARRIER WALL AND GLARE SCREEN REPAIRS AND GUARDRAIL REMOVAL AND REPLACEMENT. WORK CAN OCCUR CONCURRENTLY WITH STONY ISLAND.
 - B. CLASS A PATCHING.
 - LANE CLOSURES PER STANDARDS 701400, 701401 AND TC-25 - TRAFFIC CONTROL DETAILS FOR FREEWAY CENTER LANE CLOSURE.
 - WORK SHALL BE PERFORMED FROM 8:00 PM FRIDAY TO 5:00 AM MONDAY.
 - C. BARRIER WALL AND GLARE SCREEN REPAIRS. SHOULDER AND LANE CLOSURES PER STANDARDS 701101, 701400 AND 701401 FOR TRAFFIC CONTROL DURING ALLOWABLE SHOULDER AND LANE CLOSURES IDENTIFIED IN THE SPECIAL PROVISIONS.
 - D. GUARDRAIL REMOVAL AND REPLACEMENT.
 - OUTSIDE SHOULDERS. SHOULDER AND LANE CLOSURES AND PARTIAL RAMP CLOSURES PER STANDARDS 701101, 701400 AND 701401 AND DISTRICT DETAIL TC-17 FOR TRAFFIC CONTROL DURING ALLOWABLE CLOSURES IDENTIFIED IN THE SPECIAL PROVISIONS.
 - MEDIAN. TRAFFIC CONTROL PER MAINTENANCE OF TRAFFIC PLANS. PERMANENT LANE CLOSURES SHOWN IN STAGE I FOR I-94 SHALL NOT EXCEED 30 CALENDAR DAYS. TEMPORARY LANE CLOSURES OUTSIDE THE 30 CALENDAR DAYS ALLOWED AS STIPULATED IN THE SPECIAL PROVISIONS.
3. THE CONTRACTOR SHALL ERECT ROAD CONSTRUCTION AHEAD SIGNS (W20-1103(O-48) WITH FLASHING BEACON ON ALL ARTERIAL ROADWAYS APPROACHING INTERCHANGE RAMP.
4. REDUCE LANE WIDTH USING 35:1 TAPER PER DISTRICT DETAIL TC-9 - TRAFFIC CONTROL DETAILS FOR FREEWAY SINGLE AND MULTI-LANE WEAVE. A W5-1 (48 x 48) ROAD NARROWS SIGN WILL BE ERECTED 500' IN ADVANCE OF THE TAPER.
5. REMOVAL OF TEMPORARY PAVEMENT MARKING, WHEN REQUIRED, SHALL BE PAID FOR AS "WORK ZONE PAVEMENT MARKING REMOVAL".
6. REMOVAL OF EXISTING PAVEMENT MARKING, WHEN REQUIRED, SHALL BE PAID FOR AS "PAVEMENT MARKING REMOVAL".
7. EXISTING OR TEMPORARY PAVEMENT MARKINGS REMOVED DURING MILLING OPERATIONS WILL NOT BE PAID FOR SEPARATELY.
8. CASTINGS EXPOSED IN TRAVEL LANES SHALL BE PROTECTED PER APPLICABLE PORTIONS OF ARTICLE 603.07 OF THE STANDARD SPECIFICATIONS. THIS WORK WILL NOT BE PAID FOR SEPARATELY, BUT SHALL BE INCLUDED IN THE VARIOUS HMA BINDER AND SURFACE COURSES PLACED.

LEGEND

- ① EXISTING PAVEMENT MARKING
- ② WET REFLECTIVE TEMPORARY TAPE, TYPE III, 5" (10' DASH - 30' SKIP)
- ③ WET REFLECTIVE TEMPORARY TAPE, TYPE III, 4" (YELLOW LEFT & WHITE RIGHT) INSTALLED WITHIN 24 HOURS OF MILLING OR BINDER PLACEMENT.
- ④ PROPOSED PAVEMENT MARKING. SEE PAVEMENT MARKING PLANS.
- ⑤ VERTICAL BARRICADES WITH STEADY BURNING MONO DIRECTIONAL LIGHT AT 100' C-C SPACING. VERTICAL BARRICADES ALONG SHOULDERS WILL REMAIN IN PLACE BETWEEN OPERATIONS TO PREVENT SHOULDER RIDING. DURING EACH OPERATION VERTICAL BARRICADES WILL THEN BE USED TO SEPARATE THE WORK ZONE AND OPERATING LANES.

- BITUMINOUS SURFACE REMOVAL
- HMA LEVELING, BINDER AND SURFACE COURSES

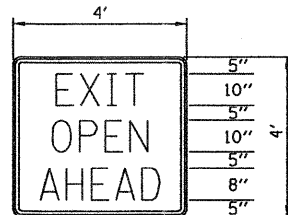

1" BORDER LINE
GREEN REFLECTIVE BACKGROUND
WITH WHITE LEGEND

THIS SIGN SHALL BE INSTALLED
IN ADVANCE OF ALL OPEN/EXIT
RAMPS WHEN THE RIGHT
LANES ARE CLOSED.



W8-11
48" x 48"

NOTE:
THIS SIGN SHALL BE INSTALLED
ON BOTH SIDES OF THE ROADWAY
500' IN ADVANCE OF AREAS WHERE
THERE IS A GRADE DIFFERENTIAL
BETWEEN LANES, AFTER EACH
ENTRANCE RAMP AND A MINIMUM
OF EVERY MILE.

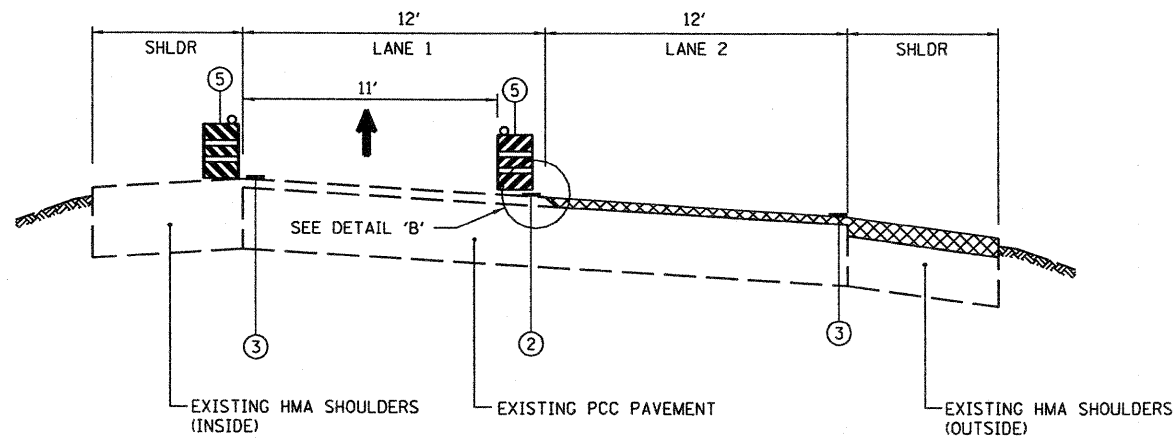

OPERATION FOUR - STONY ISLAND FEEDER RAMPS

PLACE 3/4" LEVELING BINDER - LANE 2
PLACE 2-1/4" BINDER - OUTSIDE SHOULDER

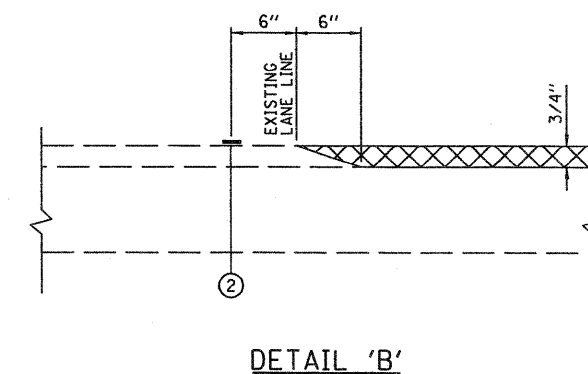

DETAIL 'B'

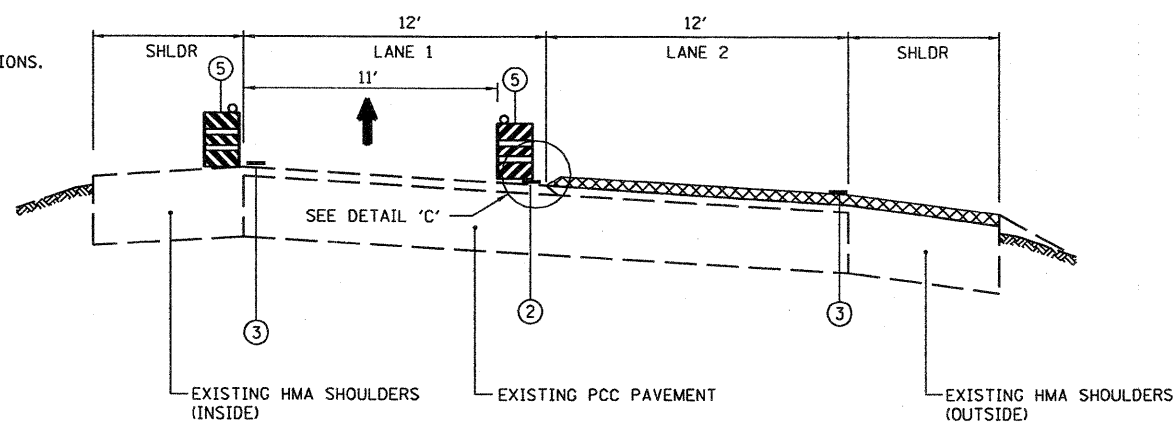

OPERATION FIVE - STONY ISLAND FEEDER RAMPS

PLACE AREA REFLECTIVE CRACK CONTROL TREATMENT LANE 2
PLACE 1-3/4" - SURFACE LANE 2 AND OUTSIDE SHOULDER

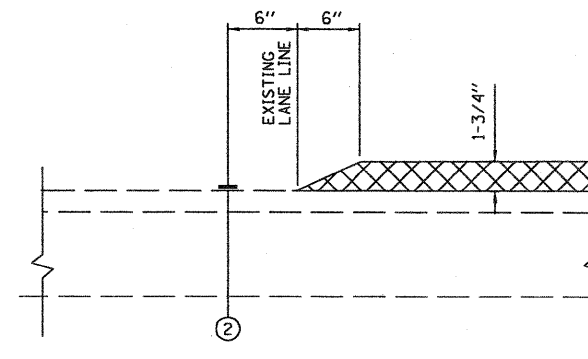

DETAIL 'C'

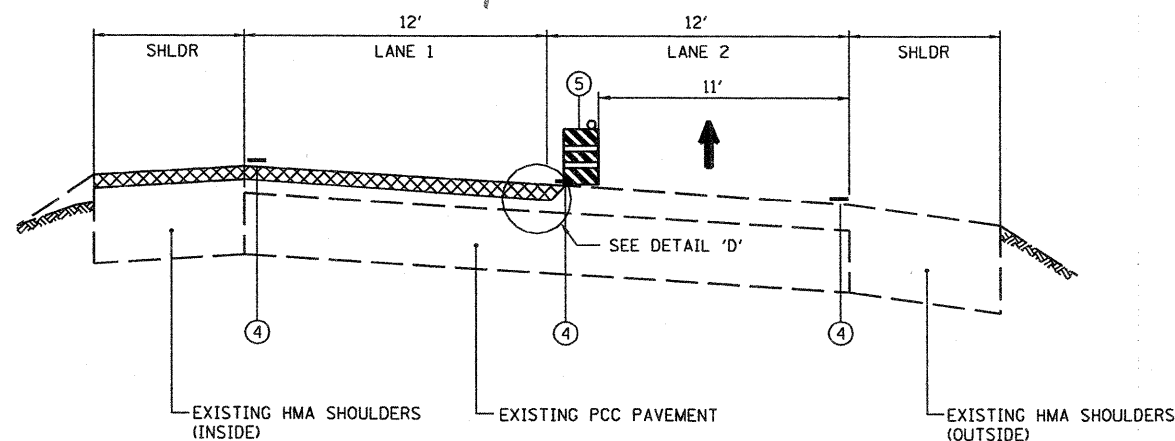

OPERATION SIX - STONY ISLAND FEEDER RAMPS

PLACE AREA REFLECTIVE CRACK CONTROL TREATMENT LANE 1
PLACE 1-3/4" SURFACE - LANE 1 AND INSIDE SHOULDER

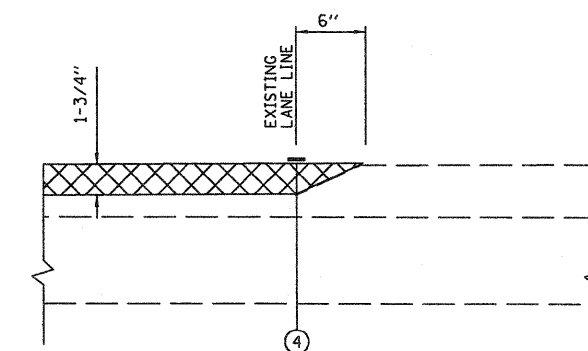

DETAIL 'D'

FILE NAME =
0160C08-061-STAGE I.B.dgn

USER NAME = dvoznirak

DESIGNED -

REVISED -

DRAWN - DMW

REVISED -

PLOT SCALE = N/A

CHECKED -

REVISED -

PLOT DATE = 2/6/2009

DATE - 2/6/2009

REVISED -

STATE OF ILLINOIS
DEPARTMENT OF TRANSPORTATION

BISHOP FORD EXPRESSWAY (I-94)
SUGGESTED MAINTENANCE OF TRAFFIC

SCALE: N/A

SHEET NO. 2 OF 9 SHEETS

STA.

TO STA.

F.A.I. RTE.

94

SECTION

(0312-708W, ETC. & 1315RS-4

COUNTY

COOK

TOTAL SHEETS

167

SHEET NO.

61

CONTRACT NO. 60C08

FED. ROAD DIST. NO. ILLINOIS FED. AID PROJECT