

**LEGEND**

- ⊙ PROPOSED RAMP AND RAMP SHOULDER RESURFACING.
  - HOT - MIX ASPHALT SURFACE REMOVAL, 4"
  - HOT - MIX ASPHALT BINDER COURSE, IL-19.0, N70, 2-1/4"
  - HOT - MIX ASPHALT SURFACE COURSE, MIX "D", N70, 1-3/4"
- HMA PATCH • PROPOSED HOT MIX ASPHALT PAVEMENT PATCH. SEE SCHEDULE OF QUANTITIES
- PCC PATCH • PROPOSED PORTLAND CEMENT CONCRETE PAVEMENT PATCH. SEE SCHEDULE OF QUANTITIES

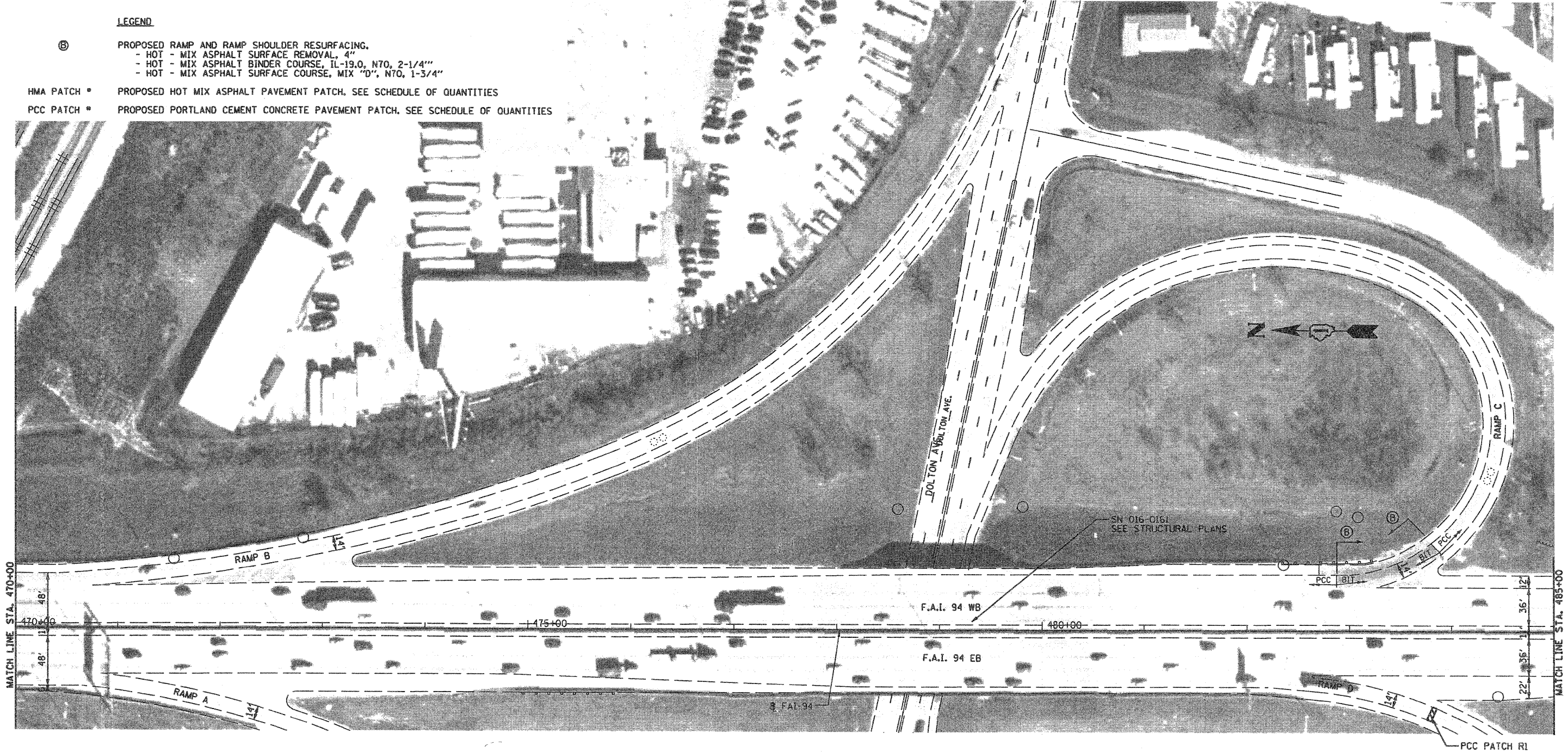

FILE NAME =  
D180C00-052-PLAN.14.dgn

USER NAME = dwozierski  
 DESIGNED -  
 DRAWN - DMW  
 CHECKED -  
 DATE - 2/6/2009

REVISED -  
 REVISED -  
 REVISED -  
 REVISED -

**STATE OF ILLINOIS  
 DEPARTMENT OF TRANSPORTATION**

**BISHOP FORD EXPRESSWAY (I-94)  
 RESURFACING PLAN**

SCALE: 1" = 50' SHEET NO. 14 OF 21 SHEETS STA. 455+00 TO STA. 485+00

F.A.I. RTE.	SECTION	COUNTY	TOTAL SHEETS	SHEET NO.
94	(0312-708W, ETC. & 1315RS-4	COOK	167	52
FED. ROAD DIST. NO.		ILLINOIS FED. AID PROJECT		

CONTRACT NO. 60C08