

LEGEND

- (A) PROPOSED MAINLINE RESURFACING
 - HOT - MIX ASPHALT SURFACE REMOVAL, 2"
 - POLYMERIZED HOT - MIX ASPHALT SURFACE COURSE, STONE MATRIX ASPHALT, N80, 2"
- PROPOSED MAINLINE SHOULDER RESURFACING
 - HOT - MIX ASPHALT SURFACE REMOVAL, 2"
 - HOT - MIX ASPHALT SURFACE COURSE, MIX "D", N70, 2"

- HMA PATCH ■ PROPOSED HOT MIX ASPHALT PAVEMENT PATCH, SEE SCHEDULE OF QUANTITIES
- PCC PATCH ■ PROPOSED PORTLAND CEMENT CONCRETE PAVEMENT PATCH, SEE SCHEDULE OF QUANTITIES

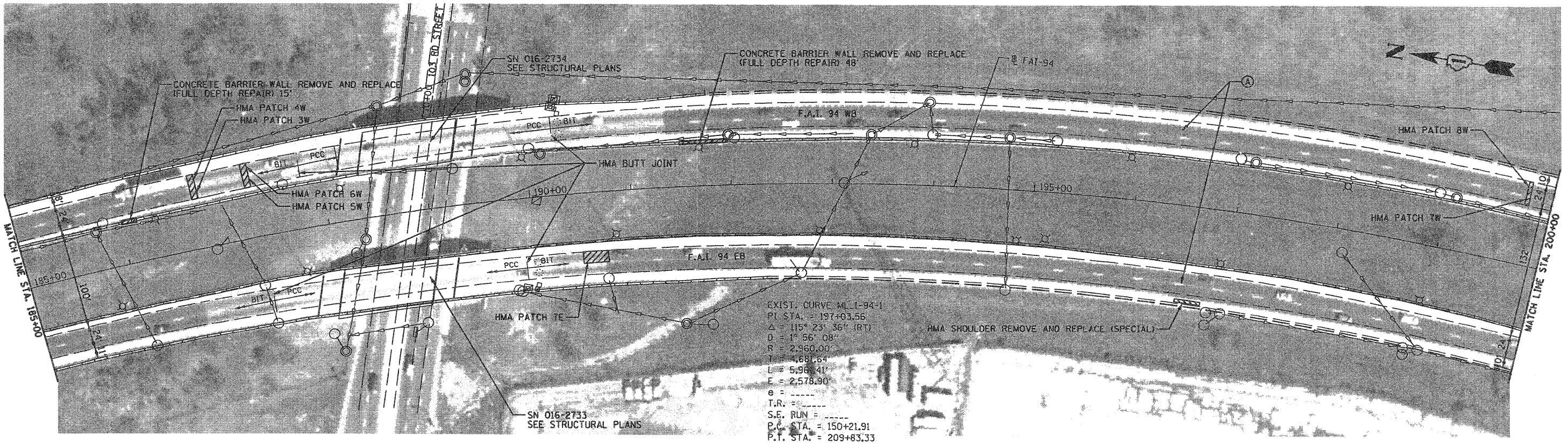
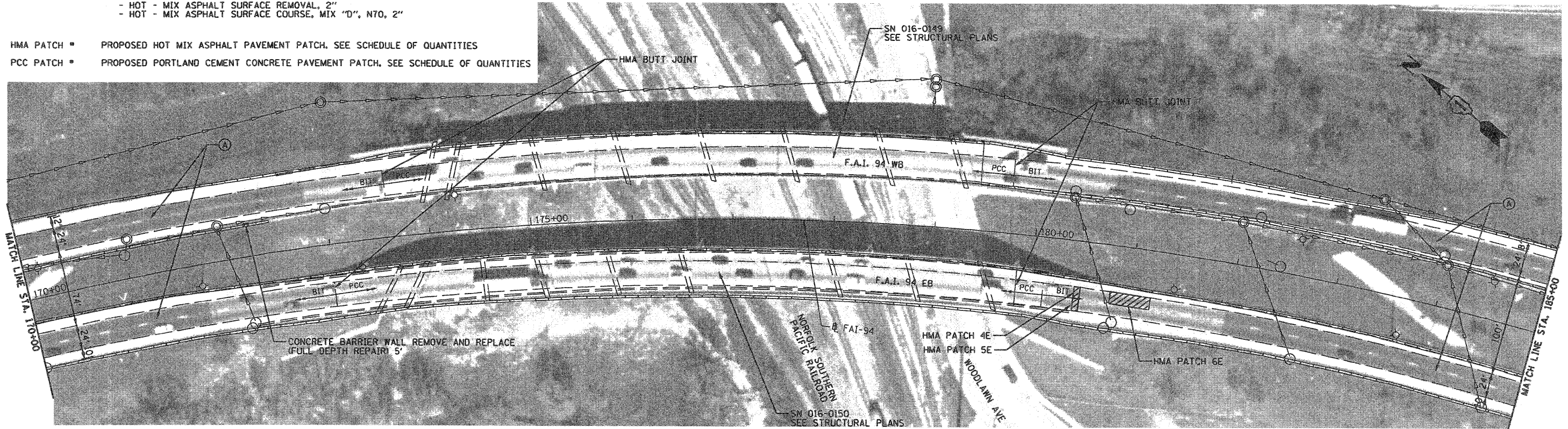

FILE NAME = 0160C08-041-PLAN_3.dgn	USER NAME = dwoznia-sk1	DESIGNED - DRAWN - CHECKED - DATE -	REVISOR - REVISIONS - REVISIONS - REVISIONS - REVISIONS -	STATE OF ILLINOIS DEPARTMENT OF TRANSPORTATION	BISHOP FORD EXPRESSWAY (I-94) RESURFACING PLAN	F.A.I. RTE. 94	SECTION K0312-706W, ETC. & 1315RS-4	COUNTY COOK	TOTAL SHEETS 167	SHEET NO. 41
PLOT SCALE = 100.00' / IN.	PLOT DATE = 2/6/2009	DATE = 2/6/2009	REVISIONS -			SCALE: 1" = 50'	SHEET NO. 3 OF 21 SHEETS	STA. 170+00 TO STA. 200+00	FED. ROAD DIST. NO.	ILLINOIS FED. AID PROJECT