

PLAN

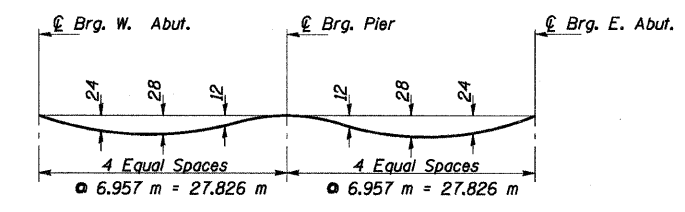

DEAD LOAD DEFLECTION DIAGRAM
(Includes weight of concrete only)

Notes:
The above deflections are not to be used in the field if the engineer is working from the grade elevations adjusted for the dead load deflections as shown on this sheet and on Sheets S5 and S6 of S23.
All dimensions are in millimeters (mm) except as noted.
All elevations and offsets are in meters.

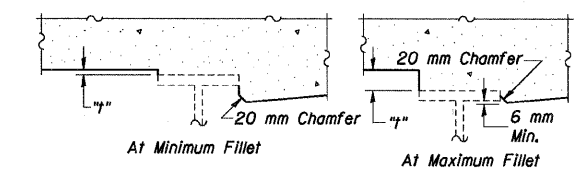

To determine "t": After all structural steel has been erected, elevations of the top flanges of the beams shall be taken at intervals shown on this sheet. These elevations subtracted from the "Theoretical Grade Elevations Adjusted for Dead Load Deflection" shown on this sheet and on Sheets S5 and S6 of S23, minus slab thickness, equals the fillet heights "t" above top flange of beams.

FILLET HEIGHTS

BEAM 1

Location	Station	Offset	Theoretical Grade Elevations	Theoretical Grade Elevations Adjusted For Dead Load Deflection
Bk. of W. Abut.	2354.404	12.037	188.398	188.398
☉ Brq. W. Abut.	2355.089	12.037	188.416	188.416
A	2358.089	12.037	188.492	188.504
B	2361.089	12.037	188.557	188.578
C	2364.089	12.037	188.612	188.639
D	2367.089	12.037	188.657	188.686
E	2370.089	12.037	188.692	188.718
F	2373.089	12.037	188.717	188.736
G	2376.089	12.037	188.731	188.743
H	2379.089	12.037	188.736	188.740
☉ Brq. Pier	2382.915	12.037	188.727	188.727
I	2385.915	12.037	188.709	188.711
J	2388.915	12.037	188.680	188.690
K	2391.915	12.037	188.642	188.659
L	2394.915	12.037	188.593	188.617
M	2397.915	12.037	188.534	188.562
N	2400.915	12.037	188.465	188.493
O	2403.915	12.037	188.386	188.410
P	2406.915	12.037	188.297	188.312
☉ Brq. E. Abut.	2410.741	12.037	188.169	188.169
Bk. of E. Abut.	2411.426	12.037	188.144	188.144

BEAM 2

Location	Station	Offset	Theoretical Grade Elevations	Theoretical Grade Elevations Adjusted For Dead Load Deflection
Bk. of W. Abut.	2354.404	10.107	188.436	188.436
☉ Brq. W. Abut.	2355.089	10.107	188.455	188.455
A	2358.089	10.107	188.530	188.542
B	2361.089	10.107	188.595	188.617
C	2364.089	10.107	188.651	188.678
D	2367.089	10.107	188.695	188.724
E	2370.089	10.107	188.730	188.756
F	2373.089	10.107	188.755	188.775
G	2376.089	10.107	188.770	188.782
H	2379.089	10.107	188.774	188.779
☉ Brq. Pier	2382.915	10.107	188.766	188.766
I	2385.915	10.107	188.747	188.750
J	2388.915	10.107	188.719	188.728
K	2391.915	10.107	188.680	188.698
L	2394.915	10.107	188.631	188.656
M	2397.915	10.107	188.573	188.601
N	2400.915	10.107	188.504	188.532
O	2403.915	10.107	188.425	188.448
P	2406.915	10.107	188.336	188.351
☉ Brq. E. Abut.	2410.741	10.107	188.208	188.208
Bk. of E. Abut.	2411.426	10.107	188.183	188.183

BEAM 3

Location	Station	Offset	Theoretical Grade Elevations	Theoretical Grade Elevations Adjusted For Dead Load Deflection
Bk. of W. Abut.	2354.404	8.177	188.475	188.475
☉ Brq. W. Abut.	2355.089	8.177	188.494	188.494
A	2358.089	8.177	188.569	188.581
B	2361.089	8.177	188.634	188.656
C	2364.089	8.177	188.689	188.716
D	2367.089	8.177	188.734	188.763
E	2370.089	8.177	188.769	188.795
F	2373.089	8.177	188.794	188.813
G	2376.089	8.177	188.808	188.820
H	2379.089	8.177	188.813	188.818
☉ Brq. Pier	2382.915	8.177	188.804	188.804
I	2385.915	8.177	188.786	188.789
J	2388.915	8.177	188.757	188.767
K	2391.915	8.177	188.719	188.736
L	2394.915	8.177	188.670	188.695
M	2397.915	8.177	188.611	188.640
N	2400.915	8.177	188.542	188.571
O	2403.915	8.177	188.464	188.487
P	2406.915	8.177	188.374	188.389
☉ Brq. E. Abut.	2410.741	8.177	188.246	188.246
Bk. of E. Abut.	2411.426	8.177	188.222	188.222

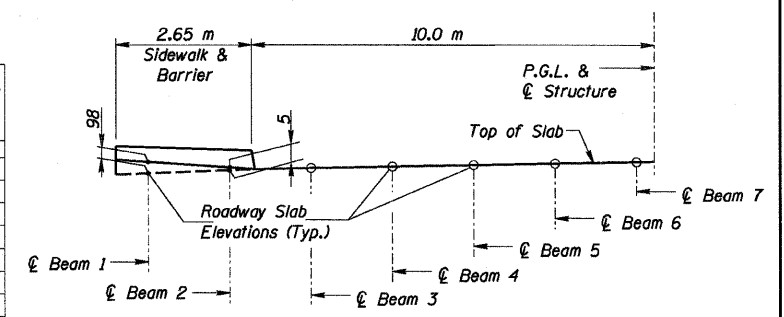

DECK SECTION AT SIDEWALK

Notes:
Work this sheet with Sheets S5 and S6 of S23.

COLLINS ENGINEERS
123 North Wacker Drive
Suite 300
Chicago, IL 60606
(312) 704-9300
www.collinsengr.com
ILLINOIS PROFESSIONAL DESIGN FIRM LICENSE NO. 184-00093

REVISIONS	
NAME	DATE

ILLINOIS DEPARTMENT OF TRANSPORTATION
115 TH. STREET OVER FAI 57
FAU RTE. 1584 SEC. 068-1919.2-CF
COOK COUNTY
STATION 2+382.915
STRUCTURE NO. 016-2037
TOP OF SLAB ELEVATIONS-I
DRAWN BY KAC
CHECKED BY FRB/DGS
DATE: JANUARY 16, 2009