

EXIST. CURVE CUR40 @ NEW BUS 50
 PI STA. = 497+73.51
 $\Delta = 45^\circ 24' 50''$ (RT)
 D = 23' 17' 06"
 R = 246.06'
 T = 102.97'
 L = 195.03'
 E = 20.67'
 P.C. STA. = 496+70.54
 P.T. STA. = 498+65.58

EXIST. CURVE CUR20 @ IL 250
 PI STA. = 9+00.00
 $\Delta = 28^\circ 36' 55''$ (LT)
 D = 4' 00' 16"
 R = 1,430.83'
 T = 364.92'
 L = 714.60'
 E = 45.80'
 P.C. STA. = 5+35.08
 P.T. STA. = 12+49.68

* NOTE: All Mast Arm Mounted Signal Heads to be installed in the middle of the traffic lanes except for the 5 section head installed on the EB mast arm. Locate this head on the lane line between the lanes, then install the 3 section head at a space 8 feet away.

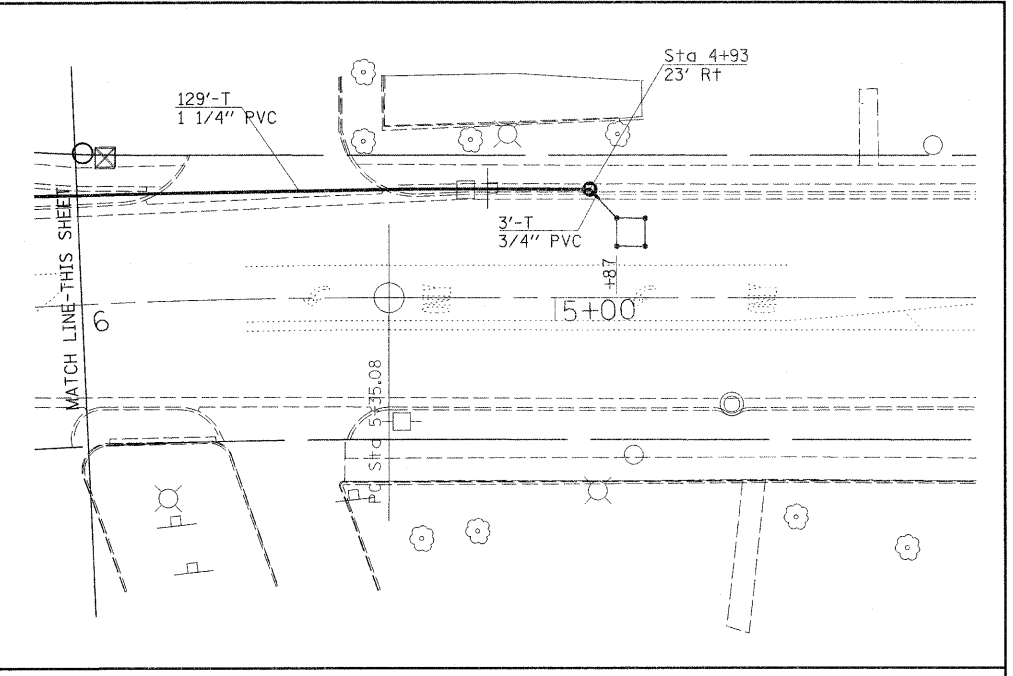

FILE NAME =	USER NAME = mcelleanla	DESIGNED -	REVISED -	STATE OF ILLINOIS DEPARTMENT OF TRANSPORTATION	INTERSECTION-BSN RTE 50 & IL 250 SIGNAL LAYOUT			F.A.S. RTE.	SECTION	COUNTY	TOTAL SHEETS	SHEET NO.
c:\pwork\pwork\mcelleanla\2196565\074480-TS-sht.dgn		DRAWN -	REVISED -		1809	(2)TS-1	LAWRENCE	12	6			
PLOT SCALE = 20.0000' / IN.		CHECKED -	REVISED -		CONTRACT NO. 74480							
PLOT DATE = 12/30/2010		DATE -	REVISED -		ILLINOIS FED. AID PROJECT							
				SCALE:	SHEET NO.	OF	SHEETS	STA.	TO STA.			