

F.A.S. RTE.	SECTION	COUNTY	TOTAL SHEETS	SHEET NO.
1619	(C)I-1	SANGAMON	10	1
		ILLINOIS	CONTRACT NO. 72E30	

**INDEX OF SHEETS**

- 1 COVER SHEET
- 2 GENERAL NOTES/COMMITMENTS
- 3 SUMMARY OF QUANTITIES
- 4-5 TYPICAL SECTIONS
- 6 SCHEDULE OF QUANTITIES
- 7 ALIGNMENT SHEET
- 8-9 SHOULDER STABILIZATION PLAN
- 10 DETAIL OF BRICK PAVEMENT REMOVAL AND REPLACEMENT  
DETAIL OF CURB REMOVAL AND REPLACEMENT

**STATE OF ILLINOIS**  
**DEPARTMENT OF TRANSPORTATION**  
**DIVISION OF HIGHWAYS**

**PROPOSED  
HIGHWAY PLANS**

**FAS ROUTE 1619 (OLD IL 4)  
SECTION (C)I-1**

**BRICK PAVEMENT PATCHING  
SANGAMON COUNTY**

C-96-058-11

**LIST OF STANDARDS**

SHEET NO.	NAME OF STANDARDS
BLR 21-8	TYPICAL APPLICATION OF TRAFFIC CONTROL DEVICES FOR CONSTRUCTION ON RURAL LOCAL HIGHWAYS
BLR 22-6	TYP. APPL. OF T.C.D. FOR RURAL LOC. HWYS. (2-LANE 2 WAY RURAL TRAFF.) (RD. CLOSED TO THRU TRAFF.)
701901-01	TRAFFIC CONTROL DEVICES
701201-04	LANE CLOSURE, 2L, 2W, DAY ONLY, FOR SPEEDS > 45 MPH

D-96-058-11

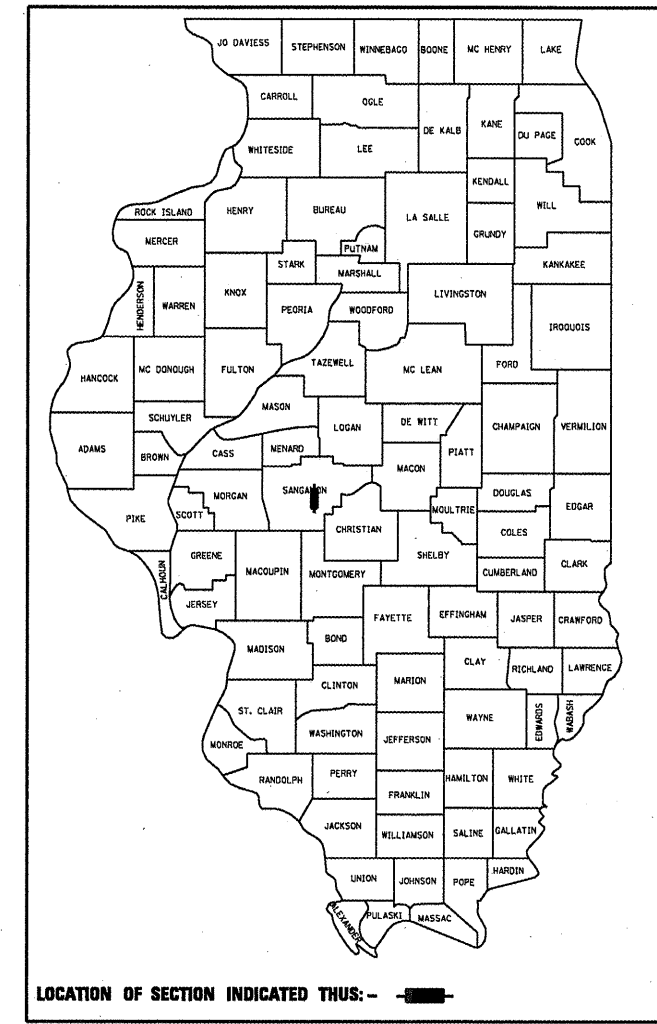

**PROJECT BEGINS**  
STA 736+56.03 (OLD IL 4)

SN 084-0502

SN 084-0501

**PROJECT ENDS**  
STA 802+03.78 (OLD IL 4)

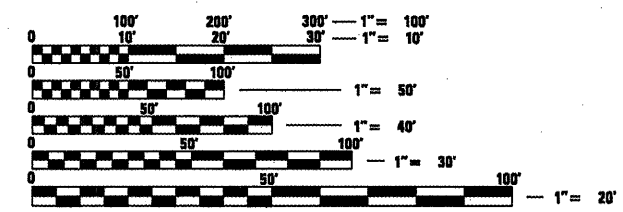
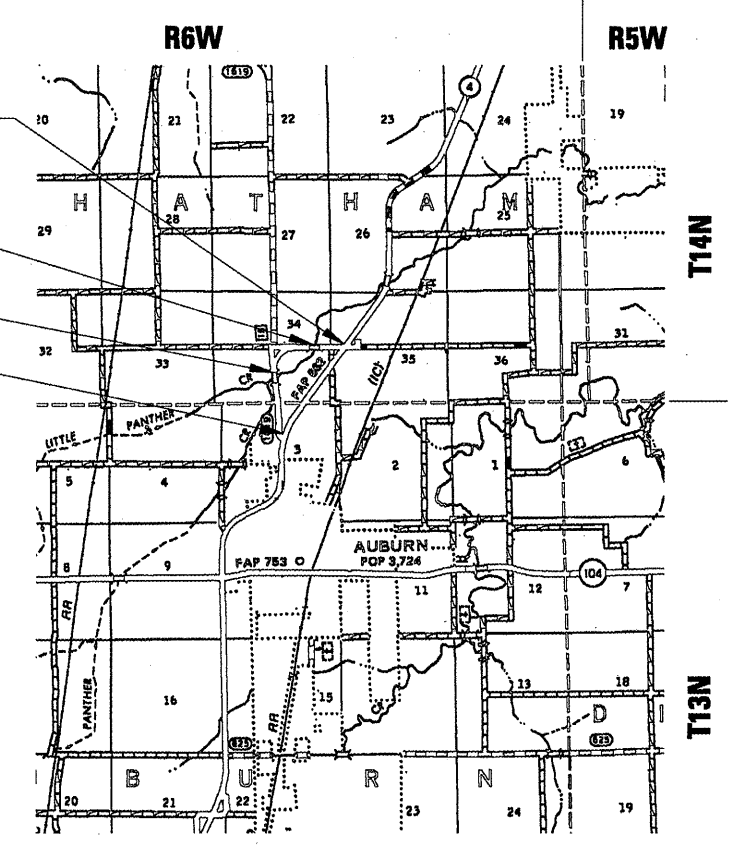

FULL SIZE PLANS HAVE BEEN PREPARED USING STANDARD ENGINEERING SCALES. REDUCED SIZED PLANS WILL NOT CONFORM TO STANDARD SCALES. IN MAKING MEASUREMENTS ON REDUCED PLANS, THE ABOVE SCALES MAY BE USED.

J.U.L.I.E.  
JOINT UTILITY LOCATION INFORMATION FOR EXCAVATION  
1-800-892-0123  
OR 811

ADT = 1000 (2007)  
PV = 834 (83.4%)  
SU = 133 (13.3%)  
MU = 33 (3.3%)

GROSS LENGTH = 6547.75 FT. = 1.240 MILE  
NET LENGTH = 6547.75 FT. = 1.240 MILE

PROJECT ENGINEER: JOHN NEGANGARD 217-782-6990  
PROJECT MANAGER: JAY EDWARDS 217-785-5321

CONTRACT NO. 72E30

STATE OF ILLINOIS  
DEPARTMENT OF TRANSPORTATION  
DIVISION OF HIGHWAYS

SUBMITTED February 17 20 11  
Rega Z. Dmicki  
DEPUTY DIRECTOR OF HIGHWAYS, REGION ENGINEER

March 4 20 11  
Scott E. Still P.E.  
ENGINEER OF DESIGN AND ENVIRONMENT

March 4 20 11  
Christine M. Reed  
DIRECTOR OF HIGHWAYS, CHIEF ENGINEER

**PRINTED BY THE AUTHORITY  
OF THE STATE OF ILLINOIS**