

BM UEL218C: USGS BENCHMARK. CHISLED SQUARE IN CENTER OF WEST CONCRETE HEADWALL OF 36" CMP UNDER IL 4 & LOCATED 42 FT SOUTH OF MONTGOMERY ROAD AT NORTH EDGE OF VIRDEN  
 STA. 248+66.8; 23.6' RT ELEV. = 650.760

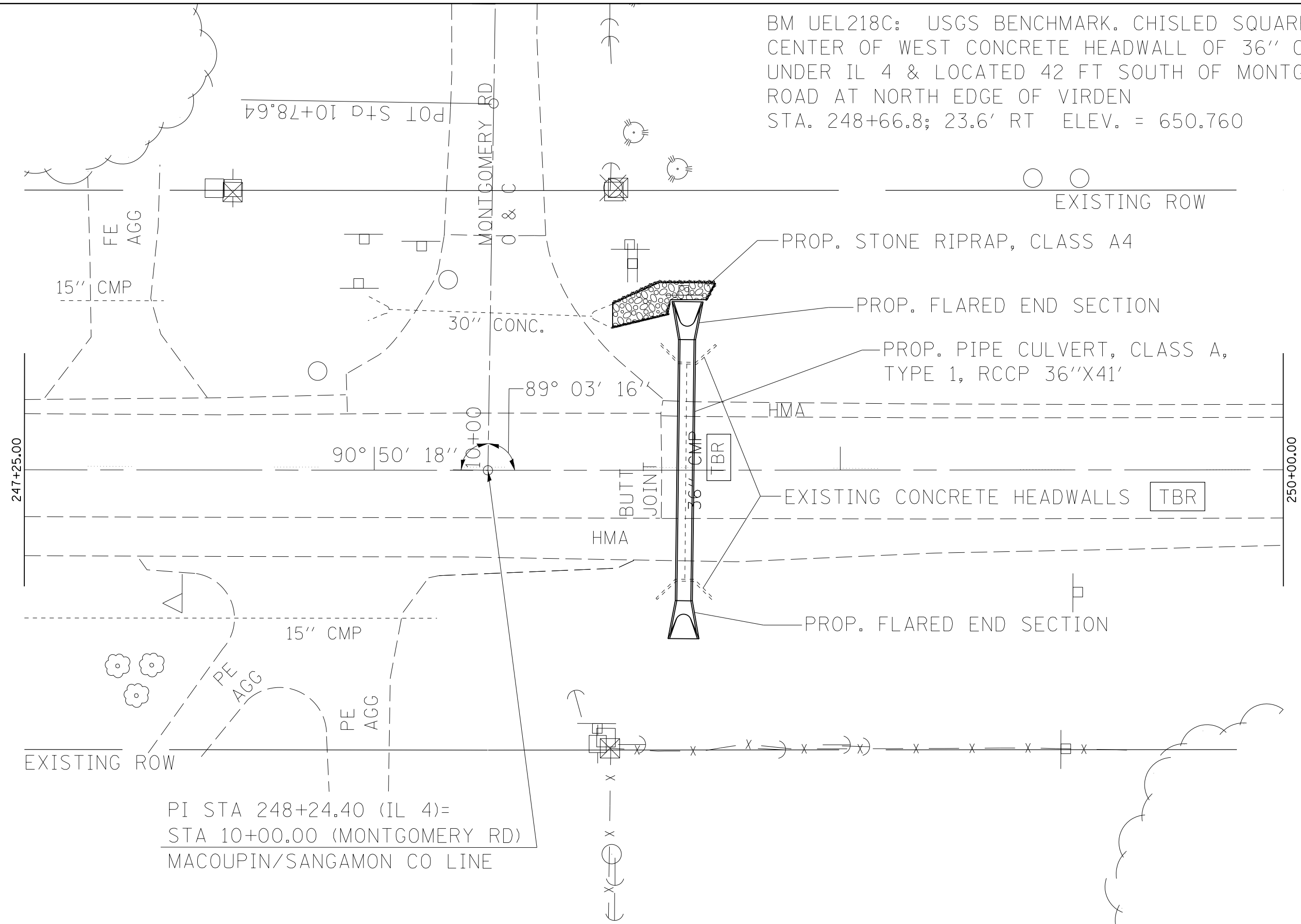

PI STA 248+24.40 (IL 4) =  
 STA 10+00.00 (MONTGOMERY RD)  
 MACOUPIN/SANGAMON CO LINE

FILE NAME =	USER NAME = laughl1n1	DESIGNED -	REVISED -
et:\pwork\pwork\laughl1n1\0254343\0672E21-sh:plansheets.dgn		DRAWN -	REVISED -
		CHECKED -	REVISED -
		DATE -	REVISED -

**STATE OF ILLINOIS  
 DEPARTMENT OF TRANSPORTATION**

<b>PLAN VIEW</b>			
SCALE:	SHEET NO.	OF SHEETS	STA. TO STA.

F.A.P. RTE.	SECTION	COUNTY	TOTAL SHEETS	SHEET NO.
662	(D)CR	MACOUPIN	5	4
CONTRACT NO. 72E21				
ILLINOIS FED. AID PROJECT				