

F.A.P. RTE.	SECTION	COUNTY	TOTAL SHEETS	SHEET NO.
662	(67)I, (109)I-2	MACOUPIN	7	1
		ILLINOIS	CONTRACT NO. 72D83	

**STATE OF ILLINOIS**  
**DEPARTMENT OF TRANSPORTATION**  
**DIVISION OF HIGHWAYS**

**PROPOSED**  
**HIGHWAY PLANS**

**FAP ROUTE 765 (IL 4 / IL 108)**  
**SECTION (67)I, (109)I-2**

**BRICK PAVEMENT PATCHING**  
**MACOUPIN COUNTY**

C-96-018-10

**INDEX OF SHEETS**

- 1 COVER SHEET
- 2 GENERAL NOTES/COMMITMENTS
- 3 SUMMARY OF QUANTITIES
- 4 TYPICAL SECTIONS
- 5 SCHEDULE OF QUANTITIES
- 6 PLAN VIEW OF CARLINVILLE SQUARE
- 7 DETAIL OF BRICK PAVEMENT REMOVAL AND REPLACEMENT

**LIST OF STANDARDS**

SHEET NO.	NAME OF STANDARD
701501-06	URBAN LANE CLOSURE, 2L, 2W, UNDIVIDED
701701-07	URBAN LANE CLOSURE, MULTILANE INTERSECTION
701901-01	TRAFFIC CONTROL DEVICES

D-96-018-10

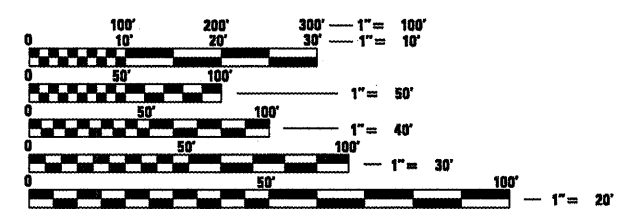
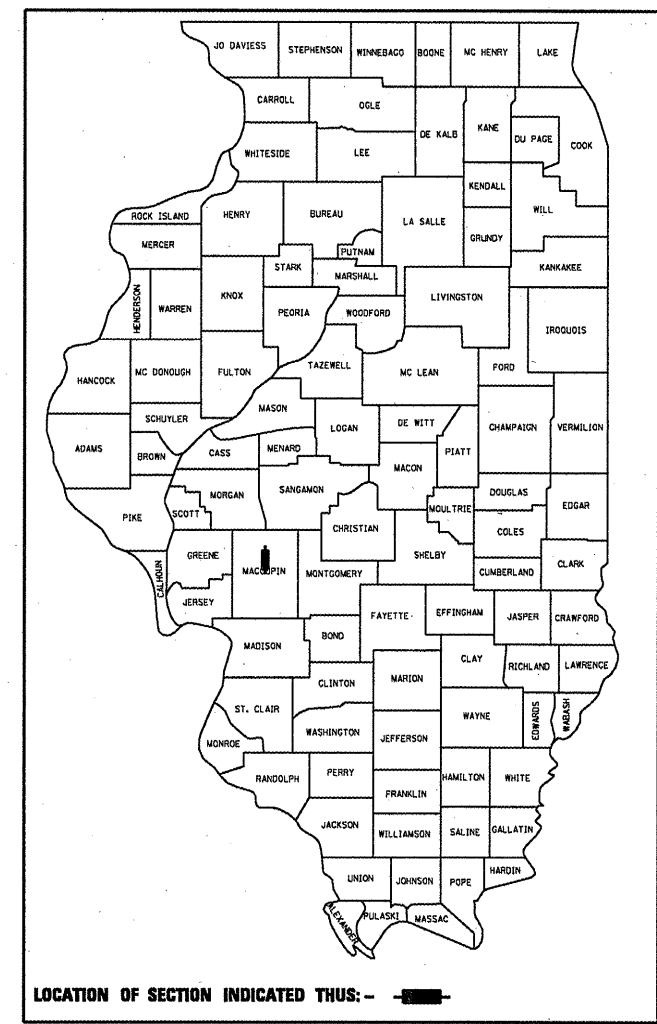

FULL SIZE PLANS HAVE BEEN PREPARED USING STANDARD ENGINEERING SCALES. REDUCED SIZED PLANS WILL NOT CONFORM TO STANDARD SCALES. IN MAKING MEASUREMENTS ON REDUCED PLANS, THE ABOVE SCALES MAY BE USED.

J.U.L.I.E.  
 JOINT UTILITY LOCATION INFORMATION FOR EXCAVATION  
 1-800-892-0123  
 OR 811

ADT = 9400 (2009)  
 PV = 8667 (92.2%)  
 SU = 517 (5.5%)  
 MU = 216 (2.3%)

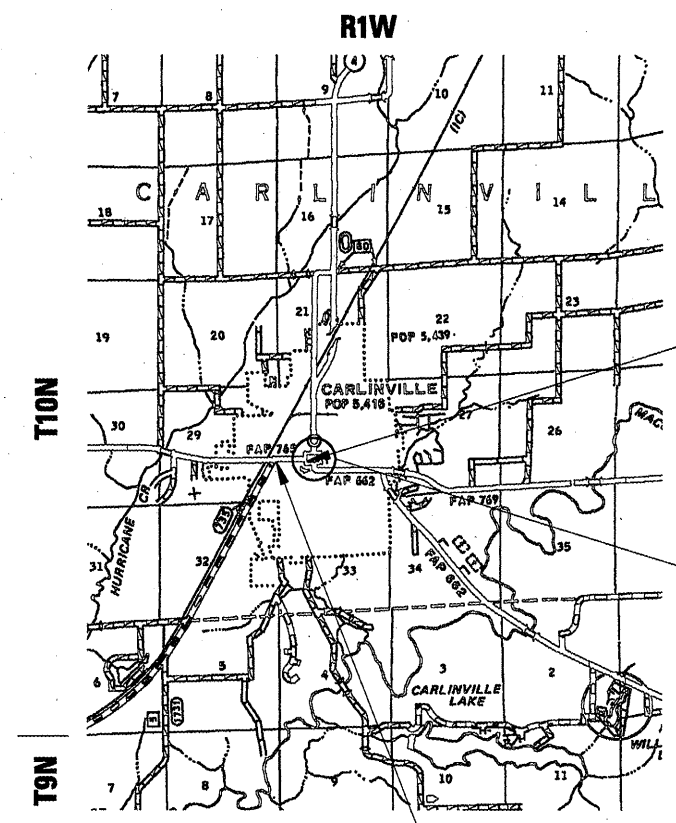

**PROJECT BEGINS**  
**STA 0+14 (IL 108)**

**PROJECT INCLUDES**  
**CARLINVILLE SQUARE**  
**(NO STATIONING)**  
**(IL 4 & IL 108)**

**PROJECT ENDS**  
**STA 15+00 (IL 108)**

GROSS LENGTH = 1514.00 FT. = 0.287 MILE  
 NET LENGTH = 1514.00 FT. = 0.287 MILE

**PROJECT ENGINEER: JOHN NEGANGARD 217-782-6990**  
**PROJECT MANAGER: JAY EDWARDS 217-785-5321**

**CONTRACT NO. 72D83**

STATE OF ILLINOIS  
 DEPARTMENT OF TRANSPORTATION  
 DIVISION OF HIGHWAYS

SUBMITTED *February 17 20 11*  
*Regan L. Smith*  
 DEPUTY DIRECTOR OF HIGHWAYS, REGION ENGINEER

*March 4 20 11*  
*Scott E. Stitt P.E. /sr*  
 acting ENGINEER OF DESIGN AND ENVIRONMENT

*March 4 20 11*  
*Christine M. Reed /sr*  
 DIRECTOR OF HIGHWAYS, CHIEF ENGINEER

**PRINTED BY THE AUTHORITY**  
**OF THE STATE OF ILLINOIS**

**GENERAL NOTES**

- 1 ALL ELEVATIONS SHOWN IN THE PLANS ARE U. S. G. S. MEAN SEA LEVEL DATUM.
- 2 ANY REFERENCE TO STANDARDS THROUGHOUT THE PLANS SHALL BE INTERPRETED TO BE THE LATEST STANDARDS OF THE DEPARTMENT AS SHOWN IN THE PLANS.
- 3 EXISTING PAVEMENT DAMAGED DUE TO THE CONTRACTOR'S OPERATIONS, AND NOT OTHER WISE NECESSARY TO REPLACE, SHALL BE REPLACED AT THE EXPENSE OF THE CONTRACTOR.
- 4 THE LOCATIONS OF THOSE BURIED AND ABOVE GROUND UTILITIES SHOWN ARE APPROXIMATE. THE CONTRACTOR SHALL BE RESPONSIBLE FOR PROTECTING UTILITY PROPERTY FROM CONSTRUCTION OPERATIONS AS OUTLINED IN ARTICLE 107.26 OF THE STANDARD SPECIFICATIONS. THE J.U.L.I.E. NUMBER IS 800-892-0123. A MINIMUM OF FORTY-EIGHT HOURS ADVANCED NOTICE IS REQUIRED.
- 5 THE EXISTING ROAD SIGNS THAT INTERFERE WITH CONSTRUCTION SHALL BE RELOCATED AS DIRECTED BY THE ENGINEER. AFTER THE CONSTRUCTION IS COMPLETED, THE CONTRACTOR WILL REPLACE THE SIGNS AS DIRECTED BY THE ENGINEER. THIS WORK WILL NOT BE PAID FOR SEPARATELY BUT SHALL BE CONSIDERED INCIDENTAL TO THE CONTRACT.
- 6 WHERE SECTION OR SUBSECTION MONUMENTS ARE ENCOUNTERED, THE ENGINEER SHALL BE NOTIFIED BEFORE SUCH MONUMENTS ARE REMOVED. THE CONTRACTOR SHALL PROTECT AND CAREFULLY PRESERVE ALL PROPERTY MARKERS AND MONUMENTS UNTIL THE OWNER AND AUTHORIZED SURVEYOR OR AGENT HAS WITNESSED OR OTHERWISE REFERENCED THEIR LOCATION. IF THE ENGINEER DECIDES TO HAVE THE CONTRACTOR RESET THE MONUMENT, THIS WORK WILL BE PAID FOR IN ACCORDANCE WITH ARTICLE 109.04.

**COMMITMENTS**

- THE FIELD/RESIDENT ENGINEER SHALL CONTACT STUDIES & PLANS CONCERNING ANY MAJOR PLAN CHANGES TO MAKE SURE NO PREVIOUS COMMITMENTS (NOT LISTED) WERE MADE AFFECTING THE DESIGN AND ALLOW AN IMPROVED DESIGN FOR FUTURE PROJECTS.

<b>DISTRICT SIX</b>	
EXAMINED <u>FEB 17</u>	20 <u>11</u>
<i>Chris Walker</i>	
<b>OPERATIONS ENGINEER</b>	

EXAMINED <u>FEB 16</u>	20 <u>11</u>
<i>Tommy F. [Signature]</i>	
<b>PROJECT IMPLEMENTATION ENGINEER</b>	

EXAMINED <u>FEBRUARY 17</u>	20 <u>11</u>
<i>John C. [Signature]</i>	
<b>PROGRAM DEVELOPMENT ENGINEER</b>	

100% STATE  
**URBAN**  
CONSTRUCTION  
TYPE CODE  
0005

Code No.	Item	Unit	Total	
67100100	MOBILIZATION	L SUM	1.0	1.0
70102620	TRAFFIC CONTROL AND PROTECTION, STANDARD 701501	L SUM	1.0	1.0
70102635	TRAFFIC CONTROL AND PROTECTION, STANDARD 701701	L SUM	1.0	1.0
<b>X4420716</b>	CLASS C PATCHES, TYPE I, 9 INCH (SPECIAL)	SQ YD	11.0	11.0
<b>X4420718</b>	CLASS C PATCHES, TYPE II, 9 INCH (SPECIAL)	SQ YD	91.0	91.0
<b>X4420720</b>	CLASS C PATCHES, TYPE III, 9 INCH (SPECIAL)	SQ YD	182.0	182.0
<b>X4420722</b>	CLASS C PATCHES, TYPE IV, 9 INCH (SPECIAL)	SQ YD	397.0	397.0
<b>X0327208</b>	DRAINAGE STRUCTURE PATCH	SQ YD	13.0	13.0
X0325225	BRICK PAVEMENT REMOVAL AND REPLACEMENT	SQ FT	7974.0	7974.0
<b>X0327207</b>	BRICK JOINT FILLER	SQ YD	14820.0	14820.0
X0540000	BRICK PAVERS	SQ FT	1994.0	1994.0

FILE NAME =	USER NAME = laughlinr1	DESIGNED -	REVISED -
et:\pwork\p\dot\laughlinr1\d0222065\062083-sht-500.dgn		DRAWN -	REVISED -
	PLOT SCALE = 100.0000 ' / in.	CHECKED -	REVISED -
	PLOT DATE = Feb-18-2011 10:20:18AM	DATE -	REVISED -

**STATE OF ILLINOIS  
DEPARTMENT OF TRANSPORTATION**

SUMMARY OF QUANTITIES			
SCALE:	SHEET NO.	OF SHEETS	STA. TO STA.

F.A.P. RTE.	SECTION	COUNTY	TOTAL SHEETS	SHEET NO.
662	1671, 11091-2	MACOUPIN	7	3
CONTRACT NO. 72083				
ILLINOIS FED. AID PROJECT				

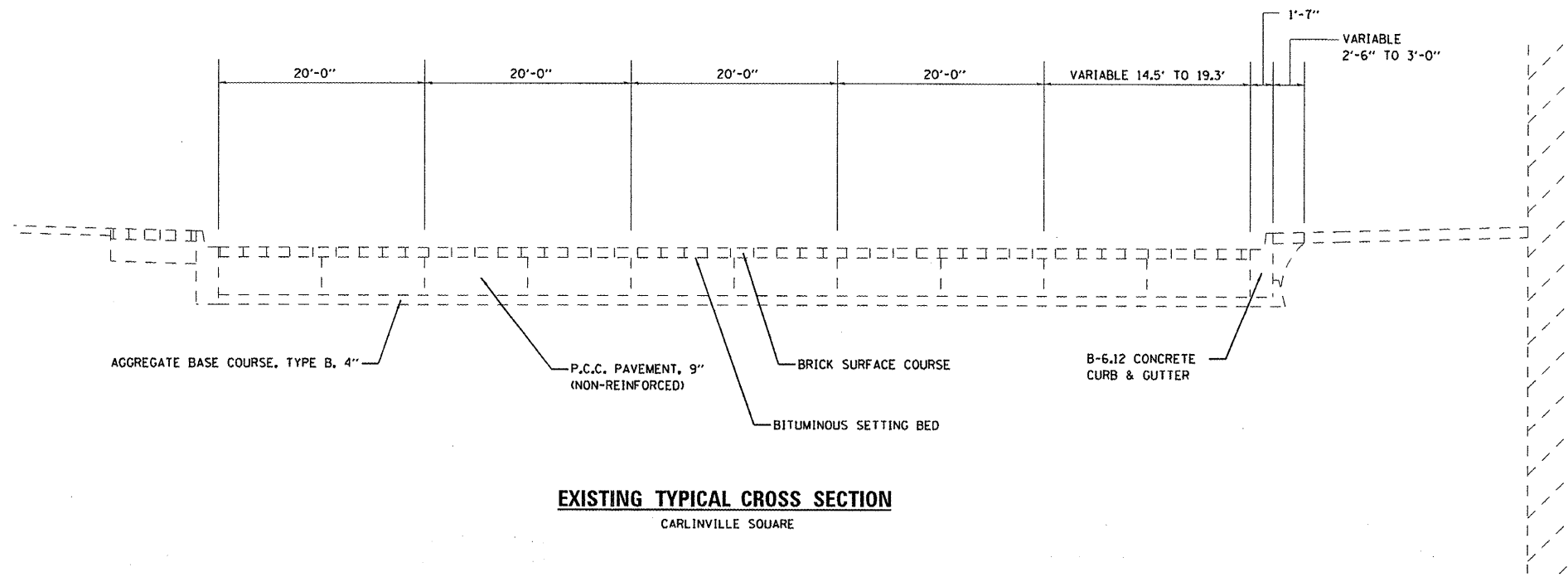

**EXISTING TYPICAL CROSS SECTION**

CARLINVILLE SQUARE

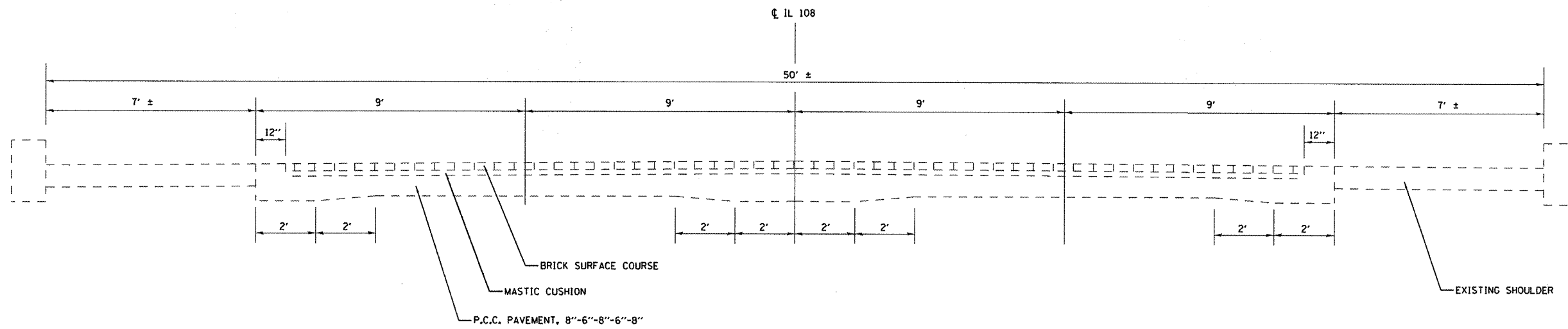

**EXISTING TYPICAL CROSS SECTION**

IL 108 (MAIN STREET)

FILE NAME =	USER NAME = laughlinr1	DESIGNED -	REVISED -
et:\pwork\p\ridot\laughlinr1\0222065\0672083-shr-typical.dgn		DRAWN -	REVISED -
		CHECKED -	REVISED -
		DATE -	REVISED -

**STATE OF ILLINOIS  
DEPARTMENT OF TRANSPORTATION**

<b>TYPICAL SECTION</b>			
SCALE:	SHEET NO.	OF SHEETS	STA. TO STA.

F.A.P. RTE.	SECTION	COUNTY	TOTAL SHEETS	SHEET NO.
662	16711, 110911-2	MACOUPIN	7	4
CONTRACT NO. 72083				
ILLINOIS FED. AID PROJECT				

IL 108

LENGTH	WIDTH		CLASS C PATCH9" (SPECIAL)					DRAINAGE STRUCTURE PATCH
			TYPE 1	TYPE 2	TYPE 3	TYPE 4		
			SQ FT	SQ YD	SQ YD	SQ YD	SQ YD	SQ YD
<b>SQUARE TO WEST STREET</b>								
16	6	LT	144.0		10.7			
5	2.5	LT						1.4
<b>WEST STREET TO PLUM STREET</b>								
40	9.5	CL					42.2	
30	8	CL	320.0				26.7	
6	4	LT						2.7
32	6	CL	272.0			21.3		
2	2	RT	16.0	0.4				
4	3	LT	30.0	1.3				
<b>PLUM STREET TO OAK STREET</b>								
6	4	CL						2.7
20	8	RT	220.0			17.8		
115	8	RT	1170.0				102.2	
<b>OAK STREET TO LOCUST STREET</b>								
4	4	CL						1.8
6	6	LT	64.0	4.0				
10	4	LT						4.4
36	6	FULL WIDTH	304.0			24.0		
<b>LOCUST STREET TO END OF PROJECT</b>								
36	6	FULL WIDTH	304.0			24.0		
36	6	FULL WIDTH	304.0			24.0		

LENGTH	WIDTH		CLASS C PATCH9" (SPECIAL)					DRAINAGE STRUCTURE PATCH
			TYPE 1	TYPE 2	TYPE 3	TYPE 4		
			SQ FT	SQ YD	SQ YD	SQ YD	SQ YD	SQ YD
<b>CARLINVILLE SQUARE (STARTING AT WEST SIDE (IL 108) PROCEEDING COUNTERCLOCKWISE)</b>								
37	3		195.0		12.3			
12	8		140.0		10.7			
7	3		45.0	2.3				
26	5		196.0		14.4			
28	13		450.0				40.4	
45	15		799.0				75.0	
38	12		560.0				50.7	
9	8		110.0		8.0			
50	3		260.0			16.7		
36	6		304.0			24.0		
18	16		360.0				32.0	
15	3		85.0		5.0			
30	3		160.0		10.0			
8	3		50.0	2.7				
23	3		125.0		7.7			
45	3		235.0			15.0		
15	7		153.0		11.7			
50	5		364.0				27.8	
45	3		235.0			15.0		

<b>TOTALS</b>						
7974.0	10.7	90.5	181.8	397.0		12.9
<b>SQ FT</b>	<b>SQ YD</b>	<b>SQ YD</b>	<b>SQ YD</b>	<b>SQ YD</b>		<b>SQ YD</b>
<b>BRICK PAV'T REM AND REPL</b>	<b>CLASS C PATCH9" (SPECIAL)</b>					<b>DRAINAGE STRUCTURE PATCH</b>
	TYPE 1	TYPE 2	TYPE 3	TYPE 4		
<b>USE</b>	7974.0	11.0	91.0	182.0	397.0	13.0

FILE NAME =	USER NAME = laughlin-l	DESIGNED -	REVISED -
c:\pwork\pvidot\laughlin\08222065\062083-shr-schedule.dgn		DRAWN -	REVISED -
PLOT SCALE = 100.0000 ' / in.		CHECKED -	REVISED -
PLOT DATE = Feb-18-2011 10:20:27AM		DATE -	REVISED -

STATE OF ILLINOIS  
DEPARTMENT OF TRANSPORTATION

SCHEDULE OF QUANTITIES

SCALE:	SHEET NO.	OF	SHEETS	STA.	TO	STA.
--------	-----------	----	--------	------	----	------

F.A.P. RTE.	SECTION	COUNTY	TOTAL SHEETS	SHEET NO.
662	(67), (109)I-2	MACOUPIN	7	5
CONTRACT NO. 72DB3			ILLINOIS FED. AID PROJECT	

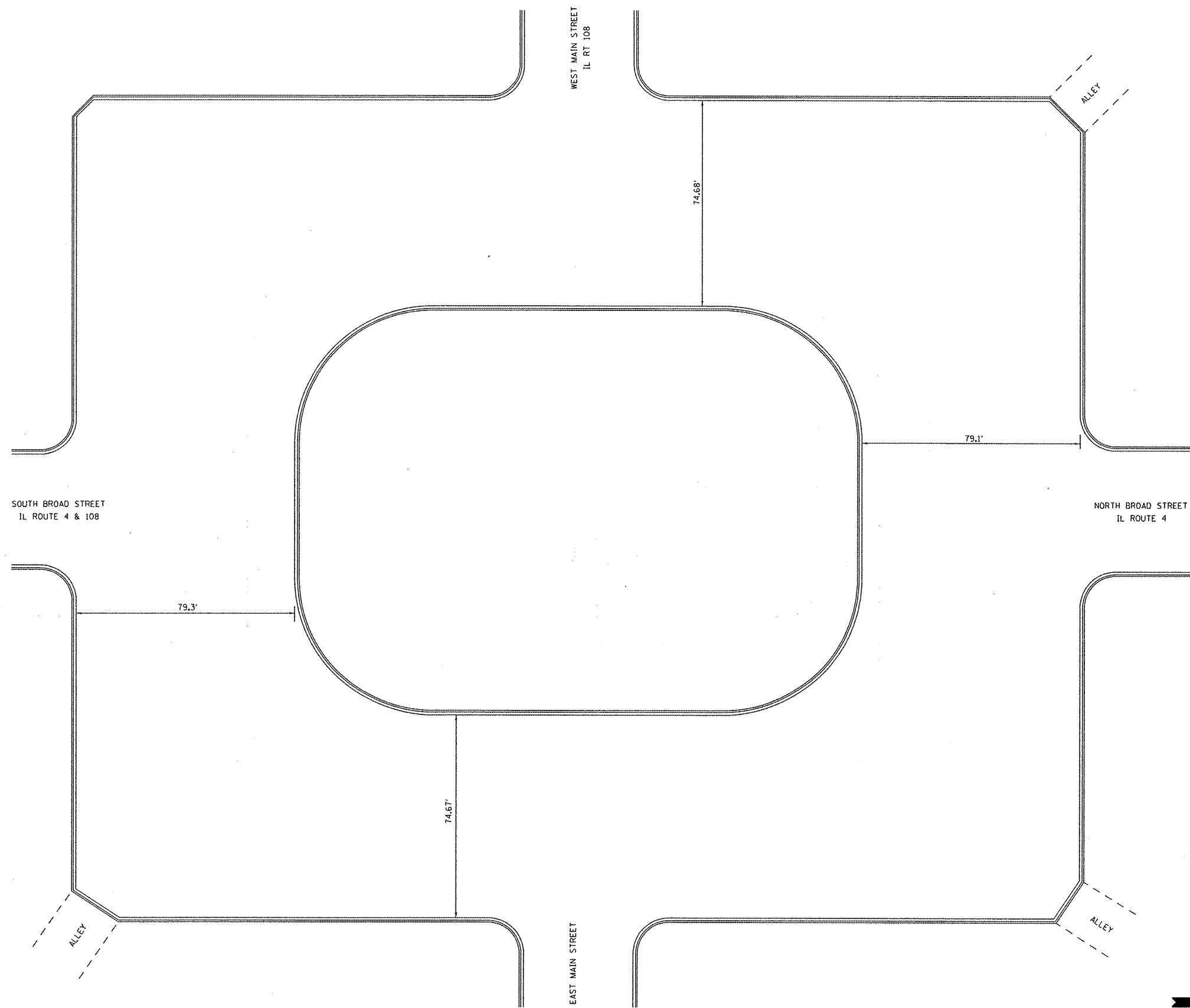

NOT TO SCALE

FILE NAME =	USER NAME = laughlinr1	DESIGNED -	REVISED -
c:\pwworksp\puidot\laughlinr1\0222065\0672083-shr-detail-carlinvillesquare.dgn		DRAWN -	REVISED -
		CHECKED -	REVISED -
		DATE -	REVISED -

**STATE OF ILLINOIS  
DEPARTMENT OF TRANSPORTATION**

**CARLINVILLE CITY SQUARE**

SCALE:	SHEET NO. OF SHEETS	STA. TO STA.	F.A.P. RTE. 662	SECTION (67)1, (109)1-2	COUNTY MACOUPIN	TOTAL SHEETS 7	SHEET NO. 6
						CONTRACT NO. 72D83	
ILLINOIS FED. AID PROJECT							

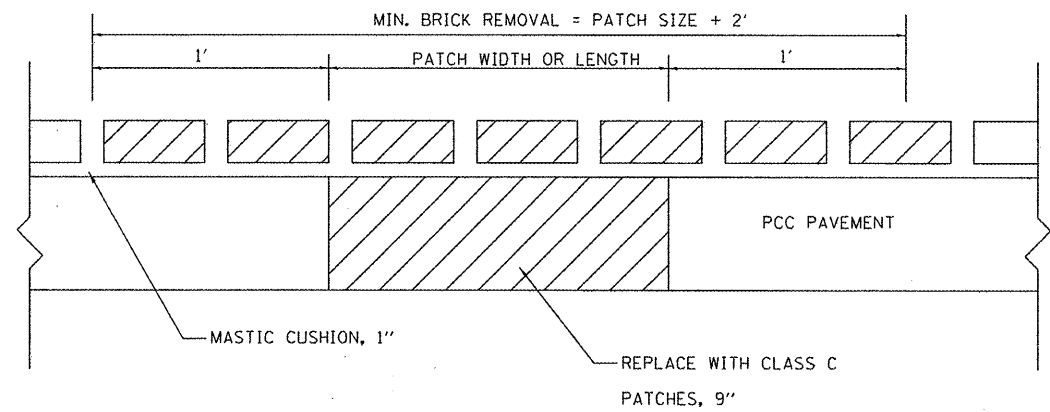

DETAIL OF BRICK PAVEMENT REMOVAL AND REPLACEMENT

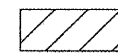
 REMOVAL AND REPLACEMENT LIMITS

FILE NAME =	USER NAME = laughlinr1	DESIGNED -	REVISED -
ct:\pr-work\p1\dot\laughlinr1\08222065\06	Z083-sht-details.dgn	DRAWN -	REVISED -
	PLOT SCALE = 40.0000' / 1"	CHECKED -	REVISED -
	PLOT DATE = Feb-18-2011 10:20:36AM	DATE -	REVISED -

STATE OF ILLINOIS  
DEPARTMENT OF TRANSPORTATION

DETAILS

SCALE:	SHEET NO.	OF	SHEETS	STA.	TO STA.
--------	-----------	----	--------	------	---------

F.A.P. RTE.	SECTION	COUNTY	TOTAL SHEETS	SHEET NO.
662	16711, 110911-2	MACOUPIN	7	7
CONTRACT NO. 72083				
ILLINOIS FED. AID PROJECT				