

Existing Structure: S.N. 016-0367 was built in 1934 as S.B.I. Route 60, Section 60B&C-NRM, as a three span structure with simply supported steel beams on reinforced concrete abutments and piers. In 1987 as F.A.P. Route 525, Section 60B-1-R(81), the concrete bridge deck was removed and replaced, selected beams were removed and replaced, and other various repairs were performed.

Traffic to be maintained using stage construction.

No salvage.

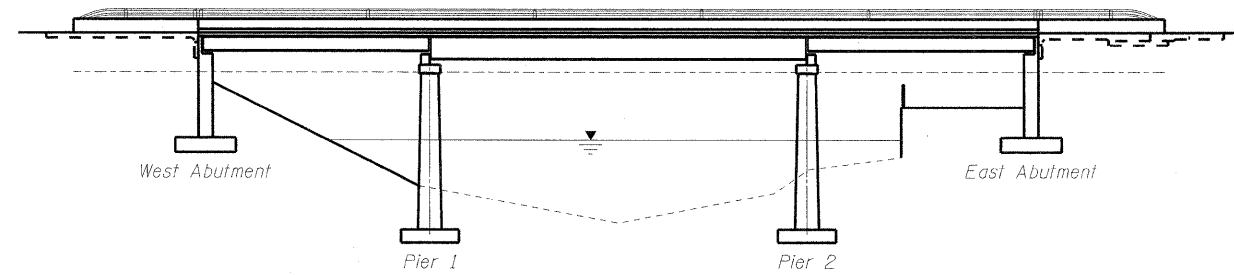

ELEVATION

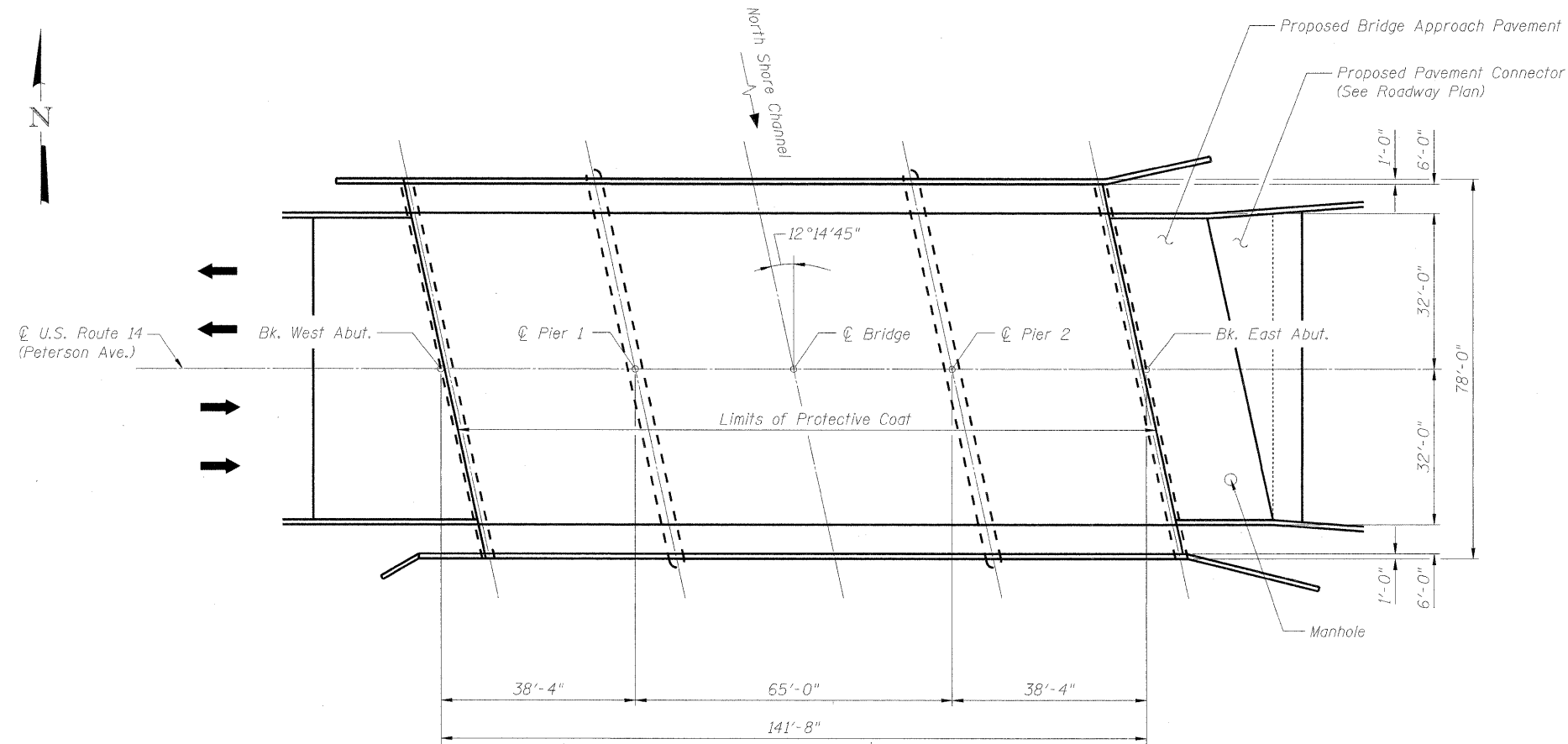

PLAN

SCOPE OF WORK

1. Reconstruct East Approach Slab
2. Apply protective coat to East Approach Slab
3. Apply protective coat to existing bridge deck

DESIGN SPECIFICATIONS

2002 AASHTO Standard Specifications for Highway Bridges, 17th Edition

DESIGN STRESSES

FIELD UNITS

$f'_c = 3,500$ psi
 $f_y = 60,000$ psi (reinforcement)



Brad H. Sayers
 BRAD H. SAYERS, S.E.
 IL. LIC. NO. 081-006267
 EXP 11/30/12
 DATE 3/7/11

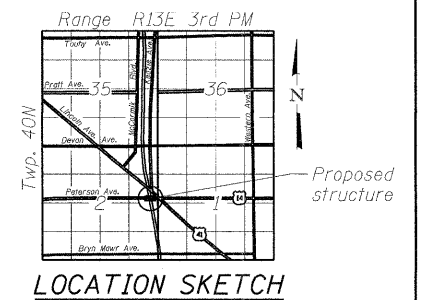

FILE NAME = G:\projects\2102156_0065\CAD\Structural\0160367_60L55_001_General_Plan.dgn

	USER NAME = 2sayerb	DESIGNED - BHS	REVISED -	STATE OF ILLINOIS DEPARTMENT OF TRANSPORTATION	GENERAL PLAN AND ELEVATION S.N. 016-0367	F.A.P. RTE. 0341	SECTION 2010-070-1	COUNTY COOK	TOTAL SHEETS 18	SHEET NO. 7
	PLOT SCALE = N/A	CHECKED - GSP	REVISED -			SHEET NO. S1 OF 6 SHEETS	CONTRACT NO. 60L55			
	PLOT DATE = 3/7/2011	DRAWN - MJB	REVISED -			FED. ROAD DIST. NO. 1 ILLINOIS FED. AID PROJECT				
		CHECKED - GSP	REVISED -							