

IL. ROUTE 53

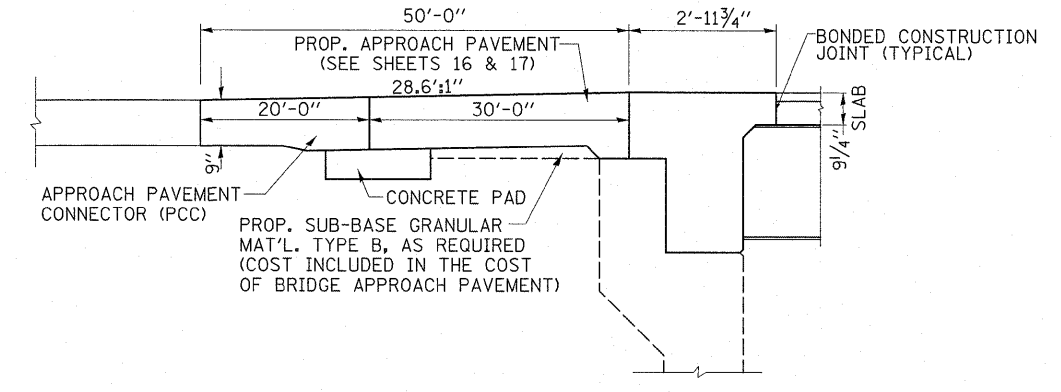
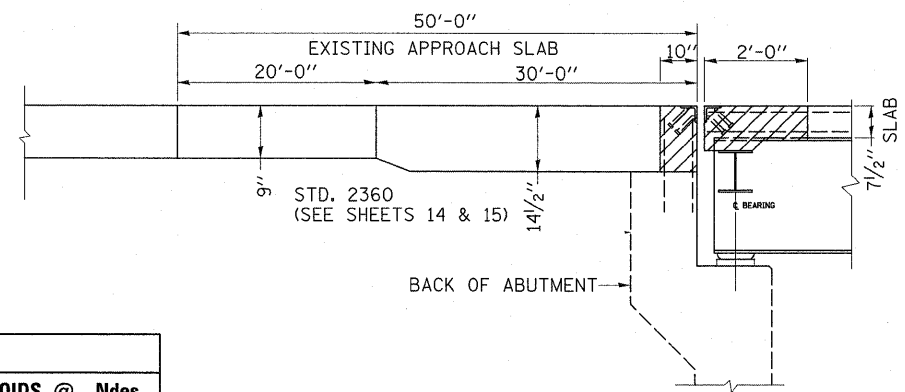
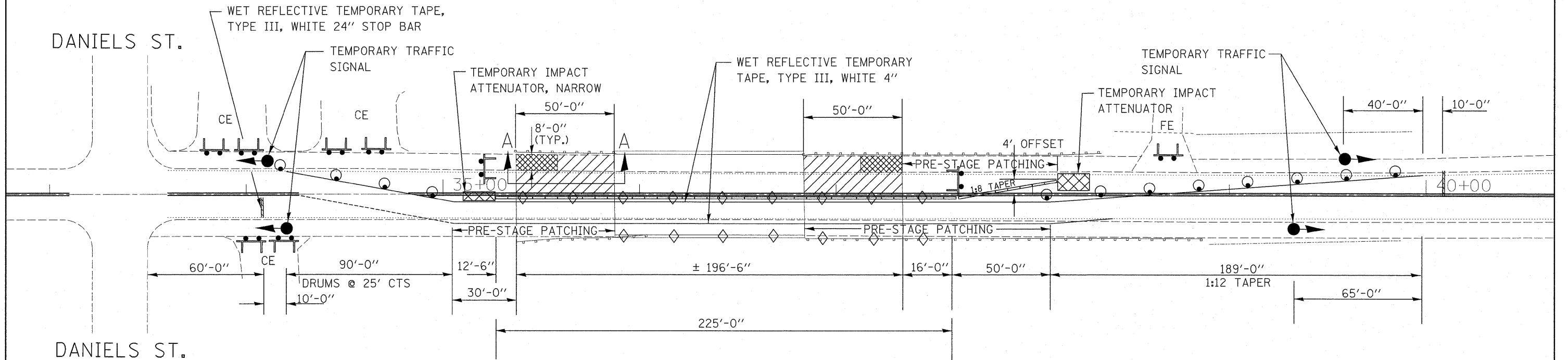

HOT-MIX ASPHALT MIXTURE REQUIREMENTS	
MIXTURE TYPE	AIR VOIDS @ Ndes
HOT-MIX ASPHALT SHOULDER	
TOP 2"	
HOT-MIX ASPHALT SURFACE COURSE, MIX "D", N50, (IL 9.5 mm)	4% @ 50 GYR.
BOTTOM 6"	
HOT-MIX ASPHALT BINDER COURSE, IL-19.0, N50 (2 LIFTS)	4% @ 50 GYR.

- THE UNIT WEIGHT USED TO CALCULATE ALL HOT-MIX ASPHALT SURFACE MIXTURES IS 112 LBS/SQ.YD./IN

- THE AC TYPE FOR POLYMERIZED HMA MIXES SHALL BE SBS/SBR PG 70 -22 AND FOR NON-POLYMERIZED HMA THE AC TYPE SHALL BE PG 64 -22 UNLESS MODIFIED BY DISTRICT ONE SPECIAL PROVISIONS. FOR "PERCENT OF RAP" SEE DISTRICT ONE SPECIAL PROVISIONS.

LEGEND

- TYPE III BARRICADE
- TEMPORARY CONCRETE BARRIER
- DRUM WITH STEADY BURN MONODIRECTIONAL LIGHT
- 8" PAVED SHOULDER REMOVAL
8" HMA SHOULDER
- APPROACH PAVEMENT

NOTE:

- BARRIER WALL/ GUARDRAIL MARKERS AT 25' CTS SEE STANDARDS 704001 & 635011
- TYPE III BARRICADES TO BE PLACED WHEN NO WORK IS BEING PERFORMED
- ADVANCE WARNING SIGNS & TRAFFIC CONTROL ON IL 53 SHALL BE ACCORDING TO STANDARD 701321 EXCEPT AS SHOWN. COST INCLUDED WITH "TRAFFIC CONTROL AND PROTECTION (SPECIAL)".