

STATE OF ILLINOIS
DEPARTMENT OF TRANSPORTATION

F.A.P. RTE.	SECTION	COUNTY	TOTAL SHEETS	SHEET NO.
326	D5 CM PATCH 2022-2	CHAMPAIGN	6	1
		ILLINOIS	CONTRACT NO. 70F59	

D-95-005-22

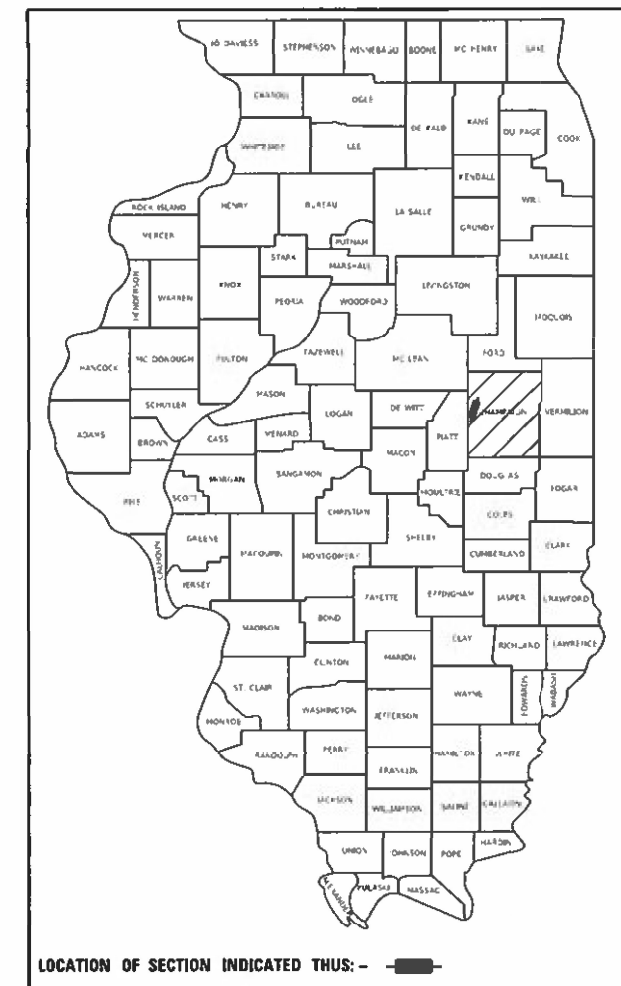

LOCATION OF SECTION INDICATED THUS: - [shaded box] -

FOR INDEX OF SHEETS, SEE SHEET NO. 2
FOR SUMMARY OF QUANTITIES, SEE SHEET NO. 3

TRAFFIC DATA		
	Leg "A"	Leg "B"
2021 ADT =	IL 47 6,850	IL 47 7,950
P.U. & P.C.% =	84.0	92.0
SU% =	8.0	3.5
MU% =	8.0	4.5
Truck Rte. Class =	Class II	Class II
N.H.S. Route =	Yes	Yes

Leg "A" is IL 47 from 0.5 miles north of I-74 WB ramps to I-74 WB ramps.
Leg "B" is IL 47 from I-74 WB ramps to I-74 EB ramps.

PROPOSED
HIGHWAY PLANS

FAP ROUTE 326 (ILL 47)
SECTION D5 CM PATCH 2022-2
PATCHING
CHAMPAIGN COUNTY

C-95-022-22

AT I-74 N. OF MAHOMET

DESIGN DESIGNATION
OTHER PRINCIPAL ARTERIAL

TOWNSHIP
MAHOMET

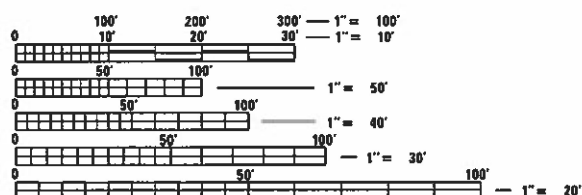

FULL SIZE PLANS HAVE BEEN PREPARED USING STANDARD ENGINEERING SCALES. REDUCED SIZED PLANS WILL NOT CONFORM TO STANDARD SCALES. IN MAKING MEASUREMENTS ON REDUCED PLANS, THE ABOVE SCALES MAY BE USED.

J.U.L.I.E.
JOINT UTILITY LOCATION INFORMATION FOR EXCAVATORS
1-800-892-0123
OR 811

PROJECT ENGINEER: JASON STULTS
DESIGNER: JOSEPH GRAZIANO
PHONE NUMBER: (217)465-4181

CONTRACT NO. 70F59

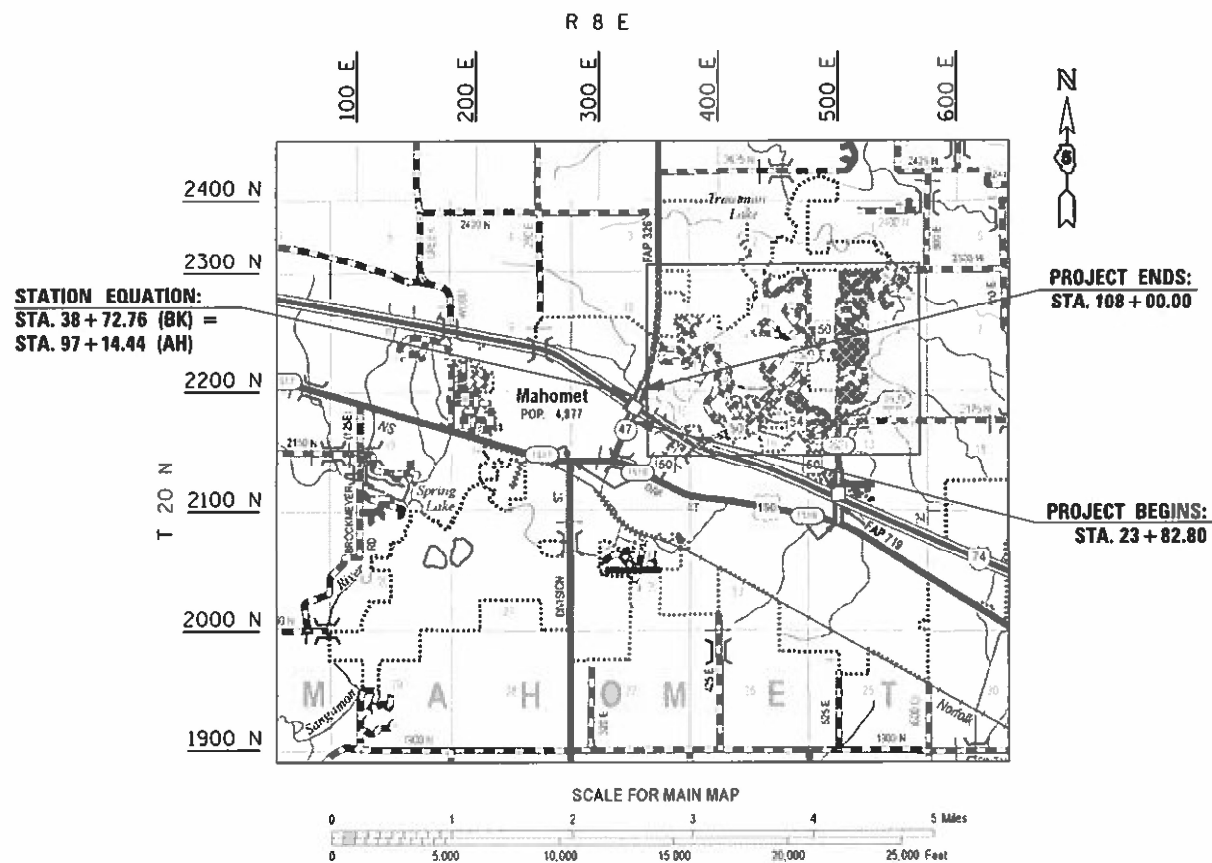

STATE OF ILLINOIS
DEPARTMENT OF TRANSPORTATION

SUBMITTED 12/14/2021
Renail A. Harroth swm
REGIONAL ENGINEER

February 4, 2022
[Signature]
ENGINEER OF DESIGN AND ENVIRONMENT

February 4, 2022
Stephen M. [Signature]
DIRECTOR OF HIGHWAYS PROJECT IMPLEMENTATION

PRINTED BY THE AUTHORITY
OF THE STATE OF ILLINOIS

INDEX OF SHEETS

<u>SHEET NO.</u>	<u>DESCRIPTION</u>
1	COVER SHEET
2	INDEX OF SHEETS
2	HIGHWAY STANDARDS
2	GENERAL NOTES
3	SUMMARY OF QUANTITIES
4-5	TYPICAL CROSS SECTIONS
6	SCHEDULE OF QUANTITIES

LIST OF HIGHWAY STANDARDS

<u>STANDARD NO.</u>	<u>DESCRIPTION</u>
000001-08	STANDARDS SYMBOLS, ABBREVIATIONS, & PATTERNS
001001-02	AREAS OF REINFORCEMENT BARS
001006	DECIMAL OF AN INCH AND OF A FOOT
420001-10	PAVEMENT JOINTS
420701-03	PAVEMENT WELDED WIRE REINFORCEMENT
442101-09	CLASS B PATCHES
701001-02	OFF-ROAD OPERATIONS, 2L, 2W, MORE THAN 15' AWAY
701006-05	OFF-ROAD OPERATIONS, 2L, 2W, 15' TO 24" FROM PAVEMENT EDGE
701301-04	LANE CLOSURE, 2L, 2W, SHORT TIME OPERATIONS
701456-05	PARTIAL EXIT RAMP CLOSURE FREEWAY / EXPRESSWAY
701501-06	URBAN LANE CLOSURE, 2L, 2W, UNDIVIDED
701701-10	URBAN LANE CLOSURE, MULTILANE INTERSECTION
701901-08	TRAFFIC CONTROL DEVICES

GENERAL NOTES

G.N. - 100A
ELECTRONIC FILES AND/OR ELECTRONIC SURVEY INFORMATION INCLUDING CADD FILES WILL NOT BE AVAILABLE TO THE CONTRACTOR.

G.N. - 780 (SPL)
PAVEMENT MARKING FOR THIS PROJECT IS TO BE PERFORMED BY OTHERS, FIELD PERSONNEL SHALL NOTIFY GARY SIMS, DISTRICT 5 TRAFFIC OPERATIONS ENGINEER AT (217) 465-4181 WHEN THE PROJECT IS COMPLETE AND READY FOR PAVEMENT MARKINGS.

COMMITMENTS

NO COMMITMENTS

MODEL: D:\default
FILE: Name: p:\ulideck-cw-bentley.com\FWIDOT\Documents\DOT Offices\District 5\Projects\0570F59\CADD\data\CAD\heest\0570F59-shl-ContNotes.dgn

USER NAME = grazianoja	DESIGNED -	REVISED -	STATE OF ILLINOIS DEPARTMENT OF TRANSPORTATION	INDEX OF SHEETS, HIGHWAY STANDARDS, & GENERAL NOTES	F.A.P. RTE.	SECTION	COUNTY	TOTAL SHEETS	SHEET NO.
PLOT SCALE = 40,0000 ' / in.	DRAWN -	REVISED -			326	D5 CM PATCH 2022-2	CHAMPAIGN	6	2
PLOT DATE = 12/14/2021	CHECKED -	REVISED -			CONTRACT NO. 70F59				
	DATE -	REVISED -			SCALE:		SHEET 1	OF 1	SHEETS
					ILLINOIS FED. AID PROJECT				

① EXISTING TYPICAL CROSS SECTION

STATION TO STATION
 23+82.80 38+72.76 (BK)
 97+14.44 (AH) 99+61.80 ②

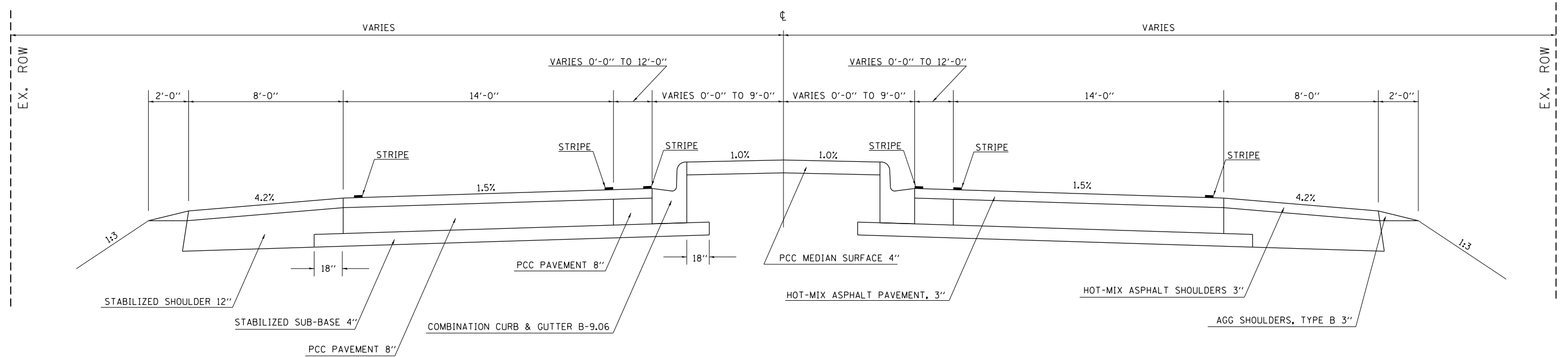

② EXISTING TYPICAL CROSS SECTION

STATION TO STATION
 ① 99+61.80 104+06.45 ③

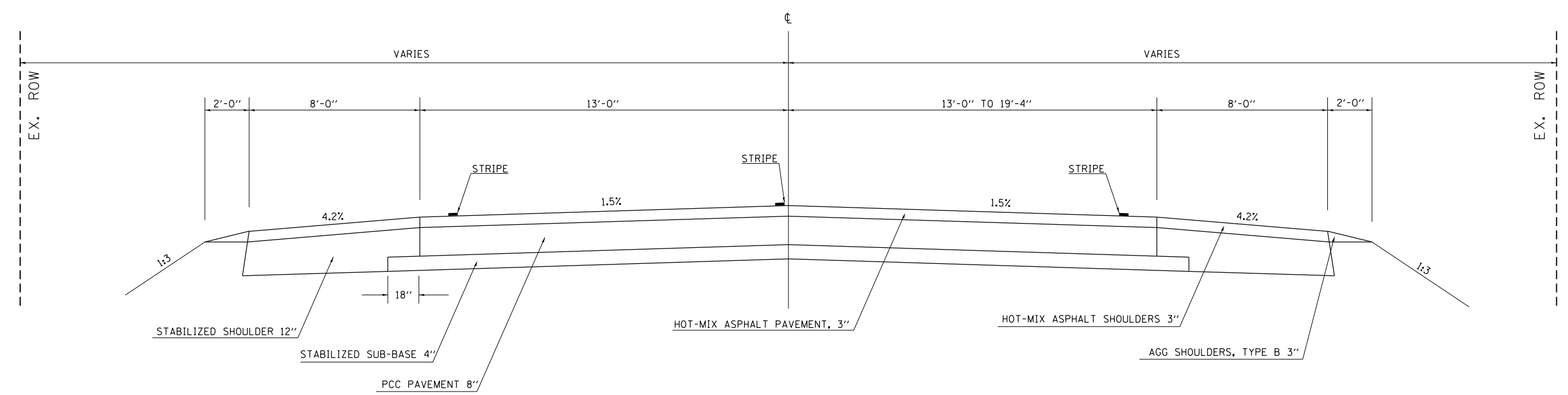

MODEL: D:\p\...
 FILE: NAME: ...
 PROJECT: ...
 DATE: ...

USER NAME = grazianoja	DESIGNED -	REVISED -
	DRAWN -	REVISED -
PLOT SCALE = 40,0000 ' / in.	CHECKED -	REVISED -
PLOT DATE = 12/14/2021	DATE -	REVISED -

**STATE OF ILLINOIS
 DEPARTMENT OF TRANSPORTATION**

TYPICAL CROSS SECTIONS			
SCALE:	SHEET 1	OF 2 SHEETS	STA. TO STA.

F.A.P. RTE.	SECTION	COUNTY	TOTAL SHEETS	SHEET NO.
326	D5 CM PATCH 2022-2	CHAMPAIGN	6	4
CONTRACT NO. 70F59				
ILLINOIS FED. AID PROJECT				

3 EXISTING TYPICAL CROSS SECTION

STATION TO STATION
 104+06.45 108+00.00

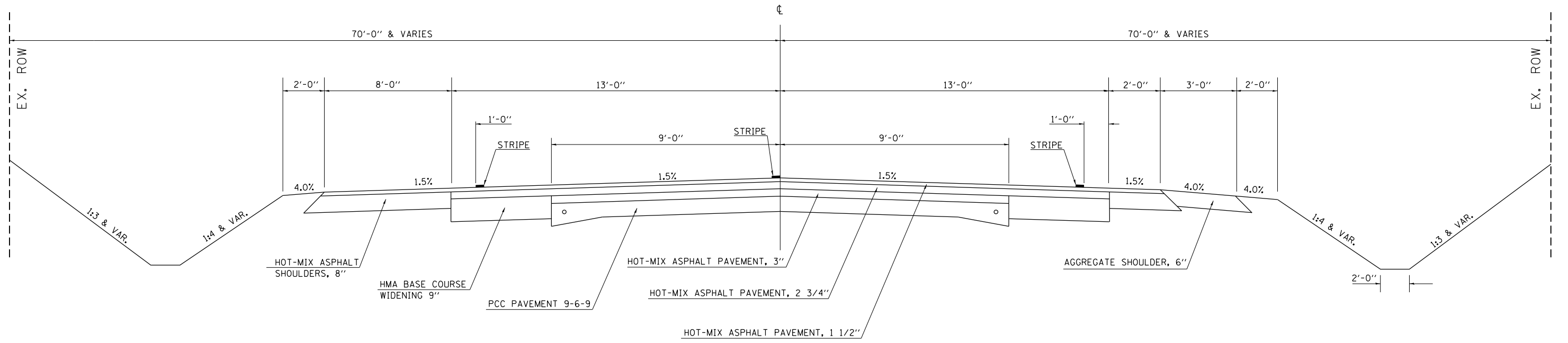

MODEL: D:\default
 FILE NAME: p:\p\lides-cw-bentley.com\FWIDOT\Documents\DOT Offices\District 5\Projects\570F59\CADD\data\CAD\hecs\570F59-shl-typical.dgn

USER NAME = grazianoja	DESIGNED -	REVISED -
	DRAWN -	REVISED -
PLOT SCALE = 40,0000' / in.	CHECKED -	REVISED -
PLOT DATE = 12/14/2021	DATE -	REVISED -

STATE OF ILLINOIS
 DEPARTMENT OF TRANSPORTATION

TYPICAL CROSS SECTIONS

SCALE: SHEET 2 OF 2 SHEETS STA. TO STA.

F.A.P. RTE.	SECTION	COUNTY	TOTAL SHEETS	SHEET NO.
326	D5 CM PATCH 2022-2	CHAMPAIGN	6	5
CONTRACT NO. 70F59				
ILLINOIS FED. AID PROJECT				

SCHEDULE OF QUANTITIES

ILL 47 NB CLASS B PATCHES, 11 INCH						CLASS B PATCHES, TYPE II, 11 INCH (SQ YD)	CLASS B PATCHES, TYPE III, 11 INCH (SQ YD)	CLASS B PATCHES, TYPE IV, 11 INCH (SQ YD)	SAW CUTS (FT)	TIE BARS 3/4" (EACH)	DOWEL BARS 1 1/2" (EACH)	WELDED WIRE REINFORCEMENT (SQ. YD)	
APPROX. STATION	DIR	LANE	LENGTH	WIDTH	SQ YD	44200982	44200986	44200988	44213200	44213204	44201299	44200050	
*35+70	NB	RAMP RTL	30	18	60.00			60.0	114.0	16.0	48.0	60.0	
36+01	NB	DL	55	14	85.56			85.6	152.0	18.0	60.0	85.6	
36+39	NB	DL	10	14	15.56		15.6		62.0		24.0	15.6	
97+32	NB	DL	12	14	18.67		18.7		66.0		24.0	18.7	
98+45	NB	DL	12	14	18.67		18.7		66.0		24.0	18.7	
99+97	NB	DL	8	13	11.56	11.6			55.0		22.0		
101+78	NB	DL	10	13	14.44	14.4			59.0		22.0		
103+65	NB	DL	8	13	11.56	11.6			55.0		22.0		
SUBTOTAL:						236.0	37.6	53.0	145.6	629.0	34.0	246.0	198.6

*I-74 WB Off-Ramp at ILL 47

ILL 47 SB CLASS B PATCHES, 11 INCH						CLASS B PATCHES, TYPE II, 11 INCH (SQ YD)	CLASS B PATCHES, TYPE III, 11 INCH (SQ YD)	CLASS B PATCHES, TYPE IV, 11 INCH (SQ YD)	SAW CUTS (FT)	TIE BARS 3/4" (EACH)	DOWEL BARS 1 1/2" (EACH)	WELDED WIRE REINFORCEMENT (SQ. YD)	
APPROX. STATION	DIR	LANE	LENGTH	WIDTH	SQ YD	44200982	44200986	44200988	44213200	44213204	44201299	44200050	
101+44	SB	DL	10	13	14.44	14.4			59.0		22.0		
99+97	SB	DL	6	13	8.67	8.7			51.0		22.0		
97+64	SB	DL	6	14	9.33	9.3			54.0		24.0		
37+97	SB	DL	6	14	9.33	9.3			54.0		24.0		
35+05	SB	DL	40	17	75.56			75.6	131.0	13.0	60.0	75.6	
33+50	SB	DL	6	14	9.33	9.3			54.0		24.0		
31+70	SB	DL	6	14	9.33	9.3			54.0		24.0		
31+50	SB	DL	6	14	9.33	9.3			54.0		24.0		
28+00	SB	DL	10	14	15.56		15.6		62.0		24.0	15.6	
25+57	SB	LTL	30	12	40.00			40.0	96.0	20.0	30.0	40.0	
25+00	SB	LTL	64	18	128.00			128.0	182.0	42.0	96.0	128.0	
SUBTOTAL:						328.9	69.6	15.6	243.6	851.0	75.0	374.0	259.2

SUMMARY

	CLASS B PATCHES, TYPE II, 11 INCH (SQ YD)	CLASS B PATCHES, TYPE III, 11 INCH (SQ YD)	CLASS B PATCHES, TYPE IV, 11 INCH (SQ YD)	SAW CUTS (FT)	TIE BARS 3/4" (EACH)	DOWEL BARS 1 1/2" (EACH)	WELDED WIRE REINFORCEMENT (SQ. YD)
GRAND TOTAL:	107.2	68.6	389.2	1480.0	109.0	620.0	457.8
USE:	108.0	69.0	390.0	1480.0	109.0	620.0	458.0

MODEL: D:\rout FILE: NAME: p:\p\lides-cw-bentley.com\FWIDOT\Documents\DOT_Offices\Dir\frt_5\Projects\DS70F59\CAD\data\CAD\heest\DS70F59-sh-Schedule.dgn

USER NAME = grazianoja	DESIGNED -	REVISED -
	DRAWN -	REVISED -
PLOT SCALE = 40,0000 ' / in.	CHECKED -	REVISED -
PLOT DATE = 12/14/2021	DATE -	REVISED -

**STATE OF ILLINOIS
DEPARTMENT OF TRANSPORTATION**

SCHEDULE OF QUANTITIES			
SCALE:	SHEET 1	OF 1	SHEETS
	STA.		TO STA.

F.A.P. RTE.	SECTION	COUNTY	TOTAL SHEETS	SHEET NO.
326	D5 CM PATCH 2022-2	CHAMPAIGN	6	6
			CONTRACT NO. 70F59	
		ILLINOIS	FED. AID PROJECT	