

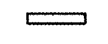

**LEGEND**

-  IMPACT ATTENUATOR
-  TEMPORARY CONCRETE BARRIER
-  BARRELS WITH STEADY BURNING LIGHT
-  TEMPORARY BRIDGE TRAFFIC SIGNALS

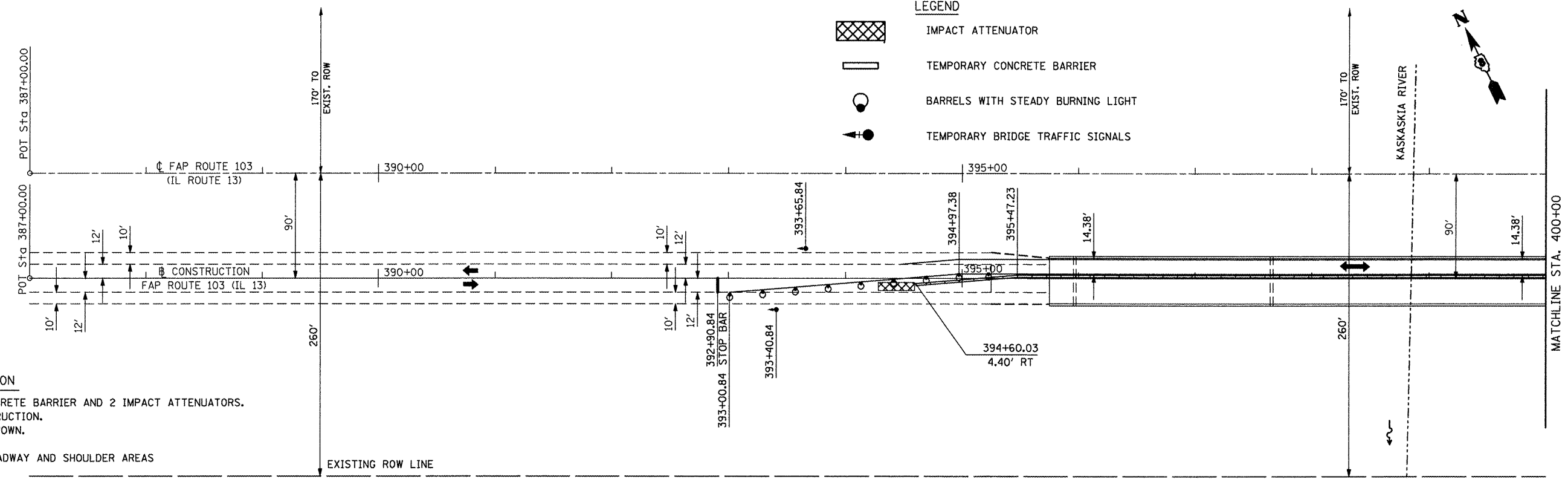

**SEQUENCE OF CONSTRUCTION**

RELOCATE 850 FEET OF TEMPORARY CONCRETE BARRIER AND 2 IMPACT ATTENUATORS.  
 PERFORM ALL WORK FOR STAGE 2 CONSTRUCTION.  
 SEE STANDARD 701321 FOR ITEMS NOT SHOWN.  
 PLACE CLASS A PATCH (SPECIAL).  
 REMOVE BITUMINOUS SURFACE IN THE ROADWAY AND SHOULDER AREAS  
 UTILIZED FOR STAGE CONSTRUCTION.  
 RESURFACE THE ROADWAY AND SHOULDER AREAS  
 UTILIZED FOR STAGE CONSTRUCTION.

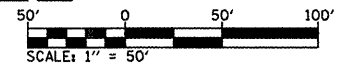
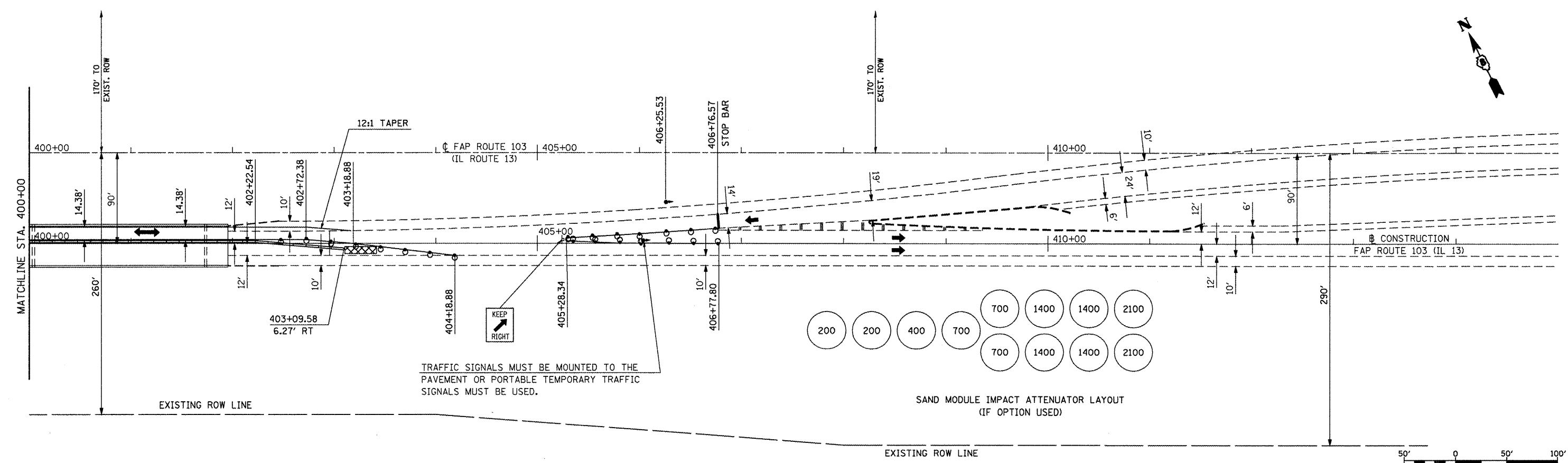

FILE NAME = #FILE#	USER NAME = #USER#	DESIGNED - ACM	REVISED -	<b>STATE OF ILLINOIS DEPARTMENT OF TRANSPORTATION</b>	<b>STAGE 2 CONSTRUCTION</b>			F.A.P. RTE. 103	SECTION 561-B-1	COUNTY ST. CLAIR	TOTAL SHEETS 21	SHEET NO. 7
	PLOT SCALE = #SCALE#	DRAWN - ACM	REVISED -		SCALE: 20'	SHEET NO. 2 OF 2 SHEETS	STA. 387+00	TO STA. 415+00	CONTRACT NO. 76E20			
	PLOT DATE = #DATE#	CHECKED -	REVISED -		ILLINOIS FED. AID PROJECT							
		DATE -	REVISED -									