

STAGING SCHEDULE					
STAGE	TEMPORARY CONCRETE BARRIER	RELOCATE TEMPORARY CONCRETE BARRIER	IMPACT ATTENUATORS TEMPORARY (NON-REDIRECTIVE) TEST LEVEL 3	IMPACT ATTENUATORS RELOCATE (NON-REDIRECTIVE) TEST LEVEL 3	TEMPORARY BRIDGE TRAFFIC SIGNALS
STAGE I	850		2		
STAGE II	0	850		2	
STAGE I & II					1
TOTAL	850	850	2	2	1

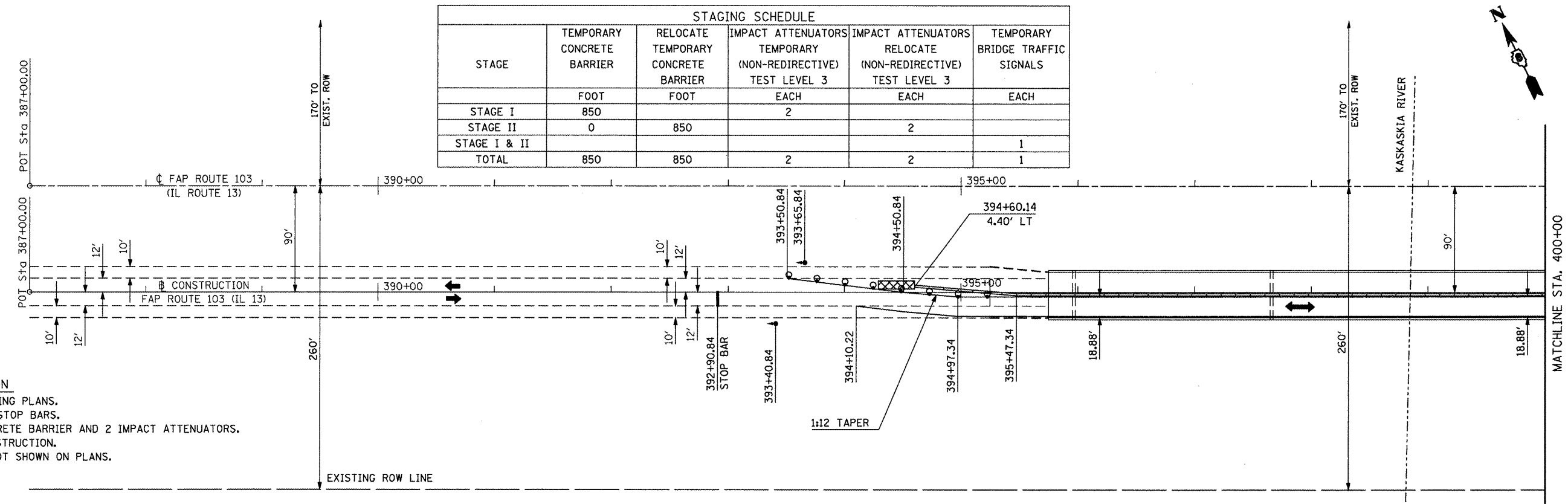

SEQUENCE OF CONSTRUCTION
 PLACE STOP BARS AS SHOWN ON STAGING PLANS.
 REMOVE PAVEMENT MARKING BETWEEN STOP BARS.
 PLACE 850 FEET OF TEMPORARY CONCRETE BARRIER AND 2 IMPACT ATTENUATORS.
 PERFORM ALL WORK FOR STAGE 1 CONSTRUCTION.
 SEE STANDARD 701321 FOR DETAILS NOT SHOWN ON PLANS.

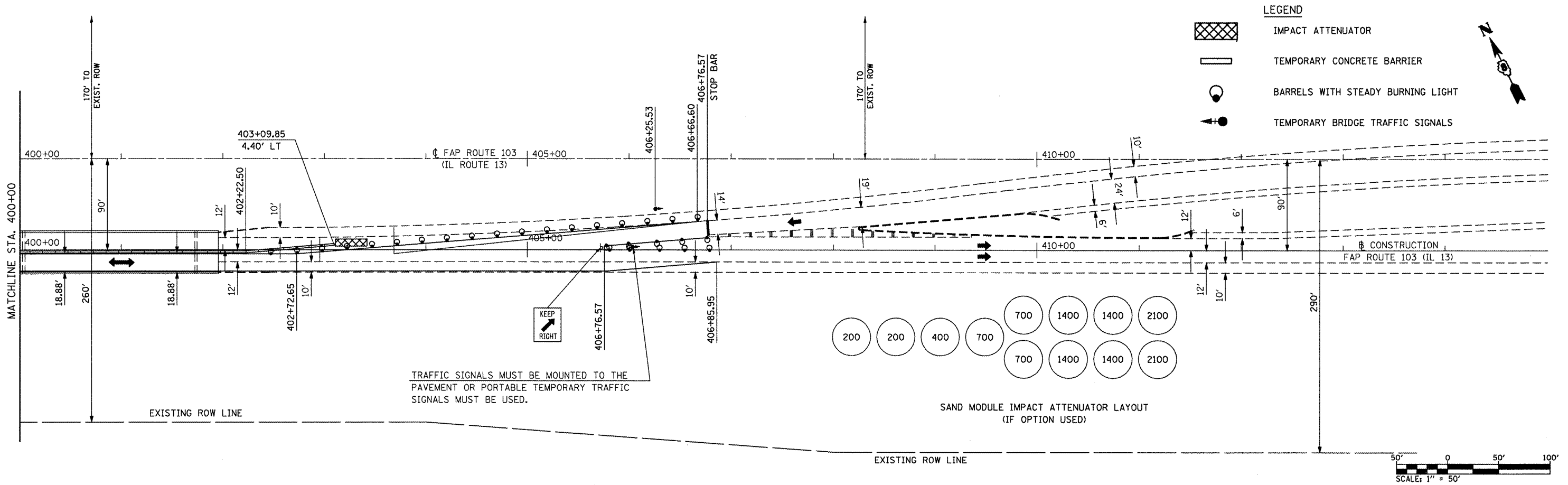

TRAFFIC SIGNALS MUST BE MOUNTED TO THE PAVEMENT OR PORTABLE TEMPORARY TRAFFIC SIGNALS MUST BE USED.

SAND MODULE IMPACT ATTENUATOR LAYOUT (IF OPTION USED)

