

STATE OF ILLINOIS
DEPARTMENT OF TRANSPORTATION
DIVISION OF HIGHWAYS
PROPOSED
HIGHWAY PLANS

| F.A.P. RTE. | SECTION | COUNTY | TOTAL SHEETS | SHEET NO. |
|-------------|------------|-----------|--------------------|-----------|
| 840 | (121,122)I | VERMILION | 12 | 1 |
| | | ILLINOIS | CONTRACT NO. 70891 | |

FOR INDEX OF SHEETS, SEE SHEET NO. 2
 FOR SUMMARY OF QUANTITIES, SEE SHEET NO. 4

D-95-068-10

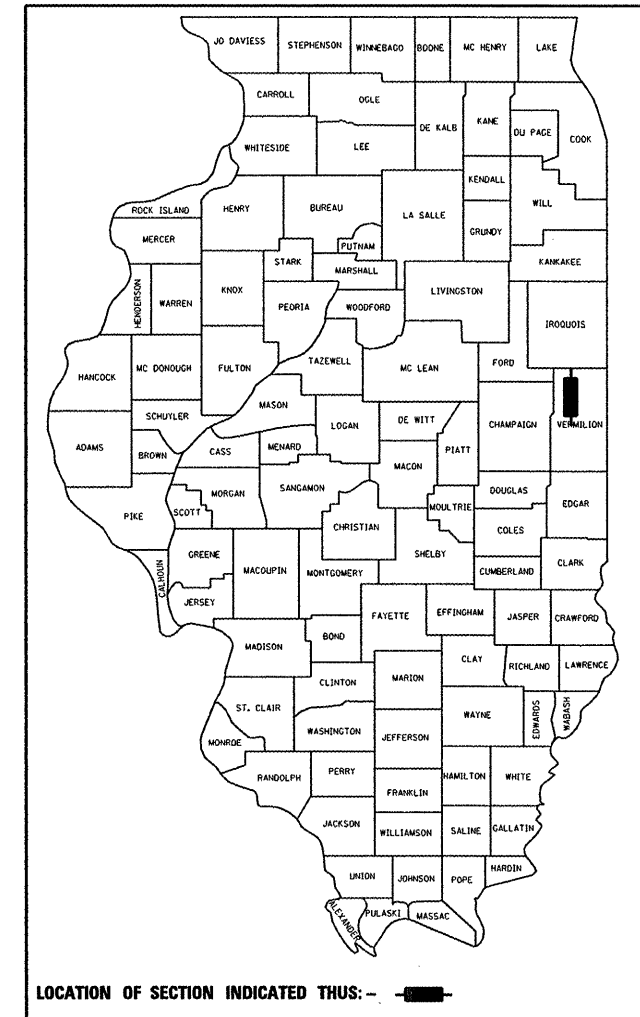

FAP ROUTE 840 (IL 49)
SECTION (121,122)I
VERMILION COUNTY

C-95-068-10

CENTERLINE MICROSURFACING FROM FAST CREEK TO US 136 W

CURRENT ADT
 MINOR ARTERIAL
 FAP 840 (IL 49) = 1,450 (2009)

DESIGN DESIGNATION
 N/A

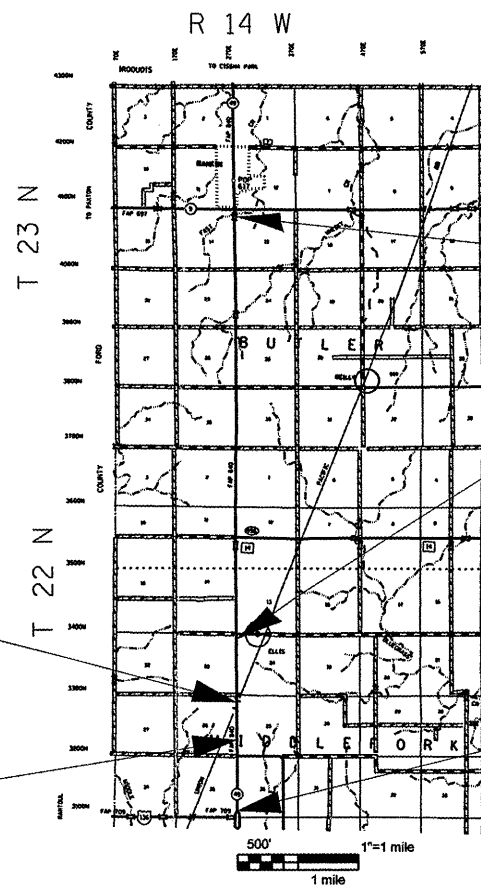

END IMPROVEMENT
 STA. 1280+10

STATION EQUATION
 STA. 870+00(BK)=STA. 870+71(AH)

BEGIN IMPROVEMENT
 STATION 765+00

BRIDGE OMISSION
 S.N. 092-0101
 STA. 854+78 - 861+60

STATION EQUATION
 STA. 837+24(BK)=STA. 837+20(AH)

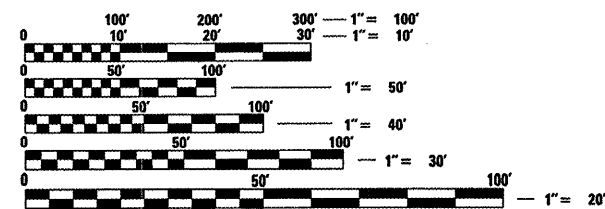

FULL SIZE PLANS HAVE BEEN PREPARED USING STANDARD ENGINEERING SCALES. REDUCED SIZED PLANS WILL NOT CONFORM TO STANDARD SCALES. IN MAKING MEASUREMENTS ON REDUCED PLANS, THE ABOVE SCALES MAY BE USED.

J.U.L.E.
 JOINT UTILITY LOCATION INFORMATION FOR EXCAVATION
 1-800-892-0123
 OR 811

PROJECT ENGINEER : KEVIN TRAPP 217-465-4181
 PROJECT MANAGER : JEFF SHERER
 DESIGNER : RANDY AUSTIN
 CONTRACT NO. 70891

GROSS LENGTH = 51,443.00 FT. = 9.743 MILES
 NET LENGTH = 50,761.00 FT. = 9.614 MILES

STATE OF ILLINOIS
 DEPARTMENT OF TRANSPORTATION
 DIVISION OF HIGHWAYS

SUBMITTED 12/14 20 10

Janette A. Cowan
 DEPUTY DIRECTOR OF HIGHWAYS, REGION ENGINEER

Feb 4 20 11
Scott E. Stitt P.E. LE
 acting ENGINEER OF DESIGN AND ENVIRONMENT

Feb 4 20 11
Christine M. Reed LE
 DIRECTOR OF HIGHWAYS, CHIEF ENGINEER

**PRINTED BY THE AUTHORITY
 OF THE STATE OF ILLINOIS**